

you and 3 others may pay the price

Nature sends a warning of Porrhoea—bleeding gums. Only one person out of five past forty escapes. Thousands younger are subject to it as well. Be on your guard.

Brush your teeth with Forhan's FOR THE GUMS More than a tooth paste—it checks Porrhoea 35c and 60c in tubes

Dr. Waugh

DENTIST 106 Wellington St. Phone 256.

CANADIAN NATIONAL RLY'S

A change will be made in passenger train schedules on Sunday, May 13th, 1928.

Standard time, not so-called daylight saving time, will continue to be used for schedules of all trains on the Canadian National Railways.

For particulars apply to: J. P. HANLEY, C.P. and T.A., C.N. Ry. Cor. Johnson and Ontario Streets, Kingston, Ont.

CANADIAN PACIFIC

Table with columns for destinations (MONTREAL, QUEBEC, etc.) and train names (Minnedosa, etc.)

Ask about Around the World, Mediterranean, Around America, and World Cruises, January-February, 1928.

A moral, sensible, well-bred man. Will not insult me; no other can.—Cowper.

An English House of Distinctive Design

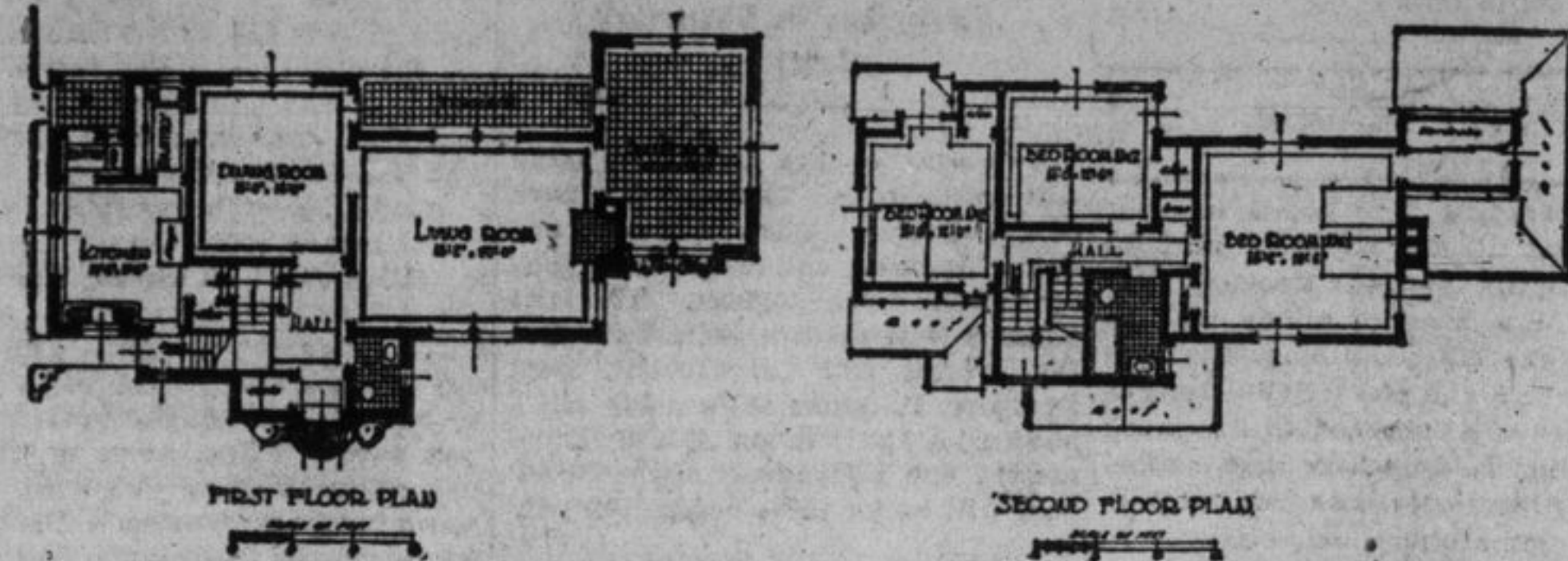

This house avoids the commonplace in design; in every detail it shows unusual character; it is a house that would stand out in distinction from its neighbors.

Yet there is nothing freakish about the design, it is throughout, in the best of taste and, at the same time, it is unusual and distinctive. It follows the old English type.

The architects have so handled the roofs that a pleasing variety in form and outline is obtained. The entrance gable has the roof eaves brought down to the tops of the first story windows, and the plain stucco walls of this gable form a fitting setting for the heavy oak doorway.

The walls of the house are finished in stucco, preferably white; the roof is slate of various colors and sizes; the chimney is hard burned red brick, and the timberwork, window frames, etc., should be stained a weathered gray, preferably quite dark.

The plans of this house present a livable arrangement of good size rooms, the result of thorough study on the part of the architects.

The necessary coat closet and the very desirable toilet room are both provided near the entrance door, where they are most convenient.

A small stair hall gives entrance to the living room, the dining room, and provides the stairway. Steps from the main stair platform to the kitchen (with a door) eliminate the service stairway.

On the second floor three bedrooms are well laid out. A large bath is provided. There are plenty of closets.

A cellar is provided under the entire house, and here is the heating plant, the laundry, and such. This house should have a lot with seventy-five feet frontage, to give it proper setting.

Complete working plans and specifications of this house may be obtained for a nominal sum from the Building Editor. Refer to House A-36.

REPORT ON HIGHWAYS

Conditions as Reported by the Department of Public Highways.

Toronto to Kingston—To Rouge Hill, fair. Rouge Hill to Port Hope, good. Port Hope to Belleville, gravel road good for touring cars and light loads, avoid heavy loading.

Belleville to Kingston, good, five miles of old road in Ernestown rather rough. No detours.

Kingston to Quebec Boundary—Whitby to Lindsay—Fair. Road closed on the eighth concession of Brock. Detour on the sixth concession from Sunderland to the County Line.

Port Hope to Peterboro—Gravel road to Fraserville in good condition for touring, avoid heavy loads. Fraserville to Peterboro macadam, road good.

Pictou to Foxboro—Pictou to Belleville, good. Old road rather rough. Belleville-Foxboro, good. Old road fairly rough. No detours.

Kingston to Ottawa (via Smith's Falls)—Kingston to Smith's Falls, road well dragged and in good shape for motor traffic. Smith's Falls to Port Elmsley good. Port Elmsley to Perth, good. Contractors will be starting soon to construct culverts and macadam base course.

Traffic is warned to watch for slow order signs. Perth to Carleton Place, good. Construction of culverts and macadam base course will be commenced in near future. Carleton Place to Ashton Station, good. Construction will commence shortly. Ashton Station to Stanley's Corners, excellent. Stanley's Corners to Stittville, good. Stittville to Bell's Corners, good. Bell's Corners to Ottawa, fair. Culvert construction under way, traffic is advised to take the Richmond Road to Ottawa.

Ottawa to Pembroke—Ottawa to Carp, fair. Carp to Arnprior, good. Arnprior to Renfrew, good. Renfrew to Haley's, bad. Haley's to Cobden, good. Cobden to Pembroke, good.

Toronto to Severn—Toronto to Newmarket, good. Newmarket to Severn, good throughout except small section of new road at Holland Landing. Detour through the village.

Port Credit to Owen Sound—Port Credit to Cooksville, closed to traffic. Detour Middle Road one quarter miles easterly. Cooksville to Bramp-

ton, surface good. Brampton to Chatsworth fair gravel road throughout. Grading between Brampton and Orangeville after May 15th. Culvert construction Melanethon north to Chatsworth after May 15th.

Toronto to Hamilton (via Dundas street)—Toronto to Cooksville, good. From end of pavement three-quarters mile west of Cooksville newly graded to Sixteen Mile Creek. rough. Sixteen Mile Creek to Clappans, good.

News From Elgin. Elgin, May 9.—J. F. Earl motored to Kingston on Sunday, F. J. Grey and family motored to Kingston on Sunday. Little Mollie Teskey, Oxford Mills, is the guest of her grandfather, J. R. Darjavel. The bodies were removed from the vault last week. The number was the largest in years. Arbor Day was observed by the various schools.

Plevna Home Burned. Plevna, May 8.—Fred Hill and family have the sympathy of the whole neighborhood in the loss of their home by fire. The house and nearly all the contents were burned including sixty pounds of butter and fifty dollars cash. The horse stable, hen house and pig pen were burned. Twelve little pigs met death in the pen.

Little Olive Plaque has a bad attack of tonsillitis. Miss Abernathy, Kingston, went to Vennacher this morning. A number from Plevna attended the sale at W. J. Cox's last week. Every thing was sold for a fair price. Judd Tooley and family are moving to the mountains. They have rented C. Ohlman's farm. A number of the young men around Plevna are going to work on the

HOME REMEDIES OF OUR ANCESTORS

Almost every man and woman in America can remember the botanic recipes of our mothers and grandmothers for the treatment of disease, and they were wonderfully dependable too. Every fall there were stored away in the attic thoroughwort, pennyroyal, catnip, sage, wormwood, rue, etc., for treating ills of the family during the winter months that followed. In 1873, Lydia E. Pinkham's Vegetable Compound was first prepared from one of the best botanic recipes, and the demand for it has increased to such an extent that hundreds of tons of roots and herbs are now used annually in its preparation. It has recently been proved that 98 out of every 100 women who try it have been benefited by its use, which is a marvelous record for any medicine to hold.

ton, surface good. Brampton to Chatsworth fair gravel road throughout. Grading between Brampton and Orangeville after May 15th. Culvert construction Melanethon north to Chatsworth after May 15th.

Toronto to Hamilton (via Dundas street)—Toronto to Cooksville, good. From end of pavement three-quarters mile west of Cooksville newly graded to Sixteen Mile Creek. rough. Sixteen Mile Creek to Clappans, good.

News From Elgin. Elgin, May 9.—J. F. Earl motored to Kingston on Sunday, F. J. Grey and family motored to Kingston on Sunday. Little Mollie Teskey, Oxford Mills, is the guest of her grandfather, J. R. Darjavel. The bodies were removed from the vault last week. The number was the largest in years. Arbor Day was observed by the various schools.

Plevna Home Burned. Plevna, May 8.—Fred Hill and family have the sympathy of the whole neighborhood in the loss of their home by fire. The house and nearly all the contents were burned including sixty pounds of butter and fifty dollars cash. The horse stable, hen house and pig pen were burned. Twelve little pigs met death in the pen.

Little Olive Plaque has a bad attack of tonsillitis. Miss Abernathy, Kingston, went to Vennacher this morning. A number from Plevna attended the sale at W. J. Cox's last week. Every thing was sold for a fair price. Judd Tooley and family are moving to the mountains. They have rented C. Ohlman's farm. A number of the young men around Plevna are going to work on the

new road near Cloyne. Miss Gertie Watson has gone to the States for the summer.

Address and Presentation. At the regular monthly meeting of the Maple Leaf Institute, at the home

of Mrs. Wesley Creek, an address by J. B. Miller, the RIGHT Arthur Currie and electric lamp near look like new. Napanee. Mcclair's 604 - 580 Harris St.

Why spoil a week-end? Paint your car with Carmote Auto-Color Varnish. It dries in twenty-four hours, no laying up for Sunday. This has a beautiful richness of color.

One thing to show a man is in error, and another to show him in possession of truth. The laws of conscience which we are born of nature are born of nature.

THE NATIONAL WAY

For reservations and full particulars apply to J. P. HANLEY, C.P. & T.A., C.N. Railway, Cor. Johnson and Ontario Streets, Kingston, Ont.

INTERNATIONAL LIMITED—Leave Toronto 8:25 a.m. daily, (10:30 a.m. Daylight Saving Time). Equipment: Observation, Library Car, Parlor and Dining Cars and Coaches.

NEW TRAIN—Leave Toronto 8:45 p.m. daily, (10:45 p.m. Daylight Saving Time). Equipment: Standard Sleeping Cars and Coaches.

EASTERN FLYER—Leave Toronto 11:00 p.m. daily, (12:00 midnight Daylight Saving Time). Equipment: Club Compartment Car, Standard Sleeping Cars and Coaches.

OTHER THROUGH TRAINS—Leave Toronto 7:00 a.m. daily, (8:00 a.m. Daylight Saving Time), 8:30 p.m. daily (10:30 p.m. Daylight Saving Time).

For reservations and full particulars apply to J. P. HANLEY, C.P. & T.A., C.N. Railway, Cor. Johnson and Ontario Streets, Kingston, Ont.

THE NATIONAL WAY

J. A. McNabb Co. Limited MAMMOTH HALF PRICE BLOUSE SALE THE GREATEST SALE OF BLOUSES EVER WITNESSED IN KINGSTON

Georgette, Crepe de Chene and Canton Crepe—regularly priced from \$5.95 to \$12.95, for \$2.98 to \$6.48 On Saturday morning at 9 o'clock, the Women of Kingston will have the opportunity to choose from our entire Blouse stock and only pay us 1/2 the present marked prices.

A FINAL CLEAN-UP OF CLOTH DRESSES — TRICOTINE AND POIRET TWILL

Three Groups—Three Prices. \$10.95 - \$14.95 - \$21.95 Regular \$19.95 Dresses Are Priced at \$10.95

7 Only, Tricotine and Poiret Twill Dresses—Regular \$29.50 for \$14.50

12 TRICOTINE AND POIRET TWILL FROCKS—Regular \$35 to \$45, for \$21.95

Eight Box Model Suits Beautifully Tailored From Best Tricotines at Special Saturday Reductions

Chic Summer Frocks \$3.98 Of High Quality Gingham

There is still time to wear a Suit—in fact you will be wearing one the biggest part of the season, according to the weather prophet. Just take particular notice of these Special Saturday Reductions.

In style, workmanship and quality of material, these Summer Frocks are worthy of a high price. They are Dresses you may slip on, in the afternoon, and feel well dressed. They display the Bromley Collar, Short Sleeves and Girde of self, which ties in a bow at the back. Colors: Pink, Mauve, Yellow, Red or Blue Checks. Sizes 16 to 40. Make your choice while assortment of sizes is complete.

J. G. Pennock has redecorated a new ice cream parlor. Mrs. J. F. Earl was taken to Kingston General hospital last week and underwent a successful operation for appendicitis.

Plevna Home Burned. Plevna, May 8.—Fred Hill and family have the sympathy of the whole neighborhood in the loss of their home by fire.

Little Olive Plaque has a bad attack of tonsillitis. Miss Abernathy, Kingston, went to Vennacher this morning.

Address and Presentation. At the regular monthly meeting of the Maple Leaf Institute, at the home of Mrs. Wesley Creek, an address by J. B. Miller, the RIGHT Arthur Currie and electric lamp near look like new.

Why spoil a week-end? Paint your car with Carmote Auto-Color Varnish. It dries in twenty-four hours, no laying up for Sunday.

One thing to show a man is in error, and another to show him in possession of truth. The laws of conscience which we are born of nature are born of nature.

5 Trains Daily Each Way between Toronto and Montreal Improved Service

INTERNATIONAL LIMITED—Leave Toronto 8:25 a.m. daily, (10:30 a.m. Daylight Saving Time). Equipment: Observation, Library Car, Parlor and Dining Cars and Coaches.

NEW TRAIN—Leave Toronto 8:45 p.m. daily, (10:45 p.m. Daylight Saving Time). Equipment: Standard Sleeping Cars and Coaches.

EASTERN FLYER—Leave Toronto 11:00 p.m. daily, (12:00 midnight Daylight Saving Time). Equipment: Club Compartment Car, Standard Sleeping Cars and Coaches.

OTHER THROUGH TRAINS—Leave Toronto 7:00 a.m. daily, (8:00 a.m. Daylight Saving Time), 8:30 p.m. daily (10:30 p.m. Daylight Saving Time).

For reservations and full particulars apply to J. P. HANLEY, C.P. & T.A., C.N. Railway, Cor. Johnson and Ontario Streets, Kingston, Ont.

THE NATIONAL WAY

For reservations and full particulars apply to J. P. HANLEY, C.P. & T.A., C.N. Railway, Cor. Johnson and Ontario Streets, Kingston, Ont.

INTERNATIONAL LIMITED—Leave Toronto 8:25 a.m. daily, (10:30 a.m. Daylight Saving Time). Equipment: Observation, Library Car, Parlor and Dining Cars and Coaches.

NEW TRAIN—Leave Toronto 8:45 p.m. daily, (10:45 p.m. Daylight Saving Time). Equipment: Standard Sleeping Cars and Coaches.

EASTERN FLYER—Leave Toronto 11:00 p.m. daily, (12:00 midnight Daylight Saving Time). Equipment: Club Compartment Car, Standard Sleeping Cars and Coaches.

OTHER THROUGH TRAINS—Leave Toronto 7:00 a.m. daily, (8:00 a.m. Daylight Saving Time), 8:30 p.m. daily (10:30 p.m. Daylight Saving Time).

For reservations and full particulars apply to J. P. HANLEY, C.P. & T.A., C.N. Railway, Cor. Johnson and Ontario Streets, Kingston, Ont.

THE NATIONAL WAY

For reservations and full particulars apply to J. P. HANLEY, C.P. & T.A., C.N. Railway, Cor. Johnson and Ontario Streets, Kingston, Ont.

INTERNATIONAL LIMITED—Leave Toronto 8:25 a.m. daily, (10:30 a.m. Daylight Saving Time). Equipment: Observation, Library Car, Parlor and Dining Cars and Coaches.

NEW TRAIN—Leave Toronto 8:45 p.m. daily, (10:45 p.m. Daylight Saving Time). Equipment: Standard Sleeping Cars and Coaches.

EASTERN FLYER—Leave Toronto 11:00 p.m. daily, (12:00 midnight Daylight Saving Time). Equipment: Club Compartment Car, Standard Sleeping Cars and Coaches.

OTHER THROUGH TRAINS—Leave Toronto 7:00 a.m. daily, (8:00 a.m. Daylight Saving Time), 8:30 p.m. daily (10:30 p.m. Daylight Saving Time).

For reservations and full particulars apply to J. P. HANLEY, C.P. & T.A., C.N. Railway, Cor. Johnson and Ontario Streets, Kingston, Ont.

THE NATIONAL WAY

For reservations and full particulars apply to J. P. HANLEY, C.P. & T.A., C.N. Railway, Cor. Johnson and Ontario Streets, Kingston, Ont.

INTERNATIONAL LIMITED—Leave Toronto 8:25 a.m. daily, (10:30 a.m. Daylight Saving Time). Equipment: Observation, Library Car, Parlor and Dining Cars and Coaches.

NEW TRAIN—Leave Toronto 8:45 p.m. daily, (10:45 p.m. Daylight Saving Time). Equipment: Standard Sleeping Cars and Coaches.

EASTERN FLYER—Leave Toronto 11:00 p.m. daily, (12:00 midnight Daylight Saving Time). Equipment: Club Compartment Car, Standard Sleeping Cars and Coaches.

OTHER THROUGH TRAINS—Leave Toronto 7:00 a.m. daily, (8:00 a.m. Daylight Saving Time), 8:30 p.m. daily (10:30 p.m. Daylight Saving Time).

For reservations and full particulars apply to J. P. HANLEY, C.P. & T.A., C.N. Railway, Cor. Johnson and Ontario Streets, Kingston, Ont.

THE NATIONAL WAY

For reservations and full particulars apply to J. P. HANLEY, C.P. & T.A., C.N. Railway, Cor. Johnson and Ontario Streets, Kingston, Ont.

INTERNATIONAL LIMITED—Leave Toronto 8:25 a.m. daily, (10:30 a.m. Daylight Saving Time). Equipment: Observation, Library Car, Parlor and Dining Cars and Coaches.

NEW TRAIN—Leave Toronto 8:45 p.m. daily, (10:45 p.m. Daylight Saving Time). Equipment: Standard Sleeping Cars and Coaches.

EASTERN FLYER—Leave Toronto 11:00 p.m. daily, (12:00 midnight Daylight Saving Time). Equipment: Club Compartment Car, Standard Sleeping Cars and Coaches.

OTHER THROUGH TRAINS—Leave Toronto 7:00 a.m. daily, (8:00 a.m. Daylight Saving Time), 8:30 p.m. daily (10:30 p.m. Daylight Saving Time).

For reservations and full particulars apply to J. P. HANLEY, C.P. & T.A., C.N. Railway, Cor. Johnson and Ontario Streets, Kingston, Ont.

THE NATIONAL WAY

For reservations and full particulars apply to J. P. HANLEY, C.P. & T.A., C.N. Railway, Cor. Johnson and Ontario Streets, Kingston, Ont.

INTERNATIONAL LIMITED—Leave Toronto 8:25 a.m. daily, (10:30 a.m. Daylight Saving Time). Equipment: Observation, Library Car, Parlor and Dining Cars and Coaches.

NEW TRAIN—Leave Toronto 8:45 p.m. daily, (10:45 p.m. Daylight Saving Time). Equipment: Standard Sleeping Cars and Coaches.

EASTERN FLYER—Leave Toronto 11:00 p.m. daily, (12:00 midnight Daylight Saving Time). Equipment: Club Compartment Car, Standard Sleeping Cars and Coaches.

OTHER THROUGH TRAINS—Leave Toronto 7:00 a.m. daily, (8:00 a.m. Daylight Saving Time), 8:30 p.m. daily (10:30 p.m. Daylight Saving Time).

For reservations and full particulars apply to J. P. HANLEY, C.P. & T.A., C.N. Railway, Cor. Johnson and Ontario Streets, Kingston, Ont.

THE NATIONAL WAY

For reservations and full particulars apply to J. P. HANLEY, C.P. & T.A., C.N. Railway, Cor. Johnson and Ontario Streets, Kingston, Ont.

INTERNATIONAL LIMITED—Leave Toronto 8:25 a.m. daily, (10:30 a.m. Daylight Saving Time). Equipment: Observation, Library Car, Parlor and Dining Cars and Coaches.

NEW TRAIN—Leave Toronto 8:45 p.m. daily, (10:45 p.m. Daylight Saving Time). Equipment: Standard Sleeping Cars and Coaches.

EASTERN FLYER—Leave Toronto 11:00 p.m. daily, (12:00 midnight Daylight Saving Time). Equipment: Club Compartment Car, Standard Sleeping Cars and Coaches.

OTHER THROUGH TRAINS—Leave Toronto 7:00 a.m. daily, (8:00 a.m. Daylight Saving Time), 8:30 p.m. daily (10:30 p.m. Daylight Saving Time).

For reservations and full particulars apply to J. P. HANLEY, C.P. & T.A., C.N. Railway, Cor. Johnson and Ontario Streets, Kingston, Ont.

THE NATIONAL WAY

For reservations and full particulars apply to J. P. HANLEY, C.P. & T.A., C.N. Railway, Cor. Johnson and Ontario Streets, Kingston, Ont.

INTERNATIONAL LIMITED—Leave Toronto 8:25 a.m. daily, (10:30 a.m. Daylight Saving Time). Equipment: Observation, Library Car, Parlor and Dining Cars and Coaches.

NEW TRAIN—Leave Toronto 8:45 p.m. daily, (10:45 p.m. Daylight Saving Time). Equipment: Standard Sleeping Cars and Coaches.

EASTERN FLYER—Leave Toronto 11:00 p.m. daily, (12:00 midnight Daylight Saving Time). Equipment: Club Compartment Car, Standard Sleeping Cars and Coaches.