

# FOXTAIL

## PROPERTY SERVICES INC.

905-591-1323

**CALL TODAY TO BOOK  
YOUR SPRING CLEAN UP  
WITH FREE AERATION!**

### Our services include:

- Spring Clean Up • Lawn Cutting
- Aeration • Dethatching
- Fall Clean Up
- Irrigation Opening & Closing

**THANK YOU**  
Stouffville for  
Voting Us Best  
Landscape/Lawn  
Service Company  
for 2013!

Visit our website at  
[www.foxtailpropertieservices.com](http://www.foxtailpropertieservices.com)  
or call us at 905-591-1323

## EMERGENCY MORTGAGE LOANS !

**WE REPRESENT OVER 200 LENDERS**  
Manny Johar provides 1st, 2nd and 3rd mortgages  
even with:

- Horrible Credit
- Bankruptcy
- Unemployed
- Mortgage Arrears
- Property Tax Arrears
- Power of Sale
- Self-Employed
- Pension & Disability

**Does Your bank offer payments THIS LOW?**

Mortgage Amount	Monthly Payment	Bi-Weekly Payment
\$200,000	\$759.41	\$350.50
\$220,000	\$835.35	\$385.55
\$240,000	\$911.29	\$420.60
\$260,000	\$987.23	\$455.65
\$280,000	\$1,063.17	\$490.70
\$300,000	\$1,139.11	\$525.74
\$320,000	\$1,215.05	\$560.79
\$340,000	\$1,290.99	\$595.84
\$360,000	\$1,366.93	\$630.89
\$380,000	\$1,442.87	\$665.94
\$400,000	\$1,518.81	\$700.99



**Rates from 2.4%!**  
Amortization up to  
35 years!

**Expert**  
Licence # 12079

AS OF MAY 1, 2014, OAC

*"My husband lost his job. We fell behind on our mortgage. The bank was seizing our home. I still can't believe that you gave us an emergency mortgage with no proof of income. You saved our home & gave us extra cash to get by until he finds another job. Thanks Manny!"* C.S., Uxbridge, ON

**Ask us about our: COMMERCIAL - FARM - CONSTRUCTION LOANS!**

**Call Manny - 7 DAYS A WEEK 1.888.646.7596 or  
Check us out online: [www.MannyJohar.ca](http://www.MannyJohar.ca)**

*Manny Johar is Ontario's Mortgage SUPERSTAR!*

ADVERTISEMENT

## 27 Quick and Easy Fix Ups to Sell Your Home Fast and for Top Dollar

York Region, ON - Because your home may well be your largest asset, selling it is probably one of the most important decisions you will make in your life. And once you have made that decision, you'll want to sell your home for the highest price in the shortest time possible without compromising your sanity. Before you place your home on the market, here's a way to help you to be as prepared as possible.

To assist homesellers, a new industry report has just been released called "27 Valuable Tips That You Should Know to Get Your Home Sold Fast and for Top Dollar." It tackles the important issues you need to know to make your home competitive in today's tough, aggressive marketplace.

Through these 27 tips you will discover how to protect and capitalize on your most important investment, reduce stress, be in control of your situation, and make the best profit possible.

In this report you'll discover how to avoid financial disappointment or worse, a financial disaster when selling your home. Using a common-sense approach, you will get the straight facts about what can make or break the sale of your home.

You owe it to yourself to learn how these important tips will give you the competitive edge to get your home sold fast and for the most amount of money.

Order your free report today. To order a FREE Special Report, visit [www.gtanorthhomes.com](http://www.gtanorthhomes.com) or to hear a brief recorded message about how to order your FREE copy of this report call toll-free 1-800-733-0531 and enter 1023. You can call any time, 24 hours a day, 7 days a week.

Get your free special report NOW

This report is courtesy of Gary Ng, Broker @ Right At Home Realty Inc. Brokerage. Not intended to solicit buyers or sellers currently under contract. Copyright © 2014.



Town of  
**WHITCHURCH-STOUFFVILLE**

111 Sandiford Drive, Stouffville, Ontario L4A 0Z8 • 905-640-1900 or 1-855-642-TOWN (8696) • [www.townofws.ca](http://www.townofws.ca)

## NOTICE OF STUDY COMPLETION Sub-Trunk #1 Sanitary Sewer, Town of Whitchurch-Stouffville Class Environmental Assessment Study

### THE STUDY

The Town of Whitchurch-Stouffville, through their engineering consultant Chisholm, Fleming and Associates, has initiated a Class Environmental Assessment for the proposed Sub-Trunk #1 Sanitary Sewer extension to service lands east of the Tenth Line in the community of Stouffville.

Watermain system extensions will also be considered where appropriate to extend servicing or improve circulation in the distribution system.

### THE PROCESS

This project was planned as a Schedule 'B' project as outlined in the Municipal Engineer's Association (MEA) Municipal Class Environmental Assessment (October 2000, as amended in 2007 & 2011), which is an approved process under the Environmental Assessment Act.

All parties have been provided with the required Notice of Commencement and Public Meeting. This Notice of Completion is the final stage of the integrated EA process. Subject to comments received and the necessary approvals, the Town of Whitchurch-Stouffville intends to proceed with the construction of this project in accordance with the annual budget review and approval.

If there are concerns which cannot be resolved in discussion, a party or person may request that the Minister of the Environment make an order for the project to comply with Part II of the EA Act (Part II Order). Requests must be received no later than May 31, 2014.

### COMMENTS INVITED

The project file is available for viewing at the Town Municipal Office daily from 8:30 am to 4:30 pm located at 111 Sandiford Drive, at the Stouffville Public Library at 2 Park Drive, and has also been posted on the Town of Whitchurch-Stouffville website, <http://www.townofws.ca>. If you have any questions or comments regarding the study, please contact either of the following project team members.

**Shima Rezazadeh, M.Eng., P.Eng.**  
Manager of Capital Projects  
Town of Whitchurch-Stouffville  
111 Sandiford Drive  
Stouffville, ON L4A 0Z8  
Telephone: 905-640-1910 x2404  
Toll Free: 1-855-642-TOWN(8696)  
Fax: 905-640-7957  
Email: [shima.rezazadeh@townofws.ca](mailto:shima.rezazadeh@townofws.ca)

**Andrea Carroll, P.Eng.**  
Consultant Project Manager  
Chisholm, Fleming and Associates  
317 Renfrew Drive, Suite 301  
Markham, ON L3R 9S8  
Telephone: 905-474-1458 x231  
Toll Free: 1-888-241-4149  
Fax: 905-474-1910  
Email: [paul.lapalme@chisholmfleming.com](mailto:paul.lapalme@chisholmfleming.com)

Personal information will be collected under the authority of the Municipal Act, 2001, S.O., c. 24, as amended, and will be used by the Town of Whitchurch-Stouffville for the purpose of providing further notification regarding the Class EA Study. Any questions regarding the collection of this information should be directed to the Freedom of Information and Privacy Coordinator at 905-640-1910 or 1-855-642-8697 ext 2222. With the exception of personal information, all comments will become part of the public record.

This Notice first issued May 1, 2014.

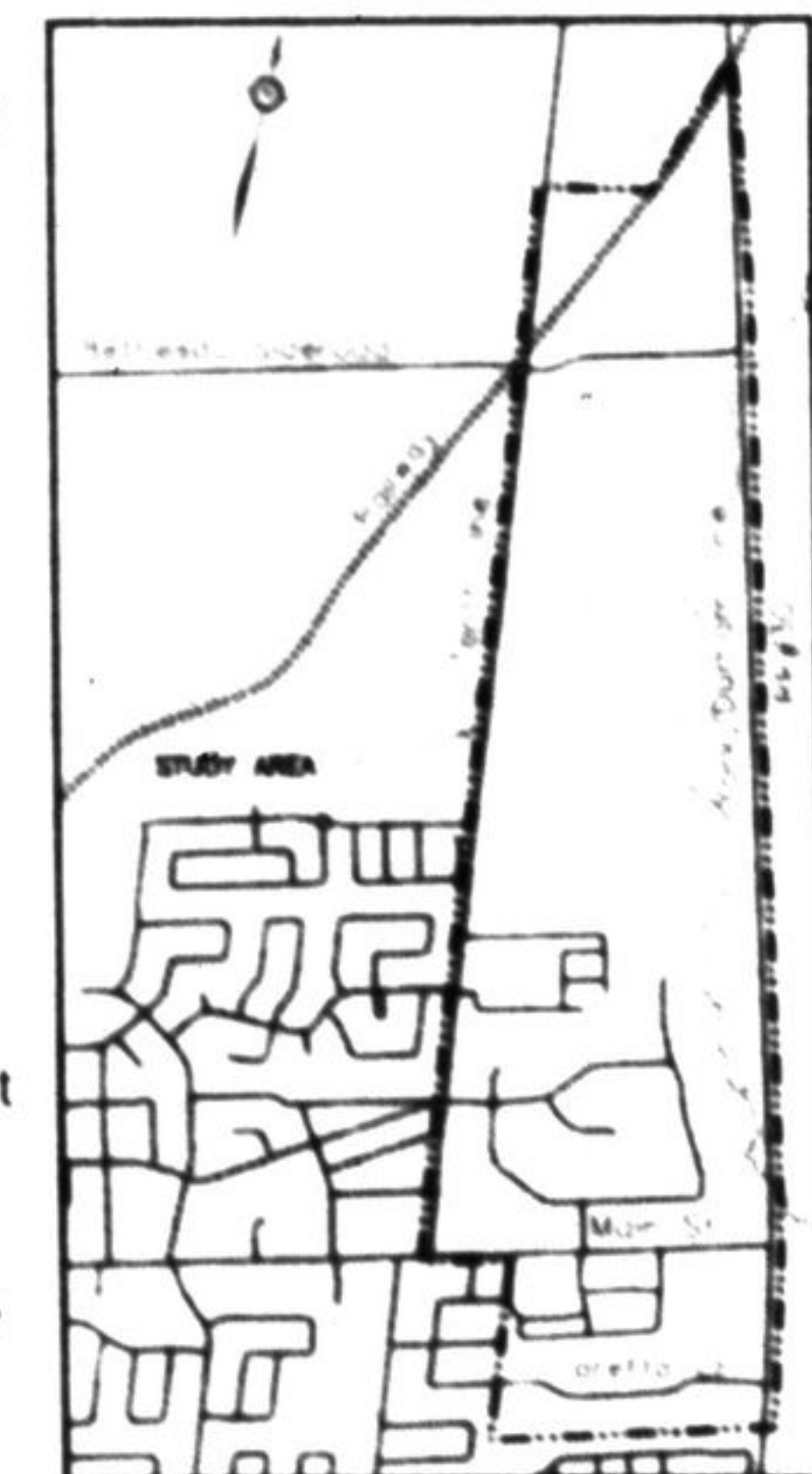

STUDY AREA