



TOWN OF  
**WHITCHURCH-STOUFFVILLE**  
*celebrating 40 years*

111 Sandiford Drive  
Stouffville, Ontario L4A 0Z8  
905-640-1900 or 1-855-642-TOWN (8696)  
**www.townofws.ca**

Lebovic Leisure Centre 905-642-PLAY(7529) • Public Library 905-642-READ(7323) • Museum 905-727-8954 OR 1-888-290-0337

## NOTICE OF COUNCIL MEETING



Council Chamber • 111 Sandiford Drive  
**TUESDAY AUGUST 23<sup>RD</sup>**  
**COUNCIL MEETING at 9:00 a.m.**  
**COUNCIL CHAMBERS**  
**111 SANDIFORD DRIVE**  
*(New Location)*



## NOTICE

### PROPOSED SALE OF PUBLIC LANDS

On August 23, 2011, Council will consider a staff report concerning the sale of Town-owned property of 2.3 acres at the corner of Woodbine Avenue and Hunter Road in Vandorf. The site has the buildings with municipal addresses of 14683 Woodbine Avenue; 14685 Woodbine Avenue and 7 Hunter Road (Part of Lot 17, Conc. 4 Whitchurch - All of PIN 03696-0057LT and Part of PIN 03696-0079LT).

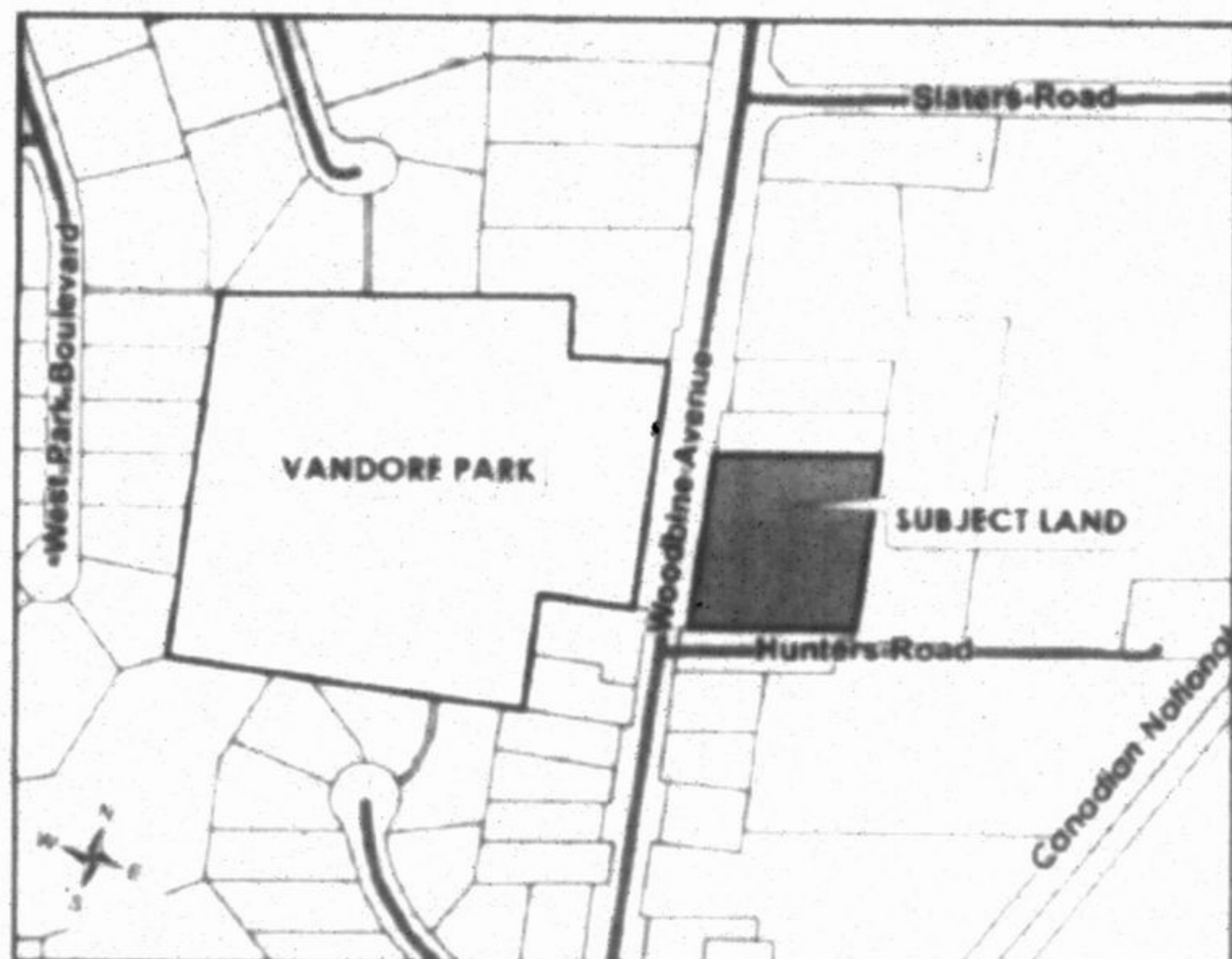

The staff report on this matter will be available from the Clerk's Department by noon August 19, 2011. Please address any inquiries to the Clerk, Town of Whitchurch-Stouffville at 905-640-1910 or 1-855-642-8697 x2224.

Dated August 11, 2011  
Michele Kennedy,  
Town Clerk

## UPCOMING EVENTS

### YRT/VIVA PUBLIC INFORMATION CENTRES

The Regional Municipality of York invites residents to attend upcoming York Region Transit (YRT/Viva) Public Information Centres throughout the month of August and provide input into the service planning process and receive an overview of its operational focus for 2012.

Town of Whitchurch-Stouffville  
Lebovic Leisure Centre  
August 22, 2011 5:00 p.m. to 7:00 p.m.

For more information and other dates and locations, please see their website at [www.york.ca](http://www.york.ca)

## RECRUITMENT

We are currently recruiting for the positions listed below. For more information on each position, please see our website at <http://www.townofws.ca/jobs.asp>

All resumes/applications to be sent to:  
Executive Assistant, Human Resources Services,  
Town of Whitchurch-Stouffville,  
111 Sandiford Drive,  
Stouffville, Ontario, L4A 0Z8  
or Fax: (905) 640-9259 or  
Email: [hr@townofws.ca](mailto:hr@townofws.ca)

### MANAGER OF CAPITAL PROJECTS

Please forward your resume in confidence, identifying position applied for, by August 26, 2011.

### PERMIT INFORMATION CLERK

Please forward your resume in confidence, identifying position applied for, by August 23, 2011.

### BABYSITTER - LEBOVIC LEISURE CENTRE

Please forward your application in confidence, identifying position applied for, by August 31, 2011.

For further information contact Barb Armstrong at [barb.armstrong@townofws.ca](mailto:barb.armstrong@townofws.ca) or 905-642-7529 ext. 328

### GROUP FITNESS INSTRUCTORS - LEBOVIC LEISURE CENTRE

Please forward your application in confidence, identifying position applied for.

For further information contact Barb Armstrong at [barb.armstrong@townofws.ca](mailto:barb.armstrong@townofws.ca) or 905-642-7529 ext. 328

*We thank all applicants who apply for these positions, but advise that only those applicants selected for an interview will be contacted. In accordance with the Municipal Freedom of Information and Protection of Privacy Act, personal information is collected under the authority of the Municipal Act, 2001, S.O. 2001, c.25, as amended and will be used for purpose of candidate selection.*

## REQUEST FOR PROPOSAL

RFP-11-37

### OPERATIONS AND ADMINISTRATION CONTRACTOR FOR THE STOUFFVILLE CEMETERY

The Town is seeking Requests for Proposal for an Operations and Administration Contractor for the Stouffville Cemetery. The document is available at the Customer Service counter at the Municipal Offices or online at <http://www.townofws.ca/bids.asp>

*Submissions will be accepted until 3:00 p.m. on  
Wednesday August 31, 2011.*

If further information is required, please contact Colleen Clarke, Cemetery Administrator at 905-640-1910 or 1-855-642-8697 x2225.



**DOWNTOWN STOUFFVILLE  
FARMERS' MARKET**  
2:00 p.m. - 7:00 p.m.  
EVERY THURSDAY ON PARK DRIVE  
(South of Main St.)

**WE HAVE MOVED TO:**  
**111 Sandiford Drive**  
**Stouffville, ON L4A 0Z8**



The Town of Whitchurch-Stouffville Municipal Offices have now moved to 111 Sandiford Dr.

To serve the public better, our new Customer Service Centre will be open from 8:00 a.m. to 5:00 p.m. for information and payment processing.

The Town now offers toll-free phone numbers for those living/working outside of the local calling area; these new numbers replace the previous Newmarket (895-XXXX) numbers. The local phone numbers remain the same:

- **905-640-1900 or 1-855-642-TOWN (8696)** to speak with a Customer Service Associate
- **905-640-1910 or 1-855-642-TOWS (8697)** for the automated attendant

Staff can now be contacted via a four-digit extension number or by adding a "2" in front of their existing extension number.

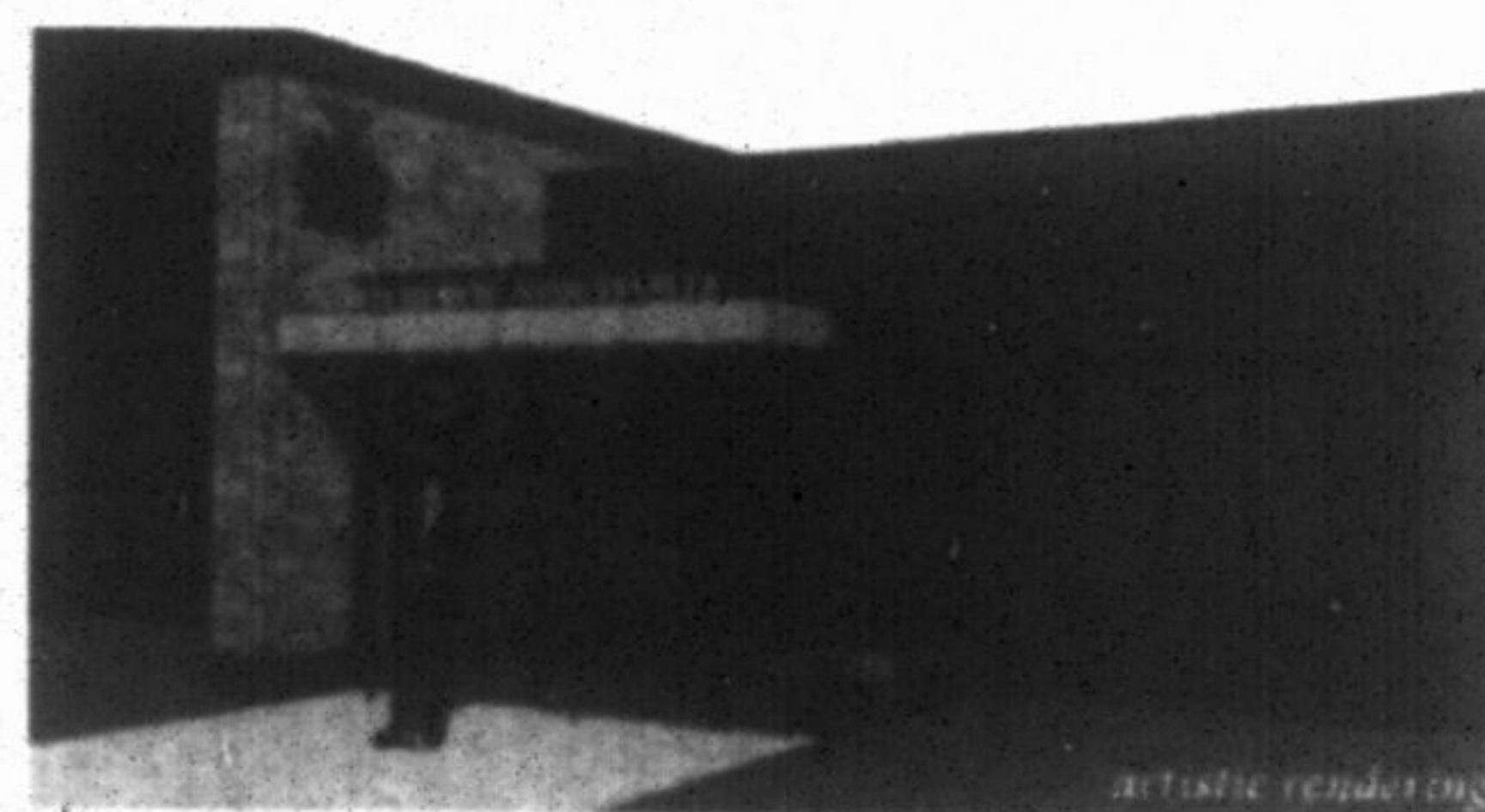

## UPCOMING EVENTS

### INSIDE WHITCHURCH-STOUFFVILLE THURSDAY, AUGUST 25<sup>th</sup>, 2011

Inside Whitchurch-Stouffville 2011 is being held in conjunction with the annual Moonlight Madness sale. Where: Civic Square in front of the Lebovic Centre for Arts & Entertainment - Nineteen on the Park.

Come meet various service groups, volunteer organizations and sports clubs that service the Town and hear how these groups help make Whitchurch-Stouffville a great place to live!

The following is a sampling of the groups and organizations that are participating:

Town of Whitchurch-Stouffville  
Whitchurch-Stouffville Chamber of Commerce  
Terry Fox Run  
Canadian Cancer Society  
Royal Canadian Air Cadets  
Stouffville Skating Club

### ARE YOU A COMMUNITY-ORIENTED, CHARITABLE, NOT-FOR-PROFIT ORGANIZATION?

Would you like to let people know more about what YOU have to offer? It is not too late to participate. For more information, please contact Gillian Angus-Trail at [gillian.angustrail@townofws.ca](mailto:gillian.angustrail@townofws.ca)

**Inside Whitchurch-Stouffville 2011**  
**THURSDAY, AUGUST 25<sup>th</sup> 7:00 P.M. to 9 P.M.**

Civic Square in front of the Lebovic Centre for Arts & Entertainment - Nineteen on the Park.  
Meet local groups that help make Whitchurch-Stouffville a great place to live!

