



Town of WHITCHURCH-STOUFFVILLE

37 Sandiford Drive, 4th Floor
Stouffville, Ontario L4A 7X5
905-640-1900 or 905-895-2423
www.townofws.com

Lebovic Leisure Centre 905-642-PLAY(7529) • Public Library 905-642-READ(7323) • Museum 905-727-8954 OR 1-888-290-0337

NOTICE OF COUNCIL MEETINGS

Council Chamber,
37 Sandiford Drive, 4th Floor
TUESDAY APRIL 20TH, 2010
COUNCIL MEETING 3:00 P.M.
PUBLIC HEARING 7:00 P.M.

Calloway Reit (Stouffville) Inc. ZBA09.016
Calloway Reit (Stouffville) Inc. ZBA10.002
1227891 Ontario Limited ZBA10.003

NOTICES

PROPOSED SALE OF PUBLIC LANDS

On May 4, 2010, Council will consider a further report regarding the sale of property at 6392 Main Street, Stouffville, (old Fire Hall) to Stouffville Hardware Ltd. This disposal process is part of a Request for Proposals issued by the Town in November, 2009.

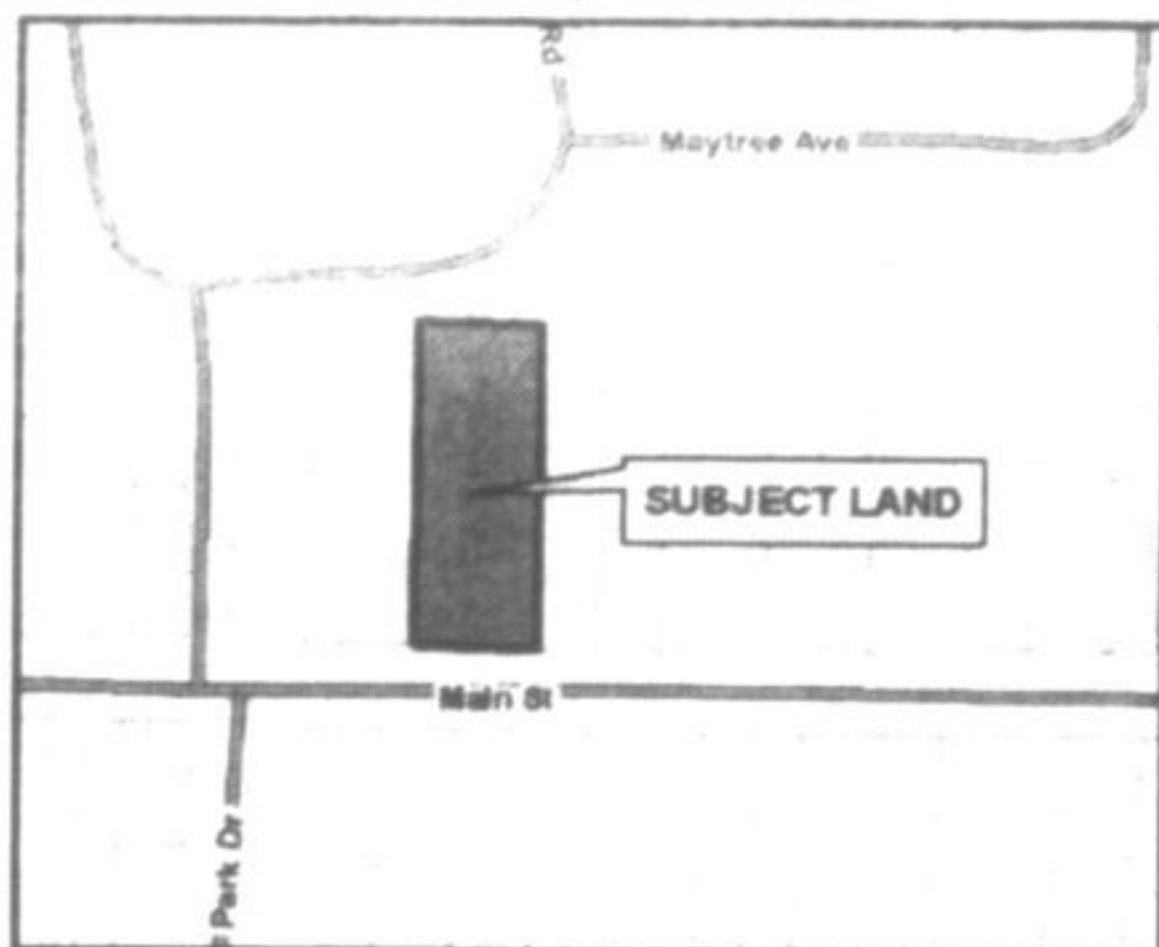

The staff report on this matter will be available in the Clerk's Department by noon on Friday, April 30, 2010. Please address any inquiries to the Clerk, Town of Whitchurch-Stouffville, at telephone (905) 640-1910 ext. 224.

Dated April 7, 2010
Michele Kennedy, Town Clerk

MUNICIPAL ENCROACHMENTS / DRIVEWAY ALTERATIONS

The Public Works Department reminds residents that the Town is **not** responsible for any damage caused during maintenance operations to items such as irrigation systems, gardens, fences, posts, interlocking brick work, concrete and wood curbs etc. that have been placed on Town property. The Town, at its discretion, may request the removal of these encroachments.

Residents and/or contractors are required to obtain an encroachment permit before any work is done on the Town Boulevards including the installation of gardens, interlocking brick work, concrete and wood curbs, driveway widening or alterations and/or the installation of irrigation systems.

If you have any questions, please contact the Public Works Department at 905-640-1910 or 905-895-5299 ext. 272.

FOR SALE

"AS IS, WHERE IS" - 1 (ONE) JORDAIR (BAUER) SCBA COMPRESSOR

The compressor, fill station and storage cylinders are contained in one integral cabinet. For viewing and bid forms please contact Assistant Deputy Bob Sumak at 905-640-9595 ext. 232.

For further details, please see our website at www.townofws.com/pdfs/Fire/CompressorSale.pdf

Closing date for bids is 4:30 p.m. April 30, 2010

TENDERS

TENDER WS-T-10-27 MILLARD STREET IMPROVEMENTS

Sealed tenders, clearly marked as to contents will be received by the Town Clerk until 3:00 p.m. local time on **Wednesday April 28, 2010.**

TENDER WS-T-10-24 SUPPLY AND DELIVERY OF TANDEM DUMP TRUCK EQUIPPED WITH PLOW AND SANDER

Sealed tenders, clearly marked as to contents will be received by the Town Clerk until 3:00 p.m. local time on **Wednesday April 28, 2010.**

REQUEST FOR QUOTATION WS-RFQ-10-21

DRAINAGE DITCH IMPROVEMENTS

Sealed quotations, clearly marked as to contents will be received by the Town Clerk until 3:00 p.m. local time on **Wednesday April 28, 2010.**

For details on the above tenders/quotations,
see our website at www.townofws.com/bids.asp

TENDER WS-T-10-05 MUSEUM VISITOR / COMMUNITY CENTRE CONSTRUCTION

Tender documents are available at the Municipal Offices, Clerk's Department, 37 Sandiford Drive, 4th Floor, Stouffville.

Tender submissions will be accepted until 3:00 pm,
Wednesday, April 28, 2010.

Whitchurch-Stouffville Museum Visitor / Community Centre Project Overview

The anticipated start date for Construction is May 2010, with completion in March 2011.

The Whitchurch-Stouffville Museum Visitor / Community Centre Project has been designed to enhance the Museum as a key element in the Town's leisure, culture and tourism strategy.

The new facility will boast flexible programming, exhibition and reception/office space to provide barrier-free connections to the existing Bogartown Schoolhouse and Vandorf Public School buildings.

The project size is estimated at approximately 9,000 square feet.

The design of the Whitchurch-Stouffville Museum Visitor / Community Centre includes:

- interior space with a seating capacity of 100
- upgraded kitchen facilities
- community group meeting and reception space
- enhanced programming space
- courtyard space for programming

A \$50.00 non-refundable cheque payable to the Town of Whitchurch-Stouffville is required per set of tender documents for this contract.

For further information, please contact Ms. Dorie Billich, Manager of Culture and Museum Services, at 905-640-1910 or 905-895-5299, ext. 294.

The Corporation of the Town of Whitchurch-Stouffville reserves the right to accept or reject any tender/quotation and also reserves the right to accept other than the lowest tender/quotation.

TENDERS CONTINUED

TENDER WS-T-10-29 SURFACE TREATMENT

Sealed tenders, in the envelope provided, clearly marked as to the contents will be received by the Clerk's Department, until 3:00 pm local time, on **Wednesday, April 28, 2010.**

The work shall consist of and include all labour, machinery and material necessary to execute and complete the following:

- SURFACE TREATMENT in accordance with the accompanying "Special Provisions" of the document.

The above description is general only and must not be construed as limiting the scope of work.

Quotations submitted by bidders are to contain the "Form of Tender" section of the document. For further information, please call 905-640-1910 or 905-895-5299 ext. 272.

TENDER WS-T-10-16

VICTORIA STREET RECONSTRUCTION

Tender documents will be available on April 21, 2010 at the Municipal Offices, Clerk's Department, 37 Sandiford Drive, 4th Floor Stouffville

Sealed tenders, clearly marked as to contents will be received by the Town Clerk until 3:00 p.m. local time on **Wednesday, May 5, 2010.**

The work shall consist of and include all labour, machinery and material necessary to execute and complete the following:

For details, see our website at www.townofws.com/bids.asp

*The Corporation of the Town of Whitchurch-Stouffville
reserves the right to accept or reject any tender
and also reserves the right to accept other than the lowest tender.*

CONSTRUCTION NOTICE

RUPERT AVENUE RECONSTRUCTION

Council has awarded a contract to Mar-San Contractors Inc. to reconstruct Rupert Avenue from Westlawn Crescent to Ninth Line. The work will commence in Mid-April and be completed by August 2010. The work includes installation of storm sewers together with curbs and gutters to replace the existing overland ditch drainage system, new asphalt pavement, and replacement of the existing sewer and watermain. A sidewalk will be provided on the north side of the street, and curb extensions will be constructed at the intersection of Rupert Avenue and Winona Drive to reduce the speed of traffic in the neighbourhood.

During construction the road will be open for local traffic only. Please consider an alternate route and exercise caution if you do travel through the construction area.

PARK DRIVE BRIDGE & ROAD EXTENSION

Construction of the Park Drive bridge and road extension south of Main Street continues in 2010. A new watermain and storm sewer as well as the parking lot and the north section of the road was substantially completed last year, and the work will now proceed with the road extension south of Burkholder Street and the new bridge crossing Stouffville Creek.

As part of this project, and in conjunction with the Memorial Park Master Plan, the toboggan hill at Thicketwood Boulevard will be removed and a new toboggan hill with a higher elevation and larger run-out area will be built on the south side of the new road.

Current efforts are focused on site grading with construction of the road and bridge expected to continue through to September.

EARTH DAY CELEBRATIONS • JOIN US AT THE STOUFFVILLE RESERVOIR
SATURDAY APRIL 17, 10:00 A.M. – 2:00 P.M.