

Click here for opinions

Hey Leaf fans: You're suckers!

I'm not sure if there are any sports fans in the world as stupid as Toronto Maple Leaf fans. And you know what? The corporate suits that own the franchise are counting on that as they count their millions.

They know that no matter what kind of pathetic product they throw on the ice at the Air Canada Centre they'll fill every seat. And next year, when they suit up another team of losers, they'll do it again.



Read John Slykhuis' "In the Right" in our BLOGS section

yorkregion.com
it clicks home

You'll find the rest of the story in John's blog on yorkregion.com

Rural mail trouble in House

BY JOAN RANSBERRY
Staff Writer

If you live in rural route York Region, problems linked to your mail delivery are about to be discussed in the House of Commons.

A motion addressing rural delivery concerns stemming from the Newmarket post office, which affect routes 1, 2 and 3 and Kettleby and include northern Whitchurch-Stouffville, have drawn the attention of the federal government by Oak Ridges-Markham MP Lui Temelkovski.

This past winter, hundreds of local rural residents experienced changes to the way mail was being delivered. For many, walking down the driveway to fetch the mail was no longer an option.

Instead, they had to get their mail from one of 90 community mail boxes spread throughout the area. For some, it means a six-kilometre drive.

"This has become a frustrating experience for some of my rural constituents," Mr. Temelkovski said. "Now this issue will be brought to the atten-

tion of the House (of Commons) where we can address it in a constructive way.

The motion will come up to debate in June and then will be further debated in the fall, Mr. Temelkovski said.

Problems came up when mail carriers at a Newmarket postal station complained driving country roads was becoming too dangerous.

The carriers filed a formal complaint stating they couldn't pull their cars far enough off the road to be safe from passing traffic, while sliding mail into traditional post-mounted boxes.

Human Resources Development Canada agreed with the carriers, which led to the community boxes.

The federal government is, however, appealing the decision.

While Mr. Temelkovski is pleased the government launched the appeal, he's asking other measures be taken in the meantime.

Putting steering wheels on the opposite side of mail delivery vehicles and adding cautionary lights could be examined, he suggested.

MARKHAM SUBARU SAVES YOU MORE THAN EVER!

\$0 ** DOWN PAYMENT ON LEASE

\$298 /Mo. IMPREZA

LEASE RATE FROM **0.8%** IMPREZA FOR 36 MONTHS APR

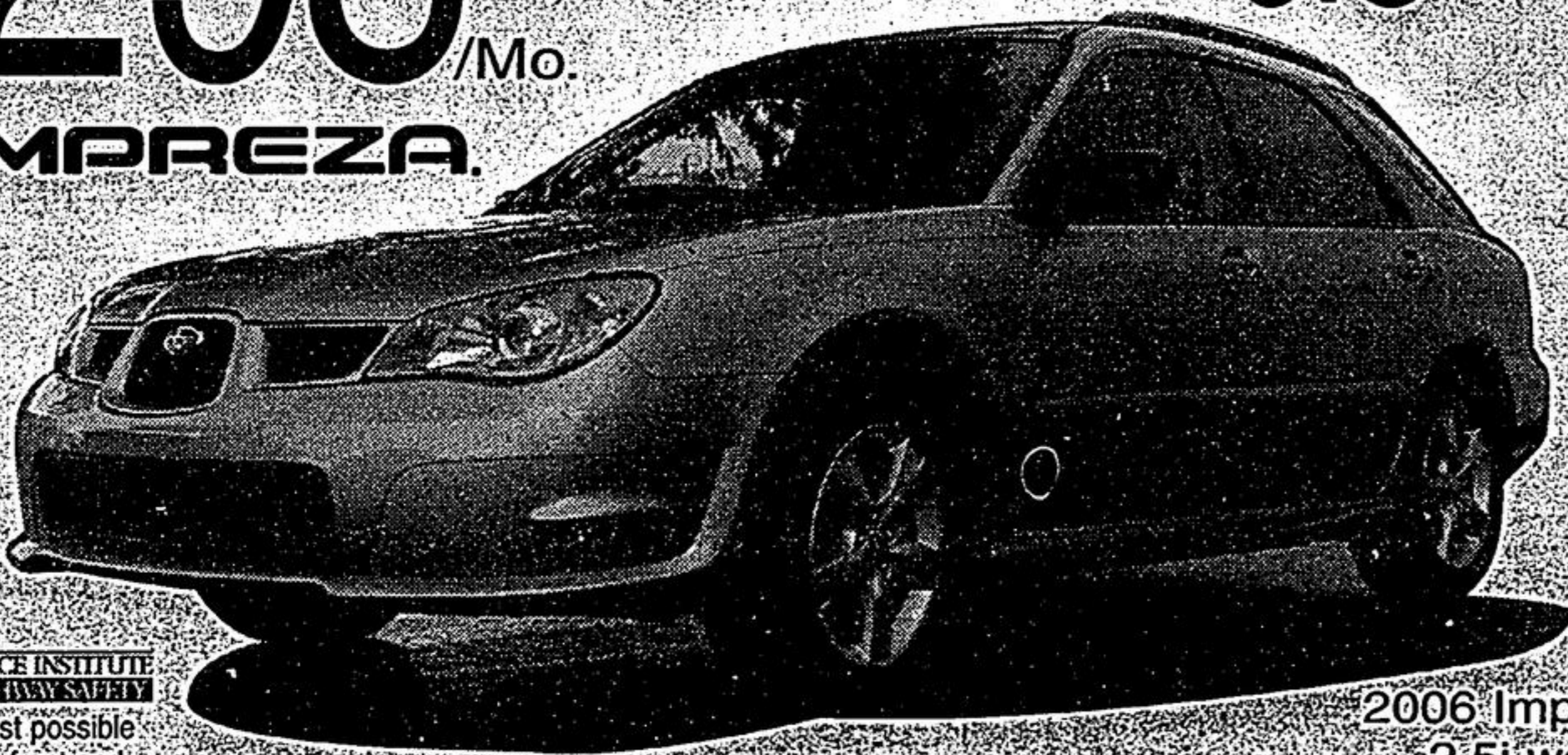

INSURANCE INSTITUTE FOR HIGHWAY SAFETY
*Highest possible rating in front and rear impact crash tests

2006 Impreza 2.5i wagon STARTING FROM \$23,495

Think. Feel. Drive.



SUBARU

MARKHAM

MARKHAM SUBARU

9401 Highway 48 North

1-866-874-4518

www.markhamsubaru.com

The Regional Municipality of York
WARDEN AVENUE (Y.R. 65)
MCCOWAN ROAD (Y.R. 67)
FROM STOUFFVILLE ROAD (Y.R. 14) TO BLOOMINGTON ROAD (Y.R. 40)
NOTICE OF INFORMATION CENTRE

The Regional Municipality of York is proposing to resurface Warden Avenue and McCowan Road this summer. The work will include expanded asphalt stabilization to recycle the existing asphalt pavement in place and add a fresh layer of hot mix asphalt as the finished surface. A Public Information Centre is planned for this project at the date and location shown below.

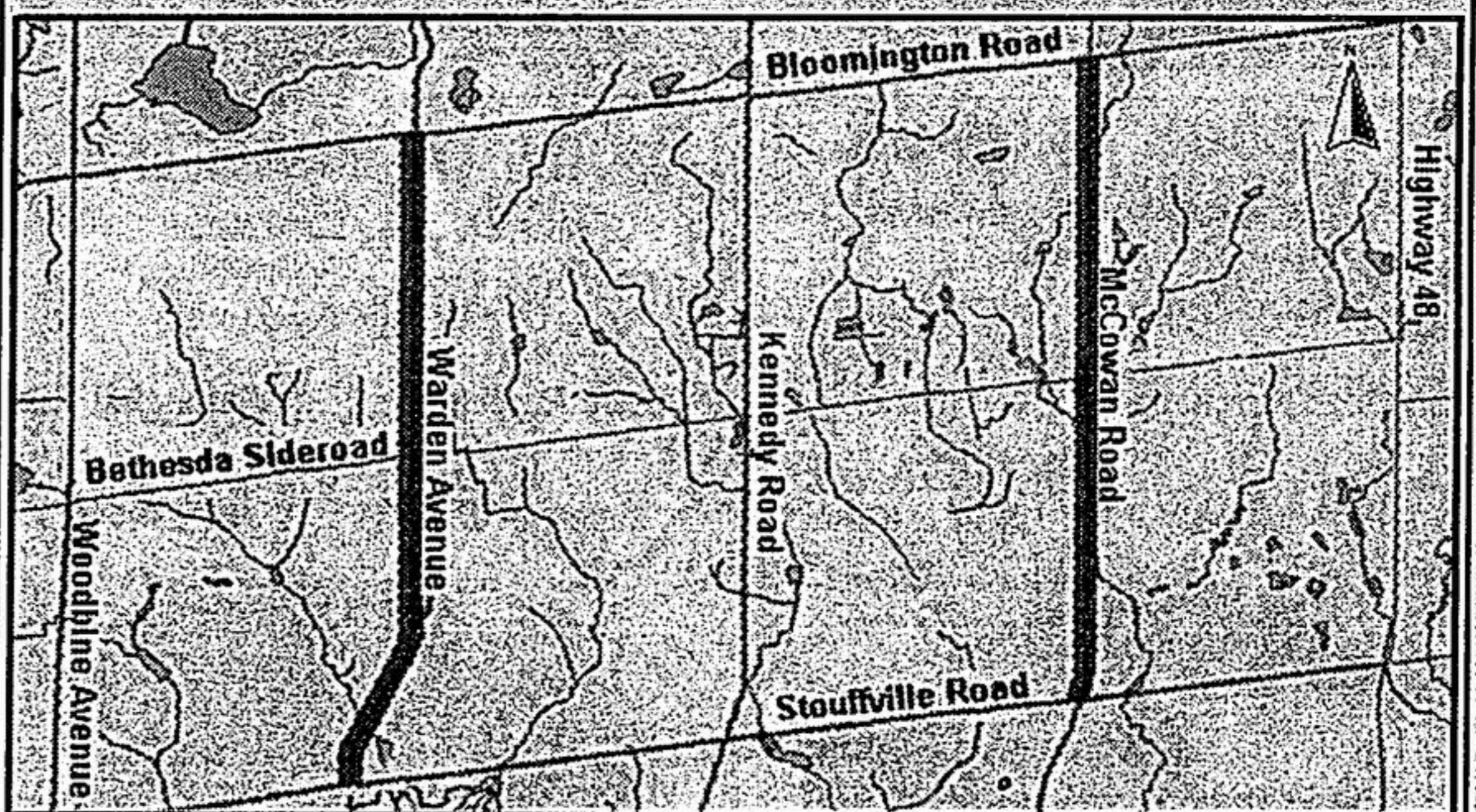

Date: Wednesday May 24, 2006
Time: 7:00 p.m. to 9:00 p.m.
Location: Lemonville Community Centre
13453 McCowan Road, Stouffville

Staff from York Region and the Town of Whitchurch-Stouffville will be available to explain the proposed work and receive comments. The Region is in the process of awarding the contract. Construction is scheduled to start by mid-June and finish by mid-August.

If you have any questions relating to this project, please contact either of the following Regional representatives:

Mr. Leonard Ng, P.Eng.
Manager, Pavements, Structures and Standards
Transportation and Works Department
The Regional Municipality of York
17250 Yonge Street
Newmarket, Ontario
L3Y 6Z1
Telephone: (905) 895-1200 Ext 5225
Toll Free: 1-877-464-9675
Fax: (905) 895-7735
E-mail: leonard.ng@york.ca

Mr. Nick McNamee, C.E.T.
Technologist
Transportation and Works Department
The Regional Municipality of York
17250 Yonge Street
Newmarket, Ontario
L3Y 6Z1
Telephone: (905) 895-1200 Ext 5226
Toll Free: 1-877-464-9675
Fax: (905) 895-7735
E-mail: nick.mcnamee@york.ca



*Car and Driver, March 2006; Forester, 2.5XT, Best small SUV. **Insurance Institute for Highway Safety (IIHS). See iihs.org for more details. 2006 Subaru Forester 2.5X model shown above. Leasing and financing programs available through GMAC. MSRP for 2006 Forester 2.5X (6J1 X0) is \$27,995 @ \$348 per month for 39 months with 0.8% lease rate and \$0 down payment. MSRP for 2006 Impreza 2.5i Wagon (6G1 RS) is \$23,495 @ \$298 per month for 36 months with 0.8% lease rate and \$0 down payment. Other rates and terms available. Low km lease based on a maximum of 20,000 km per year with excess charged at \$0.15/km. Offer applicable OAC. Dealer may sell for less. Freight/PDI, administration fee, licence, insurance, taxes, PPSA and registration are extra. Offer available at participating dealers only. See Dealer for details on other available leasing and financing options. Program expires May 31, 2006.