

Monitoring moraine's health hands-on experience

More than 25 Whitchurch-Stouffville residents got first-hand experience in monitoring water quality on the Oak Ridges Moraine.

The field day was a follow-up to community workshops held in Whitchurch-Stouffville and other municipalities in September as part of the Monitoring the Moraine program.

Residents of all ages waded into streams to identify and count tiny

Our Town with Hannelore Volpe

insects called benthic macroinvertebrates as a means of assessing the health of their habitat.

Harold Sellers, executive director of the Oak Ridges Trail Association, and Sonia Dong and Joyce Chau of Citizens' Environment Watch led the activities, which included checking

licens on trees as indicators of air quality.

The Monitoring the Moraine initiative is a partnership between Save the Oak Ridges Moraine Coalition, an organization instrumental in the creation of the ORM Conservation Act; Citizens' Environment Watch, a community-based monitoring organization and the Centre for Community Mapping, which provides communities with web informatics.

Next spring, Monitoring the Moraine organizers host workshops to train volunteers in scientific methods to track the health of local moraine features.

Volunteers will also be trained to track municipal compliance with the Oak Ridges Moraine Conservation Plan through collaboration with other groups along the moraine. For more information, contact: Mary McGrath, executive director, Citizens' Environment Watch 416-

978-4144 or Debbe Crandall, executive director, Save the Oak Ridges Moraine Coalition 905-880-3465.

Big Pipe concerns headed to council

Whitchurch-Stouffville residents and representatives from the Friends of the Rouge are bringing their water concerns to council Nov. 15.

The residents are part of a group that went to a Toronto council Oct. 20 to

ask Mayor David Miller that dewatering during the construction of the York Durham Sanitary Sewer System be halted until more information can be gathered on the long-range impact of the project.

Residents in Markham and as far north as Bloomington Road in Whitchurch-Stouffville have noticed water levels reaching unprecedented lows this summer.

For more information, call 905-640-3965 or 416-396-3292.

HYUNDAI 2006 Best Buys event

Over equipped with everything...including Value!



2006 Accent GS

- 1.6 litre DOHC engine • 5-speed manual transmission
- Power steering • dual front air bags • AM/FM/CD stereo
- and more.

Special Introductory Cash Price From **\$11,495***

MSRP \$12,995**



2006 Elantra GL

- 2.0 litre DOHC CVT engine • 5-speed manual transmission
- Dual front airbags • AM/FM/CD/MP3 stereo • 60/40 Split-folding rear seats
- 3-point seatbelts in all positions • Fully Independent suspension • and more.

Special Introductory Cash Price From **\$12,995***

MSRP \$14,995**

5-5-5 WARRANTY

5 YEAR/100,000 KM

COMPREHENSIVE LIMITED* • ROADSIDE ASSISTANCE** • POWERTRAIN

ALL HYUNDAI WARRANTIES HAVE NO DEDUCTIBLE. ** Includes fuel delivery service, flat tire changing, lock-out service, towing service and more. Just one toll-free call every 24 hours a day.

hyundaicanada.com



** 2006 Accent GS/Elantra GL MSRP starting from \$12,995/\$14,995. \$1,500/\$2,000 manufacturer to retailer credit is reflected in the cash purchase price shown in this advertisement. All cash and MSPP prices exclude freight (\$615) for Accent/Elantra, dealer administration fee, license, P.D.E. and all applicable taxes. Dealer admin and P.D.E. fees vary by dealer. All purchase offers are for a limited time. Dealers are free to set individual prices - see Dealer for full details. Hyundai's comprehensive Limited warranty coverage covers most vehicle components against defects in workmanship under normal use and maintenance conditions effective for vehicles sold.

MARKHAM HYUNDAI

4641 HWY #7, MARKHAM (at Kennedy)

SHOWROOM HOURS:

Monday-Thursday

9a.m.-9p.m.

Friday-Saturday

9a.m.-6p.m.

SALE HOTLINE

905-948-0080

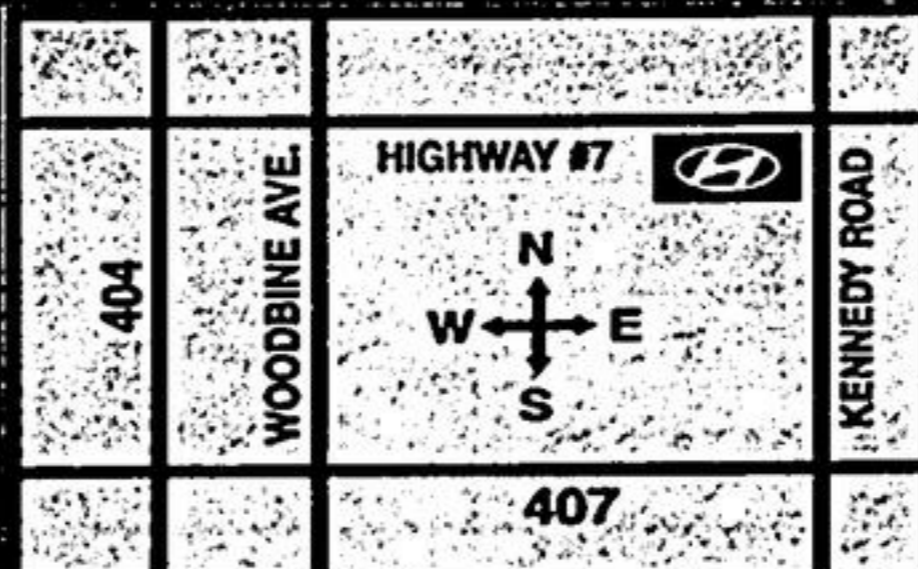

MARKHAM ECONOMIST & SUN & Stouffville Tribune
NEW ADDRESS & PHONE NUMBER ARE
145 RENFREW DRIVE, UNIT 160
MARKHAM, ONTARIO L3R 9R6
PH 905-513-1717 FAX 905-513-7525

FAST. AFFORDABLE. ALWAYS ON.
XPLORNET HIGH-SPEED INTERNET IS
EVERYWHERE IN CANADA.

Using the power of two-way satellite technology, every home in Canada can now get hooked up to the tremendous speed and reliability of Xplornet high-speed Internet. It's up to 75x faster than dial-up and doesn't tie up your phone line.

XPLORNET HIGH-SPEED INTERNET IS...

AFFORDABLE - satellite high-speed service that's competitively priced.

FAST - download up to 2 Mbps and upload up to 500 Kbps.

ALWAYS ON - you never have to log off; you're always connected.

RELIABLE - satellite technology provided by Telesat, one of the world's leading satellite operators.

We have a range of high-speed Internet packages to suit anyone's needs, with prices starting as low as \$54.99 per month. Contact your local dealer today for more information.

ANDREWS TV ANTENNAS & SATELLITE DISHES

671 Durham Road., 21, Uxbridge, Ontario
905-852-8896



www.xplornet.com

We'll mean the world to you.