

# CANADA DAY

*Come Celebrate With Us*



## Drive your dollar further summer sales event



**HYUNDAI**  
Drive your way

2005 Accent GS

MSRP \$12,995\*

**0%** Purchase Financing\* — OR — lease from up to 72 mos.

**\$139**

per mo./60 mos.  
\$1,595 Down Payment  
\$0 Security Deposit  
Freight & P.D.E. incl.



2005 Santa Fe GL

MSRP \$20,995

**0%** — OR — lease from **\$189** per mo./60 mos. • \$2,995 Down Payment • \$0 Security Deposit

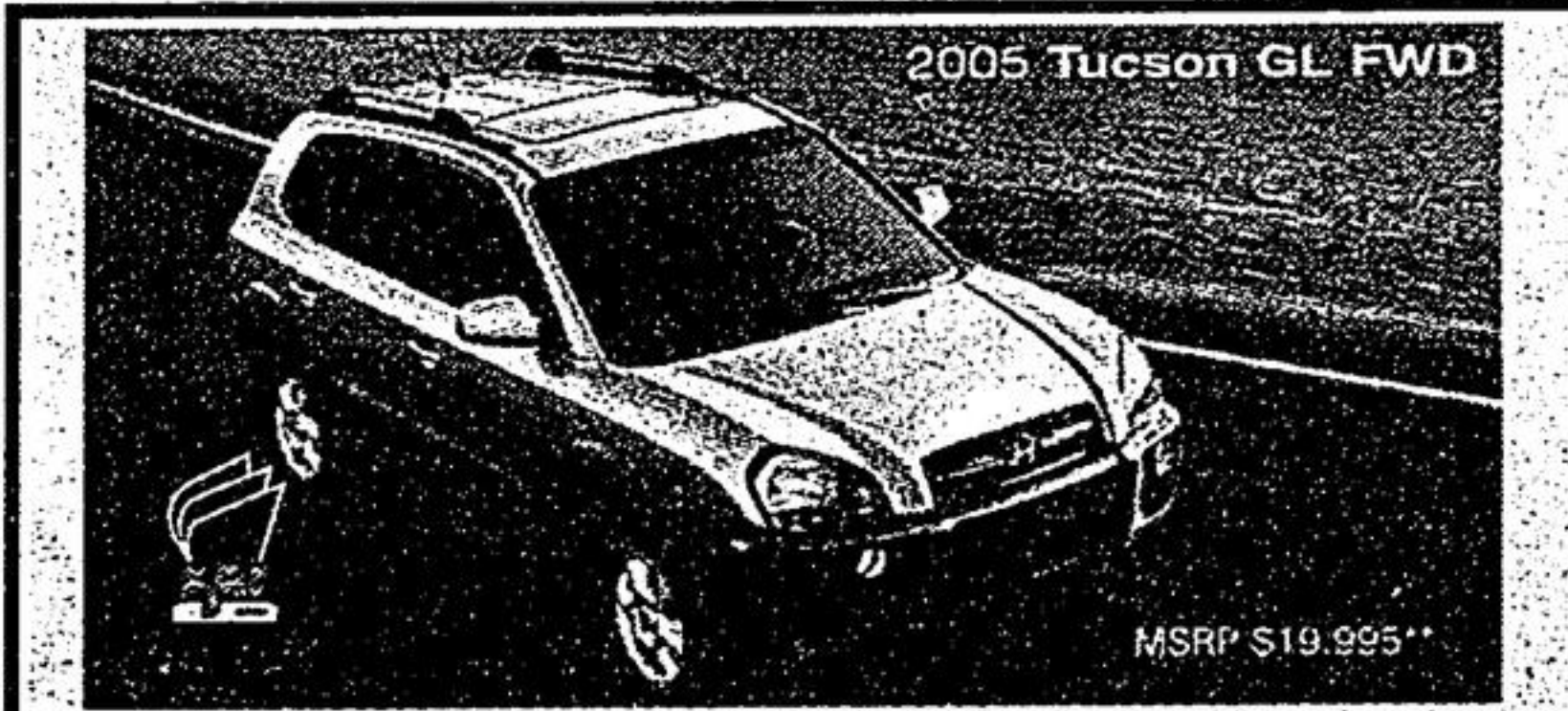

2005 Tucson GL FWD

MSRP \$19,995\*

**0%** — OR — lease from **\$189** per mo./60 mos. • \$2,995 Down Payment • \$0 Security Deposit

5 Year/100,000 km Warranty • Comprehensive Limited • Roadside Assistance • Powertrain

\*Some photos may not depict vehicle price featured. Leasing program available from Hyundai Financial Services based on new 2005 Santa Fe/Accent GS/Tucson GL. MSRP from \$20,995/\$12,995/\$19,995 annual interest rate of 3.78%/0.05%/4.00%. \$189/\$139/\$189 per month for a 60 month walk-away lease. Total lease obligation of \$14,335/\$9,335/\$14,235 and optional purchase price of \$9,238/\$3,938/\$8,182. Down payment of \$2,995/\$1,595/\$2,995 plus first monthly payment required. Zero security deposit on all models. Freight and P.D.E. for Accent included and extra for Santa Fe/Tucson. All applicable taxes, license and \$350 lease acquisition fee extra. 20,000 km mileage allowance per year applies. Additional charge of \$0.10/km. \*\*2005 Santa Fe/Accent GS/Tucson GL. MSRP from \$20,995/\$12,995/\$19,995. At purchase option for a limited time. Q.A.C. At cash purchase and MSRP price exclude freight, license, P.D.E. and all applicable taxes. Dealer may call for lease. 10% purchase financing available on all 2005 Santa Fe/Accent/Tucson models indicated Q.A.C. for 48/72/36 month terms. Financing example: \$15,000 at 0% per annum equals \$312.50/\$208.33/\$416.67 per month for 48/72/36 months. C.O.B. is \$0.00 for a total obligation of \$15,000. Limited time offer. See dealer for details.

# MARKHAM HYUNDAI

4641 HWY #7, MARKHAM (at Kennedy)

SALE HOTLINE

**905-948-0080**

### SHOWROOM HOURS:

Monday-Thursday  
9a.m.-9p.m.  
Friday-Saturday  
9a.m.-6p.m.

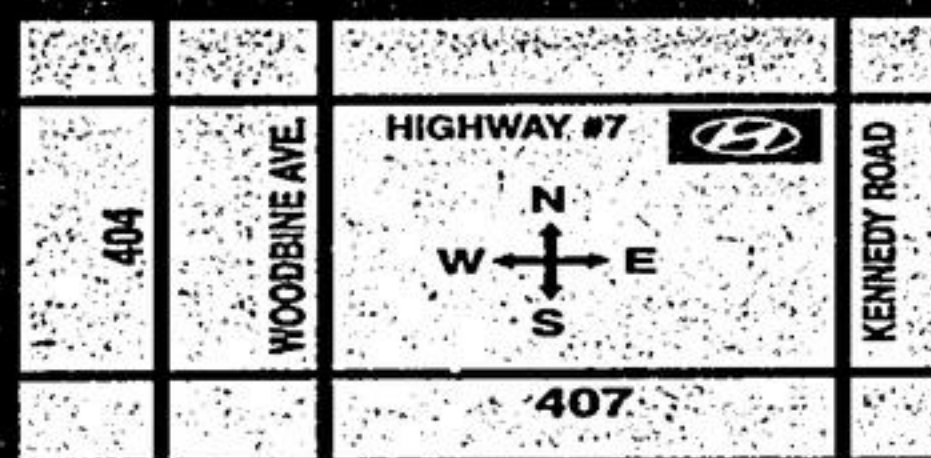

## COMMUNITY CALENDAR

Community non-profit groups in Whitchurch-Stouffville are welcome to place their coming events in this column at no charge. Please send your notice to Community Calendar at the Stouffville Sun-Tribune, Box 154, Stouffville, L4A 7Z5 (email jmason@ymg.com), or drop it off at the office, 34 Civic Ave., 3rd Floor. Deadline is Mondays at 6 p.m. Publication cannot be guaranteed but we will make every effort to ensure it is included. Please be brief.

### VOLUNTEERS

**Musical help:** The Bach to Blues Company is looking for an accompanist and new chorus members. Anyone who enjoys singing while raising money for worthy causes can call the music director at 905-649-2684.

**Whistle radio:** Volunteers are needed for a fundraising committee which is working to bring a community radio station to Whitchurch-Stouffville. For more information, call 905-640-8294, email whistle.radio@sympatico.ca or log on to www.whistleradio.com.

### NOTICES

**Schwarzli/Staley art show:** Whitchurch-Stouffville painter Josie Schwarzli and wood sculptor Bob Staley have an exhibition of their latest works at the Wellington Gallery, 32 Wellington St. W. in Aurora until July 10. The gallery is open Tuesday and Wednesday from 11 a.m. to 6 p.m.; Thursday from 11 a.m. to 8 p.m.; Friday from 11 a.m. to 6 p.m. and Saturday from 11 a.m. to 5 p.m. Call 905-751-0066 for more information.

**Extra Special at museum:** The Whitchurch-Stouffville Museum's summer exhibition, Extra Special Things, is on until Sept. 9. It features many artifacts not displayed before, highlighting the longest, shortest, and weirdest items in the museum's collections. The museum is at 14732 Woodbine Ave. in Vaudorf. Call 905-727-8954 or 1-888-290-0337.

### SPECIAL EVENTS

**TODAY**  
**Strawberry time:** The 21st annual Strawberry Festival is on until July 3. The Lions beef barbecue in the park is at 4:30 p.m. tonight; Canada Day festivities and fireworks in Memorial Park Friday, Main Street is closed for vendors, music and food on Saturday, the ecumenical church service and strawberry social are on Sunday. For more information, log on to www.strawberryfestival.ca

**FRIDAY**  
**Strawberry Festival euchre:** The Silver Jubilee Club hosts euchre and bid euchre at 1 p.m. at its club on Main Street at Market Street in Stouffville. All seniors welcome.

### SATURDAY, JULY 2

**Bike festival:** The Stouffville Lioness' Strawberry Festival bike decorating contest begins at 8:30 a.m. in the train station parking lot. The festival parade follows.

**Heritage train:** The York Durham Heritage Railway trains will make special runs all day at frequent intervals from Stouffville Train Station in the heart of the festival. The fare for these special shuttle trains is \$5 for all passengers (Infants under 1 year ride free).

### MONDAY, JULY 4

**Circus camp:** St. James Presbyterian Church, 6432 Main St. in Stouffville, hosts its annual vacation Bible school, Circus Extravaganza, for ages five and older. To register, call 905-640-6453.

### TUESDAY, JULY 5

**Pentecostal vacation Bible camp:** Stouffville Pentecostal Church, 6853 Main St., holds its summer Bible camp until July 10 for children aged five to 11. Call 905-640-5696.

### MONDAY, JULY 11

**Latcham summer art camps:** The Latcham Gallery's summer art camps for children start today. There are five sessions for ages five to 15. Youngsters work under the guidance of professional artists at the Art Bunker, 6297 Main St. in Stouffville (basement of the Silver Jubilee Club). Cost for full days is \$120 for gallery members and \$140 for non-members. For half days, the cost is \$80 for non-members and \$65 for gallery members. Call 905-640-8954.

### THURSDAY, JULY 14

**Local business meets:** The Whitchurch-Stouffville Chamber of Commerce is holding a meeting for local business owners to come up with new ideas for Stouffville's downtown and Main Street west. Registration begins 6 p.m.; the facilitated meeting starts at 6:30 p.m. in Latcham Hall, Park Drive South in Stouffville. For more information, call 905-642-4227.

### FRIDAY, JULY 22

**Summer sounds:** Heise Hill Brethren in Christ Church presents its summer concert and dessert night with Christian pop singer Bec Abbott and jazz artist Laila Biall at 7 p.m. Cost is \$12. The church is at 11760 Woodbine Ave. in Gormley.

MISSISSAUGA  
NOW OPEN

## Come Home to Amish Furniture Values.



## AMISH FURNITURE OUTLET LTD.



Mon, Wed, Fri 10:00am - 6:00pm, Sat 10:00am - 5:00pm, Sun 11:00am - 5:00pm  
1000 SHEPPARD AVE. EAST, UNIT 10, MISSISSAUGA, ONT. L4X 1L7