

HOW MANY SHOULD WE PUT YOU DOWN FOR?

0% Purchase Financing* up to 5 Years ON SELECTED MODELS



Hyundai Sonata: "Highest Ranked Entry Midsize Car in Initial Quality in the U.S."

2005 SONATA GL

LEASE FROM 0% OR \$215*

Purchase Financing* up to 5 years OR per mo./60 mos. \$3,595 Down Payment • \$0 Security Deposit



ONLY 2 LEFT

SANTA FE 3.5L GLS

BRAND NEW 2004 \$1000 GAS COUPON \$4000 CASH BACK

TIBURON Tuscani



ONLY 2 LEFT

2005 TUCSON GL FWD

2005 ACCENT GS



LEASE FROM 0% OR \$199*

per mo./60 mos. \$2,995 Down Payment • \$0 Security Deposit



LEASE FROM 0% OR \$139*

Purchase Financing* up to 48 months OR per mo./60 mos. \$1,995 Down Payment • \$0 Security Deposit • Freight & P.D.E. incl.

5-5-5 WARRANTY

5 YEAR/100,000 KM COMPREHENSIVE LIMITED* • ROADSIDE ASSISTANCE** • POWERTRAIN

HYUNDAI

ALL HYUNDAI WARRANTIES HAVE NO DEDUCTIBLE. ** Includes fuel delivery service, flat tire changing, lock-out service, towing service and more. Just one toll-free call away, 24 hours a day. hyundai.ca/canada.com

*Leasing program available from Hyundai Financial Services based on new 2005 Sonata GL/Tucson GL/Accent GS MSRP from \$22,385/\$19,995/\$12,995, annual interest rate of 2.47%/5.49%/1.10%, \$215/\$199/\$139 per month for a 60-month walk-away lease. Total lease obligation of \$16,495/\$14,995/\$9,995 and optional purchase price of \$15,200/\$9,995/\$4,291. Down payment of \$3,595/\$2,995/\$1,995 plus first monthly payment required. \$0 security deposit on all models. Freight and P.D.E. for Elantra included, extra for Sonata & Tucson. All applicable taxes, dealer administration fee, license and \$330 lease acquisition fee extra. 20,000 km allowance per year applies. Additional charge of \$0.10/km. **2005 Sonata GL/Tucson GL/Accent GS MSRP from \$22,385/\$19,995/\$12,995. All MSRP prices exclude freight, dealer administration fee, license, P.D.E. and all applicable taxes. Dealer may sell for less. Dealer order may be required on Tucson GL I-4 FWD. 10% purchase financing available on all 2005 Sonata models for 60-month term and on all 2005 Tucson and Accent models for 36/48-month terms. Financing example: \$10,000 at 0% per annum equals \$166.67/\$208.33/\$277.80 per month for 60/48/36 months. C.O.B. is \$10 for a total obligation of \$10,000.00. All purchase and lease offers are for a limited time, O.A.C. and may not be combined with any other offer. See dealer for details. Offer expires February 28, 2005.

MARKHAM HYUNDAI

4641 HWY. #7, MARKHAM (at Kennedy)

SALE HOTLINE 1-866-514-9000

SHOWROOM HOURS:

Monday-Thursday 9a.m.-9p.m. Friday-Saturday 9a.m.-6p.m.

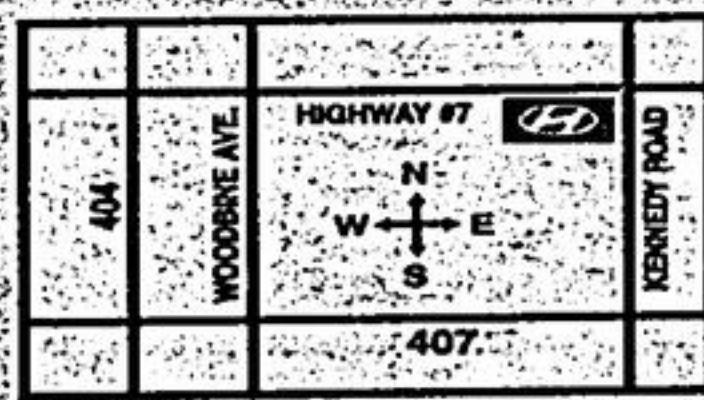

Charities still active helping Asian tsunami victims

BY MIKE ADLER Staff Writer

As international charities wind down tsunami fundraising, York Region residents remain committed to bringing long-term help to stricken Asian regions.

Members of a local relief mission are returning from Indonesia's Aceh province, where they started a medical clinic and hired local doctors and nurses to run it.

Giant waves that struck the area rolled five kilometres inland, leaving behind devastation resembling a nuclear attack, said Mohammad Alam, a Markham resident co-ordinating the joint effort for Greater Toronto Area mosques.

However, one good thing came out of the horror. "The whole world is working together," he said.

The 14 Sunni groups exceeded their \$1-million goal by more than \$500,000, Mr. Alam said.

The GTA's Hindu temples collected \$300,000 through their South Asian Earthquake Relief Fund and are waiting for another \$100,000, said fund chairperson Amar Ery of Markham.

The money would be used not for immediate relief but to build medical facilities, orphanages, homes and schools, she said, adding, "We knew right from the beginning that we will be involved in long-term relief projects."

Christian Blind Mission International, whose Canadian headquarters is in Whitchurch-Stouffville, has raised \$400,000 in Canada and sent \$100,000, mostly to provide food and water to tsunami survivors.

With 13 of its Asian projects damaged and one Sri Lankan clinic for the disabled destroyed, the group knows rebuilding will take years, executive director Dave McComiskey said. "We're still in major recovery mode."

Relief donations from people and governments amazed the world: Red Cross societies alone collected \$1.4 billion and two weeks ago declared it will not seek more.

The Medical Institute for Tamils in Canada has sent a second GTA relief team to Sri Lanka, including Dr. Rasiah Paramsothy, chief of psychiatry at Southlake Regional Health Centre, said institute trustee Dr. Arul Thangaroopan of Richmond Hill.

The group had collected at least \$160,000 in cash as well as supplies, he added.

Ahmadiyya Muslims in Canada have raised almost \$200,000, meeting their target and helping to keep camps open for medical aid, said Dr. Aslam Daud, national general secretary for the Maple-based community.

The UJA Federation of Greater Toronto raised \$1.4 million, including \$600,000 in medical supplies.

A cheque for the remainder was presented Tuesday to a distribution wing of the Jewish charity, public relations manager Rebecca Soberman said.

Inspired by the disaster, small groups and individuals are still responding with efforts of their own.

The Senior Tamils' Centre of Ontario raised \$9,000 at a North York community centre last week.

Attended by 600, a Toronto nightclub party last week organized by "an old group of Markville Secondary School students" from Markham gathered \$15,000.

On March 5, professionals from the Indian state of Kerala, the Malayalee Association of Social Workers of Ontario, host a variety program at Markham's Victoria Square Community Centre.

The 7:30 p.m. event will aid relief in Kerala through a college there, organizer Sajimon Joseph of Richmond Hill said.

Closer than you think. Only 18 miles from McCowan and Highway 7.

Rosemarie, Office

Why spend all weekend shopping for the right piece of furniture. Come here to choose your style, colour and size and enjoy your time off.

AMISH FURNITURE OUTLET LTD.



No Interest/No Payments Up To 6 Months