

# Drugs easy to find, students tell York pot conference

BY MITCHELL BROWN  
Staff Writer

She doesn't use it herself, but if Kristine Taylor ever wanted to try marijuana, she said it wouldn't be much of a hassle finding it.

"It would take about 10 seconds," the Maple High School student said.

"In school, people know the ones who have it and so they can go and find that person."

*'In school, people know the ones who have it (marijuana) and so they can go and find that person.'*

As for why nobody thinks of turning the dealers in, she asks, why would they?

"The students that know they don't care," she said.

"If they don't do it, they don't bother with that person. And if they do do it,

they're not going to go and tell on that person."

Ms. Taylor was one of about 250 students who attended the Youth Summit on Cannabis at Pierre Elliott Trudeau High School in Markham Wednesday, the first event of its kind in Canada.

Students from public, Catholic and private high schools across York Region were brought together with doctors, police officers and youth workers to discuss the legal and health risks involved in using marijuana.

"We're having an open dialogue with young people about a substance that, other than medical use, at this point is, in fact, still illegal," said Patricia Scott-Jeffroy of York Region Health Services, one of the organizers of the event.

"We're struggling with things appearing to be changing every day and so we've come together to discuss what is true, what is myth, what is fact."

Many students said they were surprised the speakers did not come out preaching about the evils of marijuana.

For instance, Stephen Meredith, an outreach worker with the Centre for Addiction and Mental Health (CAMH) in Toronto, spoke frankly with students about marijuana's relative harmlessness in relation to tobacco and alcohol, which both kill far more people than all illegal drugs combined.

Still, he said, "there are not a lot of organic substances you can light on fire, suck it into your body and not have problems with."

Research shows it's a

message more young people need to hear.

A 2001 CAMH study of student drug use found:

- almost 30 per cent of students in grades 7 to OAC reported using marijuana in the past year, compared to 23.6 per cent who reported smoking cigarettes;

- 22 per cent of marijuana users reported lighting up more than 40 times per year; and

- Student use in Ontario has increased every year since 1991 and is currently

the highest rate on record.

An updated study, expected to show even higher usage rates, will be released by the end of this month.

Kristen LeFave, a Grade 12 student at Huron Heights Secondary School in Newmarket, said the event was an eye-opener for her.

"Especially that quote about how smoking four or five joints is like smoking 20 cigarettes," she said.

"I was like, wow, I would never have thought that."

Ironically, the conference was held on the same day York Regional Police, acting on a tip from Markham Hydro, discovered 512 marijuana plants, worth more than \$500,000, and marijuana-growing equipment in a Soho Crescent house in Markham, just three kilometres from Pierre Elliott Trudeau High.

No one was home at the time and police are seeking suspects. Anyone with information is asked to call 905-881-1221 or Crime Stoppers at 1-800-222-TIPS.



**ACCOUNTABLE  
APPROACHABLE  
RESPONSIBLE**  
For a Healthy & Safe Environment  
**Vote Marilyn HEAD**  
REGIONAL COUNCILLOR  
905-477-1144

The Regional Municipality of York  
**TEMPORARY ROAD CLOSURE**  
**WOODBINE AVENUE (Y.R. 8)**  
Town of Whitchurch-Stouffville

Woodbine Avenue (Y.R. 8) will be closed to through traffic between Stouffville Road (Y.R. 14) and 19th Avenue, from 7:00 p.m., November 14, 2003 to 6:00 a.m., November 17, 2003 for the emergency replacement and repair of the concrete culvert and CSPA relief culvert.

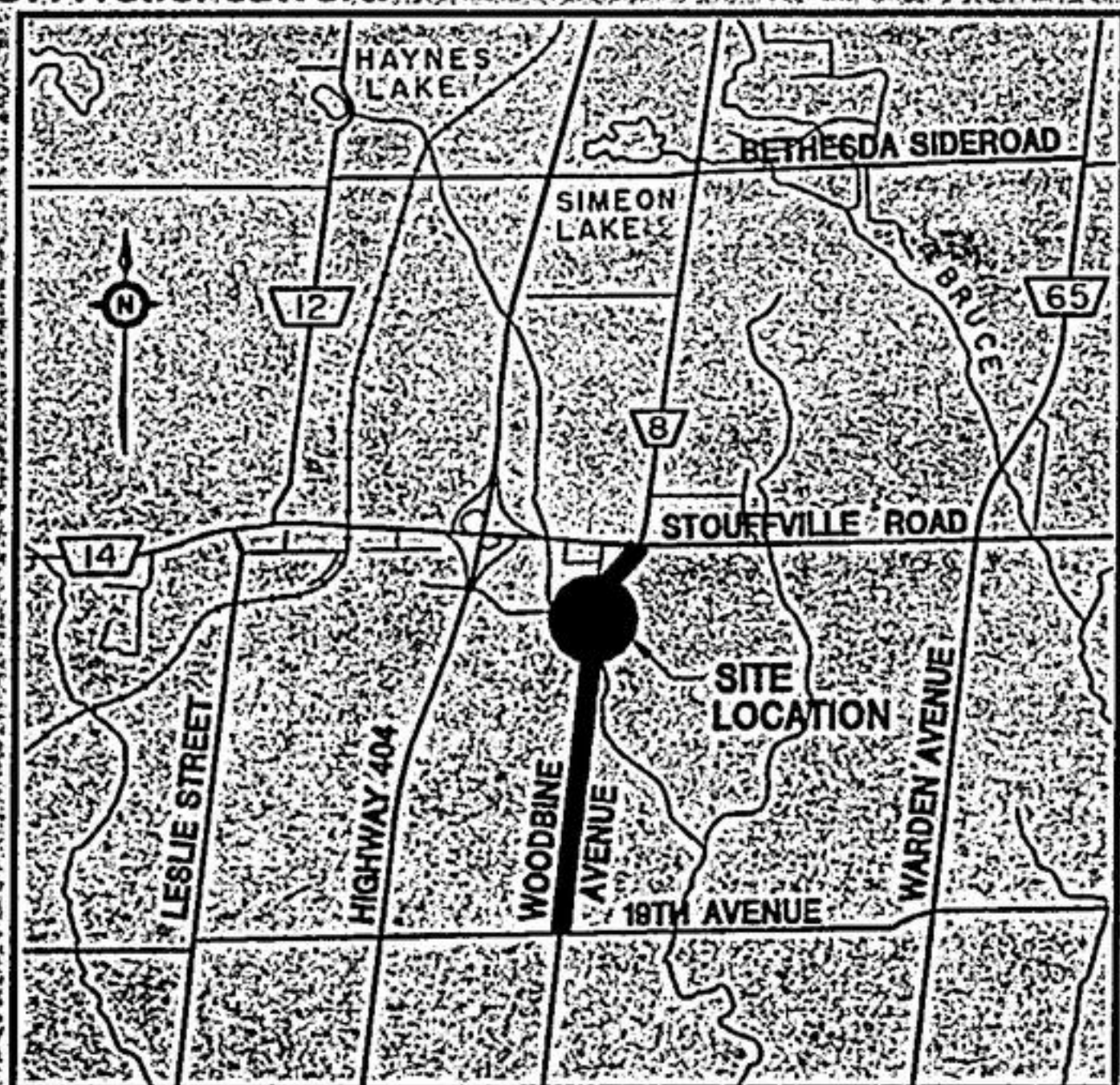

Please direct inquiries to:  
**Daniel Kostopoulos P.Eng.**  
Acting Manager, Engineering Transportation  
The Regional Municipality of York  
Transportation & Works Department  
17250 Yonge Street  
Newmarket, ON L3Y 6Z1  
Tel: (905) 895-1200 x5084  
Fax: (905) 836-4590  
Toll Free: 1-877-GO4-YORK

This notice issued on November 8, 2003.



## Mark Your Calendar! NOVEMBER 14-16

| November |    |    |    |    |    |    |
|----------|----|----|----|----|----|----|
| S        | M  | T  | W  | T  | F  | S  |
| 2        | 3  | 4  | 5  | 6  | 7  | 8  |
| 9        | 10 | 11 | 12 | 13 | 14 | 15 |
| 16       | 17 | 18 | 19 | 20 | 21 | 22 |
| 23       | 24 | 25 | 26 | 27 | 27 | 28 |
| 29       | 30 |    |    |    |    |    |

MARKHAM

CANADA'S ORIGINAL

**COUNTRY SHOW AND SALE**

**DECORATING**

Fri.-10am-9pm Sat.& Sun.-10am-5pm  
Join us at  
**CANADA'S ORIGINAL**

Display of Canada's Finest Juried Exhibitors offering "The True Essence of Country" Country Furnishings, Country Decorating Accents, Antiques, Country Clothes, Accessories, Country Crafts and Affordable Christmas Gift Ideas. Everything from A to Z to help decorate your home, garden and cottage for your Christmas "Country Hearts" Desire!

- HOURLY DOOR PRIZES
- FREE PARKING
- FREE CHILD-CARE CENTRE (2 & older)
- COAT & PARCEL CHECK
- ATM MACHINE



**4 BUILDINGS**  
**OVER 180 EXHIBITORS**



**MARKHAM FAIRGROUNDS**  
McCowan Road, 7 Km. North of Hwy. 7

Information: 905-982-1115

Admission: \$9.00 adult, \$8.00 senior, \$2.00 child, tax incl. (\$2.00 off coupon valid on adult & senior only)

### MEET SOME OF OUR DISTINGUISHED EXHIBITORS

- |                               |                                    |                            |                                     |                               |
|-------------------------------|------------------------------------|----------------------------|-------------------------------------|-------------------------------|
| A Raft of Craft               | Country Bags & Tags                | Hagerman Fine Art          | Muskoka Soap Company                | Something Extra               |
| A Simpler Time                | Country Clutter                    | Hare Hugs and Kitty Kisses | Needles and Nails                   | Something Special             |
| Adri's Chocolates             | Country Heartfelt Interior Design  | Heritage Sign Company      | Nilli                               | Sparta Classics               |
| Alpha Critters                | Country Home Custom Pine Furniture | Home Time Country Crafts   | Nor Van Woodcrafts                  | Sparta Country Candles        |
| Anastasia's Design            | Art of Walter Campbell             | Homemade Cafe              | Northern Lights Rustic Crafts       | Spring Creek Pottery          |
| Aunt Annie's Attic            | Country Side Cupboard              | Huron Sands Hotel          | Ogidaki Mountain Country Collection | That Added Touch              |
| Auntie Essie Creations        | Craft Magic                        | Preserves                  | Old Cart Co                         | The Bountiful Basket          |
| Bark Creek Crafts             | Crafty Creations                   | Indulgences                | Old English Cookie and Fudge Co.    | The Country Corner            |
| Bay Window Country            | Creating Christmas Memories        | Inspiration                | Once In A Blue Moon                 | The Country Workshop          |
| Bent Creations                | Curlew Table Linens                | Inta Lights                | Peddler's Post                      | The Hen House                 |
| Berry Ellen Reversible Coats  | D & D Crafts                       | Irene's Pottery            | Penhargett Pantry                   | The Lobo Paintings            |
| Black Creek Woodcrafts        | D & L Crafts                       | J & H Creations            | Photo Decor by Christine            | The Orange Crate Food Co.     |
| Butcher Block                 | Danny Pollak Accessories           | Jaboli II                  | Pineneedle Enterprises              | The Original Muskoka Lantern  |
| C.I.M. Crafts                 | Deer Ridge Farm                    | Kanboo K.I.D.S.W.E.A.R.    | Pipestone Studio                    | The Popcorn Lady              |
| Caja Creations                | Divine Intervention                | Kaymade Handmade Quills    | Play 'N' Wear By Sharon             | The Rusty Dragonfly           |
| Callagan's Crafts & Treasures | Earthly Pleasures                  | Kettleby Treasures         | Playmates                           | The Saltbox Shoppe            |
| Calligraphy From The Heart    | Fair Oaks Crafts                   | Kilmeny's Folk Art Studio  | Quality Quilts & Gracie's Baking    | The Victoria Basket           |
| Carol B Dolls                 | Floral Design By Ursel Nyga        | Kim Kraft                  | Quilts And Creations                | The Wandering Bean            |
| Carole's Designs              | Full O Beans                       | Kincaides Fine Foods       | R.A. Moberley                       | Timbercreek Country Furniture |
| Catherine Simpson Fine Art    | G & S Guay Handmade Tinware        | Klasson Brass              | Rebecca's Valentines                | Tracy's Wine Jellies          |
| Century Old Crafts            | Gaby Monsalves                     | Kool Kraft                 | Ring Imports                        | Tree House Kidswear           |
| Childhood Memories            | Gage & Co. Country Designs         | Lapivity Boxes             | Rittermere-Hurst-Field              | Val's Best Gifts              |
| Chocolate Sensations          | Gingerbread Studio                 | Larry Bondy Woodworking    | Rowanree                            | Valen Enterprises             |
| Christmas Country             | Girdwoods                          | Larina Inc.                | Sandpiper Creations Canada          | Victoria Anne Heirlooms       |
| Christmas in the Country      | Gourmet Cheese Platters            | Lena's Gifts               | Shaw Woodcarving                    | Victoria's Wicket Gourmet     |
| Cook's Gourmet                | Grand Flags                        | Let's Get Personal         | Shaw's Creek                        | Wood Wishes                   |
| Country Accents               |                                    | Marilyn's Crafts           |                                     |                               |
| Country Affair Candles        |                                    | Mia Lane Artist            |                                     |                               |
|                               |                                    | Mill Pond Loft Inc.        |                                     |                               |
|                               |                                    | Moore Design               |                                     |                               |