

MPP Klees will fight to keep 'doublehatter' firefighters

From page 1.

risk. The IAFF wants communities to hire full-time firefighters. "I agree from a safety standpoint," said Mr. Winters, siding with his union.

Mayor Emmerson is especially worried about how the defeat of Bill 30 will affect the town financially. "This is going to have a big impact on our fire department and ultimately on our (town) budget," said Mayor Emmerson. "This is very unfortunate. I am so disappointed."

'I maintain it's the legislature's responsibility to ensure no one in this province is subjected to intimidation by their union for volunteering.'

Deputy Fire Chief Tim Beckett spent a good part of this week dealing with the potential fallout from the vote by Ontario MPPs. Whitchurch-Stouffville, with a population of about 23,000, has 54 firefighters. Six work full-time and are members of IAFF Local 4152. Of the 48 volunteer firefighters, 16 are double-hatters.

"It may result in a loss of experienced firefighters," said Deputy Fire Chief Beckett. "It may result in a loss of our senior firefighters. It may mean the loss

of leadership on the force because six of my captains fall into the double-hatter category."

In the interest of public safety, "the 16 double-hatters should not be let go at one time," stressed Mr. Winters. "A slow phase-out would be the best approach. From a health and safety concern, the double-hatters should be gone. But it should be a slow and planned phase-out process. We're not going to put public safety at risk. I would like the oppor-

Ontario government warned it may still take action regarding the double-hatters. "I maintain it's the legislature's responsibility to ensure no one in this province is subjected to intimidation by their union for volunteering," said Mr. Klees. "I will continue to work with my colleagues to ensure the rights of volunteer firefighters are protected."

Heavy Duty Sewing Machines

•UNDELIVERED SCHOOL ORDER•

Singer Sewing Machine Company ordered these machines in anticipation of LARGE SCHOOL SALES. Due to budget cuts, these sales are undelivered. These Deluxe Singer Machines must be sold. All Machines are heavy duty and sew on all fabrics, denim, canvas, upholstery, nylon, vinyl and silk. These sewing machines are manufactured by Singer Sewing Machine Company. Your choice while supply lasts. All merchandise subject to prior sale. These machines are suitable for home, professional or classroom. **EVEN SEWS ON LEATHER!** These Deluxe Singer Machines are new with a 25 year warranty. With these new Singer machines you just set the dial and see magic happen, straight sewing, zigzag, buttonholes (any size); invisible blind hem, monogram, satin stitch, embroidery, appliqué, sew on buttons. WE ACCEPT VISA, MASTERCARD, CASH & CHEQUES. AMERICAN EXPRESS DEBIT CARDS. PHONE ORDERS TAKEN.

WITH THIS AD \$299
COMPARE AT \$799

4 DAYS ONLY!

- ★ 32 stitch functions
- ★ Heavy Duty - FREE ARM
- ★ Front DROP IN BOBBIN
- ★ SIMULATED SERGING STITCH

SINGER®

Monday - Friday 9 - 8:00, Saturday 9 - 4:00
11 SIMCOE ST. S. OSHAWA 905-433-1140

Christmas Hours

OPEN SUNDAY 11:00-5:00

REGISTERED TRADEMARK OF THE SINGER COMPANY LIMITED



Prices effective at Unionville IGA only From Sat. Dec. 14 until closing Fri. Dec. 20/02

WOW!!
Maxwell House Coffee **\$3.99** 1 kg Tin

Minute Maid Frozen Orange Juice **2 for \$1.00** 355 ml

Chef Style Prime Rib Roasts **\$4.99** lb.

Pillers Smoked Boneless Hams **\$2.69** lb.

Crisp Head Lettuce **.99¢** ea.

Sliced Fresh at our Deli Cooked Ham **.55¢** 100g

Great for Lunches Toronto Bagels **\$1.39** pkg of 6

Baked Fresh! On Premises Baguettes **.99¢** ea.

We Have The Best Party Trays! Place Your Orders Today (905) 475-8020

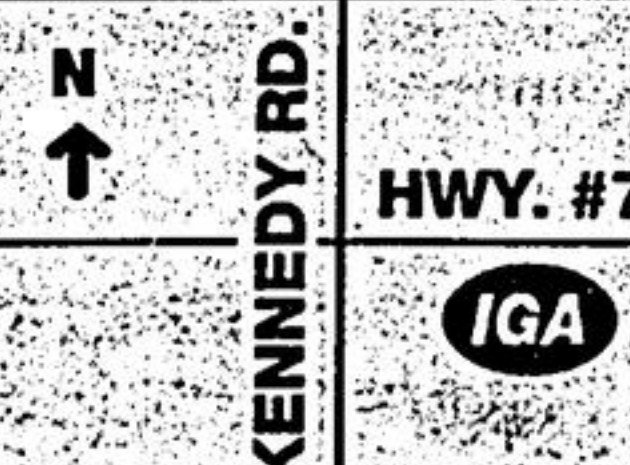

ARRIVE ALIVE... Please Don't Drink and Drive



This message brought to you as a community service of The Economist & Sun/Tribune

Christmas Special

Expires Dec. 24/02

12 month adult membership **\$399**

12 month student & senior membership **\$349**

1 month membership **\$49**

3 month membership **\$99**

The Works
Fitness & Aerobics Centre

Since 1992 • www.worksfitness.com



190 Bullock Drive • Markham • (905) 471-7871

Must be activated by January 31, 2003. Current members of less than 6 months not eligible. GST extra.