

SPIKE IN TORONTO CASELOADS COULD AFFECT YORK REGION FUNDING

Reserve funds will cover demand

From page 5.

downward trend. In fact, the region has seen welfare dependency decline steadily since the Mike Harris government assumed power in 1995.

But August saw a 1.3-per-cent increase over the same month in 2000, up to 3,994 cases from 3,942 last August. And September saw a greater jump — up slightly less than 4 per cent from the same period last year, to 4,012 cases in 2001 from 3,857.

That's cause for concern — and a symptom of an economic downturn — but not indicative of a trend yet, according to Joann Simmons, commissioner of social services and housing.

'We want to talk to the people who make these social policies and draw their attention (to the issue) and let them know.'

"That's the first time we've had that kind of an increase in quite a while," Simmons said. "It's too early to say whether it's a trend."

If a serious spike in the demand for welfare occurs, the region is covered, Simmons said. York has \$26 million in a reserve fund dedicated to social services costs.

But York's welfare costs aren't the only factor that may affect funds here: social services are among the pooled GTA expenditures for which the region is responsible. That means a dramatic increase in claims in Toronto would have an effect here.

Meanwhile, the region has an effective infrastructure in place, including a successful Ontario Works program, to help people break the welfare cycle and find employment, Simmons said.

For Rodgers, the increased demand at food banks means individuals and families are not able to make ends meet,

whether they're on social assistance or working at low-paying jobs. That's an issue her organization is trying to address.

"We want to talk to the people who make these social policies and draw their attention (to the issue) and let them know," she said.

ON SALE SAT. DECEMBER 8 TO FRI. DECEMBER 14, 2001

bulk barn

SUPER SPECIALS

pitted, large Ashlock Prunes 1.99 lb (4.39 kg)	roasted, salted or unsalted Whole Cashews 5.99 lb (13.20 kg)
loose pack Pitted Dates .99 lb (2.19 kg)	selected varieties including macaroons and rosebuds Neilson Bulk Chocolate 2.99 lb (6.59 kg)
original, bbq, cheese or salsa ranch Bits & Bites 2.79 lb (6.15 kg)	Thompson Raisins 1.29 lb (2.85 kg)

PLUS 19 IN-STORE SPECIALS EVERY WEEK

ON WEDNESDAY SENIORS SAVE 10% ON THEIR TOTAL SHOPPING BILL, EXCLUDING SPECIALS.

MARKVILLE MALL (905) 475-7220 FORTINOS SUPER MALL (905) 475-3299 FAIRVIEW MALL (416) 498-7541



ARRIVE ALIVE...

Please Don't Drink and Drive

This message brought to you as a community service of The Economist & Sun/Tribune

Pictures, Mirrors & Custom Framing

UP TO 70% OFF

FRAME EXPRESS GALLERY

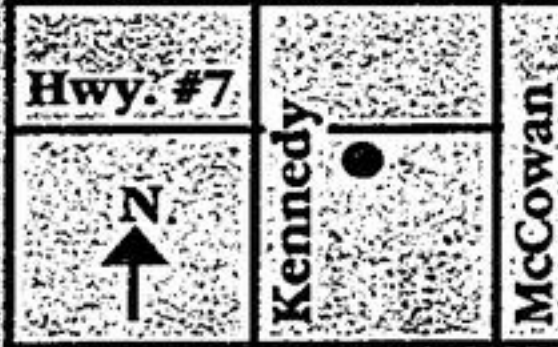

4721 Hwy. #7 (IGA Plaza) 905-474-9008

FREE Photo Frame with purchase over \$100

Business Hours: Mon - Wed 10-7, Thurs - Fri 10-8, Sat 10-6 - Sun 1-5

Gift Certificates Available

2 Hr. Framing Service



Col. Mustard's PUB & DELI

LIVE

Sat., December 8th **REMINISCING**

NEW TIME JACKPOT KARAOKE Sunday @ 8 pm

PRIVATE QUARTERS AVAILABLE Call for reservations

Book Your Christmas Party Now

Visit our website for more details: www.colmustards.com

6545 Hwy #7 E. of Wooten Way 294-4925



SING and SAVE!

JOIN US FRI. DEC 7TH FOR AN OLDE FASHIONED CAROL SING ACCOMPANIED BY OUR 1890'S PUMP ORGAN. STEP BACK IN TYME 8:00 PM - 10:00 PM

PLUS OLDE TYME CHRISTMAS SPECIAL

- All FASHIONS 20-50% OFF
- CHRISTMAS DECORATIONS 40% OFF
- SEAGULL PEWTER 30% OFF

See you at the parade.

159 Main St. Unionville

7 Days A Week (905) 477-4077



SMALLEY'S CHRISTMAS TREES

Cut your own / Spruce or Pine Professionally Trimmed
\$15⁰⁰ Pine - any size
\$20⁰⁰ Spruce - any size

TREE BALING AVAILABLE

Pop, hot dogs & sausages Free hayride, coffee & hot chocolate on weekends

OPEN DAILY 9AM TO DUSK

SMALLEY'S CHRISTMAS TREES

7201 Durham Rd 30 Lots of off road parking (905) 473-2864 (905) 473-9229

