

Adenoma, Hepatic necrosis, Hepatitis A, Hepatitis B, Herpes simplex hepatitis, Hers' disease, Histiocytosis X, Idiopathic cirrhosis, Leiomyosarcoma, Mononucleosis, Peliosis hepatitis, Porphyria variegata, Primary hepatic

FIGHT OVER 100 DISEASES WITH ONE DONATION
 These are just a few of the over 100 liver-related illnesses that threaten the lives of more than 2 million Canadian men, women and children. For 25 years now, the Canadian Liver Foundation has been leading the fight against liver disease and to continue we need your help.
 One simple act of kindness can go so very far.
 This message brought to you as a community service of The Economist & Sun/Tribune.

1320 Yonge Street,
 Suite 301
 Toronto, Ontario
 1-800-563-5483

QUALIFYING YOUNG DRIVERS!

Young Drivers + State Farm Insurance = 30% savings on Auto Insurance Rates

We reward QUALIFYING YOUNG DRIVERS

- GOOD STUDENT DISCOUNT
- MULTI-CAR DISCOUNT
- DRIVER TRAINING
- MULTIPLE DISCOUNT

FOR YOUR 15th BIRTHDAY YOU CAN SAVE UP TO 30% OFF YOUR AUTO INSURANCE!

Like a good neighbour, State Farm is there.®
 statefarm.com®

State Farm Mutual
 Automobile Insurance Company
 Canadian Head Office:
 Scarborough, Ontario

 Andrew McTaggart, Agent 190 Bullock Drive, Unit 3 Markham, Ont. (905) 294-6357	 Keith Jupp, Agent 3 Centre Street, Ste. 201 Markham, Ont. (905) 294-1562	 Joanne Freeman, Agent 9275 Markham Road Markham, Ont. (905) 294-7415
 John Calovic, Agent 548 Carlton Rd., Unit 204 Markham Ont. (905) 477-7244	 Shobha Srinivas, Agent 3321 McNicoll Ave. Scrb., Ont. (416) 332-4944	 Greg Neely, Agent 2900 Warden Ave. Ste. 240, Scrb. Bridlewood Mall, (416) 491-6333

45,000 tons of equipment junked this year: IBM

From page 12.

dents at three hazardous waste depots for recycling by EPR.

And IBM Canada, which has long given its customers the chance to recycle used products, recently expanded its commercial recycling program to include any obsolete equipment, whatever the brand, if a small fee is paid.

There are about 10 million computers in Canada, each with a lifespan of three to five years.

IBM expects Canadians to throw out 45,000 tonnes of computer equipment this year.

IBM first tries to sell cast-off equipment on a client's behalf. Failing that, the company will buy it and later issue a certifi-

cate of destruction, since clients want to be certain their data won't fall into the wrong hands, said Blake Jones, manager of the program, which can be reached at 905-316-3252.

The commercial program, however, is only for "mid-and large-sized customers."

ELECTRONICS DEPOTS

Here's where and when York Region residents can bring electronics — including computers, monitors, printers, electronic games, VCRs, digital cameras, radios, photocopiers and electronic calculators — for recycling.

Markham Household Hazardous Waste Depot, Rodick Road (on Wednesdays and Saturdays)

East Gwillimbury Household Hazardous Waste and Recycling Depot, 95 Bales Drive (on Tuesdays and Saturdays).

Georgina Waste Transfer Station, 23068 Warden Avenue (Monday through Saturday)

Ordinary consumers must pay the company \$50 to recycle their PCs and peripherals.

Environmental advocates in California, pointing out manufacturers are now required to recycle such products sold in all European Union countries, charge that such customer-pay programs as IBM's are doomed to fail.

A report by York region staff concludes that "most residents will consider this cost (to recycle) to be too high and therefore, the IBM program will not divert a substantial quantity of waste from disposal."

Jones said the electronics industry continues to move toward smaller products. "The physical poundage is going down dramatically," he said.

YORK REGION'S PERMANENT HOUSEHOLD HAZARDOUS WASTE DEPOT

CLIP & SAVE THIS AD!



POISON
 Pesticides, Chemicals
 Rat poison, Bleach
 Pharmaceuticals
 Cleaning fluids



CORROSIVE
 Batteries
 Drain cleaners
 Oven cleaners



EXPLOSIVE
 Aerosols
 Propane cylinders



FLAMMABLE
 Paints, Solvent
 Oils, Gasoline
 BBQ starter

What to do:

1. Look under your kitchen and bathroom sinks, in the medicine cabinet, tool shed, garage and basement. You'll probably find all kinds of cleaners, waxes, detergents, cosmetics, expired prescriptions, solvents, paints, bug killers, oils and grease, etc.
2. Make sure all materials are in original containers or contents are very well marked on containers.

Do not mix different products together. Be sure that all containers are capped. Please remember that your containers must be deposited with waste materials and are not returnable.

HOURS OF OPERATION FOR 2001

WEDNESDAYS
 10:00 a.m. - 6:00 p.m.
AND SATURDAYS
 8:30 a.m. - 4:30 p.m.
 (EXCEPT STATUTORY HOLIDAYS)

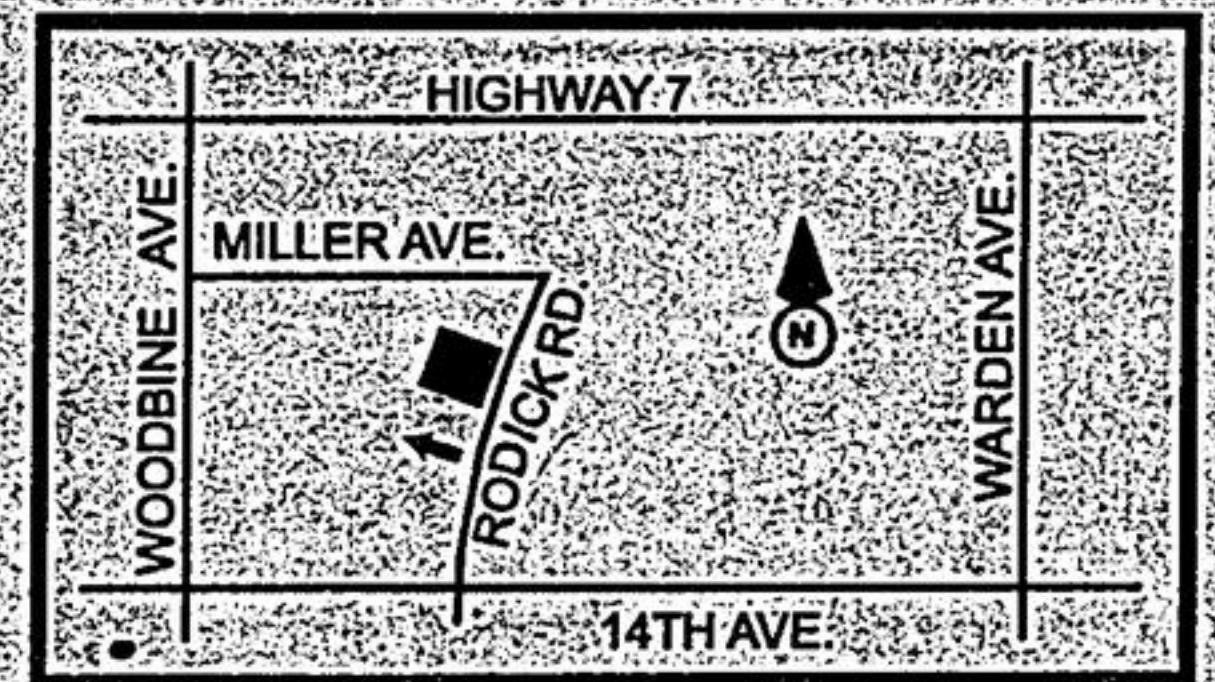

TOWN OF MARKHAM

Please Note:

- York Region residents only (proof of residence is required)
- There is no charge for this service.
- No commercial, industrial or medical office wastes accepted.
- No explosives (other than the above types), ammunition, PCBs, or radioactive wastes accepted.
- Needles and syringes from household medicinal use will be accepted in rigid containers only. No other pathological wastes will be accepted.
- Motor vehicle batteries and oil filters will be accepted.
- Tires, regular garbage, scrap metal, large metal appliances, cardboard and yard waste will not be accepted.

If you require further information:

Call York Region at (905) 764-6345 or 1-877-464-9675, extension 3039

Visit the York Region web site at: www.region.york.on.ca



An exciting new Member course from ClubLink, Station Creek Golf Club.

If you truly love the game, no other experience comes close.

Incredible golf and a remarkable feeling of privilege. For golfers who want it all, ClubLink is the only place to be.

ClubLink is proud to announce a new addition to its collection of outstanding Member Golf Clubs. Station Creek, located 3 minutes from Highway 404 and Stouffville Side Road, will boast two 18-hole championship courses. With this low introductory offer of only \$7,500* you too can become a Silver level ClubLink Member.

For more information about Membership and our low introductory offer please call:

1 800 661 1818.

*For a limited time.



CLUBLINK.ca