

Only Research can cure Leukemia  
Only Excellence in Canadian Research  
is funded by LRF

1110 Finch Ave. W., Ste. 222,  
Toronto Ontario M3J 2T2  
Tel. (416) 661-CURE (2873)  
Fax (416) 661-3840

**LEUKEMIA RESEARCH FUND CANADA**

This message brought to you as a community service of The Economist & Sun

# Ward 5: noise at the country market an ongoing concern for residents

BY HANNELORE VOLPE  
Staff Writer

The "old" part of Stouffville with its many well-maintained historic homes on tree-lined streets takes in the bottom section of Ward 5.

Here Councillor Judy Scala is having her place on council contested by long-time public school trustee and chair Harry Bowes.

This ward runs from Ninth Line east to Durham Road 30, and from Stouffville Rd. north to south of Vandorf Rd.

This is the most densely populated of Whitchurch-Stouffville's six wards with 3,342 eligible voters. Many young families, as well as a substantial number of seniors, live in the downtown core.

Truck traffic is abundant on Bloomington Rd. thanks to several active gravel pits in the area, raising traffic safety concerns. A substantial estate residential area is nestled around the Sleepy Hollow Golf and Country Club on Tenth Line. This ward is home to the Stouffville Country Market, to newer subdivisions east and west of Tenth Line north of Main Street, and to the historic section of town.

Neighbours to the Country Market have brought ongoing concerns to council for a number of years regarding noise bylaw infractions and the uses allowed at the market. It's an issue that is unlikely to go away unless addressed seriously by the new council members.

Traffic, as in the other wards, is an

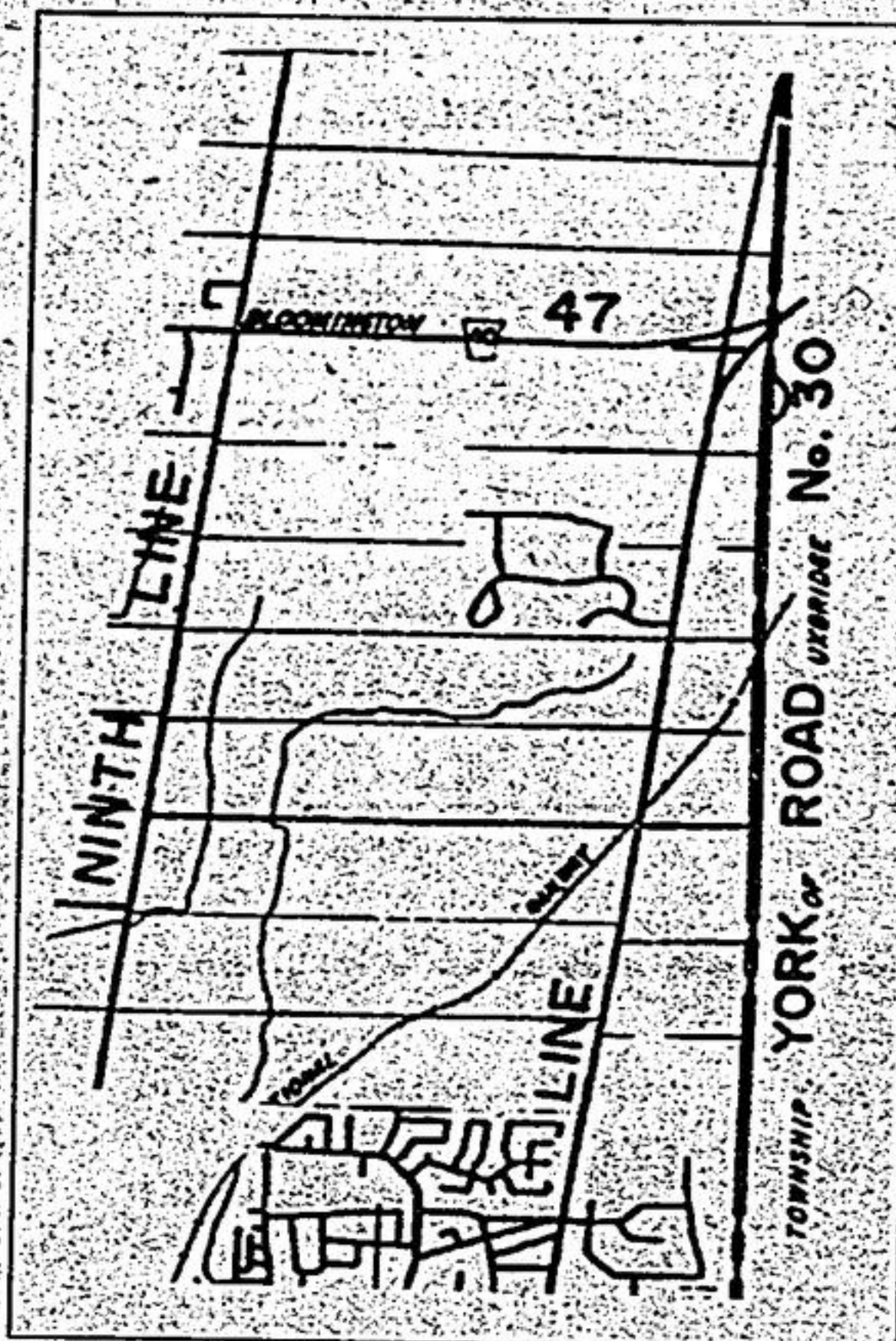

ongoing concern. Main Street traffic continues to increase as more people move into the area. On Saturday mornings there is a line of cars heading to and from the Country Market. Weekdays, the cars are lined up in true downtown fashion, crawling along Main St. for at least an hour each morning and evening.

Concerns about vandalism remain in the downtown core, according to local business owner Mario Petramala. But the new satellite police station soon to be set up at the Stouffville Train Station

is a step in the right direction. He also applauds the Main Street Vision Committee and the B.I.A.'s renewed efforts. But because their initiatives are in the beginning stages, "We have not seen results yet," Petramala said. "They are trying."

In talking to his clients, many of whom live in the downtown area, he believes this is a low-key type of election. "There is not a big, big issue for most people."

For other residents, there are still questions about the process leading up to the new indoor pool and library building's construction. Many residents think their views weren't heard. There were "gray areas" in communication coming from the town, said resident Peter Guinane.

With many young children in this ward, and more than 1,200 of them expected to play soccer next year, the dearth of town-owned fields will be something for new politicians to fix.

The number of empty buildings in town is growing, too. Council will have to decide what to do with the soon-to-be-vacated library on Main Street.

Since the Clock Tower Theatre committee recently failed in its bid to bring a cultural centre for Stouffville, there are no immediate plans for singing at the old Civic Ave. municipal building - it remains empty.

Residents are also concerned about a permanent location for the Latcham Gallery.

# Ward 6: traffic, development pressures becoming a concern

BY HANNELORE VOLPE  
Staff Writer

Ward 6 takes in the southern half of downtown Stouffville as well as some rural lands to the west.

Current Councillor Sue Sherban is being challenged by Mark Dewar.

Things have become quieter in the ward since Residents Information Group (RIG) members did a municipality-wide survey regarding who wanted the new indoor pool and library combined into one and located at the 17-acre South Park site at the end of O'Brien Ave.

Feelings both for and against the new facility ran high for a time. They may become a factor at election time.

New councillors will have to figure

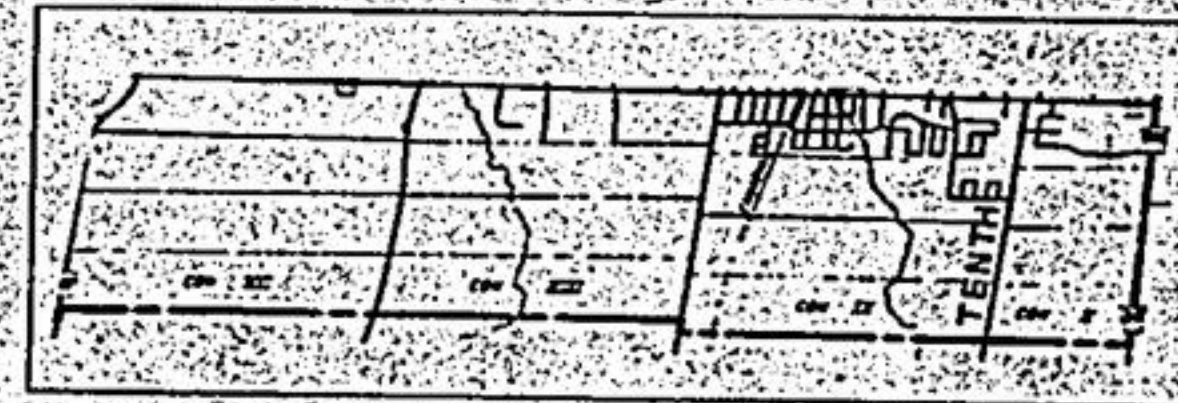

out whether and how to keep the current outdoor pool operating when the indoor facility opens.

According to RIG member Bryan Millsip, the first issue now facing this ward is the increased traffic in town.

With the new pool/library complex catering mainly to drivers, the problem could become worse, he thinks.

Development pressures could compromise the historic quality of the downtown core, residents think.

— With files by Joan Ransberry

## TD EVERGREEN

### Investment Workshop & Boot Camp How To Make Money in Stocks

- Common mistakes that investors make
- How & when to buy stocks
- Pinpointing the most explosive stocks
- The importance of earnings and revenues
- Where to find good information
- How & when to sell and take profits
- The best two indicators to time the market

Guest Speaker:  
Bradley J. Wise  
CIM, FCSI  
Vice President



Place: Angus Glen Golf Club

Date: Wed. Nov. 1st, 2000 7:00 PM

RSVP: 1-888-799-8771 or 905-707-2043

Admission\*: \$10.00 - Proceeds to Charitable Foundation

CAN'T MAKE IT? CALL US FOR OUR  
NEXT PRESENTATION DATE!

\*Trademark of TD bank. TD Evergreen is a division of TD Securities Inc., a subsidiary of TD Bank and a licensed user of TD Bank trademarks. TD Securities Inc. Member CIPF.

## Daewoo Richmond Hill

# LOOK Super Deals

### On All Remaining 2000 Models

**THE ALL NEW Nubira**  
SX SEDAN \$16,700\*

- 2.0L DOHC Engine
- Air Conditioning
- Power Windows & Locks
- Power Remote Heated Mirrors
- Sony AM/FM Stereo CD
- Fog Lights
- Rear Defroster w/Timer
- Variable Intermittent Wipers
- Driver's Seat Height Adjustment
- Dual Airbags
- 60/40 Split Rear Seat
- Carpeted Floor Mats
- 5-Speed Manual Transmission

**Leganza**  
SX SEDAN \$20,600\*

- 2.2L DOHC Engine
- 4 Speed Automatic Transmission
- 4 Wheel Disc Brakes
- Air Conditioning
- Power Windows & Locks
- Remote Keyless Entry w/Security
- Alarm
- Sony AM/FM Stereo CD
- Cruise Control
- Fog Lights
- Power Remote Heated Mirrors
- Leather Wrapped Steering Wheel
- Reclining front seats w/lumbar support
- Driver's Seat Height Adjustment
- Carpeted Floor Mats

**Lanos**  
HATCHBACK \$12,750\*

- Dual Airbags
- Driver's Seat Height Adjustment
- Sony AM/FM Stereo Cassette
- Variable Intermittent Wipers
- Rear Defroster w/Timer
- Rear Wiper/Washer
- Power Steering
- Carpeted Floor Mats
- Chrome Exhaust Tip
- 5-Speed Manual Transmission
- 9.0L/100km (31 MPG) - City
- 5.9/100km (48 MPG) - Highway

# Special interest Rate

# 0%

PURCHASE FINANCING UP TO 48 MONTHS ON ALL REMAINING DAEWOO 2000 MODEL YEAR CARS. (2.9% for 60 months) OAC.

**DAEWOO RICHMOND HILL**  
11623 Yonge Street, Richmond Hill 905-508-8009

All prices plus freight, PDI, admin, licence and taxes. Lease prices available on request. Offers expire October 30, 2000. OAC.

### The Right Technology - The Right Price

<p><b>Presario E2200</b></p> <ul style="list-style-type: none"> <li>• Intel Celeron 500</li> <li>• 64MB RAM</li> <li>• 17GB Hard Drive</li> <li>• 40x CD-ROM Drive</li> <li>• CD Rewritable Drive</li> <li>• 56K Modem</li> <li>• WIN 98</li> <li>• Factory Refurbished</li> <li>• 1-Year Warranty</li> </ul> <p>Lower Price! Monitor &amp; Speakers extra <b>\$899.99</b></p>	<p><b>Presario 5451</b></p> <ul style="list-style-type: none"> <li>• AMD K6-500</li> <li>• 96MB RAM</li> <li>• 13GB Hard Drive</li> <li>• CD Rewritable Drive</li> <li>• 56K Modem</li> <li>• WIN 98</li> <li>• Factory Refurbished</li> <li>• 1-Year Warranty</li> </ul> <p>Lower Price! Monitor &amp; Speakers extra <b>\$899.99</b></p>	<p><b>Presario 5834</b></p> <ul style="list-style-type: none"> <li>• Intel Celeron 500</li> <li>• 64MB RAM</li> <li>• 17GB Hard Disk</li> <li>• 8x DVD Drive</li> <li>• CD Rewritable Drive</li> <li>• 56K Modem</li> <li>• WIN 98</li> <li>• Factory Refurbished</li> <li>• 1-Year Warranty</li> </ul> <p>Lower Price! Monitor &amp; Speakers extra <b>\$1199.99</b></p>
--	--	---

Bring in this Ad and get a Free Package of 10 CDR Disks with any of the Presario's featured in this advertisement. (While quantities last)

Wireless Accessories available here. See all our stock online at [pcoutlet.com](http://pcoutlet.com)

45A West Wilmot St., Unit 16  
Richmond Hill, Ont L4B 2P2  
Tel: 905-707-7337  
**1-800-500-3692**  
[www.pcoutlet.com](http://www.pcoutlet.com)

**NOW OPEN SATURDAYS**

**STORE HOURS:**  
Mon - Fri 9:00 am - 6:00 pm  
Sat 10:00 am - 5:00 pm

## Be a Big Brother

it's kids stuff.

905-727-1251

This message brought to you as a community service of Economist & Sun/Tribune