

COLDWELL BANKER - Expect the Best™ COLDWELL BANKER - Expect the Best™ COLDWELL BANKER - Expect the Best™ COLDWELL BANKER - Expect the Best™



COUNTRY LANE REALTY

(905) 985-7351



\$119,900
AUTO BODY
 Thriving auto body shop, paint booth, government approved ventilation, excellent location.
 Call Ralph Fairman**, 905-985-7351.



\$279,900
BUSINESS OPPORTUNITY
 Great family operation, convenience, store/ice cream parlour with highway frontage. Good building plus great living accommodations. Call for full details. Ralph Fairman**, 905-985-7351.



\$179,900
3/4 ACRE LOT
 Nearly new 3 bedroom brick bungalow, open concept kit. & dining, finished lower level with air tight wood stove, oversized double garage. Great value at \$179,900. Call Ralph Fairman**, 905-985-7351.



\$16,900 **WORLD**
POTENTIAL
 NAME IT, WE SELL IT, THE BUSINESS KNOWN AS "CASH WORLD" specializing in used merchandise. Stock & business, \$16,900. Call Ralph Fairman**, 905-985-7351.

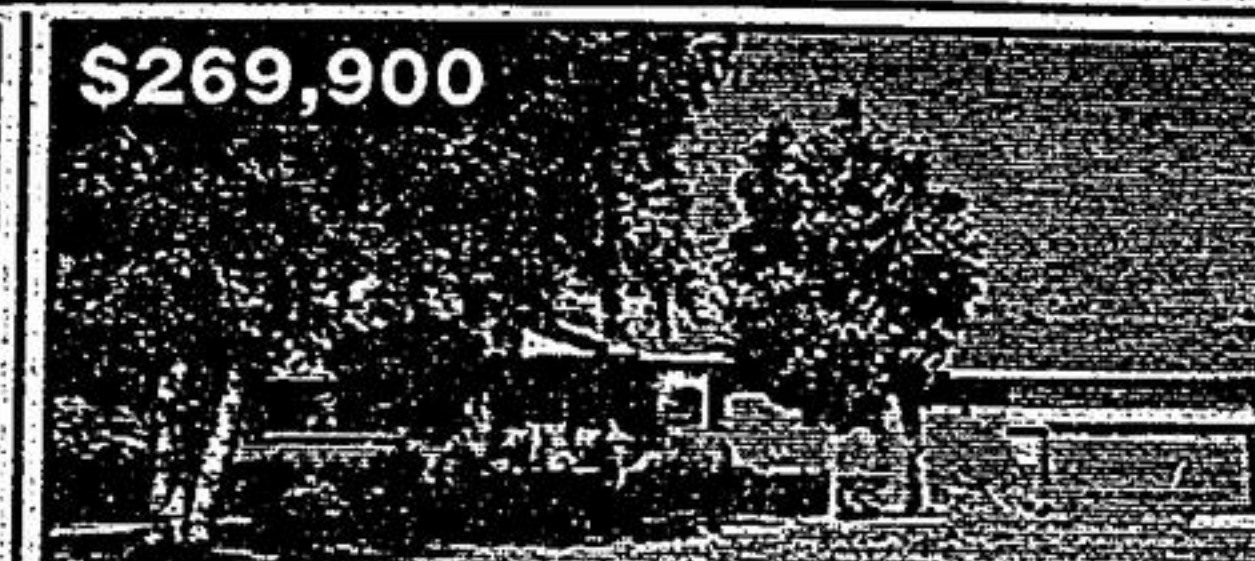

\$269,900
COUNTRY AT IT'S BEST
 2000+ sq. ft. bungalow on 10+ acres, 3 bdrms., 2-1/2 baths, main floor FR with gas fired FP, main floor laundry, economical water source heat pump plus many options too numerous to list. Listed \$269,900. Call Ralph Fairman**, 905-985-7351.

TORONTO 1 HOUR

\$400,000. A hidden paradise, 96 ac. w/33 acre "Joseph's Lake" island w/causeway access, gazebo, bridge over narrows. ZONED FOR LODGE use w/16+ rms. Great Corp. retreat. Ralph Fairman**, 905-985-7351.



\$289,900
LOCATION! LOCATION!
 Convenience to all amenities serves this large 2 storey brick & vinyl home, 4 bdrms., mn. flr. laundry & fam. rm. with FP. Large kit; fin. lower level w/full w/o to lawns sloping onto a nature lovers paradise. This home is rates a 10! Listed at \$289,900. Call Ralph Fairman**, 905-985-7351.



\$323,900
REMEMBER WHEN
 1860's 2 storey home, 4 bedrooms, original trim, plank floors, reconstructed wrap around porch, family room, inground pool, set on large Hamlet lot. Listed \$323,900. Call Ralph Fairman**, 905-985-7351.



\$139,900
WOODVILLE
 Value plus, 1300 sq. ft. brick bungalow, main floor laundry, eat-in kitchen, double garage, large lot, Municipal water. \$139,900. Call Ralph Fairman**, 905-985-7351.



\$389,900
100+ ACRES
 Sunderland, N.W., good working farm with 95+ acres workable PLUS 1840's cut stone home, bank barn, was used for dairy. \$389,900. Call Ralph Fairman**, 905-985-7351.



\$188,500
NEW HOME - NO GST -
 Quality built, all brick 3 bedroom bungalow. Huge country kitchen with walkout to deck, southerly view - main floor laundry, good floor plan, 1410 sq. ft., 1-1/2 baths, covered verandah. Located 10 mins. from Port Perry. \$188,500.
 Keith Puckrin**, 905-985-7351.



\$248,500
MAKE A SPLASH!
INGROUND POOL - PROVIDES HOURS OF FAMILY ENJOYMENT
 1698 sq. ft. quality built all brick home on 1 acre. Beautiful large bright kitchen, 3 bedrooms up, 1 down. Huge rec. room with walkout to pool. Main floor laundry, nicely decorated thruout & shows very well. Located on paved road 15 minutes from Port Perry. \$248,500. Keith Puckrin**, 905-985-7352.



\$469,000
IS LOCATION IMPORTANT? 3.74 ACRES
 2064 sq. ft. all brick home just redecorated thruout. Separate dining room, huge family room, 34' x 48' brick & coloured steel workshop with 14'x14' overhead door plus 32' x 50' storage building with cement floor. Good parking facilities. This property shows very well and all buildings are like new. Located north of Whitby on Highway 12, 25 min. Good highway exposure. Keith Puckrin**, 905-985-7352.



\$299,000
10 ACRES WITH VIEW OF CN TOWER
 Solid birch kitchen cabinets, Hardwood floors, 3 bedrooms, plus den and family room with f/p and walkout to patio. 42'x24' hip roof barn suitable for horses or storage. Located between Oshawa and Port Perry. \$329,900. Keith Puckrin**, 905-985-7352.

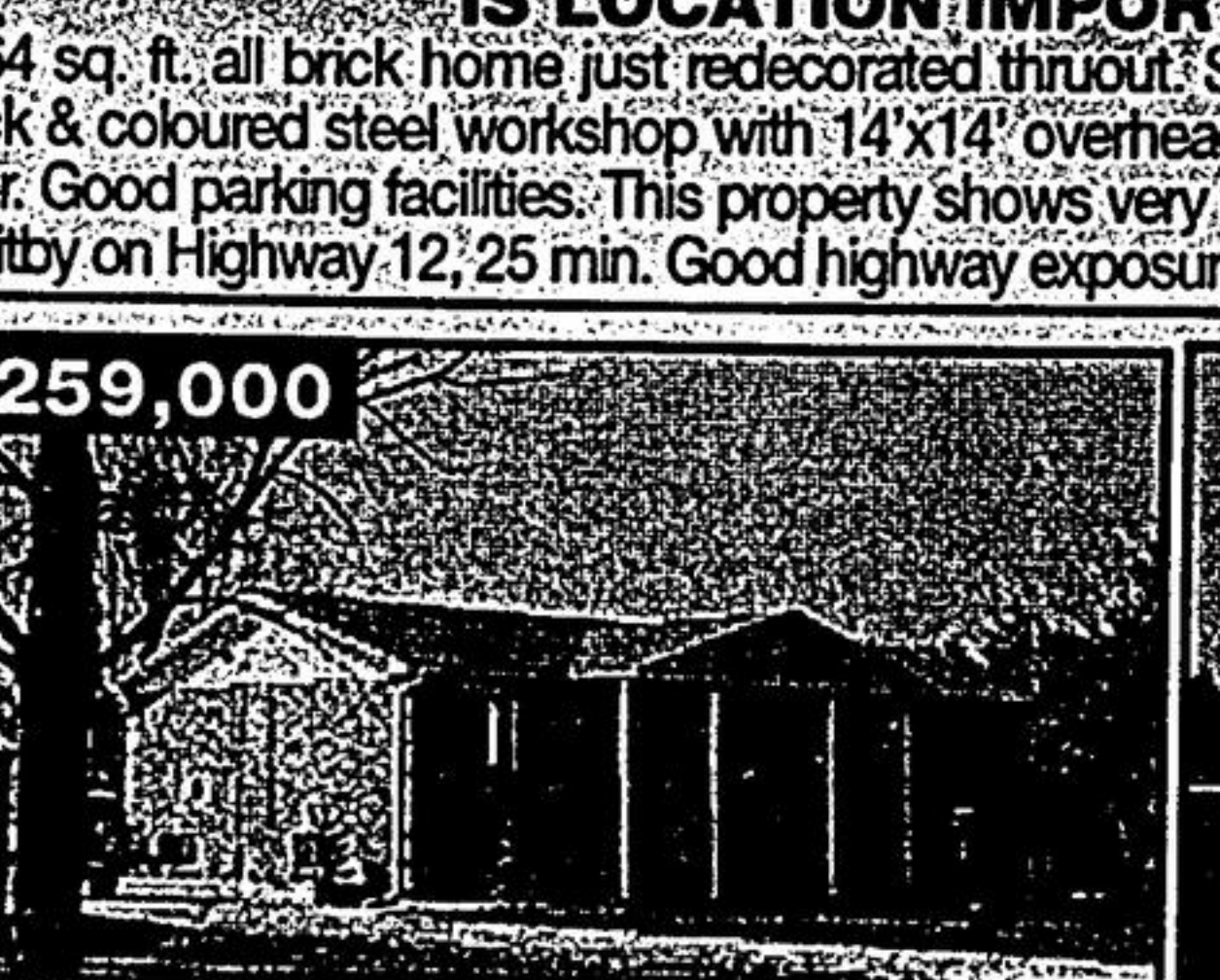

\$259,000
51 ACRE POULTRY FARM/STORAGE BUILDING
 1400 sq. ft. raised bungalow, 3 bedrooms, main floor laundry and huge kitchen, 16,000 sq. ft. 2 storey barn, 9 years old; \$259,000. For further info, please call Keith Puckrin**, 905-985-7352.

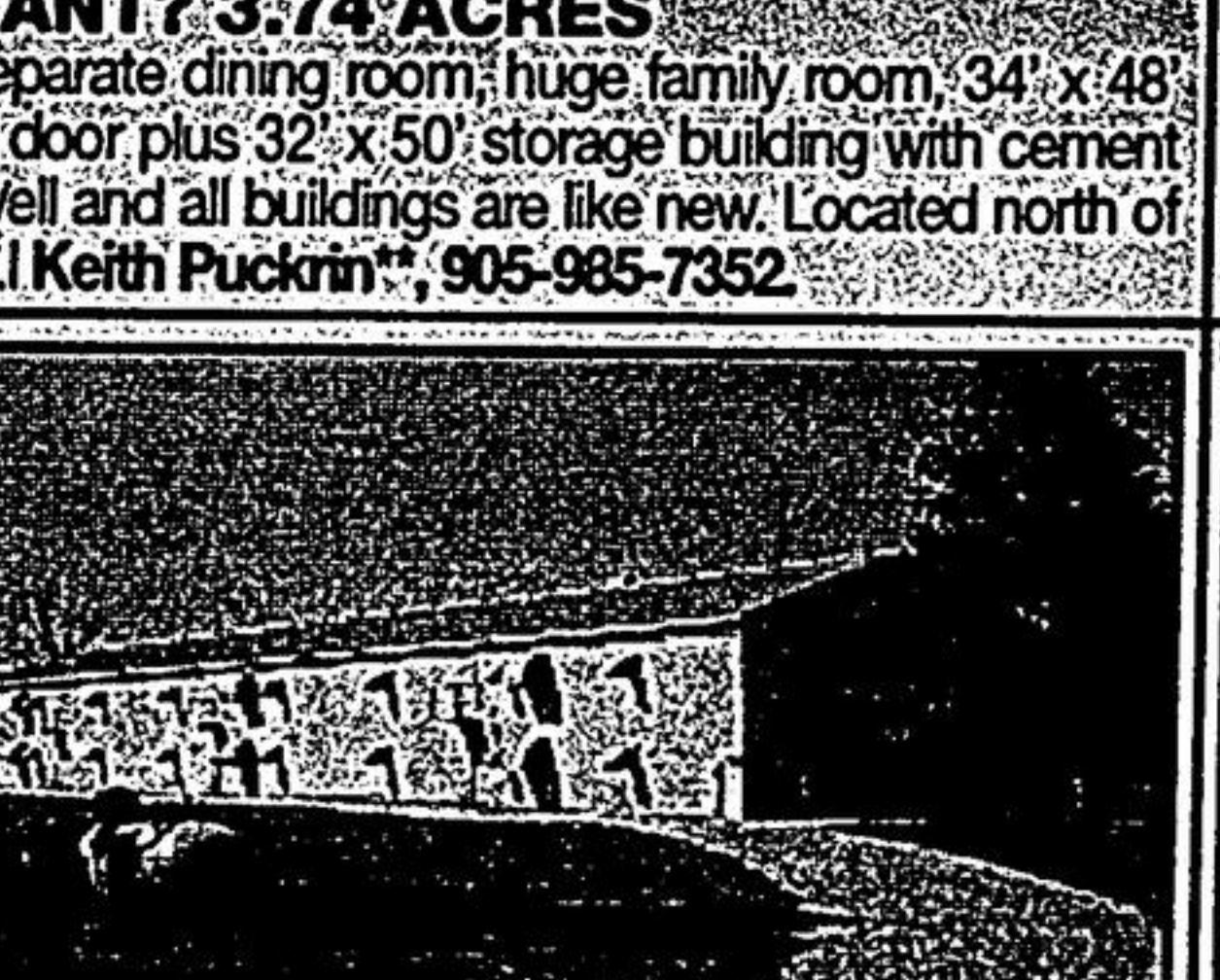

\$299,000
20 ACRES PLUS STORAGE BUILDINGS TOTAL OF 37,000 SQ. FT.
 3 two storey barns, 2400 sq. ft. brick and Tudor style home, storage and workshop buildings. \$299,000.
 For further info, please call Keith Puckrin**, 905-985-7351.

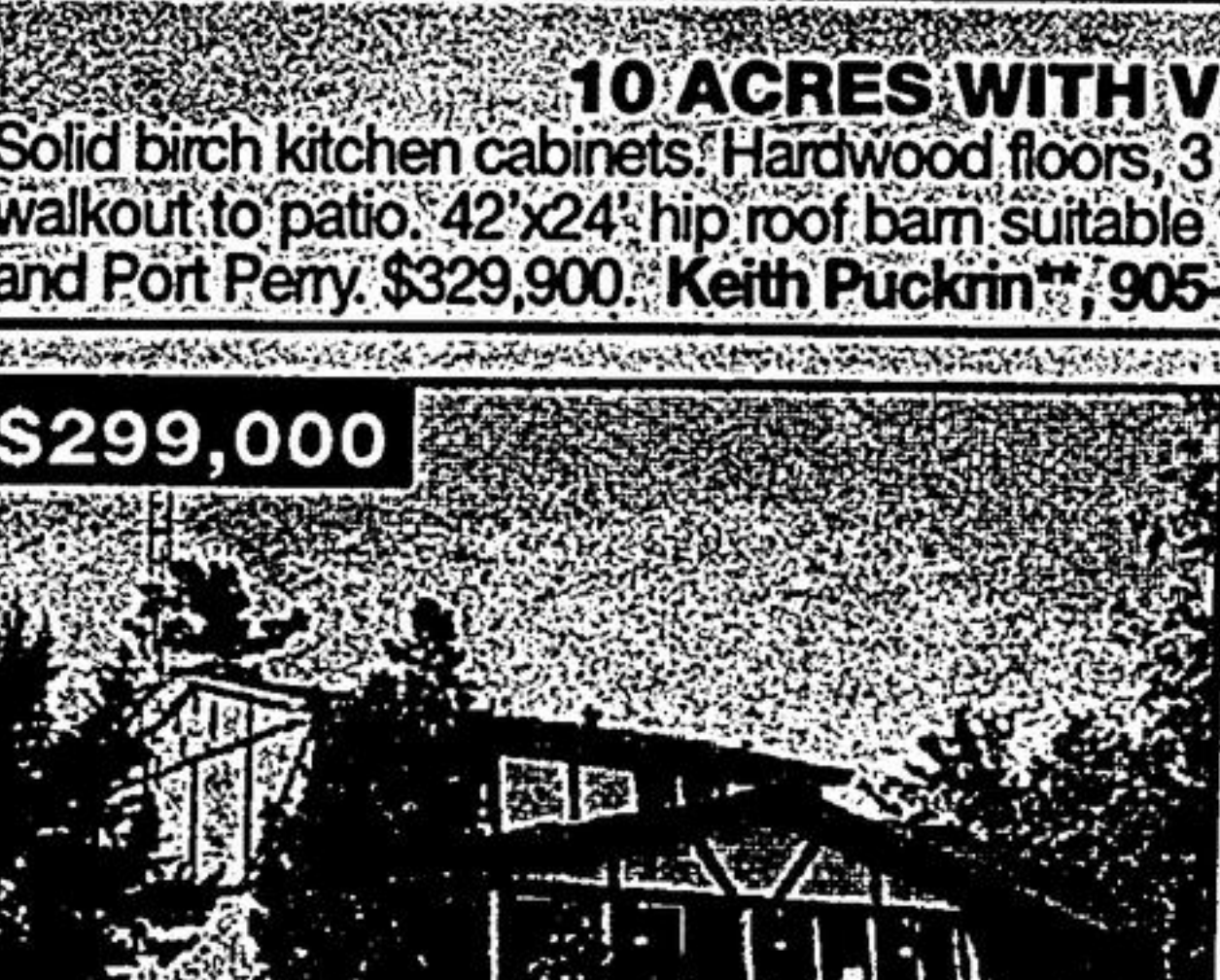

\$299,000
20 ACRES PLUS STORAGE BUILDINGS TOTAL OF 37,000 SQ. FT.
 3 two storey barns, 2400 sq. ft. brick and Tudor style home, storage and workshop buildings. \$299,000.
 For further info, please call Keith Puckrin**, 905-985-7351.

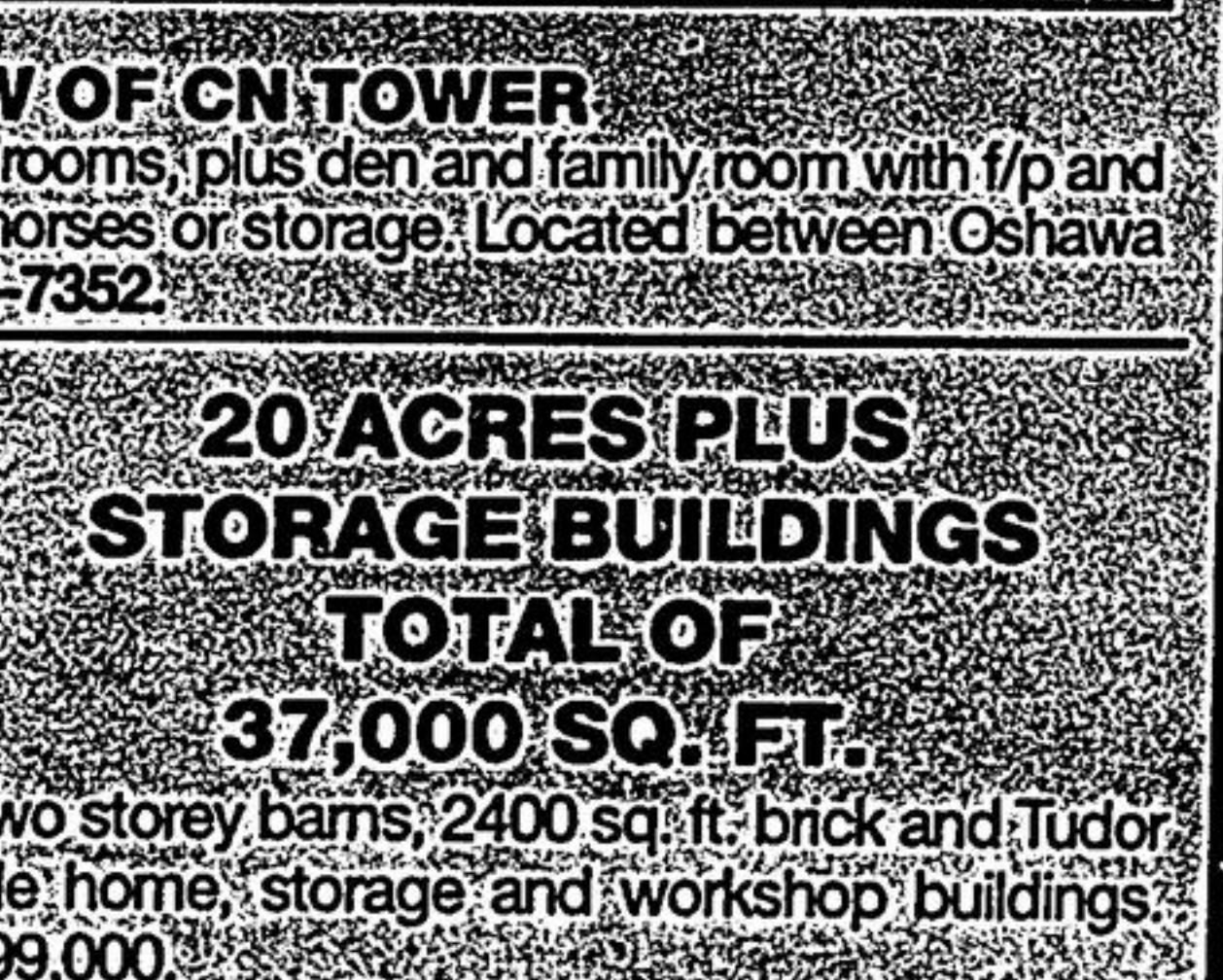

\$299,000
20 ACRES PLUS STORAGE BUILDINGS TOTAL OF 37,000 SQ. FT.
 3 two storey barns, 2400 sq. ft. brick and Tudor style home, storage and workshop buildings. \$299,000.
 For further info, please call Keith Puckrin**, 905-985-7351.

COLDWELL BANKER - Expect the Best™ COLDWELL BANKER - Expect the Best™ COLDWELL BANKER - Expect the Best™ COLDWELL BANKER - Expect the Best™



HAPPY CANADA DAY