



What to do with yard waste in York Region!

SPRING CLEANING YOUR YARD?

Remember, Keele Valley Landfill has banned organic yard waste to conserve space. If yard waste can't be composted in the backyard, residents and businesses may take these materials to York Region's Organic Yard Waste Composting Facility.

COMPOSTING FACILITY HOURS

Daytime		
April 1 to Dec. 31	Monday to Saturday (except statutory holidays)	8 a.m. to 4 p.m.
Sundays		
May 3 to June 7		9 a.m. to 4 p.m.
Evenings		
April 1 to Nov. 30	Tuesday evening only (except statutory holidays)	to 8 p.m.
Winter		
Jan. 1 to Mar. 31	Wednesday only	8 a.m. to 4 p.m.

WHAT'S ACCEPTED

- leaves
- grass clippings
- shrubs
- branches
- weeds
- garden plants
- flowers
- sod

NOT ACCEPTED

- tree branches & brush larger than 100 mm (4 inches) in diameter & 1.8 m (6 feet) long
- stumps & root balls
- driveway & road sweepings
- kitchen & food waste
- animal droppings
- fruits & vegetables
- rocks & stones
- dirt & topsoil

COST

- No charge for one load per day weighing up to 100 kg (220 lbs.) for residents and businesses.
- If the load weighs more than 100 kg, the cost is \$40 per tonne (plus GST) for the entire load.
- Payment by cash, VISA, Mastercard or Interac.
- People delivering yard waste in bags and/or containers will be asked to empty them at the Composting Facility.

COMPOST FOR SALE

- Buy compost at the facility for:
- \$2.50 per bag (GST & PST included), 20x30 inches, already filled.
- \$10 per tonne (plus GST & PST), loaded onto your pickup truck or trailer; minimum charge \$10 plus GST & PST.
- Landscaping companies, farmers, contractors and other large quantity users can purchase bulk quantities of compost. Call Miller Waste Systems at (905) 773-9876 for details.

LOCATION

The Composting Facility is located in Richmond Hill, on the south side of Bloomington Road, just west of Leslie Street.

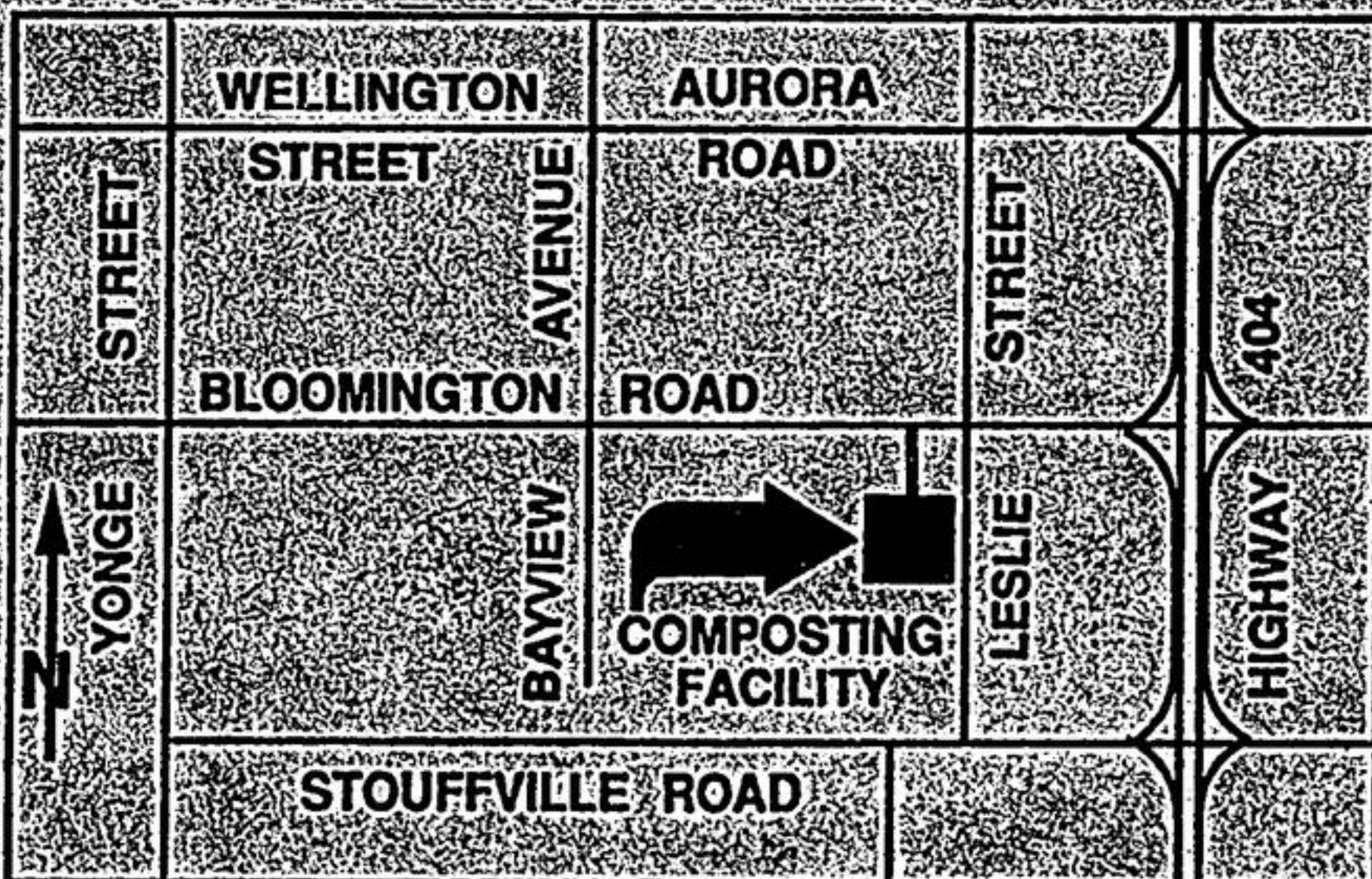

MUNICIPAL LEAF AND YARD WASTE COLLECTION

Where curbside leaf and yard waste collection is available:

1. **USE RIGID, REUSABLE CONTAINERS**, such as bushel baskets, if possible, to cut down on waste.
2. If plastic bags are unavoidable, **USE ONLY CLEAR PLASTIC BAGS**, rather than coloured. This will allow collection staff to see if any contaminants have been included accidentally. Clear bags are available at many larger stores.
3. Most yard waste collection programs allow tree and shrub clippings to be put at the curb provided they are tied in bundles no longer than 1.2 m (4 feet) and not heavier than 23 kg (50 lbs.).
4. Watch for notices from your municipality for further details.

Double birthday bash

From page 11

this special evening. A plaque was presented on behalf of the Stouffville Legion by John McCracken recognizing this club's milestone.

Another milestone was met when twins Marion Baker of Parkview Home and Millicent Boynton of Maddock celebrated their 88th birthday. The party was Saturday and the place was Angie's Eatery, and I was there to meet the twins.

Born in Victoria Square in 1910, the girls were known as the "Klinck Twins". Waiting for Marion to arrive, Millicent said she and her twin were as different as day and night, she the happy-go-lucky, Marion the more serious of the two.

Celebrating the special day was Shirley Mann of Maddock, Lynda Lizotte of Toronto, Diane Smith of Uxbridge and sister Doreen McIntosh of Uxbridge. Corsages were given out and smiles were everywhere. See you next year ladies.

The Stouffville Lioness helped make another birthday very special. Lioness Donna Brown put on a party for Audrian Williams who celebrated her 96th birthday. A resident of Elm Road in Stouffville, a recent newcomer Gerthal Barks to that address, reported that a delicious cake was served and presents opened to the delight of Audrian.



Twins Marion Baker of Parkview Home for the Aged and Millicent Boynton of Maddock joined together at Angie's Eatery last week to celebrate their 88th birthday.

Photo by RUTH LEBLANC

Is someone you know celebrating a milestone? Fax Ruth @ People at 640-5477. No calls please.

YORK REGION'S NEW PERMANENT HOUSEHOLD HAZARDOUS WASTE DEPOT



OPEN YEAR-ROUND STARTING WEDNESDAY, MAY 13, 1998

What to do:

1. Look under your kitchen and bathroom sinks; in the medicine cabinet, tool shed, garage and basement. You'll probably find all kinds of cleaners, waxes, detergents, cosmetics, expired prescriptions, solvents, paints, bug killers, oils and grease, etc.
2. Make sure all materials are in original containers or contents are very well marked on containers. Do not mix different products together. Be sure that all containers are capped. Please remember that your containers must be deposited with waste materials and are not returnable.
3. Bring your household hazardous waste to York Region's new Depot at no charge.

HOURS OF OPERATION FOR 1998

WEDNESDAYS
10:00 A.M. - 6:00 P.M.
AND
SATURDAYS
8:30 A.M. - 4:30 P.M.
(EXCEPT STATUTORY HOLIDAYS)

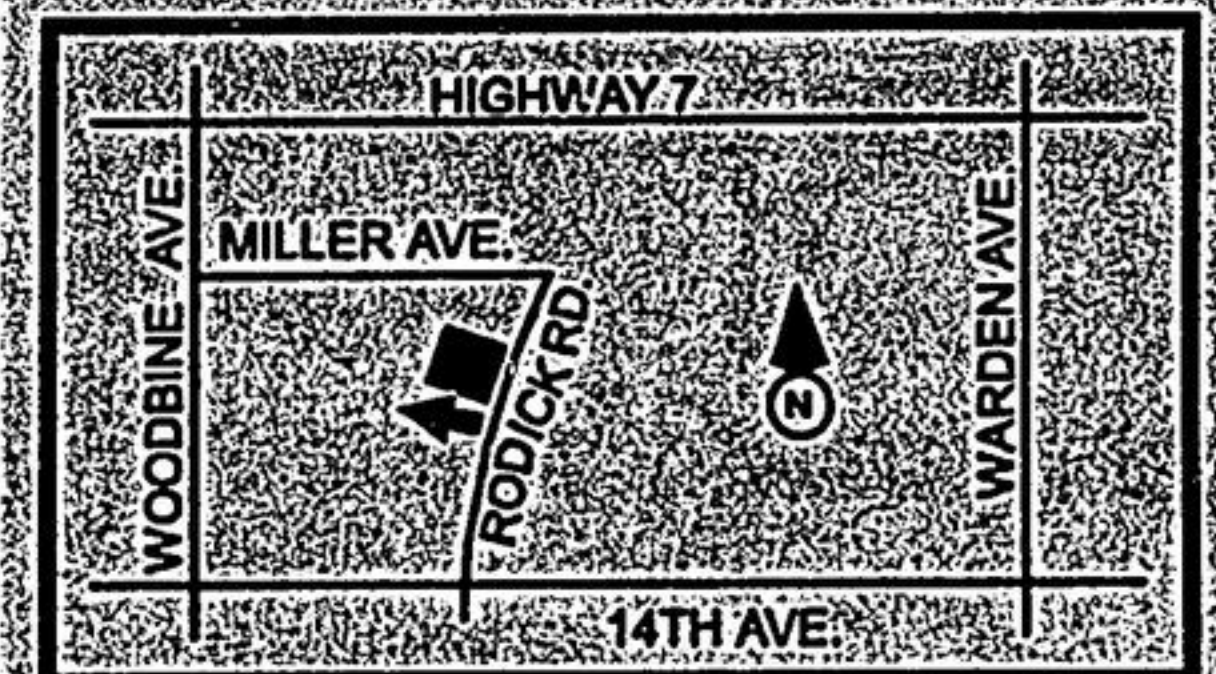

TOWN OF MARKHAM

Please Note:

- York Region residents only (proof of residence is required).
- No commercial, industrial or medical office wastes accepted.
- No explosives (other than the above types), ammunition, PCBs, or radioactive wastes accepted.
- Needles and syringes from household medicinal use will be accepted in rigid containers only. No other pathological wastes will be accepted.
- Motor vehicle batteries and oil filters will also be accepted.

