



Family Realty
Results Inc.
Uxbridge

Committed to Excellence

Serving Uxbridge & Area

(905) 649-2231

(905) 852-9781



Sinikka
Fitz-Gerald*
"Award of Excellence"

Happy & Prosperous New Year To Everyone!
Let me help you make your dreams a reality in 1997



INCREDIBLE VALUE FOR "TRUE NORTH" LOG HOME
Circa 1989 white pine log home, over 2000 sq. ft. of living space. Open concept living area with multiple walk-outs to cedar deck. Panoramic views ++. The privacy and ambience of this lovely home & property can only be appreciated by your personal viewing. \$209,900.



SUNDERLAND HOBBY FARM
7.5 acres of fields and gardens, 3 bedroom farmhouse, good out buildings. Minutes to town. \$144,900.



CALLING ALL TRUE ANTIQUE AFICIONADOS
North Uxbridge area hobby farm. Circa 1900 farmhouse with antique cabinets, wainscoting, baseboards, trim, maple & pine floors, antique light fixtures and more. Many updates since 1986. Small barn/workshop. Good workable tile drained land & woods. Truly a rare find. \$216,000.

TWO - 1 ACRE COUNTRY BUILDING LOTS

Good high & dry lots abutting the hamlet of Udora. Beat the spring rush - buy now and start building your home at the first sight of a robin.

East Lot **SOLD** West Lot **Available - \$39,900.**

*Sales Representative



BUNGALOW TOWNHOME \$165,900

3 baths, 2+1 bedrooms, open living/dining with fireplace, skylight & panoramic south view - walkout lower level features spacious & bright lounge, bath & bedroom. Professional decor.



QUAKER VILLAGE TOWNHOME! \$151,900

Spotless 3 bedroom, 2-1/2 bath, white kitchen, 40 oz. broadloom, cent. air, open stairway & ceramics in entry. Privacy fenced & westerly exposed yard. Walk to park / daycare & primary school!

Lee WELDON
ASSOCIATE BROKER

RE/MAX Scugog Realty Ltd.
An Independent Member Broker
(416) 510-1284 (905) 852-6143



INCOME OR ONE! \$122,900
Sunderland, legal duplex, upper level rents \$550 mo. Spacious 3 bedroom suite on main. Lots of house for the \$!

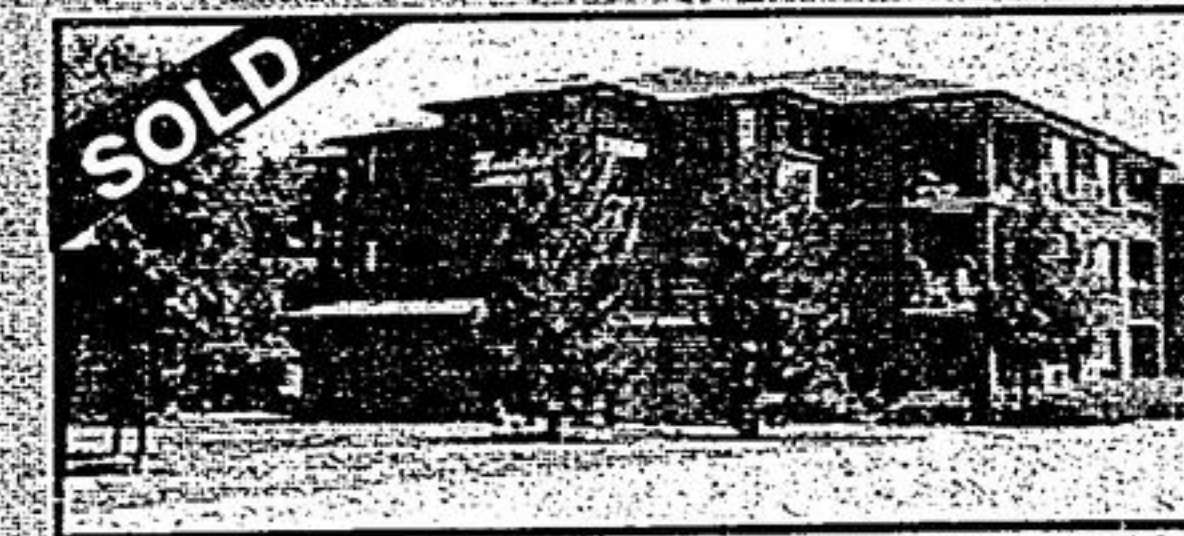

CONDO APARTMENT - \$84,900
Uxbridge, 2 bedroom balcony with south exposure!

Enjoy the Breathtaking Sunsets of Sandford Estates

Live in Your Country Style Home set on Acre Lots, overlooking the Rolling Hills of Uxbridge.



MODEL HOME NOW OPEN

\$ from **239,900** up to 3,270 sq.ft.



- 2 Storey & Bungalows
- No Lot Premiums on Most Lots
- Minutes from Amenities
- G.S.T included

KARVON

PEACE & TRANQUILITY are not hard to imagine in SANDFORD

SALES OFFICE HOURS
Mon. - Thurs. 3p.m. - 8p.m.
Frid. 1p.m. - 8p.m.
Sat. & Hols. 11am - 6pm. Sun 1p.m. - 6pm.
(905) 852-0228 Model Home

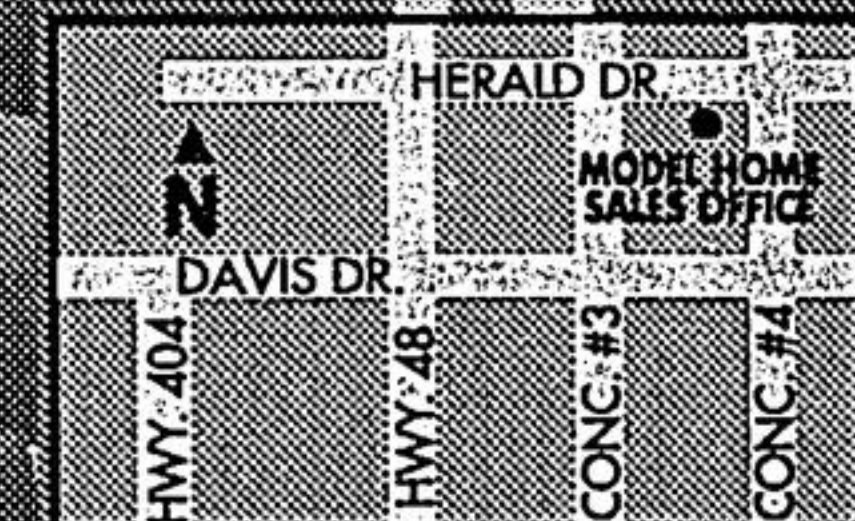

Prices & Specifications subject to change. © 1997