

Town must grow

Dear Editor:
 Mayor Fran Sainsbury seems to fear the spectre of stagnation will strike Whitchurch-Stouffville if build-up doesn't continue. I tend to agree. A community is much like a business. It can't stand still.
 Although not an engineer, I can't believe the present sewage disposal plant cannot be enlarged or modernized to handle additional affluent.
 I firmly believe our town must continue to grow — gradually. I don't feel we're ready to hook into 'the big pipe' and shoulder this multi-million dollar expense.
 Gordon Allen

Church sale sad

Dear Editor:
 I was astounded to read in your Sept. 27 issue that the United Church at Ballantrae is to be sold.
 With the population growth in that community, a new sanctuary should be required rather than the sale of the old one.
 While I appreciate the fact one can't whip people into attending church, the congregation's demise shows just how irresponsible Ballantrae residents must be.
 I'm referring, of course, to those who have no religious denomination link.
 Can you imagine the controversy if York Region Board of Education suddenly decided to sell Ballantrae School?
 In my opinion, a community church is just as necessary; or should be.
 Sincerely,
 (Mrs.) Josephine Gallagher,
 R.R. 4, Stouffville



Whitchurch-Stouffville says thanks to Judy

The town of Whitchurch-Stouffville said thanks to Judy Reesor prior to her leaving the Municipal Office after 16 years of faithful service in both the clerk and planning departments. Judy's husband, Glen, and daughter, Angela, will take up residence at Lindsay and joined the town's municipal staff in 1972. The first position she was presented with was Town Clerk by Mayor Fran Sainsbury Oct. 25.

Ontario MGS
 Ministry of Government Services
TENDER

GENERAL CONTRACTORS

Tenders are invited to supply labour, material and/or equipment to provide delivery of potable water throughout the North Pickering Land Assembly, Squires Beach and surrounding area for a period of one year commencing January 2, 1989 to December 31, 1989, as outlined in tender #187 specifications.

Sealed Tenders will be received until 3:00 p.m., Wednesday November 16, 1988 at the Toronto Public Tenders Office, at which time they will be opened in public.

Please quote T.O. No.: 187, project no.: 03-01531.

The lowest or any tender will not necessarily be accepted.

Pour tout renseignement en français au sujet de cette annonce, s'adresser au ministère des Services gouvernementaux, Bureau des appels d'offres, Salle M1-43A, Edifice Macdonald, Queen's Park, Toronto (Ontario) M7A 1N3, Telephone: (416) 965-1152.

Tender documents can be obtained from: Ministry of Government Services Public Tenders Office Room M1-43A, Macdonald Block Queen's Park Toronto, Ontario M7A 1N3 Telephone: (416) 965-1152

A \$4,000.00 Bid Bond is required.

Party wins praise

Dear Editor:
 As a mother of a bride-to-be, I wish to thank Welcome Wagon of Stouffville for the Bridal Show held at The Maples of Ballantrae Oct. 17.
 It was a delightful evening. We found it most helpful in planing our daughter's wedding.

Sincerely,
 Lorna Wagg,
 Stouffville

Editor's Mail

"Frightening"

Dear Editor:
 Often we read of police brutality — so called. Undoubtedly, there are times when officers do exert undue physical pressure when making an arrest. More often, I'd suggest, they're lenient, perhaps too lenient.

A case in point was the disgusting 'affair' on Durham Road 30 at Island Lake on the night of Oct. 14.
 I happened on the scene and witnessed the shameful event, an eye-opener to say the least.

The verbal abuse inflicted on arresting constables, (one a woman), defied description. On two occasions, the suspect attempted to 'leave the scene' only to be brought back by officers. He was finally placed in an ambulance.

Under different circumstances, I could have been the witness to a fatality, perhaps an innocent mother or child. The accused's northbound truck came to a stop in the southbound traffic lane.

The suspect made the arrest sound like he was the 'victim'. It's the public that's continually victimized by this type of motorist.

From now on, when I hear reports of 'police abuse', I'll want to know both sides of the story. The scene at Island Lake was certainly an eye-opener to me.

Sincerely,
 Robt. Barringer,
 R.R. 2, Uxbridge

Visit the Pickering Home & Design Centre

NOW OPEN!

This one-stop shopping centre offers a great selection of home furnishings and accessories. You'll also find inspiration and expert help in the Idea Place, a handy resource centre for home decorating.

At last it's possible to find everything you need for the home in one convenient location — on Brock Road, just north of the 401.

The Pickering Home & Design Centre... the largest home and design centre in Canada!

Upcoming Seminars

The Following seminars will be presented by Sheridan Nurseries in The Idea Place.

Wednesday, November 2nd
 7:00 p.m., Fall gardening calendar

Thursday, November 3rd
 7:00 p.m., Fall fertilization

Friday, November 4th
 7:00 p.m., Fall table centre pieces

Saturday, November 5th
 11:00 a.m., Winterizing your lawn and garden

1:00 p.m., Fall decorations

Saturday, November 12th
 1:00 p.m., Houseplant Care

Open:
 Monday — Friday
 10:00 a.m. — 9:00 p.m.
 Saturday
 10:00 a.m. — 6:00 p.m.



Some of the unique stores you'll find at the Centre are:

- A Special Place
- A Touch of Brass
- Sleep Shoppe
- Automated Lifestyles
- The Bath and Tile Co.
- B.B. Bargoons
- Bar Trends
- Chiu's Rattan
- Deblins
- DeBoer's (opening soon)
- Durham Doors
- Durham Lighthouse
- Indo-Persian Rug Co.
- Juliane Galleries
- Accents Galore
- The Last Post Deck and Sauna Centre
- McGinnis Landing
- Oakclair Furniture/Baby Oakclair
- Peter's Appliances
- Pier 1 Imports
- Point of View
- Sheridan Nurseries
- Victorian Revival

ENVIRONMENTAL STUDY REPORT

Markham GO Station Parking Expansion

GO Transit has completed an Environmental Study Report for parking expansion at the Markham GO Station.

The Environmental Study followed the process set out by the Ministry of the Environment and determined that no single aspect or combination of activities of the project will result in any significant detriment to the environment.

The Environmental Study Report has been submitted to the Ministry of the Environment for the public record. It is available for review at:

Ministry of the Environment
 Environmental Assessment Branch
 250 Davisville Ave., 5th Floor
 Toronto

GO Transit
 1120 Finch Ave. West
 Toronto (Downsview)

It has also been submitted to the Regional Municipality of York and the Town of Markham.



GO Transit
 1120 Finch Avenue West
 Toronto (Downsview), Ontario
 M3J 3J8

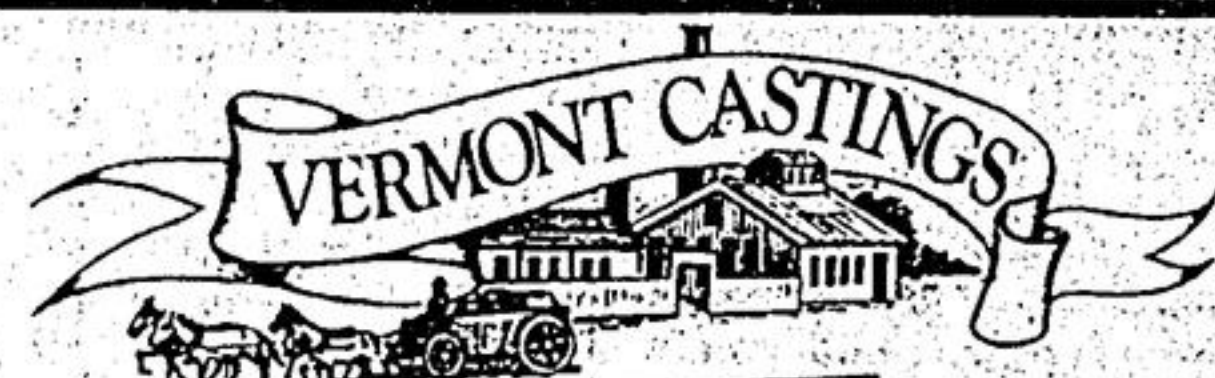

The Vermont Castings FirePlace Insert is the most thoroughly engineered heating system for fireplaces on the market today, providing all the energy efficiency of our world-famous air-tights. It installs flush in almost any fireplace. The optional patented Flex Connector™ seals the FirePlace Insert directly to the masonry flue with an airtight fit for maximum heating and draft efficiency. The secondary combustion chamber is lined with refractory firebrick, to promote better, cleaner burning, with less buildup of creosote deposits in the flue.
 All the internal workings are serviceable from the front. Just remove the face with four screws to access all the electrical connections, blowers and thermostat. Once in place, the classic mantel, fluted columns and gracefully arched glass doors provide a handsome architectural element to enhance any style of decoration.

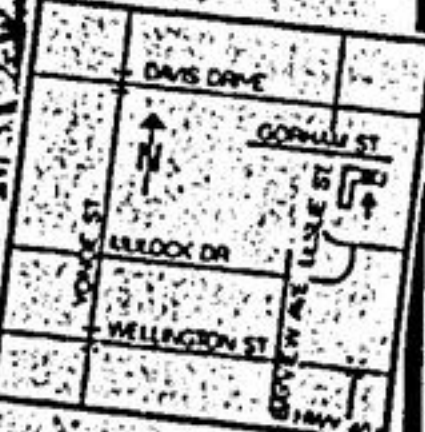

WE HAVE THE WIDEST RANGE OF WOOD & GAS STOVES AND FIREPLACES IN YORK REGION!



THE FIREPLACE and PATIO PEOPLE

Hours: Mon-Fri. 10-6
 Thurs-Fri. 10-9; Sat. 9-5

1100 GORHAM ST. SOUTH OF DAVIS DRIVE OFF LESLIE IN THE GORHAM HEIGHTS MALL

895-8700