

Fourth line news

McIntyre funeral today

By MARJORIE WOODLAND
 The tragic crash of the National Defence helicopter in Timmins Thursday, took the life of Stephen McIntyre, son of Ronald McIntyre and Marilyn (Slack) Hoskin of Port Perry. Stephen was one of four crew members killed during a trial run from Petawawa to Kapuskasing.

Heartfelt sympathy from the many friends in Goodwood go out to these families as well as to Stephen's grandmother, Gladys Slack.

The funeral service was held in Port Perry at the Scugog Funeral Parlor, today at 2 p.m.

In the early 1870s, a marvel came through our village by way of steam train. Long since obsolete, nevertheless many of us can still remember the regular morning and evening trains carrying passengers, mail, milk, and other farm produce.

Many circumstances have made this form of transportation a thing of the past, but if today's rumors are true, we may once again be able to travel between Stouffville and Blackwater in an old-fashioned steam train.

I have quoted from time to time the works of Mr. J.C. Kidd's 'Mixed Diet' book, which is specially meaningful to many of his former pupils. Jingles are included on The Months of the Year. Here is a poem he wrote for February:

February with its snow and ice and cold,

The frozen landscape in its iron grip doth hold,

And yet, they say, the bear doth venture out,

To stretch his stiffened limbs and look about;

Beholding his dark shadow on the frozen snow,

Back to his den for six long weeks doth go.

The very mild January makes us wonder just what February and March may have hidden up their sleeve.

BECOME A CARRIER

Economist & Sun

ROUTE OF THE WEEK

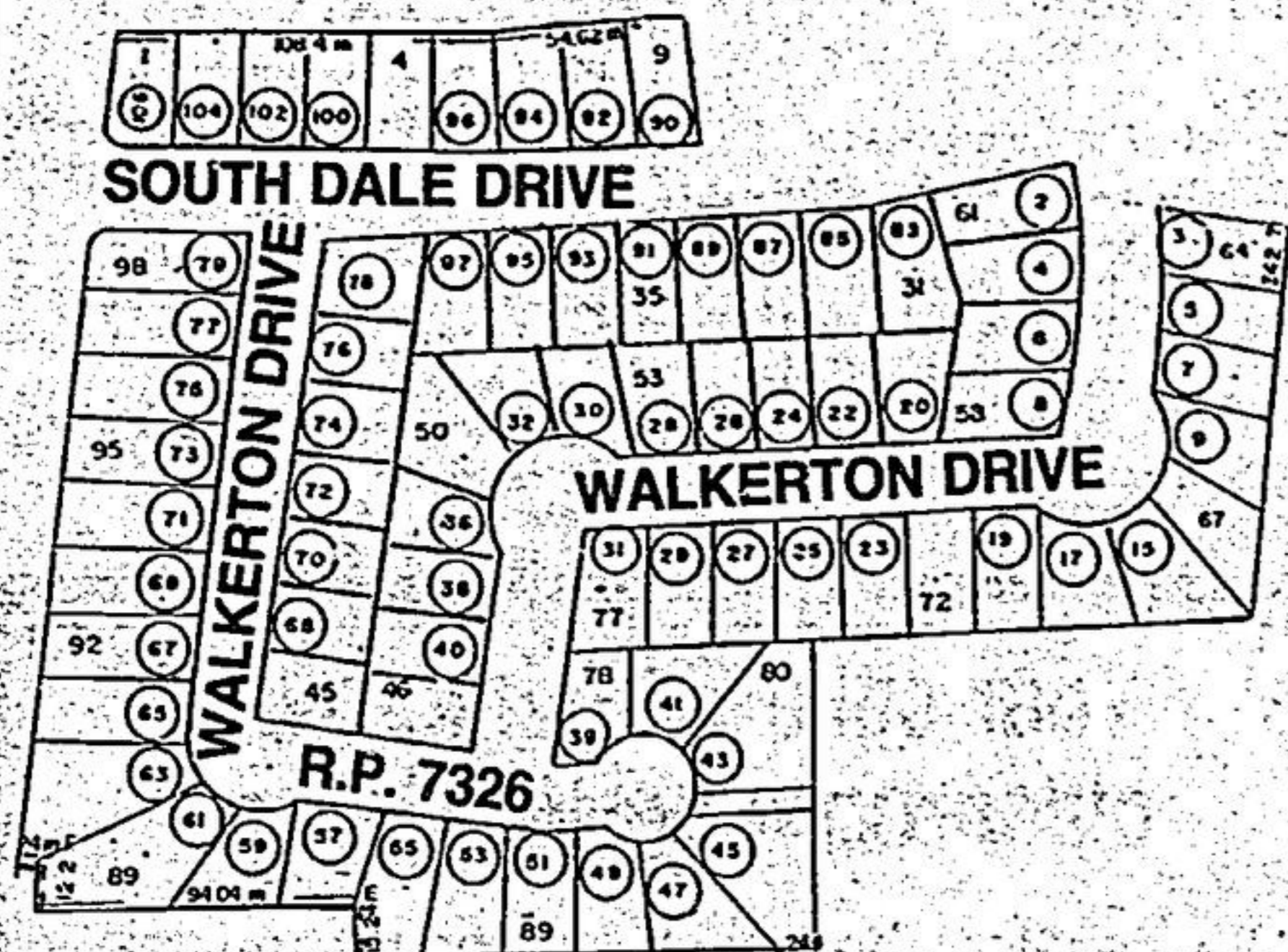

ROUTE NUMBER: MD001
 TOTAL NUMBER OF HOUSES: 75
 AVERAGE MONTHLY INCOME: \$64.43
 AVERAGE ANNUAL INCOME: \$773.16

Call 294-8244 to-day
 to set up an appointment to begin this route.
 There are also other routes available in your area.



PAPER DRIVE by MARKHAM SCOUTS

Pick Up Date
 Feb. 6, 1988

Future Dates For Pickup

Mar. 5/88, Apr. 2/88, May 7/88

Clip this ad for future reference

NO MAGAZINES PLEASE
 PLEASE TIE PAPER IN BUNDLES AND HAVE
 PAPER AT CURB BY 9:00 AM.

OR

DROP OFF AT MARKHAM ART CENTRE
 CHURCH STREET (AT REAR)

THANK YOU FOR YOUR VALUED SUPPORT
 SPONSORED BY MILL PAPER FIBRES

REGISTRATION

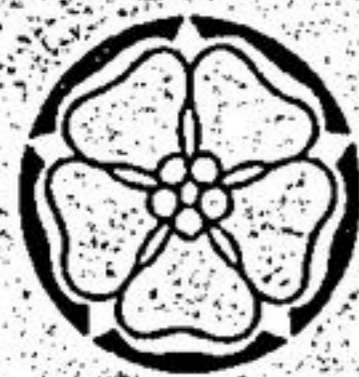

YORK REGION BOARD OF EDUCATION KINDERGARTEN REGISTRATIONS

FOR
 SEPTEMBER 1988

FOR CHILDREN BORN IN 1983

STOUFFVILLE FAMILY OF SCHOOLS
 FEBRUARY 15-18 FROM 8:30 A.M. - 4:00 P.M.

AT YOUR LOCAL SCHOOL:

Orchard Park P.S., Summitview P.S., Ballantrae P.S.,
 Whitchurch Highlands P.S., Dickson Hill P.S.

Please bring birth registration and immunization records.

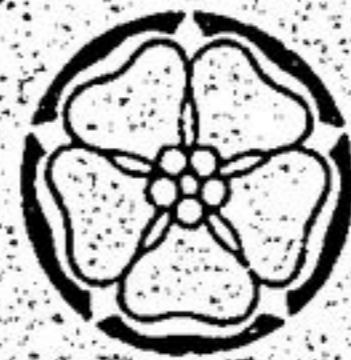

YORK REGION BOARD OF EDUCATION KINDERGARTEN REGISTRATIONS

FOR
 SEPTEMBER 1988

FOR CHILDREN BORN IN 1983

MARKHAM FAMILY OF SCHOOLS
 FEBRUARY 8-12, 8:30 A.M. - 4:00 P.M.

AT YOUR LOCAL SCHOOL:

Ramer Wood P.S., R.H. Crosby P.S., James Robinson
 P.S., Franklin Street P.S., Reesor Park P.S., William Arm-
 strong P.S., E.T. Crowle P.S.

MILLIKEN MILLS/ARMADALE FAMILY OF SCHOOLS
 FEBRUARY 22-26, 8:30 A.M. - 4:00 P.M.

AT YOUR LOCAL SCHOOL:

Milliken Mills P.S., Highgate P.S., Aldergrove P.S., Wil-
 clay P.S.

Students living east of McCowan may register at Wilclay
 P.S., but schools for this area to be determined after
 March 31st.

Please bring birth registration and immunization records.



MARKHAM YOUTH SOCCER CLUB OPEN REGISTRATION

FEBRUARY 9TH & 10TH
 6:30 P.M.-8:00 P.M.

MARKHAM DISTRICT HIGH SCHOOL

- MINI, REP, HOUSE LEAGUE & ADULT PROGRAMMES
- GIRLS & BOYS, MEN & WOMEN BORN 1982 & EARLIER
- INDOOR CLINICS & TRAINING FOR ALL AGES WEEKLY FROM FEBRUARY 1ST AT MOUNT JOY SOCCER FACILITY (FREE OF CHARGE)
- REQUIRES HEIGHT, WEIGHT, OHIP # & BIRTH CERT. FOR 1982 PLAYERS.

FOR FURTHER INFORMATION CALL 471-5522

CHILDREN'S ACADEMY

201 Main St. N.
 Markham

is now accepting registrations
 for September '88.

Daycare, nursery school, jr. and sr.
 kindergarten. Ages 18 months-5 1/2
 yrs.

Limited space available!

CALL

294-6073