

Economist/Tribune

showcase



PAM DOYLE



JUST LISTED - BUNGALOW - \$109,850.

Super 3 bdrm. (2 + 1) upgraded dolls house, eat-in kitchen, fireplace, upgraded broadloom, ceramics, central vac, air cond. unit, B/I dishwasher. Pam Doyle now. #625



JUNE WILLIAMSON



BUY IN WINTER - MOVE IN SUMMER

July possession on this 2800 sq. ft. Greenpark "Mark 4". Grand foyer, centre hall, main fl. family & laundry, 4 large bedrooms, huge kitchen. June Williamson. #620



LUIS MAYA MUNOZ

CONGRATULATIONS to Luis for being a Top Century 21 Armour Real Estate Sales Agent in December.

FAIRGATE HEIGHTS STOUFFVILLE LAST CHANCE FOR 1985 MODELS IMMEDIATE POSSESSION



2 STOREYS ON 50' LOTS F5 Model

All situated on quiet crescent
PRICES FROM \$126,900 to \$139,900
1850 sq. ft. to 2305 sq. ft.

* Clay brick * Aluminum eaves, soffit and fascia * Ceramic entrances and washrooms * Mahogany trim * Oak circular staircases & railings * Floor-to-ceiling brick fireplaces in main floor family room * Basements partitioned * Double car garage plus many more features.

For information call Jenny Ronco or Lina Ronco
640-5307 days or 497-9654 evenings
CANDO REAL ESTATE

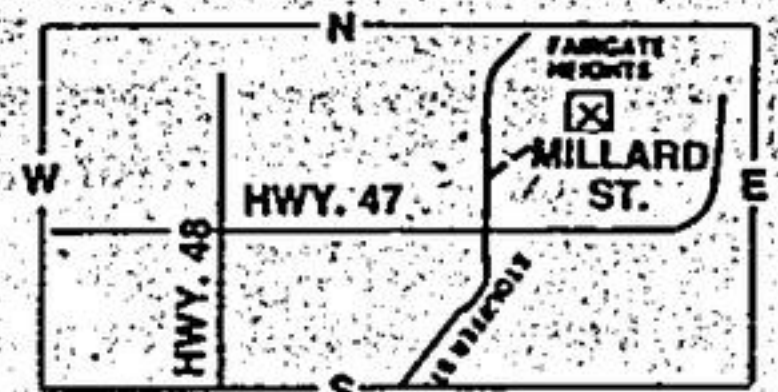

ROMARK HOMES

8 HOMES LEFT

CUSTOM DESIGN YOUR OWN INTERIOR

PRICES - \$146,900 — \$169,900 — UP TO 2830 SQ. FT.



ROMARK III
2360 SQ. FT.

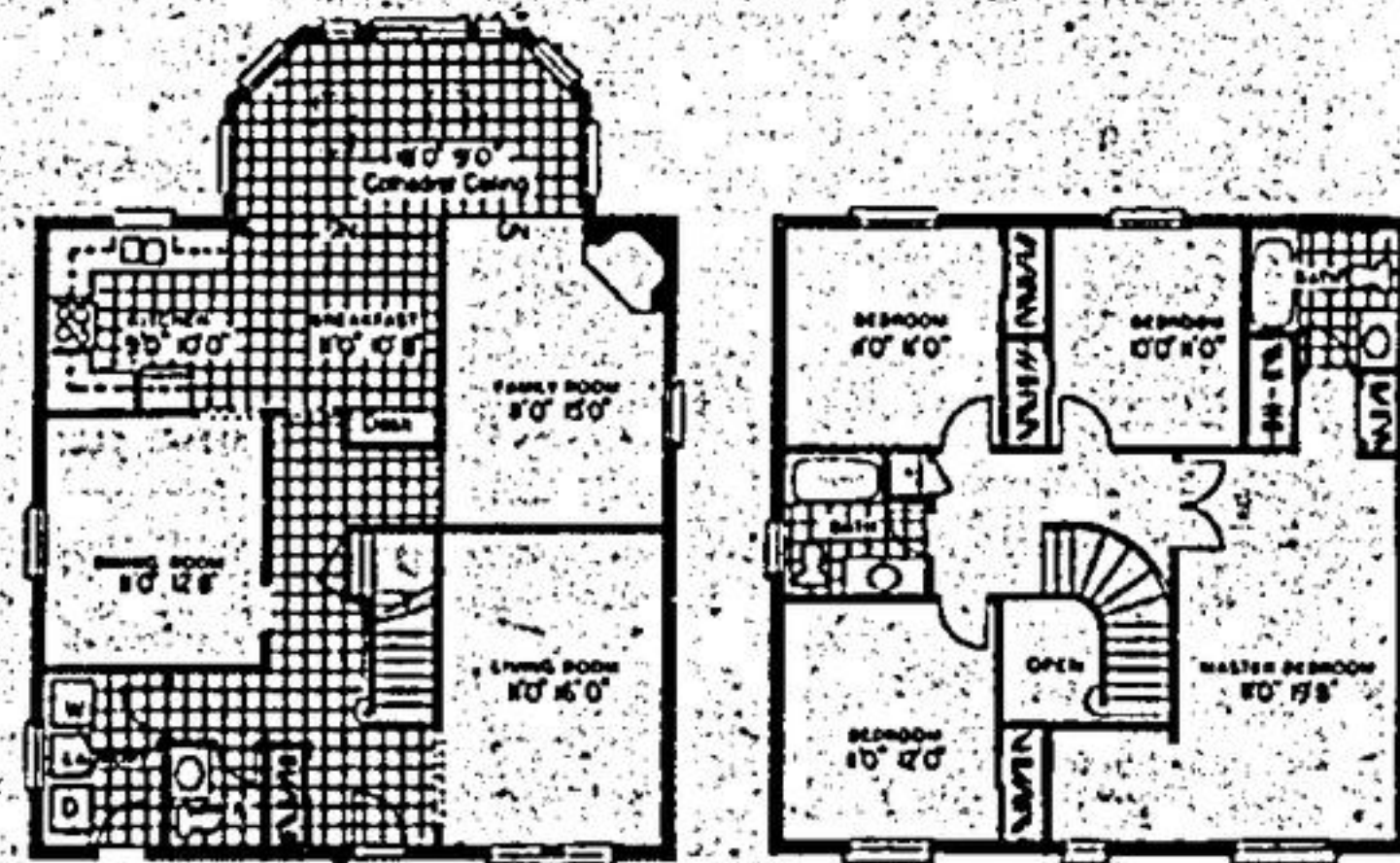

REDESIGNED ENSUITE ROMAN TUB AND STAND IN SHOWER IN THIS MODEL

ROMARK QUALITY FEATURES

- * Genuine burnt clay, or calcite brick exterior
- * Aluminum soffits, fascia & eaves
- * Casement windows
- * Greenhouse kitchens
- * Skylights
- * Roman Tubs - ceramic showers
- * Main floor family room
- * Main floor study
- * Main floor laundry wall-to-wall cupboards

- * Two car garage
- * Ceramic tiles in foyer, main & ensuite washrooms
- * Upgraded kitchen cabinets, traditional or European
- * Circular stairs
- * Brass hardware
- * Series 800 Doors or Mahogany
- * Brass Chandelier
- * Coach lamps
- * Door in home from garage

EXCLUSIVE AGENT
RE/MAX-EAST REALTY LTD.
TONI SULLIVAN
ASSOCIATE-BROKER
OFFICE 291-9988
24 HR. PAGER
245-5544 PAGER ALPHA 91150

SITE HOURS: SAT. & SUN.
1:00 TO 5:00 P.M.
WEEKDAYS BY APPOINTMENT ONLY

