

NORTH-WEST CORNER OF HWYS. 48 & 47

STOUFFVILLE
REAL ESTATE LTD. REALTOR

640-11200

"THE GOOD WILL OF THOSE
WE SERVE IS THE
FOUNDATION OF OUR
SUCCESS"

UXBRIDGE NORTH — Custom built 2,000 sq. ft. home, has beautiful main floor — family room, sunken bath, central air, on 10 acres with pond. Asking \$129,900.00. Barbara Sproule.

11 1/4 PER CENT MTGE. — Spacious 4 bdrms. 2 storey home on large deep lot in Uxbridge. Features large kitchen, separate dining room, 1 1/2 baths, inground pool and is located within walking distance to stores & schools. Only \$69,900.00. Barbara Sproule.

STARTER'S DREAM — Cute & cozy describes this spotless home with large living & dining room, modern bath, good sized bdrms., walkout to deck & full basement. Asking \$47,900.00. Lynda Hughes.

10 1/4 PER CENT MTGE. — Spacious 2 storey home in the heart of Stouffville. Large country kitchen, 3 bdrms., den, 260' deep lot. Detached 1 1/2 car garage with heavy duty wiring. Shows beautifully. \$74,900.00. Lynda Hughes.

STOUFFVILLE BACKSPLIT — Early possession on this 3 bdrm. home with large kitchen overlooking family room, 2 baths, wet bar, single car garage. All drapes included. Owner anxious. Lynda Hughes.

WE HAVE MANY OTHER PROPERTIES - GIVE US A CALL

Toronto Line 640-1200 Uxbridge, Pickering & Ajax toll free 649-2266

3 BUILDING LOTS — 1 1/3 acres each, just north of Stouffville Town. Priced to sell at \$37,900.00 each with \$10,000.00 down. Ross Gallo.

13 ACRES — Located just east of Ballantrae, excellent lot for your dream home. \$89,500.00.

12 ACRES — Just 4 miles north of town, corner property, scenic & gently rolling. \$87,500.00.

INVESTMENT PROPERTY — 3 acres adjacent to town residential area. 661 feet frontage on paved road and with a small commercial building. Ross Gallo.

JUST LISTED — Milliken Mills, Markham. Spotless 3 bdrm. 2 storey home with quality broadloom, corner fireplace in living room, w.o. from kitchen and an excellent first mortgage at 10 1/4 per cent Only \$88,500.00. Lynda Hughes.

BRAND NEW — Overlooking picturesque Uxbridge valley, this new home on 11.5 acres is a must to see. 3 bdrms., family room with fireplace and walkout, main floor laundry. Choose your own color schemes. Listed at \$134,500.00. Ross Gallo.

(Toronto Direct) 640-4151
(Mi. Albert) 473-3600

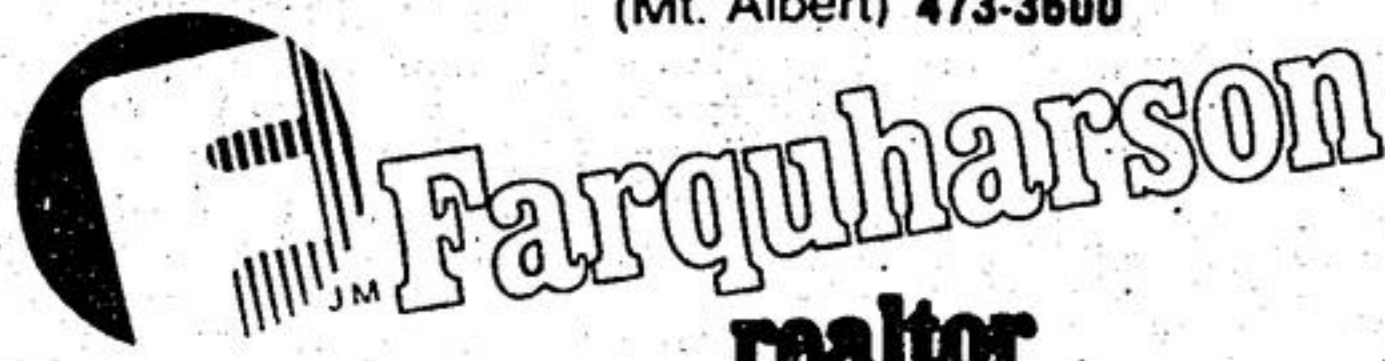

114 Main Street West, Stouffville, Ontario L0H 1L0
"SERVING OUR COMMUNITY SINCE 1956"



COUNTRY FEELING - \$59,900.00
Stouffville north, 2 bedroom bungalow, full basement with finished rec. room and fireplace, plus den or 3rd bedroom, on lovely 90 x 100 tree lot. A pleasure to show at \$59,900.00. Call Alan Kerr.

BE YOUR OWN BOSS
Uxbridge - Thriving Pizza and Sub business in the centre of town on corner lot. Solid brick building with 2 apartments and 2 stores. Asking \$129,500.00. Call John Walley.

JUST LISTED - \$75,900.00
Uxbridge - 5 bedroom brick bungalow, 2 baths, finished rec. room with fireplace, single garage, 54 x 125 landscaped lot. 11 per cent first mortgage. Call Colleen Brown.

TRUCK SIZE GARAGE
Stouffville north - 3 bedroom brick bungalow, wood stove in living room, full basement, 80 x 100 lot, truck size garage with overhead doors. Asking \$64,900.00 Call Alan Kerr.



HURRY - ONLY 2 LEFT
Ballantrae Pines, on 1/2 acre tree lot. Pre-construction prices. Gracious 2500 sq. ft. 2 storey featuring open oak staircase, 3 baths, main floor family room with fireplace, 4 bedrooms, 3 car garage and more. \$145,000.00.

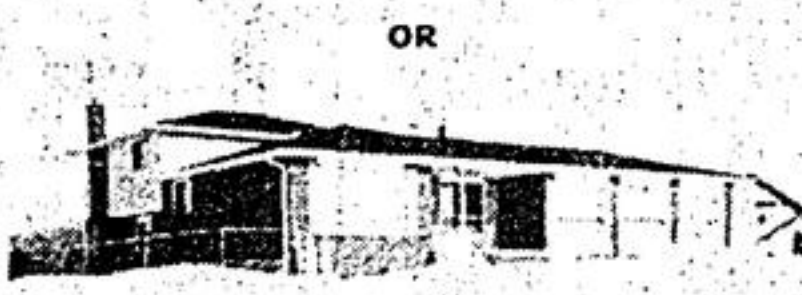

2,000 sq. ft. backsplit featuring 3 baths, 3 bedrooms, den, family room with fireplace and W.O. 2 car garage. Only \$124,900.00. Call John Walley.

UXBRIDGE SOUTH - 1/2 ACRE
Assume \$56,500.00 at 11 per cent and move into this 3 bedroom brick rancher. Quality broadloom, fireplace, 2 car garage. Asking \$84,900.00. Call Sherron Brazier.

54 farm equipment

FARM VALUE PACKAGE
M.F. 265 - 60 h.p. tractor
only 1500 hours, multi power 16.9
- 28 tires, teamed with new M.F. 236
quick attached loader.
Total value package - \$14,500.00
Call Mark Brown
ME
Pemberton Equipment
640-2994

52 poultry/livestock

LANDRACE BOARS & GLTS
From a top R.O.P. herd. Guaranteed and health approved.
A. Stouffer, R.R. 2, Woodville
705-439-2216

55 farm items

DEAD HORSES OR AND CRIPPLED CATTLE
Picked up promptly
CALL WOODVILLE
705-439-2421
Radio Dispatched Trucks
For better service
ED PECONI & SONS
LTD.
Woodville, Ont.
Licence No. 324C67

57 business services

ROSENBERG & COMPANY
Chartered Accountants
84 Yonge St. S.
Aurora
Phone 883-1664

55 farm items

DEAD HORSES OR AND CRIPPLED CATTLE
Picked up promptly
CALL WOODVILLE
705-439-2421
Radio Dispatched Trucks
For better service
ED PECONI & SONS
LTD.
Woodville, Ont.
Licence No. 324C67

57 business services

ROSENBERG & COMPANY
Chartered Accountants
22 Main St. West
Stouffville, Ontario
Resident Partner
S. Kusatz, C.A.
640-1991

55 farm items

DEAD HORSES OR AND CRIPPLED CATTLE
Picked up promptly
CALL WOODVILLE
705-439-2421
Radio Dispatched Trucks
For better service
ED PECONI & SONS
LTD.
Woodville, Ont.
Licence No. 324C67

57 business services

ROSENBERG & COMPANY
Chartered Accountants
22 Main St. West
Stouffville, Ontario
Resident Partner
S. Kusatz, C.A.
640-1991

55 farm items

DEAD HORSES OR AND CRIPPLED CATTLE
Picked up promptly
CALL WOODVILLE
705-439-2421
Radio Dispatched Trucks
For better service
ED PECONI & SONS
LTD.
Woodville, Ont.
Licence No. 324C67

57 business services

ROSENBERG & COMPANY
Chartered Accountants
22 Main St. West
Stouffville, Ontario
Resident Partner
S. Kusatz, C.A.
640-1991

55 farm items

DEAD HORSES OR AND CRIPPLED CATTLE
Picked up promptly
CALL WOODVILLE
705-439-2421
Radio Dispatched Trucks
For better service
ED PECONI & SONS
LTD.
Woodville, Ont.
Licence No. 324C67

57 business services

ROSENBERG & COMPANY
Chartered Accountants
22 Main St. West
Stouffville, Ontario
Resident Partner
S. Kusatz, C.A.
640-1991

55 farm items

DEAD HORSES OR AND CRIPPLED CATTLE
Picked up promptly
CALL WOODVILLE
705-439-2421
Radio Dispatched Trucks
For better service
ED PECONI & SONS
LTD.
Woodville, Ont.
Licence No. 324C67

57 business services

ROSENBERG & COMPANY
Chartered Accountants
22 Main St. West
Stouffville, Ontario
Resident Partner
S. Kusatz, C.A.
640-1991

55 farm items

DEAD HORSES OR AND CRIPPLED CATTLE
Picked up promptly
CALL WOODVILLE
705-439-2421
Radio Dispatched Trucks
For better service
ED PECONI & SONS
LTD.
Woodville, Ont.
Licence No. 324C67

57 business services

ROSENBERG & COMPANY
Chartered Accountants
22 Main St. West
Stouffville, Ontario
Resident Partner
S. Kusatz, C.A.
640-1991

55 farm items

DEAD HORSES OR AND CRIPPLED CATTLE
Picked up promptly
CALL WOODVILLE
705-439-2421
Radio Dispatched Trucks
For better service
ED PECONI & SONS
LTD.
Woodville, Ont.
Licence No. 324C67

57 business services

ROSENBERG & COMPANY
Chartered Accountants
22 Main St. West
Stouffville, Ontario
Resident Partner
S. Kusatz, C.A.
640-1991

55 farm items

DEAD HORSES OR AND CRIPPLED CATTLE
Picked up promptly
CALL WOODVILLE
705-439-2421
Radio Dispatched Trucks
For better service
ED PECONI & SONS
LTD.
Woodville, Ont.
Licence No. 324C67

57 business services

ROSENBERG & COMPANY
Chartered Accountants
22 Main St. West
Stouffville, Ontario
Resident Partner
S. Kusatz, C.A.
640-1991

55 farm items

DEAD HORSES OR AND CRIPPLED CATTLE
Picked up promptly
CALL WOODVILLE
705-439-2421
Radio Dispatched Trucks
For better service
ED PECONI & SONS
LTD.
Woodville, Ont.
Licence No. 324C67

57 business services

ROSENBERG & COMPANY
Chartered Accountants
22 Main St. West
Stouffville, Ontario
Resident Partner
S. Kusatz, C.A.
640-1991

55 farm items

DEAD HORSES OR AND CRIPPLED CATTLE
Picked up promptly
CALL WOODVILLE
705-439-2421
Radio Dispatched Trucks
For better service
ED PECONI & SONS
LTD.
Woodville, Ont.
Licence No. 324C67

57 business services

ROSENBERG & COMPANY
Chartered Accountants
22 Main St. West
Stouffville, Ontario
Resident Partner
S. Kusatz, C.A.
640-1991

55 farm items

DEAD HORSES OR AND CRIPPLED CATTLE
Picked up promptly
CALL WOODVILLE
705-439-2421
Radio Dispatched Trucks
For better service
ED PECONI & SONS
LTD.
Woodville, Ont.
Licence No. 324C67

57 business services

ROSENBERG & COMPANY
Chartered Accountants
22 Main St. West
Stouffville, Ontario
Resident Partner
S. Kusatz, C.A.
640-1991

55 farm items

DEAD HORSES OR AND CRIPPLED CATTLE
Picked up promptly
CALL WOODVILLE
705-439-2421
Radio Dispatched Trucks
For better service
ED PECONI & SONS
LTD.
Woodville, Ont.
Licence No. 324C67

57 business services

ROSENBERG & COMPANY
Chartered Accountants
22 Main St. West
Stouffville, Ontario
Resident Partner
S. Kusatz, C.A.
640-1991

55 farm items

DEAD HORSES OR AND CRIPPLED CATTLE
Picked up promptly
CALL WOODVILLE
705-439-2421
Radio Dispatched Trucks
For better service
ED PECONI & SONS
LTD.
Woodville, Ont.
Licence No. 324C67

57 business services

ROSENBERG & COMPANY
Chartered Accountants
22 Main St. West
Stouffville, Ontario
Resident Partner
S. Kusatz, C.A.
640-1991

55 farm items

DEAD HORSES OR AND CRIPPLED CATTLE
Picked up promptly
CALL WOODVILLE
705-439-2421
Radio Dispatched Trucks
For better service
ED PECONI & SONS
LTD.
Woodville, Ont.
Licence No. 324C67

57 business services

ROSENBERG & COMPANY
Chartered Accountants
22 Main St. West
Stouffville, Ontario
Resident Partner
S. Kusatz, C.A.
640-1991

55 farm items

DEAD HORSES OR AND CRIPPLED CATTLE
Picked up promptly
CALL WOODVILLE
705-439-2421
Radio Dispatched Trucks
For better service
ED PECONI & SONS
LTD.
Woodville, Ont.
Licence No. 324C67

81 articles for sale

LUMBER FOR SALE
Special
Dressed Spruce
1x4 random - 9 cents ft.,
1x6 random - 14 cents ft.,
1x8 20 cents ft., 1x10 24
cents ft., 2x4x8 - 89 cents
each, 2x4 random - 14
cents ft., 2x6 random - 23
cents ft., 2x8 random - 34
cents ft., 2x10 random - 43
cents ft., 2x12 random - 46
cents ft., 2x8 R Hem. 48
cents ft., 6x8 R Hemlock -
80 cents ft., 6x8 R
Hemlock - \$1.05 ft. A good
grade of economy lum-
ber. Plus taxes. Century
Mill Industrial Lumber
Ltd. 4 miles west of
Stouffville on Gormley
Road. Phone 640-2350. TF53

81 articles for sale

LUMBER FOR SALE
Special
Dressed Spruce
1x4 random - 9 cents ft.,
1x6 random - 14 cents ft.,
1x8 20 cents ft., 1x10 24
cents ft., 2x4x8 - 89 cents
each, 2x4 random - 14
cents ft., 2x6 random - 23
cents ft., 2x8 random - 34
cents ft., 2x10 random - 43
cents ft., 2x12 random - 46
cents ft., 2x8 R Hem. 48
cents ft., 6x8 R Hemlock -
80 cents ft., 6x8 R
Hemlock - \$1.05 ft. A good
grade of economy lum-
ber. Plus taxes. Century
Mill Industrial Lumber
Ltd. 4 miles west of
Stouffville on Gormley
Road. Phone 640-2350. TF53

81 articles for sale

LUMBER FOR SALE
Special
Dressed Spruce
1x4 random - 9 cents ft.,
1x6 random - 14 cents ft.,
1x8 20 cents ft., 1x10 24
cents ft., 2x4x8 - 89 cents
each, 2x4 random - 14
cents ft., 2x6 random - 23
cents ft., 2x8 random - 34
cents ft., 2x10 random - 43
cents ft., 2x12 random - 46
cents ft., 2x8 R Hem. 48
cents ft., 6x8 R Hemlock -
80 cents ft., 6x8 R
Hemlock - \$1.05 ft. A good
grade of economy lum-
ber. Plus taxes. Century
Mill Industrial Lumber
Ltd. 4 miles west of
Stouffville on Gormley
Road. Phone 640-2350. TF53

81 articles for sale

LUMBER FOR SALE
Special
Dressed Spruce
1x4 random - 9 cents ft.,
1x6 random - 14 cents ft.,
1x8 20 cents ft., 1x10 24
cents ft., 2x4x8 - 89 cents
each, 2x4 random - 14
cents ft., 2x6 random - 23
cents ft., 2x8 random - 34
cents ft., 2x10 random - 43
cents ft., 2x12 random - 46
cents ft., 2x8 R Hem. 48
cents ft., 6x8 R Hemlock -
80 cents ft., 6x8 R
Hemlock - \$1.05 ft. A good
grade of economy lum-
ber. Plus taxes. Century
Mill Industrial Lumber
Ltd. 4 miles west of
Stouffville on Gormley
Road. Phone 640-2350. TF53

81 articles for sale

LUMBER FOR SALE
Special
Dressed Spruce
1x4 random - 9 cents ft.,
1x6 random - 14 cents ft.,
1x8 20 cents ft., 1x10 24
cents ft., 2x4x8 - 89 cents
each, 2x4 random - 14
cents ft., 2x6 random - 23
cents ft., 2x8 random - 34
cents ft., 2x10 random - 43
cents ft., 2x12 random - 46
cents ft., 2x8 R Hem. 48
cents ft., 6x8 R Hemlock -
80 cents ft., 6x8 R
Hemlock - \$1.05 ft. A good
grade of economy lum-
ber. Plus taxes. Century
Mill Industrial Lumber
Ltd. 4 miles west of
Stouffville on Gormley
Road. Phone 640-2350. TF53

81 articles for sale

LUMBER FOR SALE
Special
Dressed Spruce
1x4 random - 9 cents ft.,
1x6 random - 14 cents ft.,
1x8 20 cents ft., 1x10 24
cents ft., 2x4x8 - 89 cents
each, 2x4 random - 14
cents ft., 2x6 random - 23
cents ft., 2x8 random - 34
cents ft., 2x10 random - 43
cents ft., 2x12 random - 46
cents ft., 2x8 R Hem. 48
cents ft., 6x8 R Hemlock -
80 cents ft., 6x8 R
Hemlock - \$1.05 ft. A good
grade of economy lum-
ber. Plus taxes. Century
Mill Industrial Lumber
Ltd. 4 miles west of
Stouffville on Gormley
Road. Phone 640-2350. TF53

81 articles for sale

LUMBER FOR SALE
Special
Dressed Spruce
1x4 random - 9 cents ft.,
1x6 random - 14 cents ft.,
1x8 20 cents ft., 1x10 24
cents ft., 2x4x8 - 89 cents
each, 2x4 random - 14
cents ft., 2x6 random - 23
cents ft., 2x8 random - 34
cents ft., 2x10 random - 43
cents ft., 2x12 random - 46
cents ft., 2x8 R Hem. 48
cents ft., 6x8 R Hemlock -
80 cents ft., 6x8 R
Hemlock - \$1.05 ft. A good
grade of economy lum-
ber. Plus taxes. Century
Mill Industrial Lumber
Ltd. 4 miles west of
Stouffville on Gormley
Road. Phone 640-2350. TF53

81 articles for sale

LUMBER FOR SALE
Special
Dressed Spruce
1x4 random - 9 cents ft.,
1x6 random - 14 cents ft.,
1x8 20 cents ft., 1x10 24
cents ft., 2x4x8 - 89 cents
each, 2x4 random - 14
cents ft., 2x6 random - 23
cents ft., 2x8 random - 34
cents ft., 2x10 random - 43
cents ft., 2x12 random - 46
cents ft., 2x8 R Hem. 48
cents ft., 6x8 R Hemlock -
80 cents ft., 6x8 R
Hemlock - \$1.05 ft. A good
grade of economy lum-
ber. Plus taxes. Century
Mill Industrial Lumber
Ltd. 4 miles west of
Stouffville on Gormley
Road. Phone 640-2350. TF53

81 articles for sale

LUMBER FOR SALE
Special
Dressed Spruce
1x4 random - 9 cents ft.,
1x6 random - 14 cents ft.,
1x8 20 cents ft., 1x10 24
cents ft., 2x4x8 - 89 cents
each, 2x4 random - 14
cents ft., 2x6 random - 23
cents ft., 2x8 random - 34
cents ft., 2x10 random - 43
cents ft., 2x12 random - 46
cents ft., 2x8 R Hem. 48
cents ft., 6x8 R Hemlock -
80 cents ft., 6x8 R
Hemlock - \$1.05 ft. A good
grade of economy lum-
ber. Plus taxes. Century
Mill Industrial Lumber
Ltd. 4 miles west of
Stouffville on Gormley
Road. Phone 640-2350. TF53

81 articles for sale

LUMBER FOR SALE
Special
Dressed Spruce
1x4 random - 9 cents ft.,
1x6 random - 14 cents ft.,
1x8 20 cents ft., 1x10 24
cents ft., 2x4x8 - 89 cents
each, 2x4 random - 14
cents ft., 2x6 random - 23
cents ft., 2x8 random - 34
cents ft., 2x10 random - 43
cents ft., 2x12 random - 46
cents ft., 2x8 R Hem. 48
cents ft., 6x8 R Hemlock -
80 cents ft., 6x8 R
Hemlock - \$1.05 ft. A good
grade of economy lum-
ber. Plus taxes. Century
Mill Industrial Lumber
Ltd. 4 miles west of
Stouffville on Gormley
Road. Phone 640-2350. TF53

81 articles for sale

LUMBER FOR SALE
Special
Dressed Spruce
1x4 random - 9 cents ft.,
1x6 random - 14 cents ft.,
1x8 20 cents ft., 1x10 24
cents ft., 2x4x8 - 89 cents
each, 2x4 random - 14
cents ft., 2x6 random - 23
cents ft., 2x8 random - 34
cents ft., 2x10 random - 43
cents ft., 2x12 random - 46
cents ft., 2x8 R Hem. 48
cents ft., 6x8 R Hemlock -
80 cents ft., 6x8 R
Hemlock - \$1.05 ft. A good
grade of economy lum-
ber. Plus taxes. Century
Mill Industrial Lumber
Ltd. 4 miles west of
Stouffville on Gormley
Road. Phone 640-2350. TF53

81 articles for sale

LUMBER FOR SALE
Special
Dressed Spruce
1x4 random - 9 cents ft.,
1x6 random - 14 cents ft.,
1x8 20 cents ft., 1x10 24
cents ft., 2x4x8 - 89 cents
each, 2x4 random - 14
cents ft., 2x6 random - 23
cents ft., 2x8 random - 34
cents ft., 2x10 random - 43
cents ft., 2x12 random - 46
cents ft., 2x8 R Hem. 48
cents ft., 6x8 R Hemlock -
80 cents ft., 6x8 R
Hemlock - \$1.05 ft. A good
grade of economy lum-
ber. Plus taxes. Century
Mill Industrial Lumber
Ltd. 4 miles west of
Stouffville on Gormley
Road. Phone 640-2350. TF53

81 articles for sale

LUMBER FOR SALE
Special
Dressed Spruce
1x4 random - 9 cents ft.,
1x6 random - 14 cents ft.,
1x8 20 cents ft., 1x10 24
cents ft., 2x4x8 - 89 cents
each, 2x4 random - 14
cents ft., 2x6 random - 23
cents ft., 2x8 random - 34
cents ft., 2x10 random - 43
cents ft., 2x12 random - 46
cents ft., 2x8 R Hem. 48
cents ft., 6x8 R Hemlock -
80 cents ft., 6x8 R
Hemlock - \$1.05 ft. A good
grade of economy lum-
ber. Plus taxes. Century
Mill Industrial Lumber
Ltd. 4 miles west of
Stouffville on Gormley
Road. Phone 640-2350. TF53

81 articles for sale

LUMBER FOR SALE
Special
Dressed Spruce
1x4 random - 9 cents ft.,
1x6 random - 14 cents ft.,
1x8 20 cents ft., 1x10 24
cents ft., 2x4x8 - 89 cents
each, 2x4 random - 14
cents ft., 2x6 random - 23
cents ft., 2x8 random - 34
cents ft., 2x10 random - 43
cents ft., 2x12 random - 46
cents ft., 2x8 R Hem. 48
cents ft., 6x8 R Hemlock -
80 cents ft., 6x8 R
Hemlock - \$1.05 ft. A good
grade of economy lum-
ber. Plus taxes. Century
Mill Industrial Lumber
Ltd. 4 miles west of
Stouffville on Gormley
Road. Phone 640-2350. TF53

81 articles for sale

LUMBER FOR SALE
Special
Dressed Spruce
1x4 random - 9 cents ft.,
1x6 random - 14 cents ft.,
1x8 20 cents ft., 1x10 24
cents ft., 2x4x8 - 89 cents
each, 2x4 random - 14
cents ft., 2x6 random - 23
cents ft., 2x8 random - 34
cents ft., 2x10 random - 43
cents ft., 2x12 random - 46
cents ft., 2x8 R Hem. 48
cents ft., 6x8 R Hemlock -
80 cents ft., 6x8 R
Hemlock - \$1.05 ft. A good
grade of economy lum-
ber. Plus taxes. Century
Mill Industrial Lumber
Ltd. 4 miles west of
Stouffville on Gormley
Road. Phone 640-2350. TF53

81 articles for sale

LUMBER FOR SALE
Special
Dressed Spruce
1x4 random - 9 cents ft.,
1x6 random - 14 cents ft.,
1x8 20 cents ft., 1x10 24
cents ft., 2x4x8 - 89 cents
each, 2x4 random - 14
cents ft., 2x6 random - 23
cents ft., 2x8 random - 34
cents ft., 2x10 random - 43
cents ft., 2x12 random - 46
cents ft., 2x8 R Hem. 48
cents ft., 6x8 R Hemlock -
80 cents ft., 6x8 R
Hemlock - \$1.05 ft. A good
grade of economy lum-
ber. Plus taxes. Century
Mill Industrial Lumber
Ltd. 4 miles west of
Stouffville on Gormley
Road. Phone 640-2350. TF53

81 articles for sale

LUMBER FOR SALE
Special
Dressed Spruce
1x4 random - 9 cents ft.,
1x6 random - 14 cents ft.,
1x8 20 cents ft., 1x10 24
cents ft., 2x4x8 - 89 cents
each, 2x4 random - 14
cents ft., 2x6 random - 23
cents ft., 2x8 random - 34
cents ft., 2x10 random - 43
cents ft., 2x12 random - 46
cents ft., 2x8 R Hem. 48
cents ft., 6x8 R Hemlock -
80 cents ft., 6x8 R
Hemlock - \$1.05 ft. A good
grade of economy lum-
ber. Plus taxes. Century
Mill Industrial Lumber
Ltd. 4 miles west of
Stouffville on Gormley
Road. Phone 640-2350. TF53

81 articles for sale

LUMBER FOR SALE
Special
Dressed Spruce
1x4 random - 9 cents ft.,
1x6 random - 14 cents ft.,
1x8 20 cents ft., 1x10 24
cents ft., 2x4x8 - 89 cents
each, 2x4 random - 14
cents ft., 2x6 random - 23
cents ft., 2x8 random - 34
cents ft., 2x10 random - 43
cents ft., 2x12 random - 46
cents ft., 2x8 R Hem. 48
cents ft., 6x8 R Hemlock -
80 cents ft., 6x8 R
Hemlock - \$1.05 ft. A good
grade of economy lum-
ber. Plus taxes. Century
Mill Industrial Lumber
Ltd