

# Second Section Election Special

## Town of Whitchurch-Stouffville

### Candidates for mayor



Norman Barnard



Eldred King



Kenneth Laushway



Jim McKellar

### Ward 1



Betty vanNostrand



Stuart Starr

### Ward 3



Merlyn Baker



Henry Nauta

### Ward 5



June Button



John Garbutt



Stephen Kettle

### Public School Board



Arthur Starr



John McMurray

### Separate School Board



John McDermott



Molly McManingwell

### Home owns you

DICKSON'S HILL - "With the high tax rate on real property," com-

mented Mayoralty candidate, Alma Walker, at a candidates' meeting in Dickson's Hill, Monday, "you no longer own your home, it owns you".

### Whitchurch-Stouffville

## Poll locations

WHITCHURCH-STOUFFVILLE: Nine polling subdivisions have been established in the six wards for electoral purposes, Monday, Oct. 5.

The hours extend from 10 a.m., to 7 p.m. The locations of the polls are as follows: Ward 1 - Cedar Valley Post Office; Vandorf Community Hall. Ward 2 - Earl Grose Residence, Vivian; Cedar Beach Pavilion, Musselman's Lake. Ward 3 - Rolling Hills Golf Club, Bethesda; Bruce Burton Residence, Lemonville. Ward 4 - Masonic Hall, 9th Line North, Stouffville. Ward 5 - Fire Hall, Main Street East, Stouffville. Ward 6 - Municipal Office, Civic Avenue, Stouffville.

## Two-year term

WHITCHURCH-STOUFFVILLE: On Jan. 1, 1971, the duties of both the Regional Council (upper tier) and Local Council (lower tier) will officially begin. Members elected Oct. 5 will hold office for two years, 1971 and 1972.

For the Town of Whitchurch-Stouffville, the Mayor will sit at the regional level. The local council will comprise a Mayor and six councillors, 1 from each Ward.

The Whitchurch-Stouffville Area will elect one trustee to the York County Board of Education and one trustee to the York County Separate School Board of Education. The latter will also represent the Township of East Gwillimbury.

### Regional council meets Oct. 14

YORK REGION - The inaugural meeting of the York Regional Council will be held Oct. 14 at Bayview Secondary School. Chairman Garfield Wright announced this week. Hon. Darcy McKeough, Minister of Municipal Affairs will attend along with Deputy Minister, W.H. Palmer.

The Regional Council has until Jan. 1, 1971 to complete its organizational tasks, Mr. Wright said. The names of those elected to this level of government will be known when returns come in, Oct. 5.

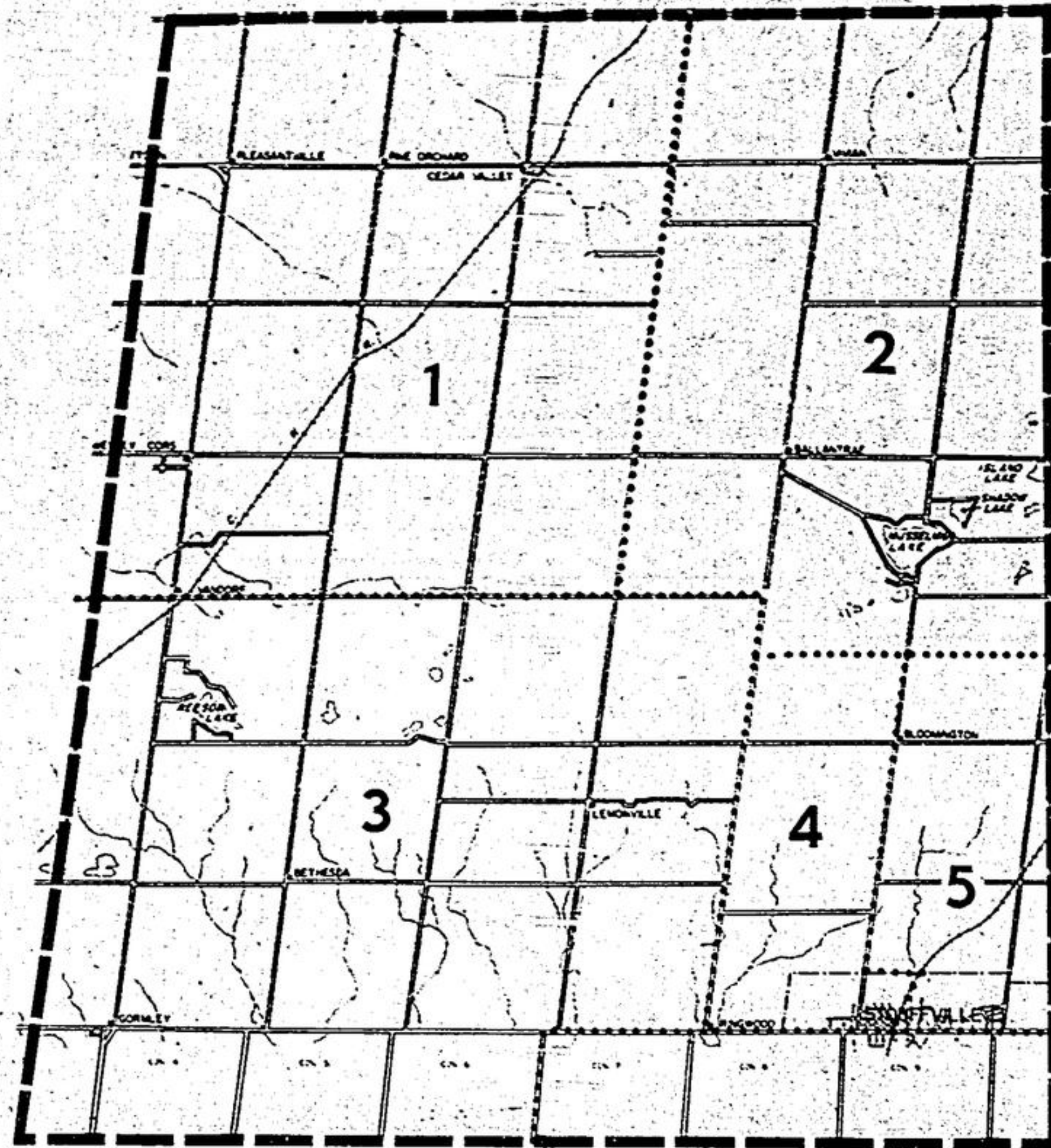

The Area of Whitchurch-Stouffville has been divided into six wards for electoral purposes. The location of polling subdivisions are listed elsewhere on this page. Election date is Monday, Oct. 5.



The Town of Markham Area is divided into six wards, extending from Mongolia to Thornhill. The Area has 17,500 eligible voters. Election date is Monday, Oct. 5.

## Town of Markham Where to vote

MARKHAM - On Monday, Oct. 5, more than 17,500 voters will be eligible to cast a ballot in the new Town of Markham Area, a municipality that extends from Mongolia on the north-east to Thornhill on the south-west. The council will comprise a Mayor, two representatives at the Regional and Local level and one councillor for each of six Wards. Also to be elected are four members to the York County Public School Board of Education.

The following polling subdivisions have been established by wards. Ward 1 - Vito's Hair-stylists, Highland Park; Woodland Jr. Public School; Henderson Ave. Public School; York Farmers' Market; Bayview Glen Public School; German Mills Community Hall. Ward 2 - North Thornhill Community Centre; Thompson Residence, Langstaff; German Mills Community Hall. Ward 3 - David Gough Residence, conc. 5 and Steeles; Heemsherk Residence, conc. 5, at Hwy. 7; Buttonville W.I. Hall; Walton Residence, 14th Avenue and Kennedy Road; Parkview Jr. Public School(2); Veterans' Hall, Unionville. Ward 4 - Markham Centennial Library; James Robinson Public School (3); Roy H. Crosby Public School; Veterans' Hall, Markham. Ward 5 - Box Grove Community Hall, (2); Veterans' Hall, Markham; Franklin St. Public School (2); Wm. Armstrong Public School (2). Ward 6 - Community Hall, Victoria Square (2); Markham Museum; Wm. Grove Residence, Dickson's Hill; Cowan Residence, Mongolia. Advance Poll - Municipal Office, Buttonville, Oct. 2 from 4 p.m., to 10 p.m., and Oct. 3 from 10 a.m., to 5 p.m.

## Town of Markham Candidates for Mayor



Alma Walker



Anthony Roman

### Local - Regional Council



Jim Jongeneel



Harold Lawrie



Albert Laidlaw

### Candidates - Town of Markham

MAYOR - Mrs. Alma Walker, Anthony Roman; LOCAL AND REGIONAL COUNCIL (2 to be elected) - Albert Laidlaw, Jim Jongeneel, Harold Lawrie; LOCAL COUNCIL (1 to be elected in each Ward) - WARD 1 - Peter Rossi, Edward Patrick, Wm. Masters, Bob Adams; WARD 2 - Chas. Stewart, Ray Muldrew, Bob Sherwood; WARD 3 - Keith Kennedy (acc.); WARD 4 - 'Bud' Bonner, (acc.); WARD 5 - Robt. McVey, Murray Henderson, Douglas Allison, Jack Morris; WARD 6 - Michael Larkin, Norman Tyndall; PUBLIC SCHOOL BOARD - (4 to be elected) - John Honsberger, Alexander Brown, John MacKay, Mrs. Merna Colbourne, Mrs. Louise Aimone, Clifford Davies;

### Candidates agree on by-pass

DICKSON'S HILL - Both Mayorally candidates, Mrs. Alma Walker and Anthony Roman, Markham Town, are in agreement that a bypass road should be constructed around the police village of Unionville rather than through it. Both replied to the question posed from the floor at a candidates' meeting, Monday night.

### 'Party' politics

DICKSON'S HILL - Markham regional council candidate, Jim Jongeneel, addressed a public meeting in Dickson's Hill School, and was critical of past performances of County Council. He claimed many members were more interested in 'parties' than in projects. He advocated the introduction of 'new blood' to break up the compact of professional politicians.

### Dog-gone-it

DICKSON'S HILL - Mrs. Louise Aimone, candidate seeking re-election to the York County Board of Education, attended a public meeting in Dickson's Hill School with her hand in a cast. She explained that she suffered the injury when she tripped over the family dog.

GO CLASSIFIED

### Election machinery ready to roll

WHITCHURCH-STOUFFVILLE - Under the organization of Returning Officer, Ralph Corner, machinery to put the Oct. 5 election in motion, is all oiled and ready to go.

One phase of this work has been to establish polling booths throughout the Area and selecting deputy-returning officers and poll clerks.

These employees are: Ward 1 - Mrs. Earla Brammer (D.R.O.), Elizabeth Hope, (Poll Clerk); George Richardson (D.R.O.), June Ponting (Poll Clerk).

Ward 2 - Celeste Smalley (D.R.O.), Helen Grose (Poll Clerk), John Wylie (D.R.O.), Alberta Britten, (Poll Clerk); Jean Windsor (D.R.O.), Cora Van Dolder (Poll Clerk).

Ward 3 - Velma Wideman (D.R.O.), Caroline Hoshell (Poll Clerk); Mrs. Christa Nimmo (D.R.O.), Mrs. Phyllis Hunt (Poll Clerk); Lois Hrebik (D.R.O.), Mona Burton (Poll Clerk).

Ward 4 - A.G. Thompson (D.R.O.), Constance Redshaw (Poll Clerk); Mrs. Grace Norton (D.R.O.), Mary Lintner (Poll Clerk).

Ward 5 - Betty Turner (D.R.O.), Evelyn Lehman (Poll Clerk); Mrs. Joan Cadieux (D.R.O.), Olive Daniels (Poll Clerk).

Ward 6 - Aurelia Smith (D.R.O.), Reta McLean (Poll Clerk); Barbara Smith (D.R.O.), Joan Davidson (Poll Clerk).

Advance Poll - Fred Timbers (D.R.O.), Norma Tranter (Poll Clerk).

### Central control

WHITCHURCH-STOUFFVILLE: When the election polls close at 7 p.m., Monday, Oct. 5, the spotlight of attention will turn to 2 locations, the Municipal Office in Stouffville and the Municipal Office at Vandorf.

Staff employees at both centres will post returns as they come in - first to the Returning Officer, Ralph Corner in Stouffville, and then by telephone to Vandorf.

Early results, depending on turnouts, are expected by 7.45 p.m.

While resident ratepayers are welcome to visit 'action central' at any time during the evening, Mr. Corner urges the electorate to refrain from obtaining the vote-count by telephone. This only ties up the line and makes clerical tabulation impossible.

### Advance poll

WHITCHURCH-STOUFFVILLE: For those persons qualified to vote but unable to be in the area on election day, Advance Polls have been set up in the Stouffville Municipal Office, Civic Avenue.

The dates and hours are: Friday, Oct. 2 from 4 p.m., to 10 p.m., and Saturday, Oct. 3 from 10 a.m., to 4 p.m.