

Terrace Bay Schreiber NEWS

Public Library
Terrace Bay Ontario
POT 2W0

C.C.T.F.N.

Vol. 18, No. 22

Wednesday, June 1, 1983

Serving Terrace Bay, Schreiber and Rossport 35¢



Ambulance to be stationed in Terrace Bay

The North Shore Ambulance Service announced last week that it has received approval and funding from the Ministry of Health to base one of its ambulances in Terrace Bay. At present, two ambulances and one emergency support unit are based at the Schreiber Medical Clinic.

A spokesman for North Shore Ambulance said, "A satellite service based in

Terrace will lessen the response time for emergencies in that community and areas east of Terrace Bay."

"It should be understood that a satellite service based in Terrace Bay is an extension of the North Shore Ambulance service that covers all the area from Gravel River in the west, to Steele River in the east. The Terrace Bay based ambulance will respond to an emer-

gency anywhere in this area where they are required, including emergency land transfers to Thunder Bay."

The ambulance service in Terrace Bay will be staffed by residents of the town on a 24 hour stand-by system. The spokesman went on to say that the hiring and training of the new staff would have to be completed before the service would become

operational. "We would not be able to station the ambulance at the hospital immediately. We are going to have to hire someone locally. We will have to put them through a training program. The program is lengthy and they will then require field experience. Because there are so few ambulance calls locally, gaining the necessary field experience would take sometime."

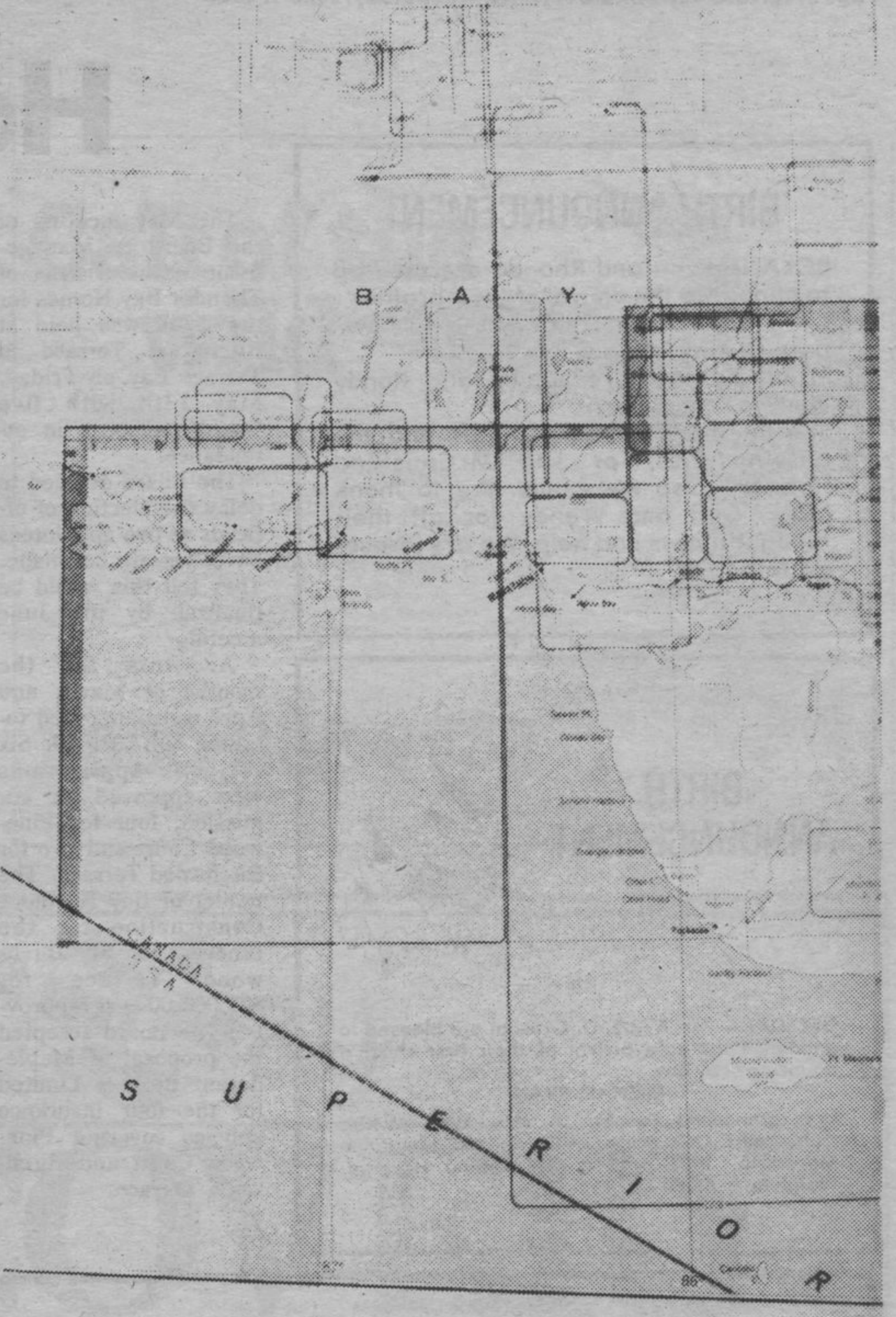

School Board to extend boundaries

The Lake Superior Board of Education completed plans at its regular monthly meeting in Manitowadge to extend its boundaries. The Board area presently includes the communities of Manitowadge, Marathon, Heron Bay, Port Coldwell, Jackfish, Terrace Bay, Schreiber and Rossport.

The proposed changes would drastically increase the area within the Board's jurisdiction, but

would not mean a significant population increase. The change would make the board larger geographically than some countries.

The new boundaries would start in the west at the Canada/US border in Lake Superior and travel north through the mouth of the Gravel River to the 49th parallel. The boundary would then turn east to the south-west corner of Grenville Township, north again to the north-

west tip of Davies Township and then east to the Algoma District boundary. The Eastern Boundary would stretch south along the Algoma District line to the border in Lake Superior. The US border would form the Board's new southern boundary.

The proposed changes have been submitted to the Ministry of Education and the Board is now awaiting word on the Minister's approval of the changes.



Elementary school children from Manitowadge, Marathon, Schreiber and Terrace Bay gathered at the Terrace Bay Campus of Lake Superior High School last

Wednesday for the First annual Festival of Song. The festival was sponsored by the local elementary public schools and saw 170 children perform for the public.

Economic Development Seminars

The second week of June will see major Economic Development seminars held in both Schreiber and Terrace Bay. The seminars are being sponsored by the Municipal Advisory Committee and will be patterned on a similar seminar held for municipal officials in Thunder Bay in June.

The seminars are scheduled for the evening of Monday, June 6 and the morning of Tuesday, June 7 in Schreiber; and the evening of Tuesday, June 7 in Terrace Bay.

Schreiber town councillor Larry Dunwoody has been appointed by Reeve Harold Fischer to

chair the Schreiber session. Dunwoody said that the Monday evening session would run from 6:30 to 10:00 p.m. and include a film from the Ontario Ministry of Tourism and Recreation. "The sessions are wide open to the public and we want to see as many people as

continued on page 8

Terrace Bay Fish Derby

The Second Annual Terrace Bay Fish Derby is all set to go for Saturday, June 4, and Sunday, June 5. This year's Derby is sponsored by Molson Breweries and features prizes in six categories: speckled trout, lake trout, rainbow trout, pickerel,

pike and bass. George Robinson, President of the Terrace Bay District Rod and Gun Club said that the Club is expecting this year's Derby to be even more successful than last year's. "We are planning on handling 250 people per day.

The booth for weighing will be set up at the Aguasabon Trailer Park. The final weigh-in will be on Sunday, June 5, at 6:00 p.m. We are accepting fish caught anywhere in wildlife management unit 21A. That's from Cavers Hill to Mani-

continued on page 2