

**POLICE DEPARTMENT REPORT:** Cont'd from pg. 12  
 On arrival it was found that the dispute had been settled. This resulted in no charges being laid.

While on patrol early Sept. 25th, it was noted that a number of windows in the Recreation Centre had been broken. Investigations are continuing with charges pending.

On Sept. 25th at 5:30 p.m. a vehicle was reported stolen from the Red Dog Inn parking lot. Police recovered the vehicle abandoned on the Main St. of Schreiber.

A motor vehicle collision on Birch Cres. resulted in \$800 damage with one local resident being charged with failing to yield.

During the early hours of Sept. 26, culprits entered Cameron's Texaco and stole a quantity of cigarettes.

The Police Dept. is in possession of two small bicycles. The owners may claim these by identifying them.

**BRIDAL SHOWER**

A Bridal Shower Tea will be held in honour of Miss Linda Power on Saturday, October 2nd from 8:00 p.m. to 10:00 p.m. in the Anglican Church Hall, Schreiber. Everyone welcome.

**ROYAL CANADIAN LEGION  
 OPERATION SERVICE**

**(TO WAR VETERANS, EX-SERVICE PERSONNEL, THEIR WIDOWS AND DEPENDANTS ONLY.)**

The Department of Veterans Affairs have lost contact with many Ex-service persons and their dependants throughout Canada. A Survey is being conducted to determine if any of these people are in need of assistance. This may include information regarding: the Pension Act, War Veterans Allowance, Medical treatment, educational assistance, Canada Pension, Old Age Pension, etc. To inform you of these rights and privileges is part of the Royal Canadian Legion's national program.

For further information leave your name and phone number with:

**ROYAL CANADIAN LEGION**

SCHREIBER 824-2872

G.A. Nicol - President, L.V. Bourke - Sec.-Treas.

TERRACE BAY Contact Paul Coupal.  
 Bill Kujbida - President.

**HELP US**

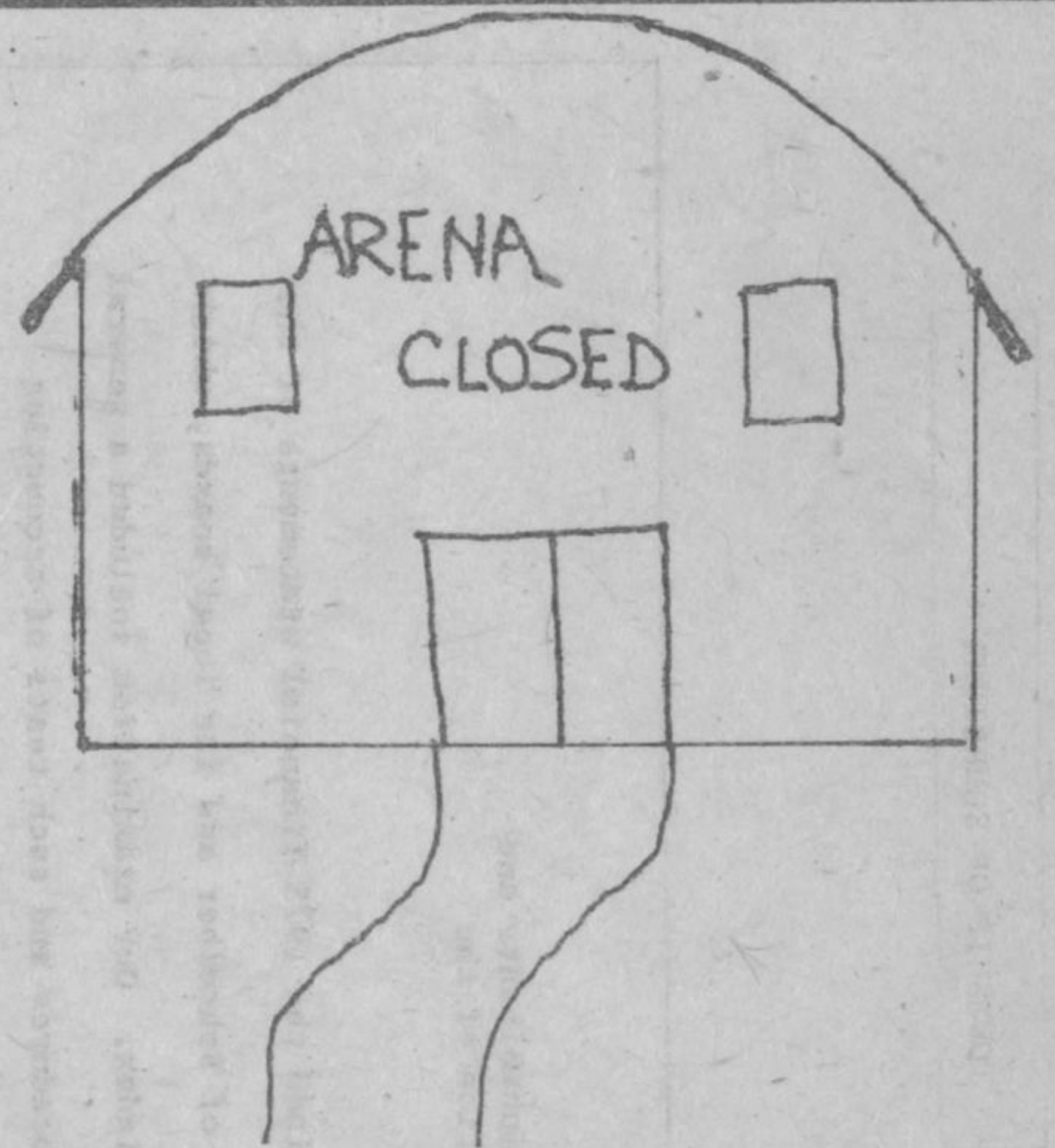

**GET INVOLVED**

- \*SCHREIBER MINOR HOCKEY ASSOCIATION
- \*SCHREIBER JUNIOR HOCKEY CLUB
- \*SCHREIBER FIGURE SKATING CLUB
- \*SCHREIBER ARTIFICIAL ICE COMMITTEE