

# SAVEWAY LUMBER CEDAR PICNIC TABLE

HWY. NO. 7 & COSTA RD  
SOUTH OF HIGHWAY NO. 7 - BETWEEN KEELE STREET & JANE STREET

PHONE  
669-2297

## LUMBER & BUILDING SUPPLIES TABLE

### PLYWOOD PANELING

These plywood panels are factory seconds with only slight defects.

4'x8' Sheets **3.95** SHEET

### NO. 1 GRADE PANELING

Durable Easy to Clean Finish Available in: Hickory, Butter Walnut, Blond Elm and Sandalwood.

4'x8' **4.79** each

### HUNTER DOUGLAS PANELING

No. 1 Quality KNOTTY CEDAR KNOTTY PINE PECAN & VALLEY ELM

4'x8' sheet **5.99** each

### BIRCH PREFINISHED PANELLING

The time is right. The price is right. Now you can add the beauty and warmth of BIRCH PANELING TO HOME OR COTTAGE INTERIORS. These 4x8 Panels are easy to install. Come in.

4x8 sheet **9.95** sheet

This 70" Cedar Table has 2" thick top and seats 6 people. It is precut and ready for easy assembly in the backyard or at the cottage.

**29.50** each



## WINDOWS

### SASHLESS SLIDER WINDOWS

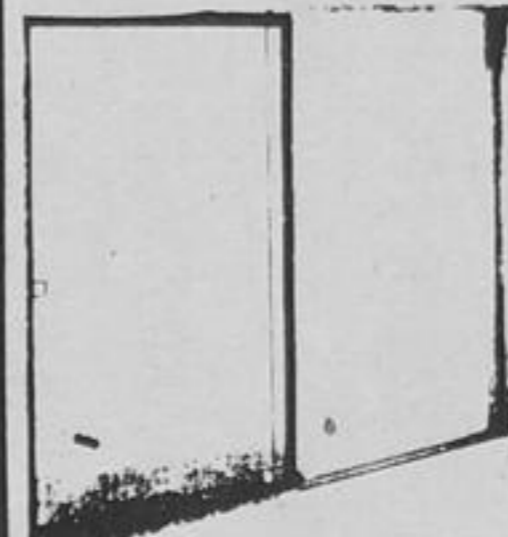

COMPLETELY ASSEMBLED  
READY TO OPERATE

#### DOUBLE GLAZED WITH SCREEN WEATHERSTRIPPING & HARDWARE

C.M.H.C. 5351 \*Selected Ponderosa Pine Frame is toxic treated\* Complete with copper-tone half screen in black fiberglass\* Positive burglar proof security lock and acrylic pull handles \*Double glazed with two pair of sliding glass panels \*Jamb width 3 1/2" with outside casing installed

ORDERING CODE NUMBER	ROUGH OPENING SIZE	SPECIAL PRICE
2620	33 1/2 x 28	\$38.20
326	39 1/2 x 34	45.68
426	51 1/2 x 34	54.92
430	51 1/2 x 40	58.80
526	63 1/2 x 34	63.14
530	63 1/2 x 40	69.15

### PATIO DOORS

Anodized 3/16" satin finish aluminum-glazed 3/16" tempered safety glass - Weather stripped. Includes two doors, one stationary and one operating. R.S.O. 5' 11 5/8" x 6' 8 3/4"

ALUMINUM

**205<sup>11</sup>**

WOOD

**334<sup>61</sup>**

### PLASTIC LAMINATE

SAME AS ARBORITE SHEETS BLACK TEXTURE FINISH

4'x8' sheet

**6.88** each

### P.V.C. CORRUGATED PLASTIC PANELS

FOR PATIO ROOFS CARPORTS AND FENCING. YELLOW & WHITE

26" x 96"

**1.90** panel

### CEDAR PICKET GATES

36" wide x 42" High

**3.95** each

### TOMATO STAKES

48" LONG 30 PIECE BUNDLE

**1.99** BUNDLE

### EXPANDABLE TRELLIS FENCING

12" x 11"..... 1.75  
24" x 11"..... 3.25  
48" x 11"..... 5.95

### SUPER

patio and carports...roofs and fences

### FIBREGLASS PANELS

COLOURS AS AVAILABLE

26" x 96" **5.95**  
26" x 120" **7.45**  
26" x 144" **8.95**

**SAVE**

### 210 lb. ASPHALT SHINGLES

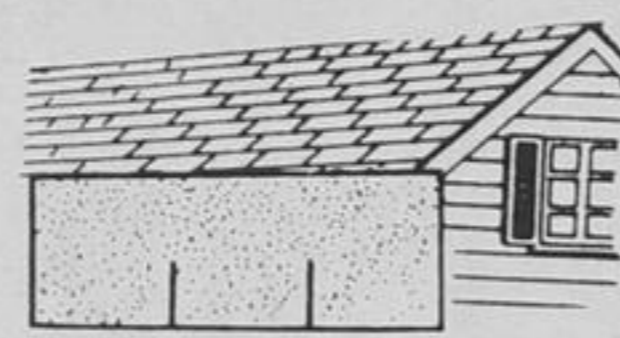

- 210 lb. PER SQUARE
- No. 1 QUALITY-NO SECONDS
- CMHC APPROVED
- AVAILABLE IN BLACK, WHITE AND GREEN

**14.50** Per 100 Sq. Ft.

## CEILINGS

### SUSPENDED CEILING SYSTEMS

MAIN BEAM 12' **1.67** CROSS TEE 2' **28¢**  
CROSS BEAM 4' **57¢** WALL ANGLE 12' **1.16**



Ideal for lowering those high ceiling or hiding water pipes, duct-work, etc.

#### 2x4' LAY-IN PANELS PKG. OF 12 TILES

PLAIN WHITE **15.44** ctn. MICRO PERF **19.59** ctn. FISSURED\* **22.54** ctn. \*10 FISSURED PANELS PER CTN.

### TILEBOARD

These 4' x 3' x 1/8 sheets are ideal for the Kitchen, Bathroom, in home or cottage. Another outstanding Save-way Value.

4" Squares **6.99** 2" Squares **10.95** Plain **11.95**

### ECONOMY SPRUCE STUDS

### 2"x4" STUDS

92 5/8" to 96" long **64¢** each

WE WELCOME

CHARGEX



CREDIT CARDS



LUMBER and BUILDING SUPPLIES

NORTH HWY. 7 & COSTA RD.



Plenty of FREE Parking

THESE PRICES IN EFFECT WEDNESDAY, JUNE 18 to TUESDAY JUNE 24 OR WHILE QUANTITIES LAST AT OUR HWY. 7 & COSTA ROAD STORE