

DESIGN for LIVING

Private Master Suite

© Copyright
SELECT HOME DESIGNS

- Attention to detail is given to all elevation options of this spacious four-bedroom home.
- Special mouldings and trim add interest to nine-foot ceilings on main floor.
- Dining room with tray ceiling is separated from living room by decorative columns.
- Centrally located kitchen features large cooking island, pantry, telephone desk and an abundance of cupboard and counter space.
- Private master suite boasts his and hers walk-in closets and roomy master bath.
- Optional adjacent exercise room offers an additional 214 sq.ft.
- Main bath with double-size vanity is conveniently located to other three bedrooms.

To receive a 300 page plan book for only \$9.95 (including shipping and GST) featuring this design and more than 400 other beautifully illustrated home and cottage designs, call 1-800-663-6739, fax (604) 251-3212 or e-mail to: selecthomedesigns@msn.com (specify newspaper name). We accept Visa/Mastercard/AMEX. For payment via cheque or money order, make payable to Design for Living, c/o this newspaper, send to #301, 611 Alexander Street, Vancouver, B.C., V6A 1E1.



Plan No. 95-2892

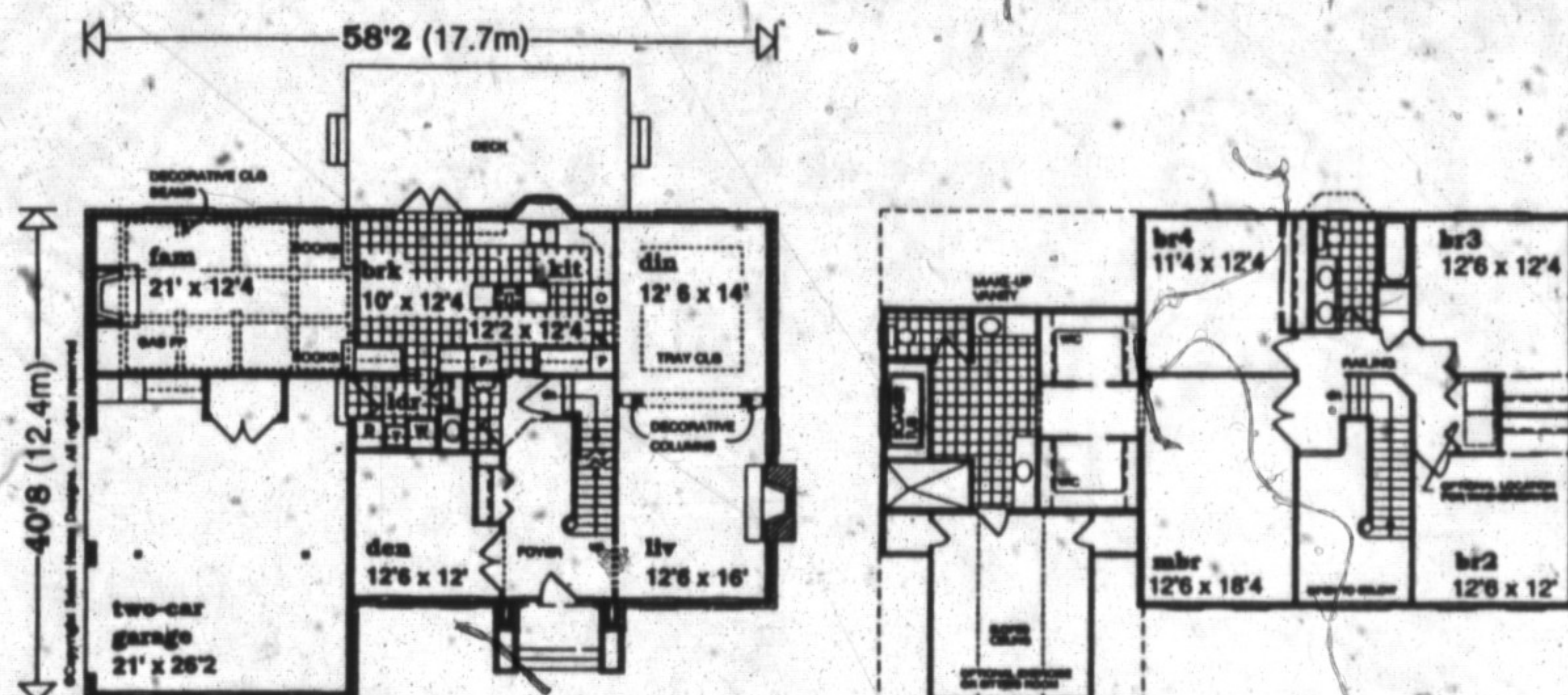

RES—The Canadian Champion, Wednesday, September 18, 1996

RE/MAX MILTOWNE REALTY CORP. *Going Above and Beyond For YOU*

22 Ontario St. S. 878-7777

PMP
PREMIER
MARKET
PRESENCE

Office: 878-7777
Residence: 875-4698
Toronto Line: 825-4485

HEATHER ASHBE-MEEHAN
Sales Representative

COUNTRY BUNGALOW
Finished top to bottom a real gem., insulated garage, I/G pool for those hot days. A must see at \$244,000.

EXECUTIVE CAMPBELLVILLE
1-1/2 acres, landscaped gardens & pond, 4 bedrooms, 4 baths, main floor office. Sunny greenhouse, kitchen, oak hardwood & ceramic main floor.

42 ACRE HOBBY FARM
Very scenic private stream, 30 x 60 6 stall barn and open concept bungalow. A must see. \$359,000.

"TOAD HALL"
10-acre estate. Custom home is a "10" with sep. nanny's quarters. A must see! \$579,000.

RENOVED ARGYLE FARMS
48 acres, complete with renovated homestead, 5 barns, 1/2 mile track & separate apt. — A thriving standard-bred breeding farm.

BETTY INGLE R.R.S.
Sales Representative
Registered Relocation Specialist
Office: 878-7777
Tor. Line: 825-4485

LOVELY 3 BEDROOM TOWNHOUSE
Finished basement, neutral broadloom end unit with garage, air conditioning. A must to see, priced at \$127,900. Phone Betty for your appointment to view.

"YOU'LL BE IMPRESSED"
3 bedroom townhouse with attached garage features a finished basement, fenced yard, freshly painted, upgraded broadloom. Priced at \$127,900, with interest rates down why wait to buy? Phone Betty for an appointment today.

JACK McCRUDDEN
Associate Broker
878-7777

48 ACRES. Priced at \$299,000. This unique property has bed & breakfast operation. A barn for farthing. The home is a large detached 4 bdrm. bungalow with a detached granny suite for that extra family member. Two ponds, bush & lots of grazing space. There are many more amenities to this home.

This home is nicely nestled in a great family neighbourhood. Super upgrades throughout. This home must be seen to be appreciated. Priced at only \$169,900.

FOR LEASE: 1200 sq. ft. industrial unit \$64,000.
FOR SALE: 1585 sq. ft. industrial unit front exposure to Main St. \$64,000.
FOR LEASE: 1800 sq. ft. available immediately \$650 per month.
For information on these please contact:
JACK McCRUDDEN

KATRINA WALTON
SALES REPRESENTATIVE
Office: 878-7777 Res: 878-1588
Tor. Line: 825-4485
Serving Milton Since 1985

NATURE LOVERS PARADISE
A great buy just around the corner from Burns Conservation Area. 25 acres with 500-foot frontage, close to 401. Call today for details. Asking \$151,900.

I have qualified purchasers looking for:

- Semi-detached or link in Timberlea
- Backsplit or Bungalow in older Milton
- Split level or 2 storey in Dorset Park.

If you are interested in selling, please call Katrina.

FLORENCE WALTER
Sales Representative
878-7777 Office
878-0231 Res.
825-4485 Tor. Line

GREAT BEGINNINGS
Desirable area of prestigious homes in Brookville Estates. New 2850 SQ.FT. 2-storey home on 2 acre lot. If you hurry, you can choose the finishes you want. Asking \$329,900. Call me to view.

RE/MAX

for sale SOLD

Don't wait. Call RE/MAX first.
Milton's #1 Real Estate Company
For years & years & years