



DESIGN for LIVING

Spacious vaults to rear

© Copyright
SELECT HOME DESIGNS

- This three bedroom, rear view home expands to a large entertainment size deck.
- Vaulted kitchen includes a windowed eating area, pantry and a pass through with snack bar to dining room
- Master bedroom with bright corner window features its own private three piece ensuite.
- Bedroom three or optional den is conveniently located near the front entry.

Send for Canada's largest plan book with more than 500 home plans, including a wide variety of architectural styles from luxurious brick manors to affordable bungalows, only \$9.95 (including shipping and GST). To order using VISA or MasterCard, call toll-free 1-800-663-6739 or send cheque or money order to Design for Living, c/o The Canadian Champion, 382 West Broadway, Vancouver, B.C., V5Y 1R2. Trained consultants are standing by Monday to Saturday to take your order for the plan book, or to provide information about the plan featured in this column.

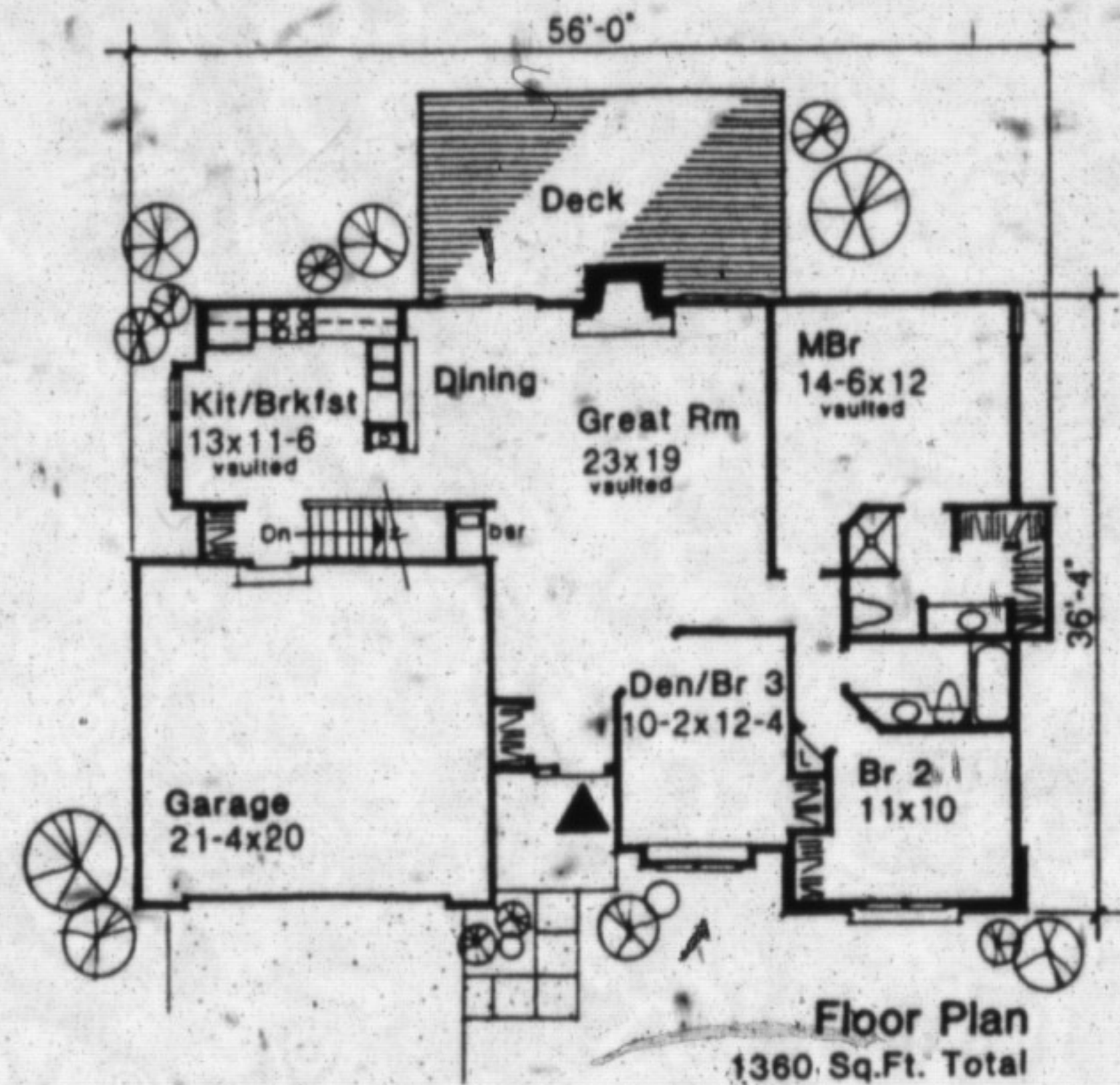

RE/MAX THE REAL ESTATE SUPERSTARS
878-7777 22 Ontario St. S.
INDEPENDENTLY OWNED AND OPERATED



Gary Thomas Broker/Owner.....878-7777	Betty Ingle.....827-4286	Phil Prestidge.....878-6924
Heather Ashbee.....878-7777	Sharon Kerley.....854-0474	Scott B. Prior.....878-7777
Carol M. Brooks.....875-0067	Lindsay McLaren.....854-2451	James Snow.....878-2172
Carole Budworth.....878-8545	Maurice Miljour.....876-4577	Jean Snowden.....878-3155
Gladys Cranford.....875-3039	Lloyd Moore.....(519) 853-3158	Anne Taylor.....854-9833
Ron Furik.....878-3337	Mike Morgan.....878-8093	Glen Thomas.....876-0987
Sheryl Gray.....875-1121	Paul Page.....878-2995	Al Volpe.....878-7777
Clayton Hackenbrook.....875-0771	John (J.P.) Pears.....878-6859	Florence Walter.....878-0231
Richard Hierman.....878-5806		Katrina Walton.....878-1588



HEATHER ASHBEE
Sales Representative

Office: 878-7777
Residence: 875-4698
Toronto Line: 825-4485

517 BEAVER COURT



This 2 storey home has lots to offer. Updated carpet, family room with F.P., B/I dishwasher, C/air, C/vac. Privately fenced yard with covered patio.
A MUST SEE! PRICED AT \$166,900.

★ REMAX SOLD ★ REMAX SOLD ★

SHERYL GRAY
Sales Representative
Office: 878-7777
Res. 875-1121
Tor. Line 825-4485



388 WOODLAWN CRES.

Come out to see this lovely home: 3 extra large bedrooms, master bedroom has 4 piece ensuite & additional 4+2 piece, main floor family room with fireplace, central air, finished basement with wet bar, double car garage and more. \$182,900.

Call Sheryl Gray at 878-7777

★ REMAX SOLD ★ REMAX SOLD ★



ANNE TAYLOR
Associate Broker
Town & Country

REGISTERED RELOCATION SPECIALIST

854-9833
Tor.: 825-4485
Pager: 878-7777

TIMBERLEA SEMI
\$164,900



Four bedroom on fenced corner lot has the feel of a detached home. Living room has fireplace and walk-out, bay windows in dining room and kitchen, unspoiled basement level for your finishing touch.

YOUR FAMILY WILL LOVE IT
\$199,900



Spacious four level sidesplit in Dorset Park. Large oversized fenced yard with inground pool for the kids to play in, walk-out to deck. Gas heating, some new windows, a great home for your growing family.

TOWN & COUNTRY
\$249,900



Have the best of both worlds. Upgraded home on almost an acre just outside town offers new windows, gas furnace, Florida room with hot tub, pool and quiet agricultural views. Come and inspect.

IN THE VILLAGE
\$284,900



Upgraded family home nestled among towering trees on large wooded lot just steps to village shops. Master bedroom suite with fireplace, huge family room, separate living/dining rooms. Older established community offers a lifestyle you would wait for your growing family.

CONTEMPORARY TASTES?
\$319,000



At the end of long wooded driveway, close to Conservation area, this modern home offers unusual design features: octagonal living and master bedroom both with fireplaces, living room with cathedral ceiling, all on 2 beautiful acres.