



# ROYAL LEPAGE

## Aim Higher™

T.M. Roy LePage Real Estate Services Ltd. Broker 1993



**\$125,000**  
Why rent? Maintenance fee only \$100. per month. 3 bdrm. T.H. Roof '93, windows '94, w/o to fenced yard & more. Norma or Ed Proveau\*



**\$3,300/MONTH**  
Hwy. 7 Commercial, 6,000 sq. ft. on 2 acres, showroom, offices, warehouse space. Call A. Lear-Costigan\*



**\$176,900**  
This immaculate home features ground floor family room with gas F.P., eat-in kitchen w/walkout to large deck, plus many other upgrades. Call Sandi Kinsale\* to view.



**\$164,900**  
This 4 bdrm. home features log burning fireplace, new kitchen, hardwood flooring, walkout to deck. Call Sandi Kinsale\* to inspect.



**\$227,900**  
This 4 bdrm. home features large kitchen overlooking family rm., open concept living area, ensuite bath plus lots more. Call Sandi Kinsale to view.



**\$149,900**  
With 5% down and low interest rates lends payments less than rent. Recent renovations include roof, plumbing, wiring, furnace, insulation, all drywall, broadband and more. Available to move into anytime. Call Eva Gooding\*



**\$167,900**  
Very well built all brick home featuring finished recreation room plus 4th bdrm. combined living & dining rms. with gleaming hardwood floors, two decks, situated in a well desired neighborhood. Eva Gooding\*



**\$189,900**  
A home you'll love, so meticulously cared for some recent changes are windows, sashes, soffits, central air, central vacuum, broomroom, oak railing, bathroom air cleaner, deck, a large beautiful 4 bedroom home perfect for the growing family. Eva Gooding\*



**\$239,900**  
An attractive residence so very well cared for with an exceptional one acre with a view from every direction. Open concept living & dining rooms, eat-in kitchen accented by oak cabinets, mammoth family rm. w/F.P. Eva Gooding\*



**\$369,900**  
This luxurious home displays the finest in workmanship and quality construction, ultra modern greenhouse kitchen, mammoth principal rooms including a library, luxury bedrooms with a balcony. Located in select neighborhood. Call Eva Gooding\*



**\$179,900**  
Simply a showplace renovated to perfection. You'll love the entrance addition. A gorgeous kit. designed with Oak cabinets, lower level consists of a complete 2 bdrm. in-law suite, beautiful landscaping including a pond and so much more! Call Eva Gooding\*



**\$174,900**  
Escarpment lot, 2 scenic acres on top of escarpment. Ready for building. Permit, new well installed. A. Lear-Costigan\*

### LAND INVESTMENT

90 Acres S. of Milton—Frontage on 2 roads with 16 Mile Creek running through property. \$750,000.

102 Acres, 1/2 wooded, great location minutes N. of 401. Asking \$279,000.  
For further info. call Norma or Ed Proveau\*



**SANDY DEL PAPA\***  
Sales Representative  
878-8101

**URGENTLY NEEDED**  
For Firm Buyers (Feb. '95 closing)  
Dorset Park home 4 bdrms.  
Main Flr. Fam. Rm.

### COUNTRY CLASSIC



This beautifully maintained Century home shows the pride of ownership both from the meticulously manicured grounds and from the quality of the renovations. If you are looking for the charm of yesteryear this one's for you. \$279,900.

### COME TAKE A LOOK!



Now only \$249,900. This 4 bdrm. exec. home (approx. 2400 sq. ft.) offers greenhouse kitchen with w/o to deck and inground pool on generous 55 x 120 ft. lot. Also main floor family room & laundry. Call today.



**JOYCE HAGEVIK\***  
Sales Representative  
878-8101  
\*The name friends & neighbours recommend\*



**\$1200 MONTHLY**  
House and retail space on busy corner. 1st & last month rent required. Call to view, set up home and shop before the new year.



**\$189,900**  
Set your future dream home among the pines and tamaracs. This gorgeous 2 acre property is fully treed on dead end road. What's the cost for privacy & Mother Nature abound??



**\$136,900**  
Don't pay rent! This gorgeous end unit townhouse offers everything for the 1st time or retirement buyers. Upgrades galore & more. Once through you'll be impressed.

**"TOGETHER"**  
We make it happen.

## THE COUNTRY CORNER INGE WINTHER\*

878-8101  
Specializing in Country Properties for 21 years



**"THE SHIELDING"**  
Campbellville \$329,000. Quaint 1890's 1-1/2 storey with lrg. addition added in 1972. Nestled on a breathtaking 50 ac. lot with 30 ac. of original hardwood forest with large stream & trails winding through. Sep. garage & century log barn.



**"TALLWOOD PLACE"**  
Circa 1850. Beautifully restored & decorated Ontario stone house with large wing. Nestled on a spectacular 49 ac. lot with wooded ravines and large creek. Large pool & cabana. 1824 stone barn. Guest cabin & garage. \$660,000.



**APPLE HILL FARM**  
(Circa 1843) Carefully restored Canadiana with new addition & coach house set very private & secluded on 109 scenic acres with pool, pond & restored bank barn. The land consists of 50 acs. clear & 59 acs. bush with riding trails.



**MULTI-GABLED VICTORIAN**  
Set majestically on manicured grounds with mature maples and a 4 car coach house on 98 spectacular party wooded ac. This 4,100 sq. ft., 3 story features large principal rooms, 3 F.P.'s & 5 bdrms. Restored barn \$899,000.



**SECLUDED COUNTRY ESTATE**  
Charming English stone cottage with large stone wing nestled on prof. landscaped grounds with mature trees, 20 x 40 pool, patios & tennis court. A separate garage stable with box stalls are both built in stone. 33 stunning acres. \$750,000.



**SCENIC RURAL ONTARIO FARM**  
Carefully restored Century Victorian built in red brick with the traditional tall windows & cornish trim. Featuring front & back staircase, high ceilings, 5 bedrooms, etc. Separate garage, cottage & bank barn. \$540,000.



**ONTARIO STONE HOUSE (1865)**  
Nestled among 100 year old maples on 98 scenic acres of gentle rolling land. This Canadiana with large stone wing features front and back staircase, original pine floors, doors and trim. Separate garage & barn. \$430,000.



**SPECTACULAR ESCARPMENT FARM**  
Beautifully restored 1861 stone house with large architecturally designed wing, nestled on prof. landscaped grounds with mature trees, pool & restored barn. 90 party wooded acres backing onto natural woodlands. \$695,000.



**THE LENNON HOMESTEAD (1859)**  
Charming restored Ontario stone house with original stone wing nestled on landscaped grounds with pool, separate garage and barn on 37 scenic acres with pond & stream. The house has large principal rms. & centre hall. \$495,000.



**PETRA SCHWABE\* B.A.**  
Sales Representative  
878-8101



**MUCH ADMIRER HOME \$319,000.**  
Conveniently located between Milton and Georgetown, minutes from Hwy. 401. Custom-built bungalow with several walkouts from the upper & lower levels. A beautiful home on an exceptional 2.5 acre property.



**COUNTRY CLASSIC \$323,000.**  
Lovingly restored and beautifully decorated. 4 bdrms., new family room addition with spectacular views of the surrounding countryside. Parklike setting with stream.



**BARB LAFLECHE\***  
Sales Representative  
878-8101



**"Delivering the service you expect and deserve"**



**\$172,500**  
This bright 3 bdrm. home boasts new broadloom, finished lower level, C/A, and an oversized garage. Well maintained and located in a nice neighborhood.



**\$224,900**  
Classic Cape Cod home offers all the "I want's" M.F. family room, F.P., bright eat-in kit. & exceptionally lrg. bdrms. This all-brick model is nicely landscaped & located on Sunnyvale Cres.



**VIRGINIA BRAZEAU\* R.N.**  
Sales Representative  
878-8101

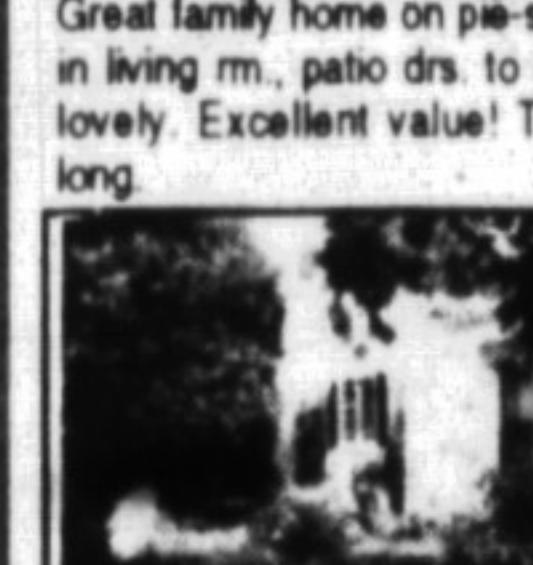

**\$165,000 QUIET STREET**  
Great family home on pie-shaped lot. Fireplace in living rm., patio drs. to deck. Immaculate & lovely. Excellent value! This one won't last long.



**\$379,000 24 ACRES**  
S. of 401 location. Raised bungalow featuring ground level basement & huge principal rms., workshop, plus 2 car garage. Woods, stream and a beautiful view from every window.



**\$279,000 S. OF MILTON**  
Just a few mins. to town! Excellent workshop. Come & view this lovely home with in-law suite. Good value here and definitely "Not" a drive-by. You must see inside!!

**"It's good to know someone who knows and cares"**

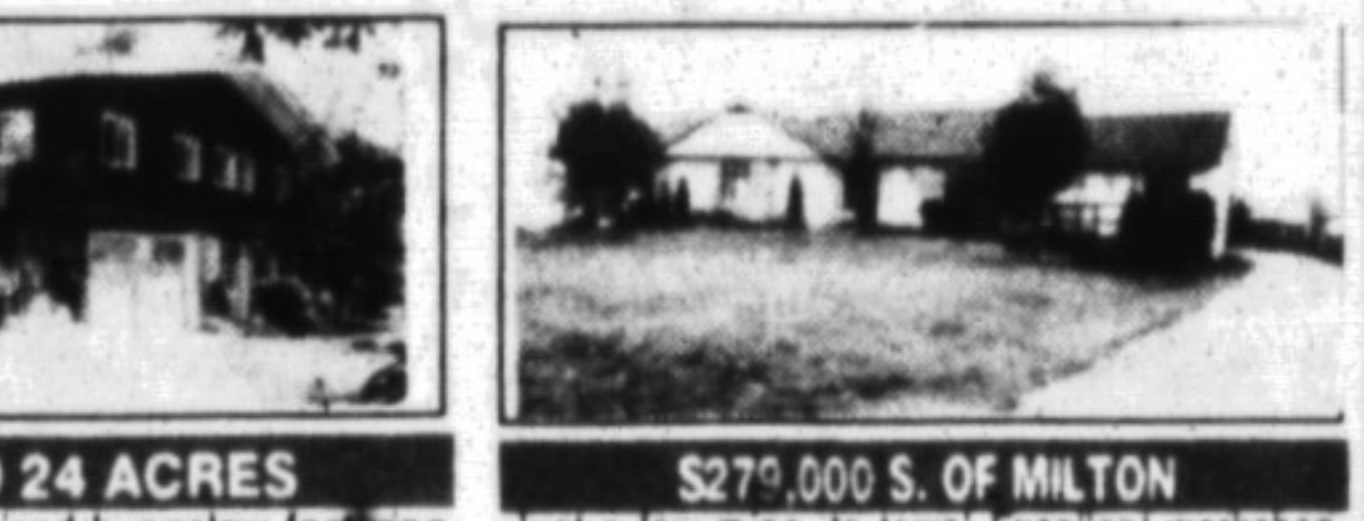

**\$219,000 REDUCED 25 ACRES**  
Ideal opportunity to build your dream home, just 4 mins. to 401/Guelph Line interchange. Woods at road for privacy & high clear lapd at rear. Pond, stream. It's all here! Just call!

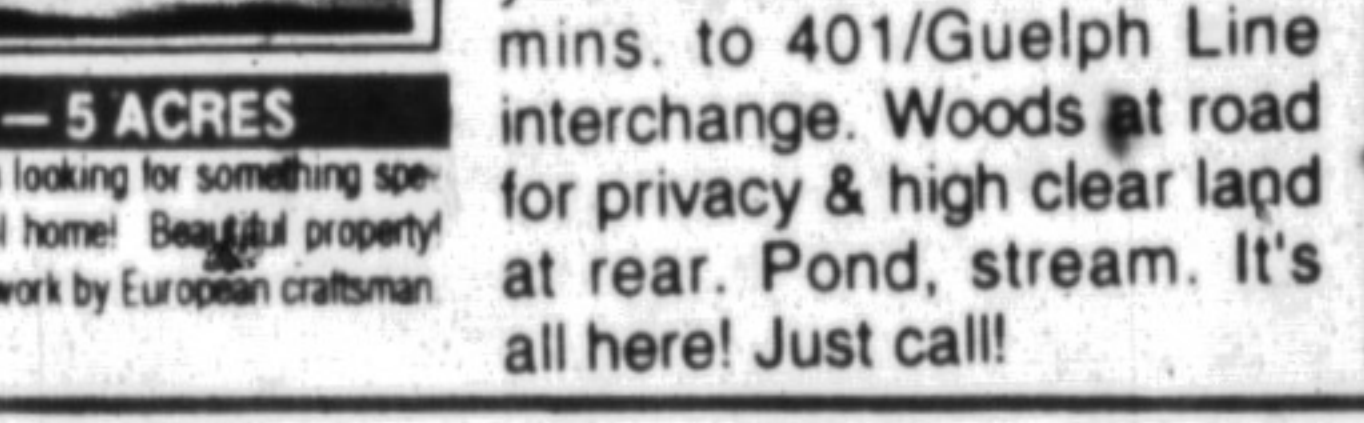

**\$390,000 — 5 ACRES**  
Ideal home for the person looking for something special and unique. Beautiful home! Beautiful property! Only 14 years old, stone work by European craftsman. It's wonderful!