

Meeting planned to discuss implications of industrial levy

from LEVY on page 11
pects to be breaking even in terms of the services it puts out for new development. Halton's charge is being phased in because the developers organized an angry protest lobby to fight the \$2.81 levy in the middle of a deep recession.

There is another wild card yet to be played in the development charges game — the levy expected from the public and separate school boards. That potential charge is still being studied.

All rolled together, the charges are to replace the old system of levies, under which many individual deals were carved out in negotiations between municipalities and developers. But standardizing the procedure is proving difficult as various parties

plead to be exceptions to the rule, and politicians keep finding what they see as loopholes in the plans.

Ward 3 councillor Marion Howard dressed down municipal staff for what she felt was a sterile document.

"I've got a lot of frustration with the whole process. What the hell ever happened to creativity?" She called the submission "the same old boiler plate stuff with no new ideas." Councillors want to "stimulate the marketplace" but instead are being confronted with "layers of taxes upon taxes that send everyone down to the States."

Milton Chamber of Commerce president Carol McDonald said council should at least adopt a phase-in program for the charges. "That way we can get the growth

now and phase in the charges as this economy starts to turn around."

As far as attracting new industry under the proposed scheme, "we seem to be putting every impediment in front of them that we can," Ms McDonald said.

Michael Welch, who manages the High Point industrial park complex, said "the level playing field seems to be changing," as far as contributions his clients have already made to Milton go.

The developers invested approximately \$12 million in utility servicing for the park years ago and now may be faced with additional charges because several of them haven't built on the property yet, he said.

Ward 2 councillor Brad Clements said he was "absolutely floored" at

the proposed hydro levy being as much as what the Town needs (63 cents per sq. ft.). He called it "outrageous."

"Our costs are based on historical costs," countered Milton Hydro general manager Don Thorle, adding that they had merely been "projected" forward.

"In a perfect scenario this is the best way to get the most money," said Ward 1 councillor Rick Day.

But all it may mean now is that Milton will get a solid payback "if anybody is nuts enough to build anything in Milton," he warned.

Councillors asked for more information on a wide range of topics, including possibly phasing in the charges, allowing some exemptions for additions to existing businesses totalling 5,000 sq. ft. or less, and a cost justification for the electricity levy.

Council downshifts on speeding letter



Bruce Attenborough

Former Ward 3 councillor Bruce Attenborough's pen is a bit too acid for Milton town council's taste when it comes to his concerns about rural speeding.

Mr. Attenborough recently wrote a letter to town council complaining of speeding on Guelph Line and criticizing both Halton Region (Guelph Line is a regional road) and Halton Regional Police brass for failing to take action on the issue.

Mr. Attenborough said Halton Region hasn't erected the necessary signs that would allow police to enforce speeding rules on a northern

Nassagaweya stretch of Guelph Line. He also suggested the regional police force is perhaps "too top heavy with paper pushers" when more front-line personnel are needed.

Mr. Attenborough added that money from ticketing speeders on the Guelph Line could help finance "the long overdue retirement party for (Halton Regional Police) chief James Harding."

Town public works director John Matthews had originally proposed forwarding Mr. Attenborough's letter

• see SPEEDING on page 12

CORRECTION NOTICE

Due to a printing error in today's (this week's) Shoppers Drug Mart flyer on page 3, Hostess Salt and Vinegar Potato Chips are pictured and are not available in this size.

It should have read Hostess Potato Chips Regular or Barbeque, Ruffles, Cheeto or Doritos 140g.

We apologize for any inconvenience this may have caused.

SHOPPERS DRUG MART



- Windshield Stone Chip Repairs
- Sunroofs
- Tonneau Covers
- Running Boards
- Auto Upholstery

Locally Owned & Operated

781 MAIN ST. EAST
876-4785

A Big Thank You

I want to take this opportunity to thank all those who sponsored and volunteered their time for the 1992 Ron MacNeil Charity Golf Tournament.

1992 Sponsors

- | | | |
|----------------------------------|--------------------------------|-------------------------------|
| ▲ The Canadian Champion | ▲ Bill Currie (Royal LePage) | ▲ Dufferin Quarry |
| ▲ Greg Marchant | ▲ Glen Creighton | ▲ Turner Medical |
| ▲ Pro Tip Tools | ▲ Bruce Hood Travel | ▲ Orchids 'N Lace |
| ▲ Glenn Turner | ▲ Bob Noble | ▲ Harrop House |
| ▲ Boriands Foto Centre | ▲ Country Feelings | ▲ Paul McCann (Jack Fraser's) |
| ▲ The Genuine Gold Connection | ▲ Halton Electronics | ▲ Randy Nowak |
| ▲ Videoflicks | ▲ Leaver Mushrooms | ▲ Milton U Brew |
| ▲ Key Centre | ▲ Bergsma's Paints | ▲ Okihiro Golf |
| ▲ Irwin Toys | ▲ Carlisle Golf Course | ▲ Don Cherry's Grapevine |
| ▲ Beaver Lumber | ▲ Earl MacNeil (Devils Pulpit) | ▲ Shopper's Drug Mart |
| ▲ Harris Stationery | ▲ Lions Head Golf Course | ▲ Spice 'O Life |
| ▲ Scooters Sport Shop | ▲ Greystone Golf Course | ▲ Fat Freddy's |
| ▲ The Fitness Technique | ▲ Irene Hill | ▲ Mike's Barber Shop |
| ▲ Frank Nascimben | ▲ Cooke's Casuals | ▲ Halton Outdoor Shop |
| ▲ Bar Ben Hardware | ▲ The Dickens Restaurant | ▲ Milltown Tire |
| ▲ Milton Red Sox Baseball | ▲ Lube It | ▲ Sandstone Transport |
| ▲ Milton Golden Pond Hockey Club | ▲ Rick (Skip) McTrach | ▲ Belamy's Restaurant |
| ▲ Ron Furik (Re/Max) | ▲ Comic Express | ▲ The Second Cup |
| ▲ Gary Thomas (Re/Max) | ▲ Hertz Rent-A-Car | |
| | ▲ Newman's Shoes | |

FINANCIAL REPORT

INCOME	EXPENSES
\$15,001.84	\$11,487.97
PROFIT	
\$3,513.87	

All money will be distributed to needy children and students in Milton.
Please contact: Sian Bowness, E.C. Drury High School or Ron MacNeil, Re/Max Milltowne Realty for further information.

RON MACNEIL

ATTENTION TOYOTA OWNERS

Complete parts & service available at
Georgetown Toyota 1991
15 Mountainview Rd. N.
Georgetown

Open
8 - 6 Monday - Friday
8 - 8 Thursdays

877-2296

Toronto Line 846-5141

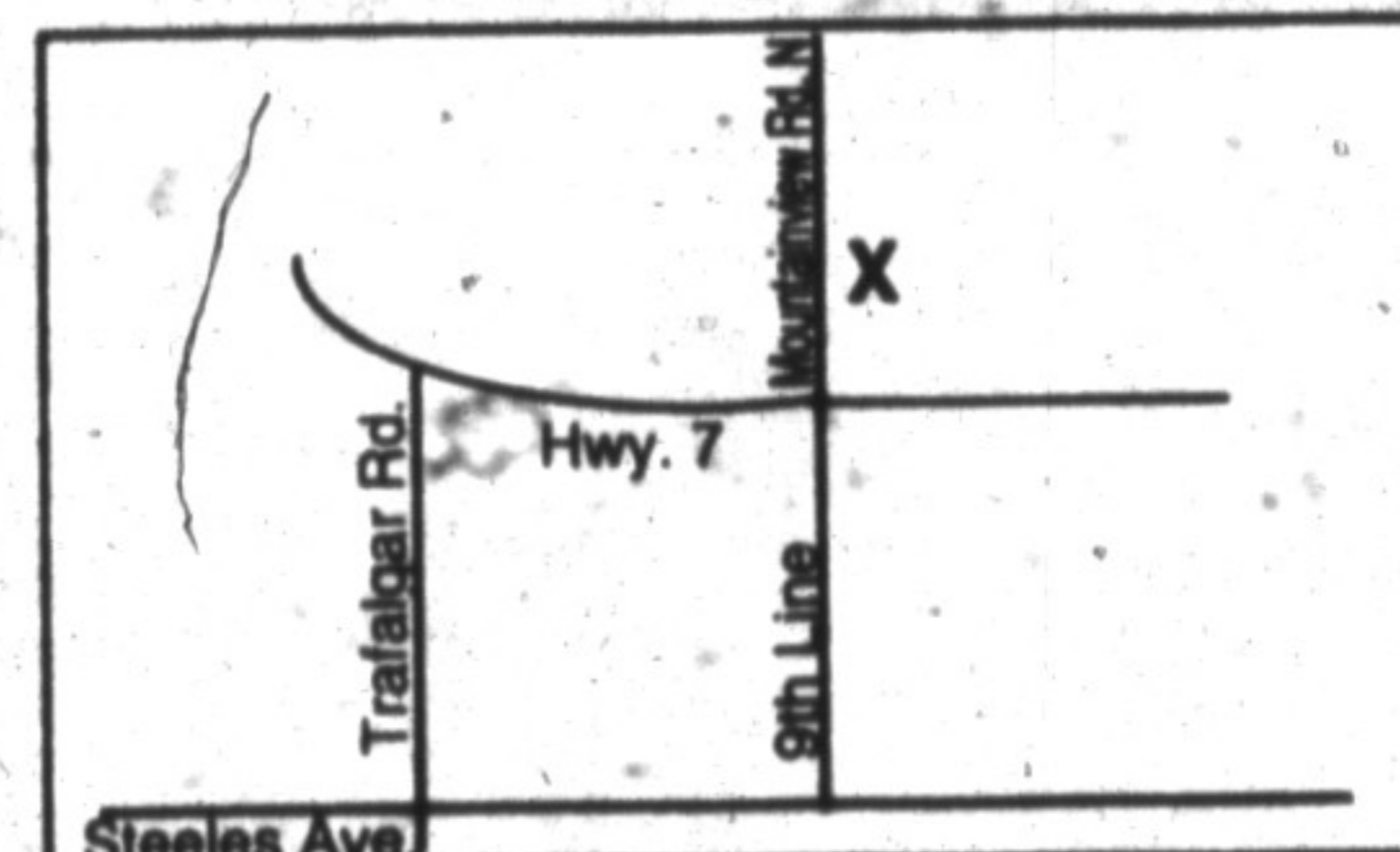

10% Discount for Seniors

TOYOTA QUALITY SERVICE
TOYOTA GENUINE PARTS