

ROYAL LEPAGE Advantage



SOONER OR LATER ...
This area is going to be fully developed. It's already in the official plan. Zoned M2A this 2 storey brick home at \$315,000 is a good investment. Call Lawrie Given*878-8101.

CAMPBELLVILLE CAFE GOOD
\$349,000 nestled on tree ac on quiet dead-end road & featuring: traditional center hall, formal living rm. with french drs. lrg. sep. dining rm with french drs. to hall, family rm. with f.p. & greenhouse breakfast area, lrg. bedrms etc. Inge Winther*878-8101.



JUST REDUCED TO \$179,900
Call Wayne Casson to see this three bedroom backsplit complete with a finished rec. room, central air conditioning and an inground pool. This home is located in a very desirable area with a deep lot.

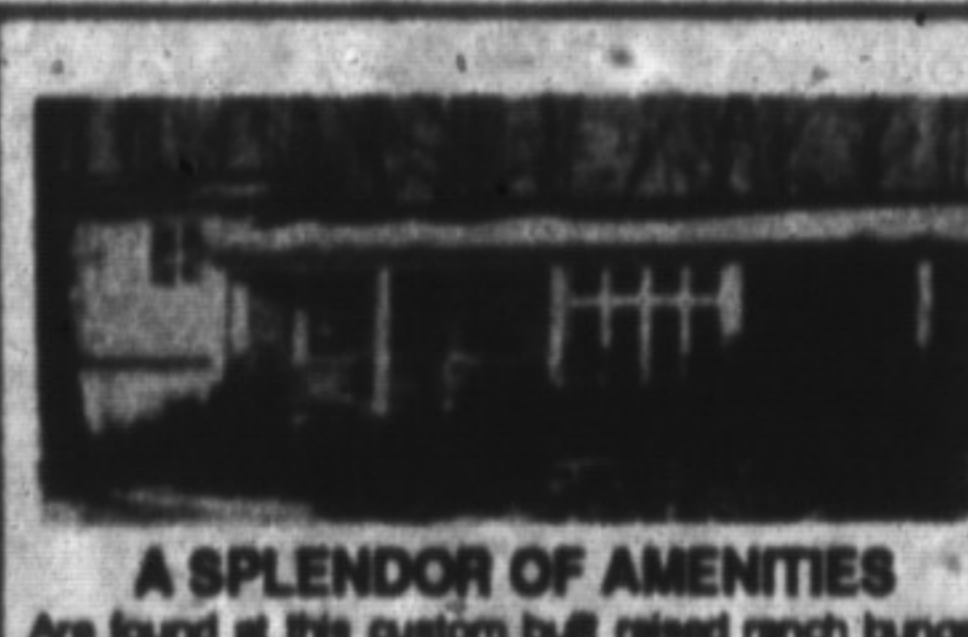

A SPLENDOR OF AMENITIES
Are found at this custom built raised ranch bungalow located in Campbellville. Enjoy the upgraded oak kitchen, sunny solarium, overlooking the inground pool, the fabulous master retreat and more! The mature .37 acre lot offers peace & privacy. Listed at \$399,000. Barb Lafèche*878-8101.



LARGE EXECUTIVE HOME AVAILABLE
Excellent area, excellent home, 4 bdms, 4 baths, main floor F.R. with F.P. & walkout. Eat-in kitchen with walkout to pressure treated deck with wrap around benches and backing onto park. Prof. fin. rec. rm., games rm. & bar. Double garage. \$299,900. Carol K. Budworth*878-8101.



YOU'LL LOVE THE VERY NATURE OF IT!
Sited on a scenic 2 1/2 acre lot, this attractive 4 bedroom bungalow comes complete with large eat in kitchen and walkout, separate living room with fireplace, huge rec room with fireplace, den or 5 bedroom, office plus many upgrades. Offered at \$279,900. Call Bill Currie*878-8101.



REDUCED \$10,000 EXCELLENT BUY IN GREAT AREA
3 bdrm backsplit with 2 baths, fin. rec. rm. with fireplace. Well painted & decorated inside and out, backing onto park, pool patio, double drive - close to schools. Have a look. \$179,900. Carol D. Budworth*878-8101.



BEAUTIFUL CAMPBELLVILLE
\$699,000 Two story tudor on 4 acres, offering 4 bdms, 3 baths, 2 f.p.s, separate dining, 17 X 37 pool, tennis court. Set well back from the road. Les Bunker*878-8101.



GARDENERS PARADISE ASKING \$299,000
This unique country home on 2 acres has extensive grounds for your gardening pleasure. Large double house, inground pool and close to Oakville and Milton. Please ask for Rosa Runnalls*878-8101.

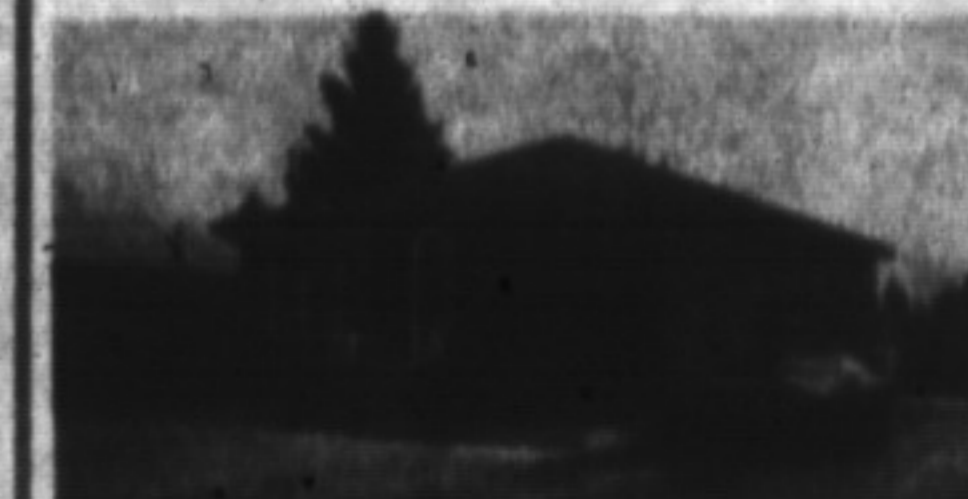

SUPER BUNGALOW - LOW DOWN PAYMENT!
Vendor will assist with financing. Lower level in-law suite. Just redecorated come and see how for your money will go. Asking price \$187,900. Rosa Runnalls*878-8101.



NEW PRICE
YOUR BUYING OPPORTUNITY NOW \$185,900.
This 4 bedroom home is a super buy for your family. Maximum space for minimum dollars. Call for your personal viewing. Rosa Runnalls*878-8101.



PRIVACY AT IT'S BEST
Almost 3 acres wooded setting on private rd. floor to ceiling picture windows main floor family rm with large deck this is a unique home please to show \$279,900. Call Denzil Lawrence*878-8101.



QUIET COUNTRY LIVING REDUCED
47 acres of woods stream 3 bdrm bungalow double garage nice country location 5 minutes to 401. Please call \$325,000. Denzil Lawrence*878-8101.



COUNTRY HERITAGE HOME 10 ACRES
Home built 1854 nicely restored all brick 3 car garage 4 boxstall barn property nicely treed backs onto conservation Lake. Please call \$499,900. Denzil Lawrence*878-8101.



ESCARPMENT SETTING
10 acres partly wooded with 3 bdrm bungalow plus a in-law suite in basement, beautiful setting close to Milton. Reduced. Listed for \$339,000. Please call Denzil Lawrence*878-8101.



NICE HORSE FARM REDUCED
67 acres 14 boxstall 3 paddocks large barn 3 bdrm brick home with new kitchen, family rm etc. all building in good condition \$549,900. Please call Denzil Lawrence*878-8101.



COUNTRY PARADISE \$287,500
Gorgeous 10 acre property provides a perfect setting for this charming 3 bedroom home. Features 3-car garage, new sunroom, finished basement with walk-out & lots more. Move-in condition! Petra Schwabe*878-8101.



EXECUTIVE ESTATE \$495,000
Attractive 14 room georgian home on 10 scenic acres. Features 6 bedrooms, main floor in-law suite, family room, family-sized kitchen with new sunroom addition, pool, barn +++ Petra Schwabe*878-8101.



NOT JUST YOUR ORDINARY SEMI
• a huge 49' X 403' lot
• all windows 3 yrs. old
• large two car garage
• with shop and work
• bench ... very private location
Contact Rudy Arbeiter*878-8101.



SPACIOUS HOME - WORTH A LOOK
Located on Foster Court, this 4 level split offers three bedrooms, 2 washrooms, eat-in kitchen, combination living room and dining room with walkout to large deck, family room with fireplace central air and vac plus a very large lot. Contact Bill Currie*878-8101.



BEAT THE HEAT
Immaculate 4 bdrm home complete with main floor family room and fireplace, eat-in kitchen with walk-out to patio, combo living room and dining room, 3 washrooms, central air and vac, inground pool & large lot \$268,900. Call Bill Currie.

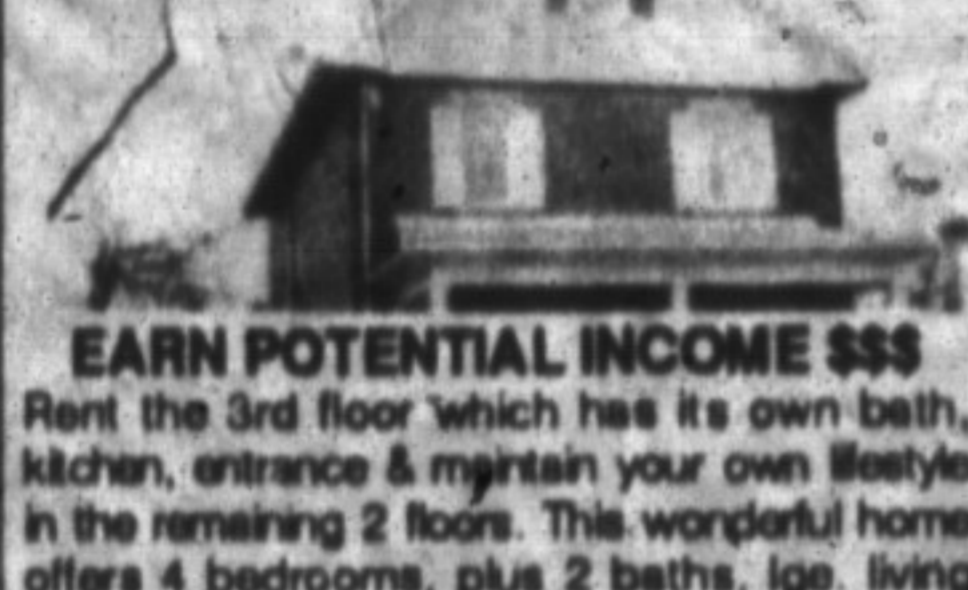

EARN POTENTIAL INCOME \$\$\$
Rent the 3rd floor which has its own bath, kitchen, entrance & maintain your own lifestyle in the remaining 2 floors. This wonderful home offers 4 bedrooms, plus 2 baths, lge. living areas, full basement, fenced yard, oak trim & top much charm. \$299,000. Joyce Hagevik*878-8101.



DORSET PARK - SPACIOUS BUNGALOW
Large yard, very nice rec room with wood stove, 3 bedrooms, 2 baths plus 4 appliances. \$184,900. Contact Joyce Hagevik*878-8101.

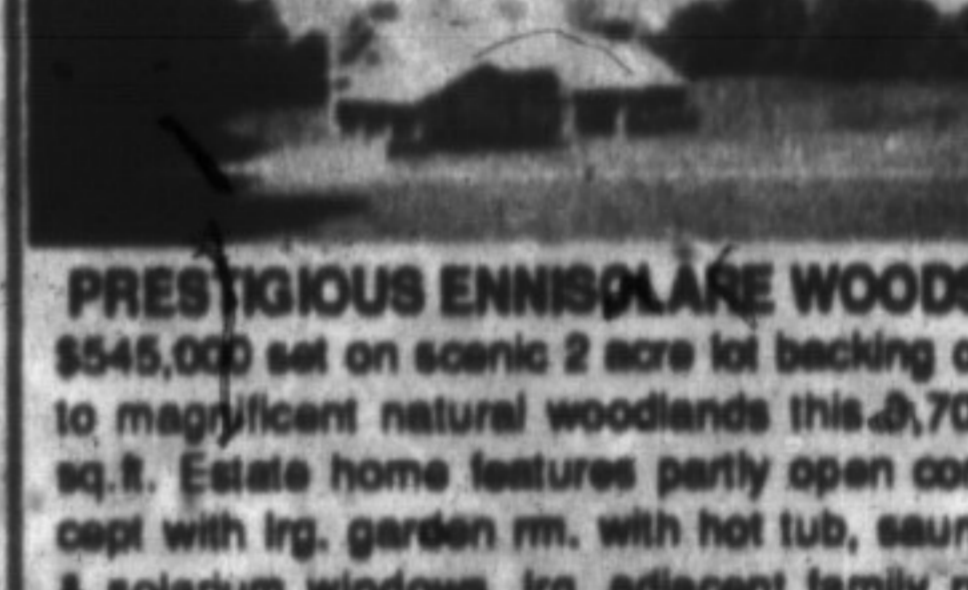

PRESTIGIOUS ENNISLARE WOODS
\$545,000 set on scenic 2 acre lot backing on to magnificent natural woodlands this 2,700 sq.ft. Estate home features partly open concept with lrg. garden rm. with hot tub, sauna, & solarium windows, lrg. adjacent family rm with f.p., lrg. custom built kitchen with center island & built-ins. Formal living rm etc. Inge Winther*878-8101.



MAGNIFICENT ESTATE ON 5 ACRES
\$699,000 traditional Georgian set on prof. landscaped grounds with brick lane, circular drive with island & spring fed ponds featuring lrg. center hall, formal living rm, lrg. sep. dining rm., family rm., with beams & fireplace, 4 bdrm, 2 suites of master. Beautiful kitchen etc. Inge Winther*878-8101.

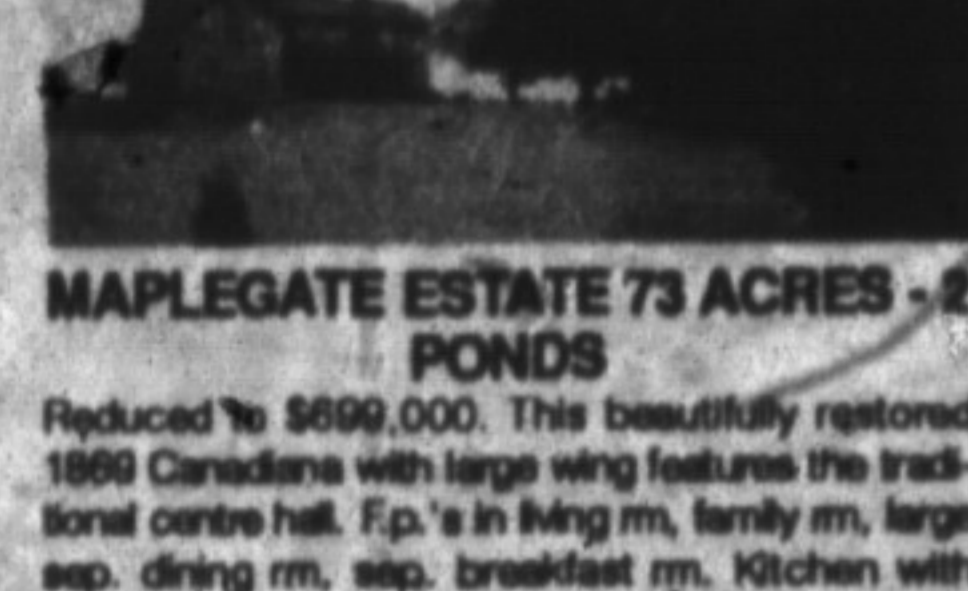

MAPLEGATE ESTATE 73 ACRES - 2 PONDS
Reduced to \$699,000. This beautifully restored 1899 Canadiana with large wing features the traditional centre hall. F.p.'s in living rm, family rm, large sep. dining rm, sep. breakfast rm. Kitchen with centre island & built-ins. Front & back staircases, etc. 2nd house on property for help, barn & paddock. Inge Winther*878-8101.



ESCARPMENT RETREAT ON 5 ACRES
\$379,000 nestled on very scenic wooded lot this unique 2 storey features: charming living rm with indoor garden, sep. dining rm., family rm., with fireplace & walkout to covered deck, solarium of kitchen, lrg. bedrooms etc. Very private area minutes from 401 & 25 Hwy. Inge Winther*878-8101.



RESTORED CANADIANA - 49 SCENIC ACRES.
\$699,000 nestled on one of the most unique lots with tree canyons, lrg. creek, pond & pool this century stone ... use with new wing features: traditional centre hall, formal living rm., with fireplace, library lrg. new kitchen with built-ins, lrg. sep. breakfast room ... barn etc. Inge Winther*878-8101.

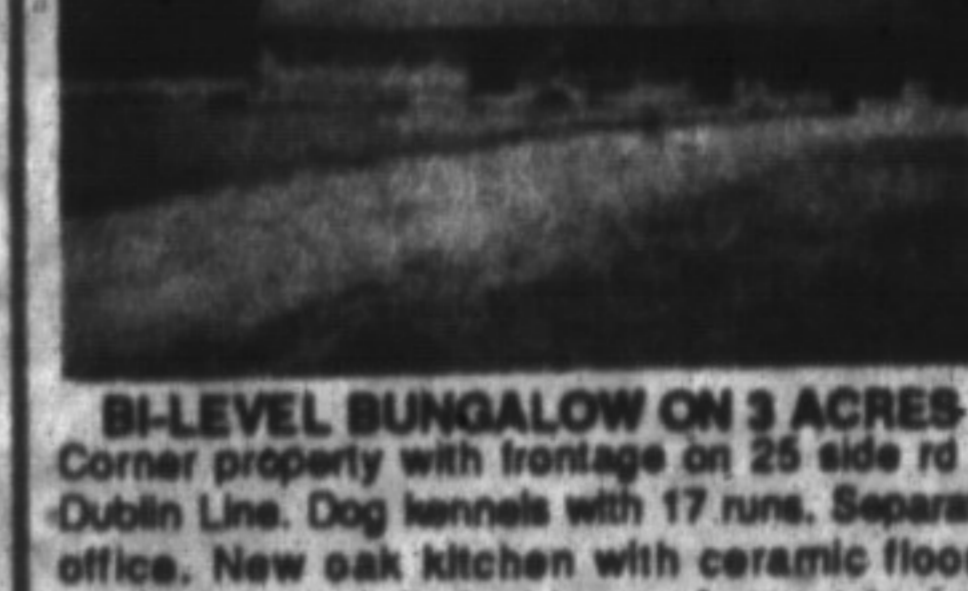

BI-LEVEL BUNGALOW ON 3 ACRES
Corner property with frontage on 25 side rd & Dublin Line. Dog kennels with 17 runs. Separate office. New oak kitchen with ceramic floors inground pool & decking. A must to see \$379,000. Contact Virginia Brazeau*878-8101.

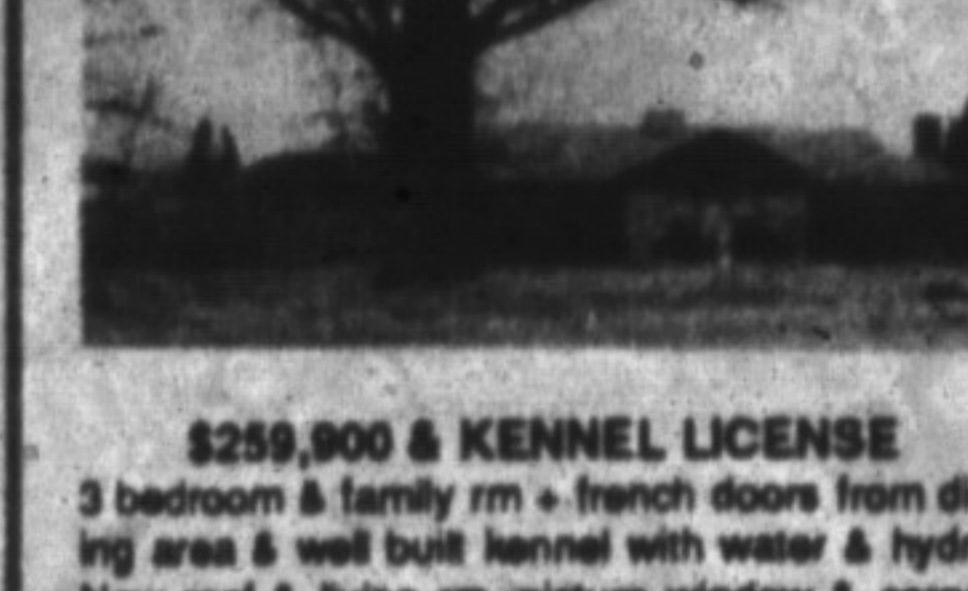

\$259,900 & KENNEL LICENSE
3 bedroom & family rm - french doors from dining area & well built kennel with water & hydro. New roof & living rm, picture window & carpet. For information call Virginia Brazeau*878-8101.

388 MAIN ST. EAST
878-8101
(Tor. Line) 826-9218
Toll Free 1-800-263-4176
** Broker
Sales Representative
Royal LePage is Canada's leading full-service real estate organization. The Company has almost 11,000 employees and representatives in nearly 475 residential, commercial and associate broker offices in Canada, the United States and overseas.

LAMONT LEONE — Manager**
SECRETARIES
Gayle Ford • Shirley Langdeau • Isobel McLean
Linda Blanchard • Judi Adams • Shirley Bottrill • Shelly Varley
It's you that counts the most.
ROYAL LEPAGE
ROYAL LEPAGE REAL ESTATE SERVICES LIMITED, REALTOR

- Dave Addison.....878-7079
- Rudy Arbeiter.....878-3558
- Virginia Brazeau.....878-1221
- Carol Budworth.....878-8545
- Les Bunker.....(519) 858-4352
- Wayne Casson.....878-0466
- Barb Crowe.....878-7875
- Bill Currie.....878-4944
- Sandy Del Papa.....878-5229
- Lawrie Given.....878-1961
- Eva Gooding.....875-4009
- Joyce Hagevik.....878-1084
- Heleli Hardy.....878-3915
- Sandra Legie.....878-1881
- Len Duncan.....878-1131
- Karen Irvine.....878-4154
- Sandi Kinsale.....878-0392
- Barb Lafèche.....875-3303
- Denzil Lawrence.....878-1944
- Audrea Lear-Costigan.....878-9151
- Gary Love.....878-4930
- Josephine Peric.....878-7849
- Steve Porter.....878-8554
- Ed Proveau.....876-1707
- Norma Proveau.....876-1707
- Barbara Ramsden.....875-3913
- Rosa Runnalls.....878-6437
- Petra Schwabe.....(519) 853-4871
- Donna Syms.....878-3142
- Inge Winther.....(519) 853-1890
- Barbara Mallescu.....878-7488