

Express movers the ticket

• from IT'S on page B2
tion in Milton and pick your destination. Say I want to go to Scarborough, I drive or walk into the supersonic people mover headed to the Scarborough station, and zoom, I'm there in three minutes.

I want to go to New York City, I take the Niagara Falls platform and then transfer. Fifteen minutes I'm in New York. Forgot to bring extra

underwear? — don't worry, just go back and get it.

All the people movers are stacked on top of each other so it doesn't take a lot of space.

There are no windows because you're moving too fast anyway. Maybe it's in some type of vacuum that sucks it through at 1,000 miles per hour — I don't know, it hasn't been invented yet.

The only thing I know for certain is that a hundred years from now people will be wondering how we managed without the conveniences they have — especially the express people mover.

And then a 2006 antique SUV will roll by and somebody will wonder what life will be like a hundred years from then.

Charity skate-off at Memorial tomorrow

The Milton Memorial Skate Park will be a hub of action tomorrow afternoon as participants take part in a charity skate-off.

Skateboarders of various age groups and levels will take part as they compete for a variety of prizes. The competition is open to children of all ages — right up until their late

teens — and registration is \$20 per skater.

Proceeds will go to Milton District Hospital.

Spectators are invited to come out and support the event and take advantage of the music, food and kids' activities.

Troy's Diner will also hold a barbecue.

Install Smoke Alarms
It's The Law.



The Ontario Fire Code requires that every home have working smoke alarms. Install them in your home or cottage today!



The Regional Municipality of Halton

Curb Appeal

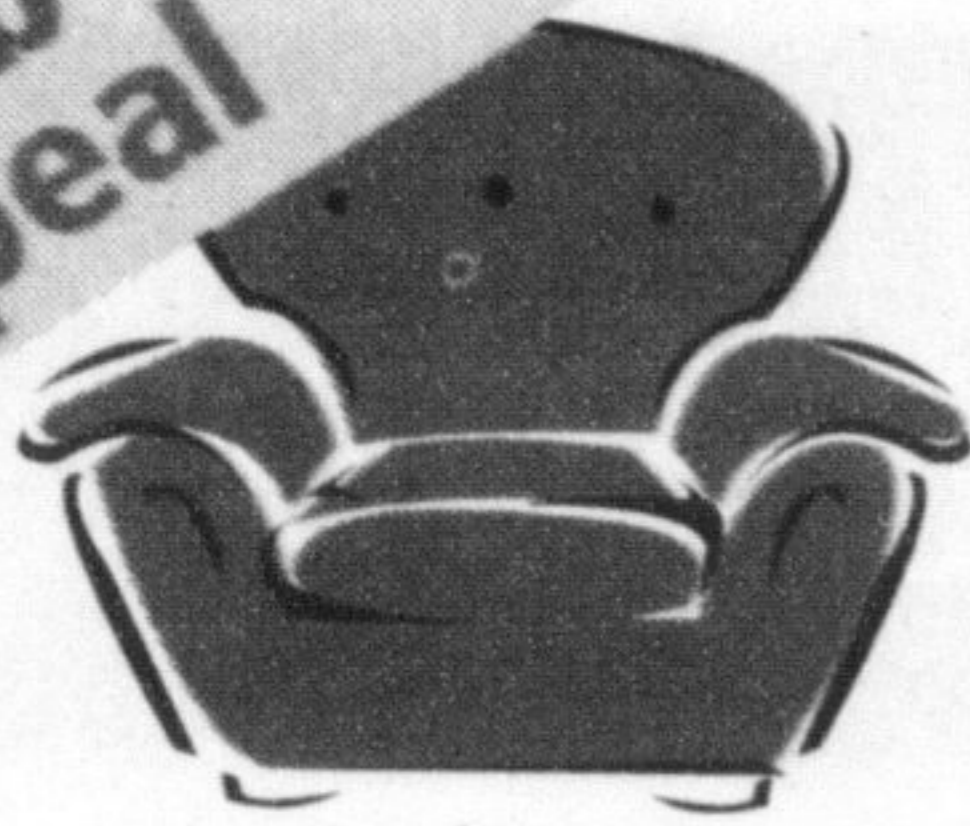

Milton Urban Bulk Collection

Place items at curb by 7:00 a.m. on your designated bulk collection day.

Check the map for your corresponding collection zone. Items will be collected on the day designated for your zone.

Note: Collection boundaries have changed. Please confirm which zone you are in.

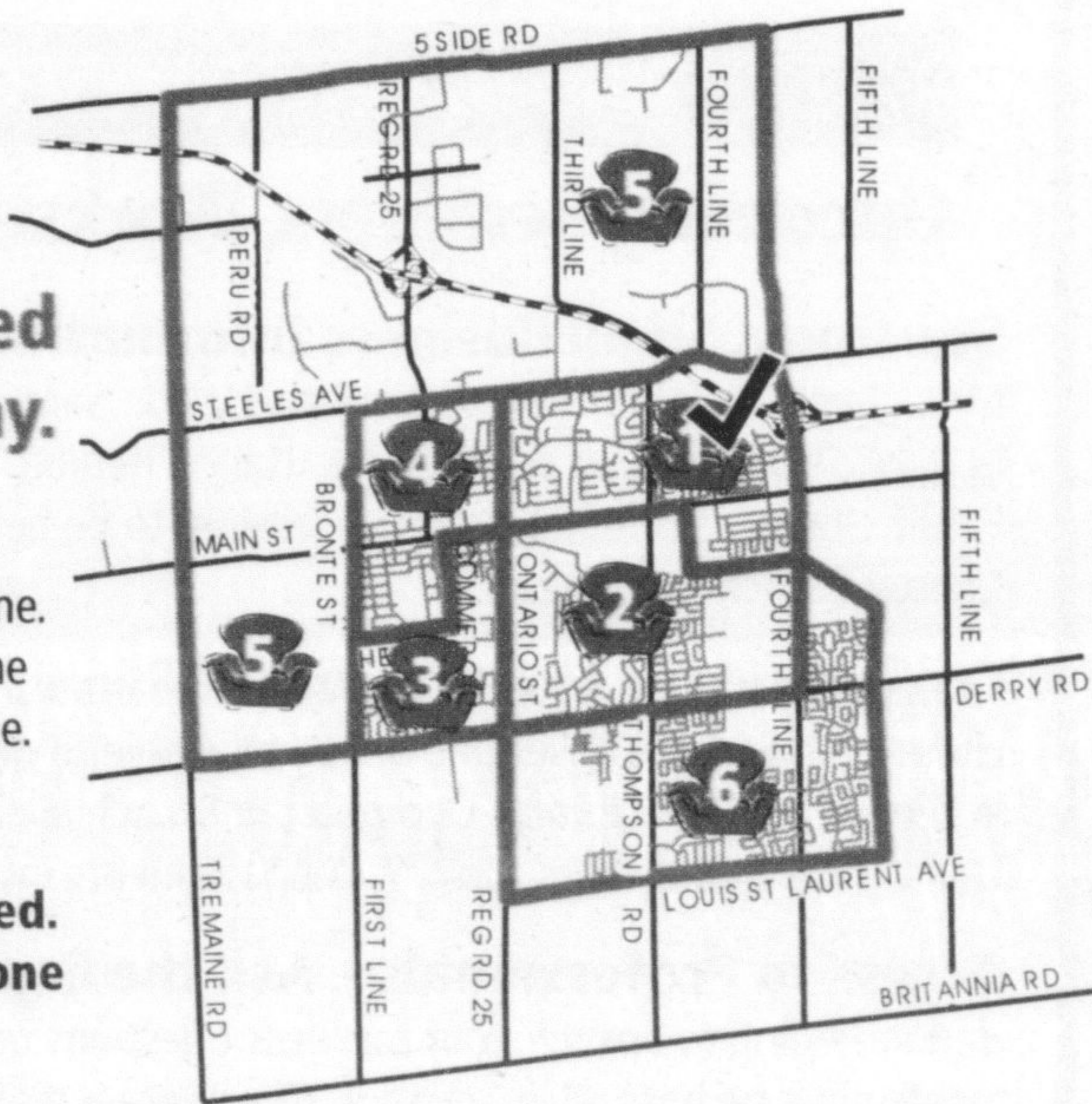

Bulk Waste Collection

Zone 1	Wednesday, August 30
Zone 2	Wednesday, September 13
Zone 3	Wednesday, September 20
Zone 4	Wednesday, September 27
Zone 5	Wednesday, October 4
Zone 6	Wednesday, October 25

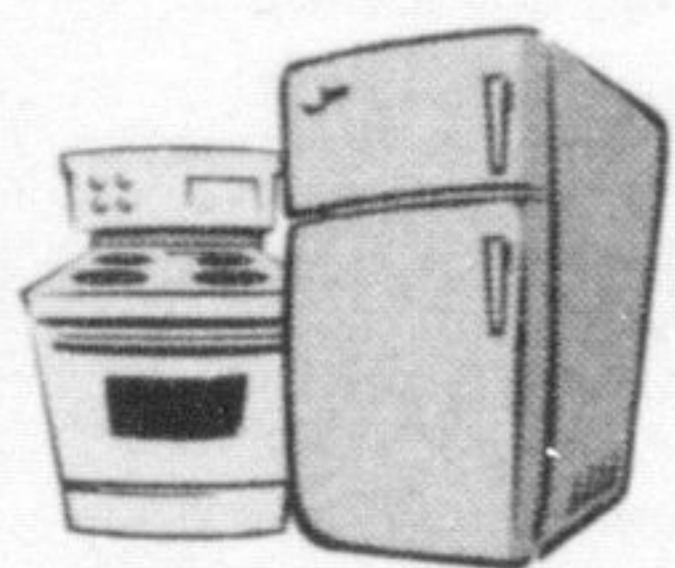

Metal & Appliance Call-in Collection Service

Metal items and appliances will ONLY be collected on a call-in basis and, therefore, will not be collected on your scheduled Bulk Collection day.

To receive collection, please call Halton Region Monday - Friday 8:00 a.m. to 5:00 p.m. at 905-825-6000
Toll free: 1-866-4HALTON (1-866-442-5866)

Metal items and appliances include refrigerators, freezers, dishwashers, stoves, washers, dryers, metal furniture, broken down swing sets, etc.

Please ensure the doors are removed for safety.

The following materials will NOT be collected:

- Automobile Parts*
- Propane Tanks
- Tires
- Building and Demolition Debris
- Concrete and Bricks
- Household Hazardous Waste
- Cardboard Boxes
- Tree Branches
- Tree Stumps**
- Soil and Rocks

These items may be disposed of at Halton's Waste Management Site (HWMS), 5400 Regional Road 25, Milton. Open Monday - Saturday 8:00 a.m. - 4:30 p.m.

*Only small non-hazardous automobile parts can be accepted at the HWMS.

**Only small tree stumps under 30 cm (1 ft) in diameter can be accepted at the HWMS.

If you have unwanted items that are in good condition, consider donating them to a charitable organization or reuse centre. You will be diverting material away from Halton's landfill and helping people in need at the same time!

NOTICE OF CONSTRUCTION

WATERMAIN REPLACEMENT AND LINNING IN THE FROBISHER BOULEVARD, HEMLOCK DRIVE AND MAPLE AVENUE AREAS, TOWN OF MILTON

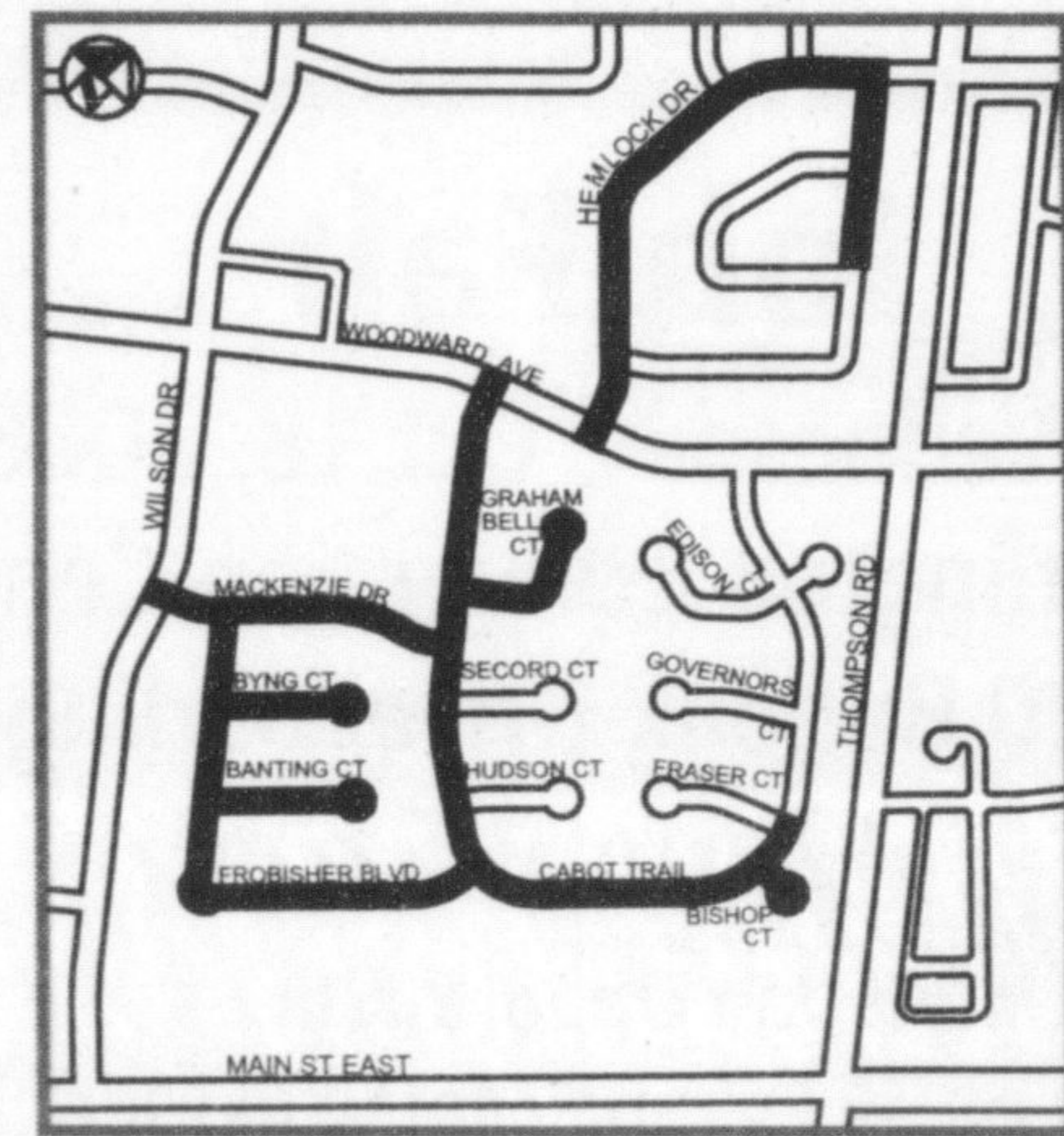

CONTRACT NUMBER: W-2361-06
SCHEDULED START DATE: SEPTEMBER, 2006
SCHEDULED COMPLETION DATE: NOVEMBER, 2006
CONSTRUCTION SUPERVISOR: JENNIFER TRIMBLE, ext. 7690

ONGOING ROAD CLOSURE

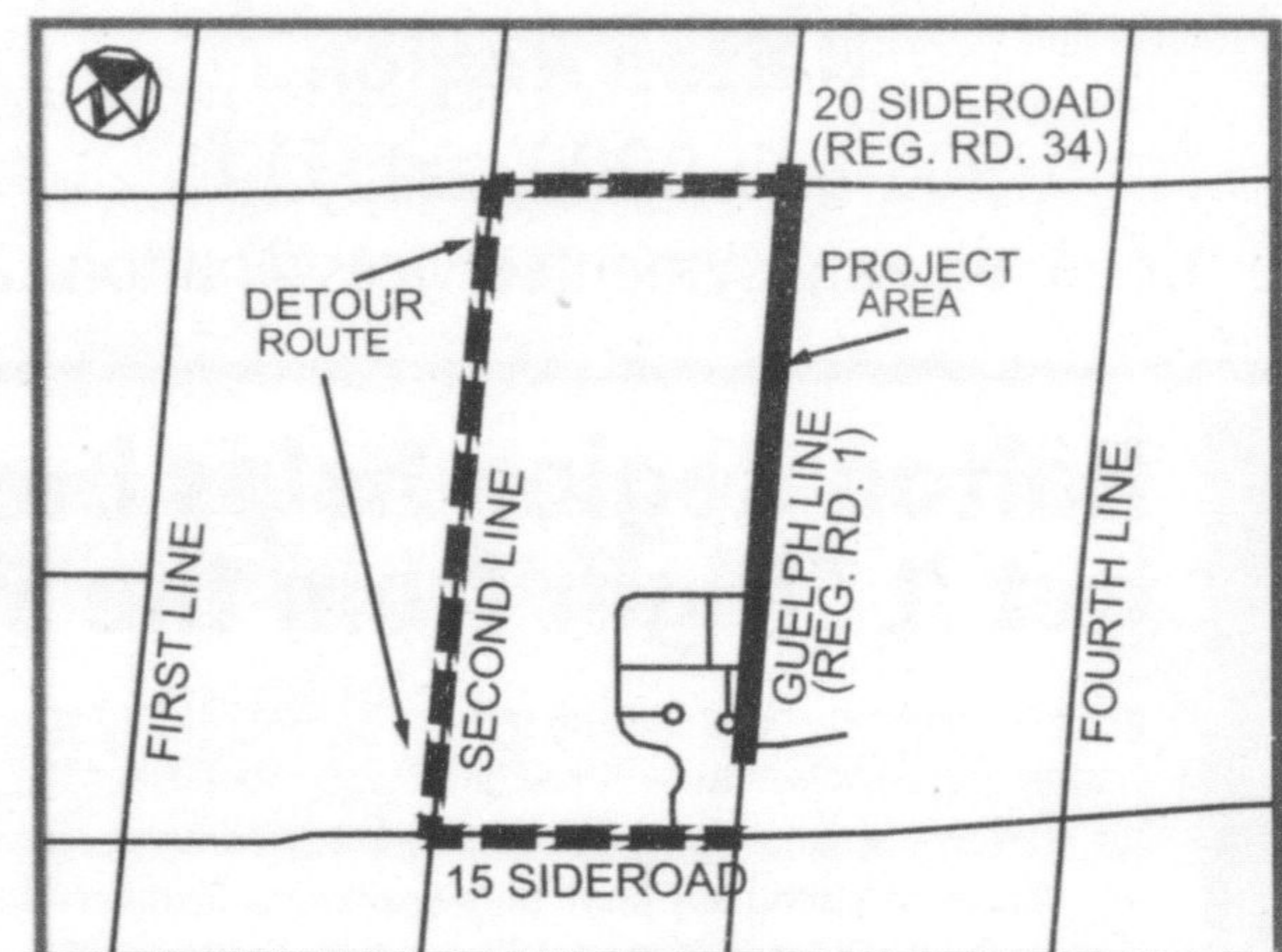

IN ORDER TO RECONSTRUCT GUELPH LINE (REGIONAL ROAD 1) BETWEEN 15 SIDEROAD AND 20 SIDEROAD (REGIONAL ROAD 34), THE ROAD WILL BE CLOSED TO THROUGH TRAFFIC

BEGINNING ON MONDAY, JUNE 26, 2006 AT 9:00 A.M. AND CONTINUE UNTIL TUESDAY, OCTOBER 31, 2006 AT 5:00 P.M.

CONTRACT NUMBER: R-2078B (PART 2) -06
CONSTRUCTION SUPERVISOR: LEONARD VERWEY
EXT. 7616