

More details released on tragic industrial accident

Police have released the name of a man killed last Friday in an industrial accident in the area of Boston Church and Lawson roads.

Scarborough resident Girma Selassie, 41, was killed at about 9:40 a.m. while operating machinery at a construction site.

An employee of TACC Construction, the

man was operating a piece of machinery known as a sheep's foot roller used to pack down soil.

The company was building a water pond as part of a reservoir system.

Selassie was in the process of packing down soil on the graded embankment of the water pond when the rear tires slipped off

the edge, police said.

The equipment began to slide down the embankment and overturned.

Police said the victim, who wasn't wearing a seatbelt, attempted to jump clear of the roller and was struck by the steel framed roll cage of the safety cab that surrounds the driver's seat.

He fell to the ground landing face down and was pinned under the machine with the weight on his back.

He sustained extensive injuries and was pronounced dead at the scene.

The Ontario Ministry of Labour is investigating, as are Halton police.



TTY: 905-878-1657

THE CORPORATION OF THE TOWN OF MILTON

905-878-7252

Milton Online
www.milton.ca

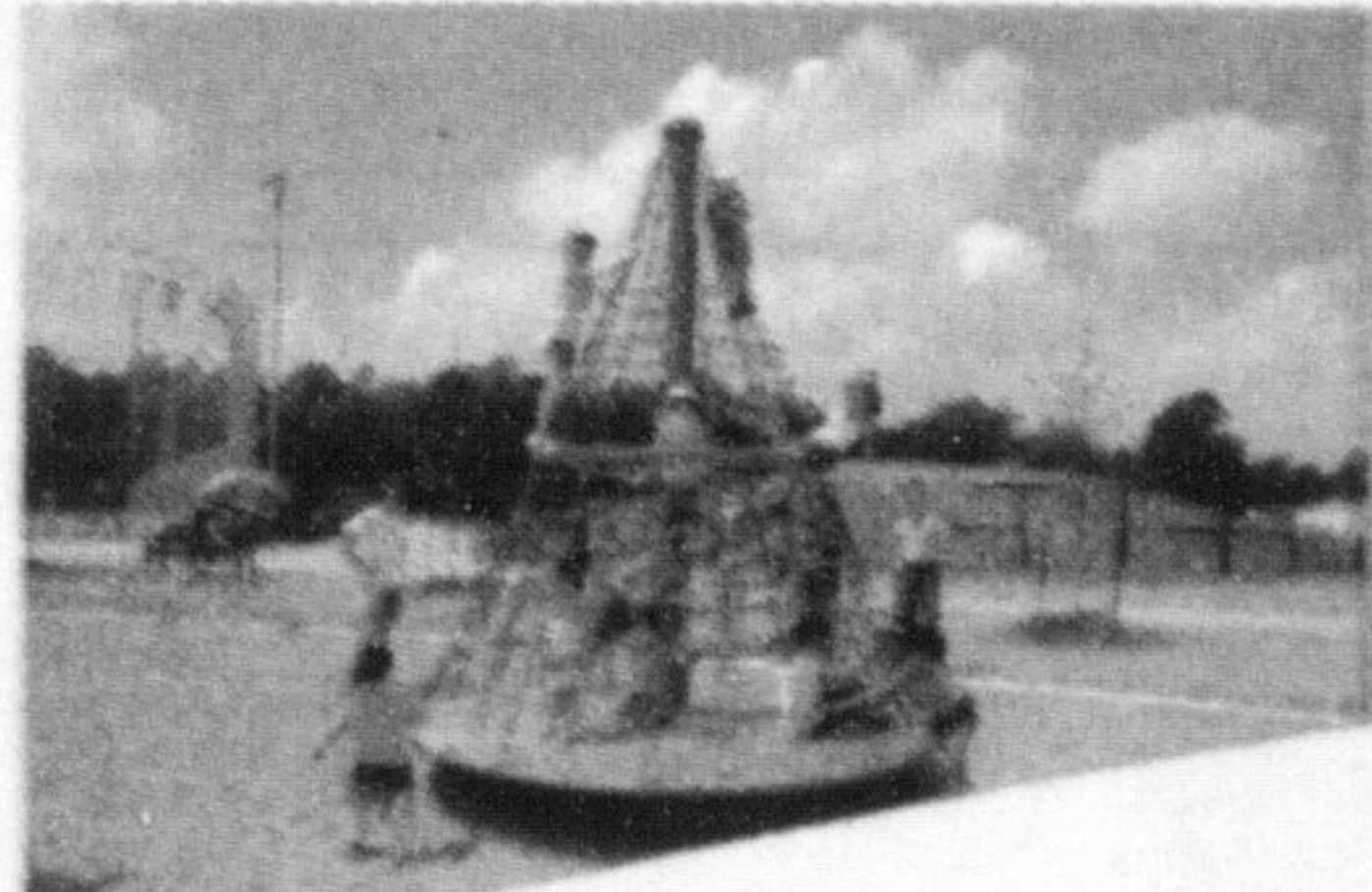

Parks and Trails

3 Public Consultations in September

Trails Master Plan Update Study Public Display of Background Materials

Monday, Sept. 11 - Friday, Sept. 22, 2006

- **Town Hall Victoria Park**
43 Brown Street, 8:30 a.m. - 4:30 p.m., weekdays
- **Milton Leisure Centre**
1100 Main Street East
Weekdays: 6 a.m. - 10 p.m. Weekends: 8 a.m. - 8 p.m.
- **Town website**

The Town of Milton recently initiated a study to revisit the Trails Master Plan (2001). This study update presents an opportunity to revisit the Town's strategy for supporting and encouraging walking and cycling. A key component of the study is to further develop the existing pedestrian and cycling network.

Another key component of the Trails Master Plan Update Study includes the development of an open space management plan for natural areas associated with the Jaycee Trail near the Mill Pond. Some of the primary goals of this management plan include ensuring trails are well connected to the town-wide trail system (existing and future), and that natural and cultural resources, such as forested blocks, are appropriately managed.

The purpose of this display is to introduce the goals and objectives of the study, provide details on the process that will be undertaken, and to encourage input and participation in the Trails Master Plan Update Study. The display will consist of six presentation boards, including the existing Trails Master Plan and study area for the Jaycee Trail Open Space Plan. Comment sheets will also be available at the display and on the Town website.

Should you have any questions or comments, please contact the following project representatives:

Contacts:

Mark Inglis, Marshall Macklin Monaghan
Phone: 905-882-7242 Fax: 905-882-0055
E-mail: inglism@mmm.ca

John Bryant, Manager, Parks & Open Space, Town of Milton
Phone: 905-878-7252, ext. 2160 Fax: 905-864-3222
E-mail: john.bryant@milton.ca

Off-leash Dog Park Community Open House

Thursday September 14, 2006

6:30 - 8:00 p.m.

Milton Leisure Centre, 1100 Main St. East

Attend this session to view and provide input on the proposed concept plans for this park.

Plans and comment sheets will also be available on the Town website as of September 15.

For more information, call 905-878-7252, ext. 2211.

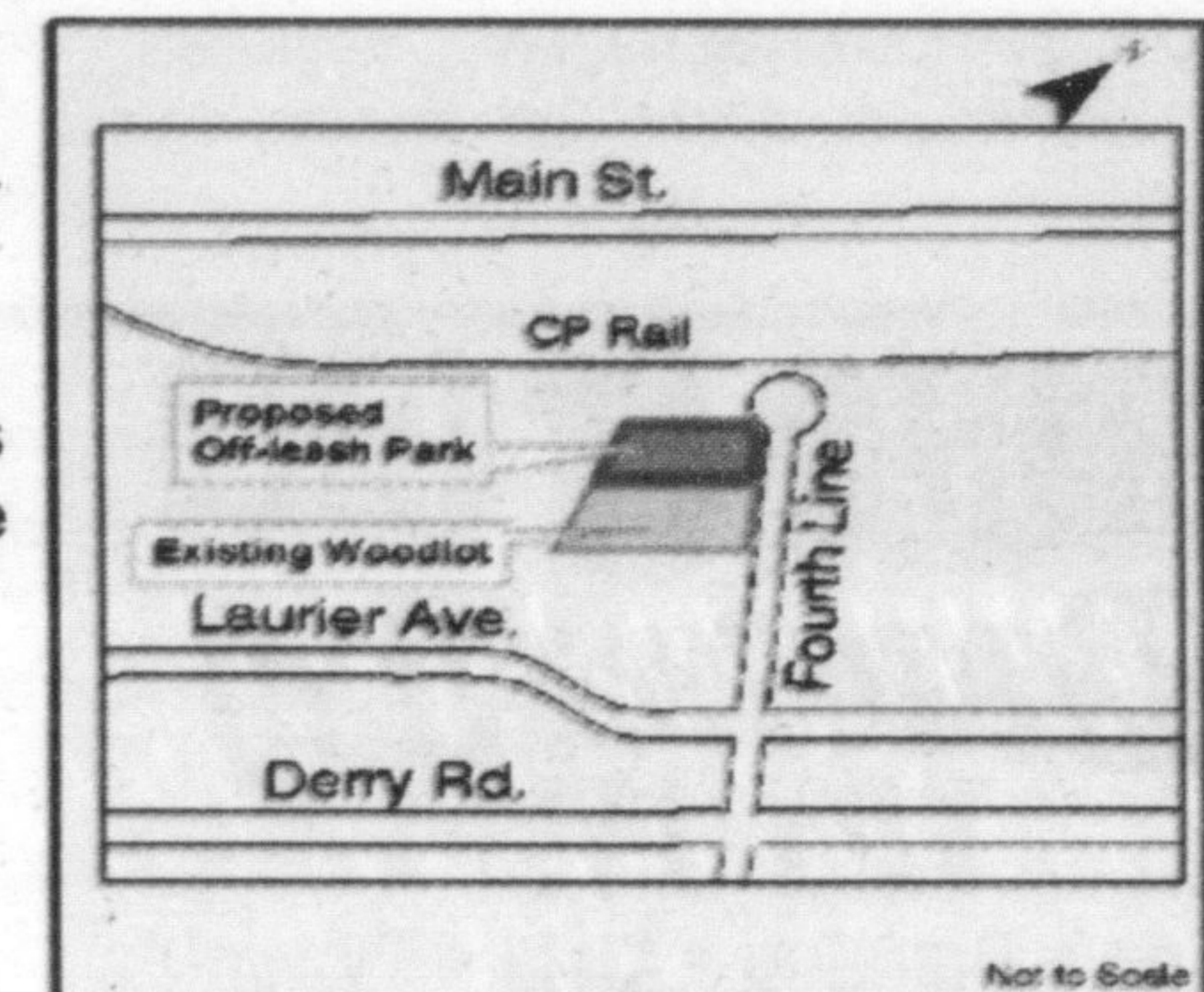

Brookville Park Expansion Community Open House #2

Wednesday, September 20, 2006

Drop-in: 6:30 - 8:30 p.m. Presentation: 7:00 p.m.

Nassagaweya Community Centre, 11264 Guelph Line, Brookville

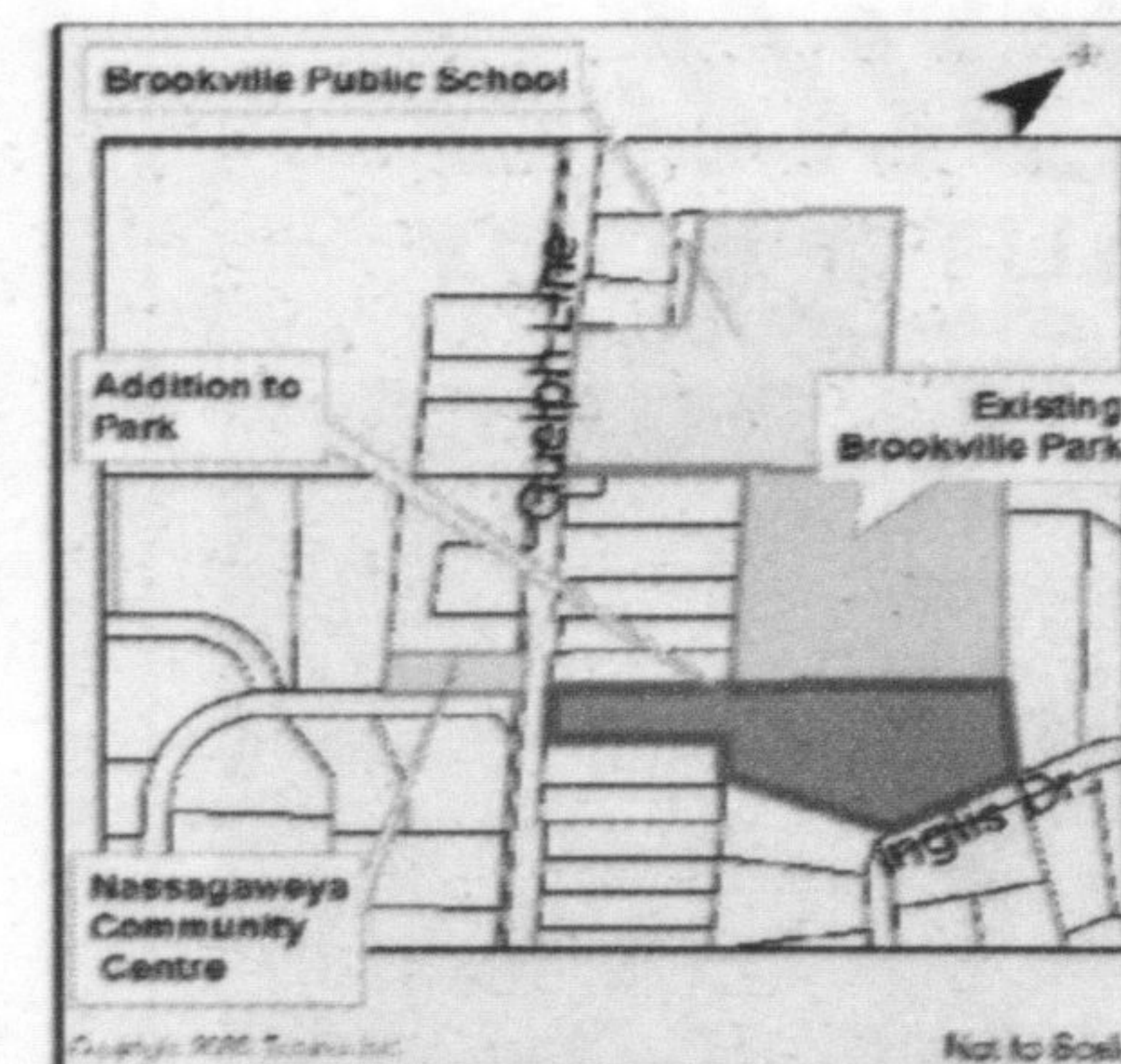

Since the first open house in February of this year, the Town has acquired another parcel of land to add onto this park expansion project. Join us to view and provide your comments on three unifying park concepts that are a result of the feedback received from the community so far. Your input will help shape a preferred option. Park concepts and comment forms will be also available on the Town website as of September 21. For more information, call 905-878-7252, ext. 2211.