

Unique photographs feature of upcoming fundraiser

Italian-themed event scheduled for February 5

The Conservation Halton (CH) Foundation is planning a one-of-a-kind fundraising event involving two unique photographs with an Italian theme.

The event, called an Italian Celebration of Life, will take place at the DiMario's Trattoria Restaurant in Burlington February 5.

Participants will enjoy a taste of fine Italian wine and food while experiencing the story of two unique photographs taken decades and worlds apart.

The first photograph, taken by famous photog-

rapher Ruth Orkin, is called American Girl in Italy, 1951. The other photo, taken this year on the streets of Burlington, simulates the scene of the first, which is now recognized internationally as a classic. The simulated photo has been called Canadian Girl in Burlington, 2005.

Both photos include a beautiful woman walking down the street while being looked at by several men. The models in both photos will be at the event to sign the limited-edition photo prints that each ticket holder will receive. Participants will also receive a photo gallery book entitled

'American Girl in Italy — The Making of a Classic'.

Proceeds from the event will support CH Foundation's R. Ross Craig Discovery Centre at the Mountsberg Conservation Area and Princess Margaret Hospital's Cervical Cancer Early Detection Research Program in honour of Concetta Guglietti.

The model in the original photograph, Ninalee Craig, a former resident of Burlington and life director of the conservation foundation, said the question she's been asked for the past 55 years since the photo was taken is if she posed for the photo and if the picture was staged.

"Absolutely not," Ms Craig said. "Ruth was striding ahead toward the Piazza. She turned, and saw me walking through a gauntlet of men. It was a situation she had long imagined. She shot a picture and shouted, 'Go back and step off that curb again.' I did. She shot, and on the second take photographed the American Girl in Italy."

Tickets to the event cost \$150 each and are available by calling Marino at DiMario's Trattoria Restaurant at (905) 333-8889. Tax receipts will be provided for \$50 each from the CH Foundation and the Princess Margaret Hospital Foundation.



The Regional Municipality of Halton

Halton Waste Management Site

User Fees are Changing at the Halton Waste Management Site (HWMS).

Halton Region will be changing the current user fees at the HWMS to keep up with increasing operating costs and to continue providing quality customer service as the Region grows.

Effective Monday, February 6, 2006, the new fee schedule will be:

New Fee Schedule

LOAD	RATE
0-50 kg Same (approximately 8 bags of household garbage)	\$5.00/load
51-150 kg New	\$10.00/load
Greater than 150 kg New	9.8 cents/kg from 0 kg (Tipping fee of \$98.00/tonne does not change)

Did you know?

50 kg is about eight garbage bags of household garbage or a small car trunk load of material. The new fees should not impact small loads coming to the HWMS, only those bringing larger loads into the HWMS. This will hopefully encourage our customers to look at how they can reduce, reuse or recycle.

Thanks to the efforts of Halton residents, Halton Region has one of the highest diversion rates in the GTA, with almost 42 per cent of all residential waste being diverted away from our landfill. The updated user fee at the HWMS continues to support the diversion of garbage from the landfill, increasing the lifespan of the landfill for the use of Halton residents.

HWMS
5400 Regional Rd. 25, Milton
Open: Monday - Saturday
8:00 a.m. - 4:30 p.m.
905-825-6000

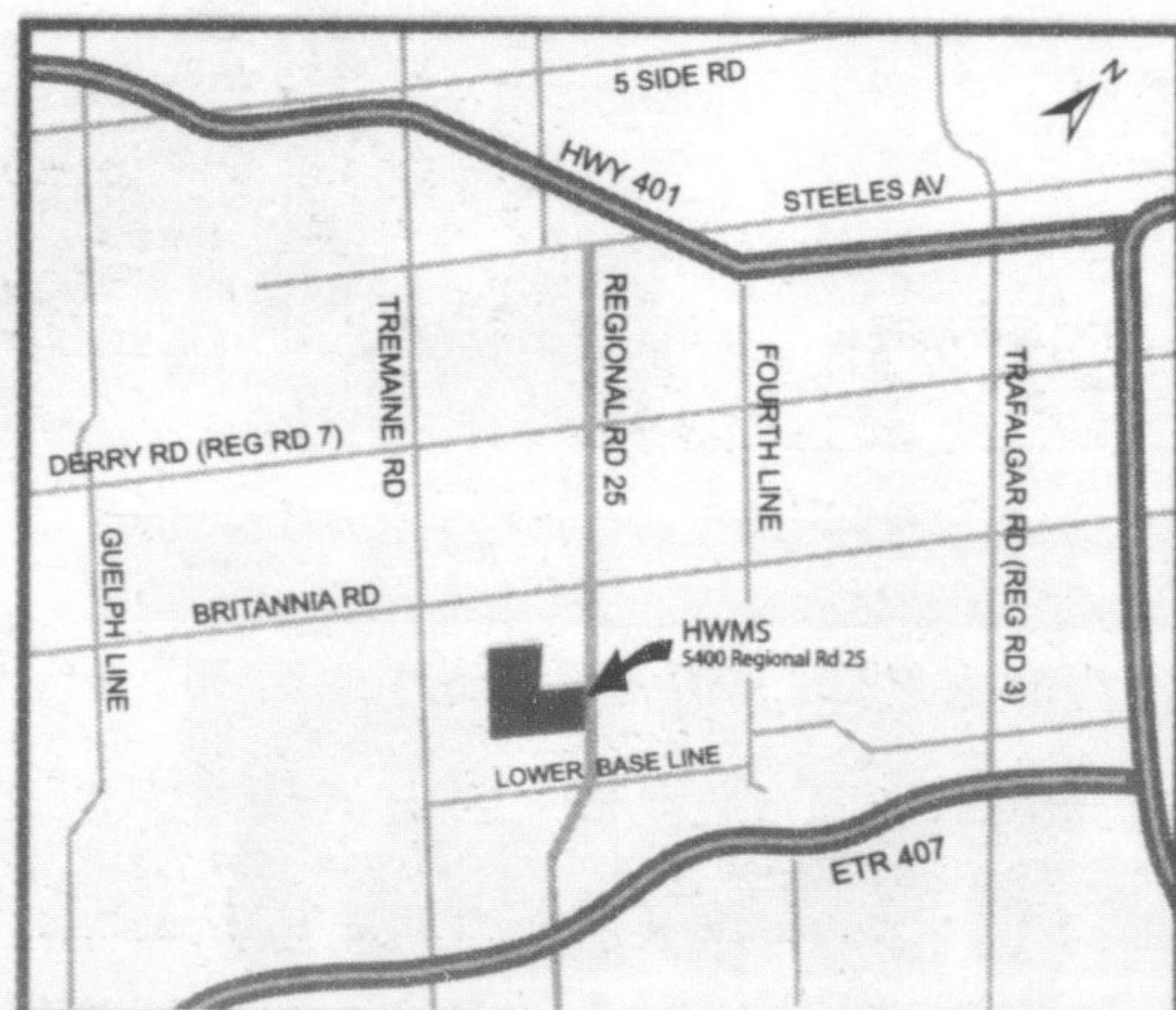

Christmas Tree Collection for Urban Areas of Milton

A change to the Christmas tree collection.

Due to the high volumes of waste after New Year's Day, collection of Christmas trees will not take place the week of January 2-6.

Before you place your tree at the curb, make sure it is ready to be recycled. Please remove decorations, bags and wires, and place your tree at the curb before 7:00 a.m. of your collection day (same day as your Blue Box collection). Please ensure Christmas trees are not frozen or buried in snow banks on your scheduled collection day.

January 2006

Monday	Tuesday	Wednesday	Thursday	Friday	Saturday
2	3	4	5	6	7
9	10	11 B	12	13	14
16	17	18 A	19	20	21
23	24	25 B	26	27	28
29	30	31			

Look for your 2006 Waste Management Calendar to be delivered to your mailbox mid-January 2006

Winter Tips for Setting Out Your Waste

- Place ALL items at the curb by 7:00 a.m. on your collection day, but not before 5:00 p.m. the evening before.
- In one Blue Box, place loose glass bottles and jars, metal food and beverage containers, aluminum foil, Styrofoam, plastic bottles and polycoat.
- In a second Blue Box flatten and place corrugated cardboard, fine paper, boxboard and newspapers.
- Tie cardboard in bundles no larger than 30"x30"x8" (76cm x 76cm x 20cm).
- To save space, crush pop cans, large plastic bottles and beverage cartons, and fill boxboard boxes with other boxboard items.
- On windy days, place your Blue Boxes out for collection on the morning of collection day by 7:00 a.m., instead of the night before.
- Stack your Blue Boxes on top of one another and place heavier items on top to prevent papers from blowing away.
- Place garbage bags/containers on one side of the driveway and Blue Boxes on the other side of the driveway.
- Keep waste items clear of snow and visible to collect. Do not place items on top of snowbanks.