

Halton Region

Halton Region *A Partnership That Works!*

NOTICE OF STUDY COMPLETION Guelph Line (Regional Road 1) Improvements. Town of Milton Class Environmental Assessment Study

The Regional Municipality of Halton has undertaken a Class Environmental Assessment (EA) to consider a wide range of options to correct the structural inadequacies and drainage deficiencies on Guelph Line (Regional Road 1) from 15 Side Road north to 20 Side Road (Regional Road 34). To best address the structural/drainage deficiencies associated with this segment of Guelph Line, a number of road improvement alternatives were examined as part of the study including complete reconstruction (2 lane), an improved vertical alignment, geometric and drainage improvements and improvements to the intersection of Guelph Line (RR1) and 20 Side Road (RR34), among other alternatives.

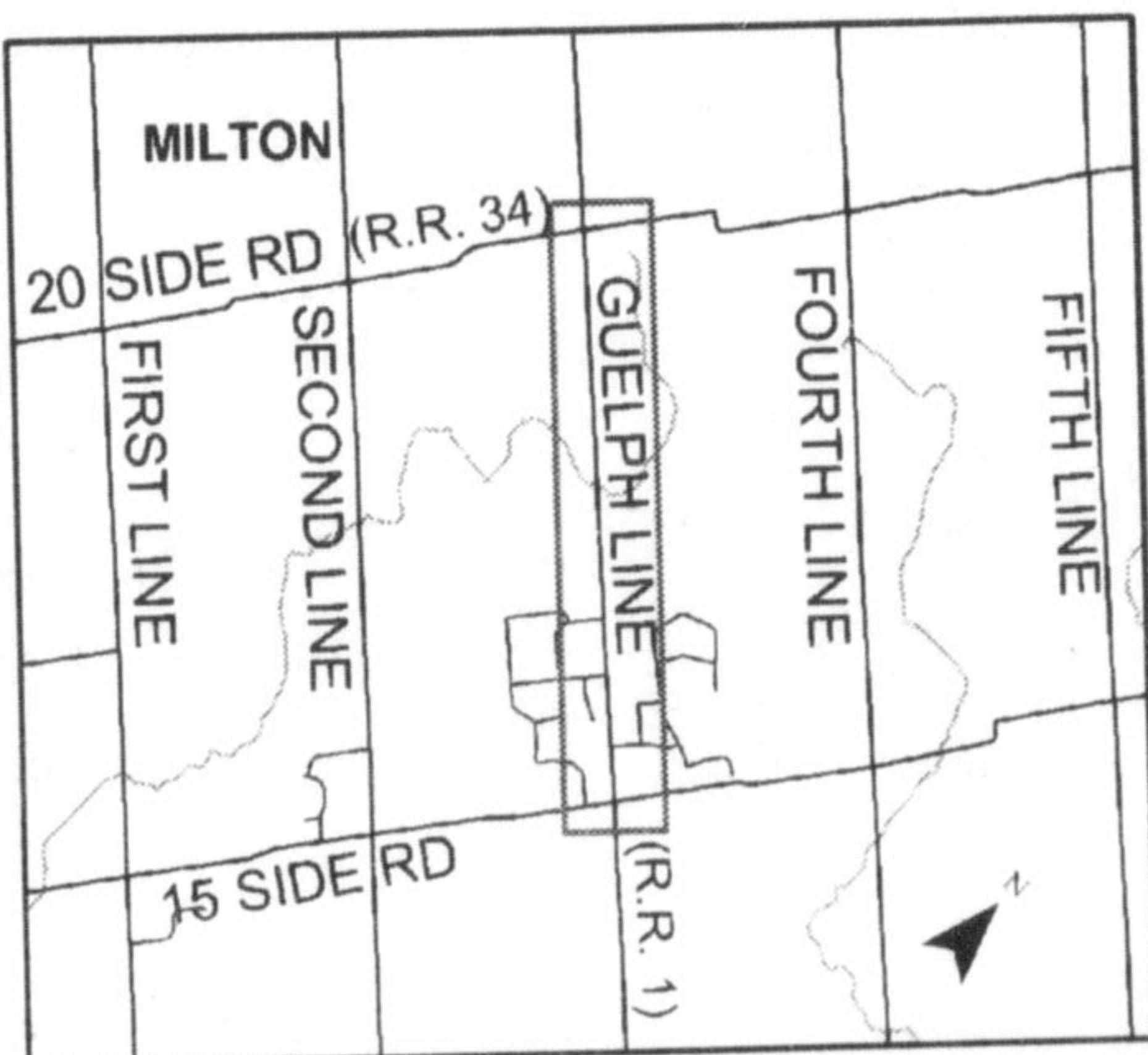

The study was conducted in compliance with Schedule C of the Municipal Engineers Association *Municipal Class Environmental Assessment (June 2000)*. In accordance with the *Municipal Class EA*, an Environmental Study Report (ESR) was prepared to document the planning and decision-making processes followed. As documented therein, the Preliminary Preferred Design calls for the reconstruction (2 lane) of the approximately 3.1 km segment of Guelph Line between 15 Side Road to 20 Side Road (RR 34).

By this Notice, the ESR is being placed on the public record for a 30-day review period in accordance with the requirements of the *Municipal Class EA*. Subject to comments received as a result of this Notice, the Region intends to proceed with detailed design and construction of the section of Guelph Line.

The Environmental Study Report is available for review at the following locations:

**Clerk's Department
Regional Municipality of Halton**
1151 Bronte Road
Oakville, Ontario
L6M 3L1
Phone: 905-825-6000
Mon-Fri: 8:30 am to 4:30 pm

**Clerk's Department
Town of Milton (Main Floor)**
43 Brown Street
Milton, ON L9T 5H2
L6J 5A6
Phone: 905-878-7211
Mon-Fri: 8:30 am to 4:30 pm

Milton Public Library
45 Bruce Street,
Milton, ON L9T 2L5
Phone: 905-875-2665
Mon: Closed
Tues-Thurs: 10:00 am to 9:00 pm
Fri-Sat: 10:00 am to 5:00 pm

Further information may be obtained from **Edward Soldo, P.Eng., Manager of Transportation Services, Halton Region, 905-825-6000, ext. 7475**. Please provide written comments to the Region's Manager by November 25, 2002 (within 30 calendar days from the date of this Notice). If concerns regarding this Project cannot be resolved through discussions with Regional staff, a person or party may request that the Minister of Environment make an order for the project to comply with Part II of the *Environmental Assessment Act* (referred to as a Part II Order). Requests for a Part II Order must be received by the Minister in writing, at the address provided below by November 25, 2002. A copy of the request must also be sent to the Region's Manager. If no request is received by November 25, 2002, the Region intends to proceed with detailed design and construction.

Minister of Environment
135 St. Clair Avenue West, 12th Floor,
Toronto, Ontario M4V 1P5

This Notice first issued on October 24, 2002

NOTICE OF STUDY COMPLETION Trafalgar Road (Regional Road 3) Improvements Town of Milton Class Environmental Assessment Study

The Regional Municipality of Halton has completed a Class Environmental Assessment (EA) to consider a wide range of options to satisfy travel demand on Trafalgar Road (Regional Road 3) from Britannia Road north to the south ramp of Highway 401. To best address the operational deficiencies that are currently associated with this segment of Trafalgar Road, a number of road improvement alternatives were examined as part of the study including widening of the roadway, new road alignments, railway crossing options, improvements to intersections and other alternatives.

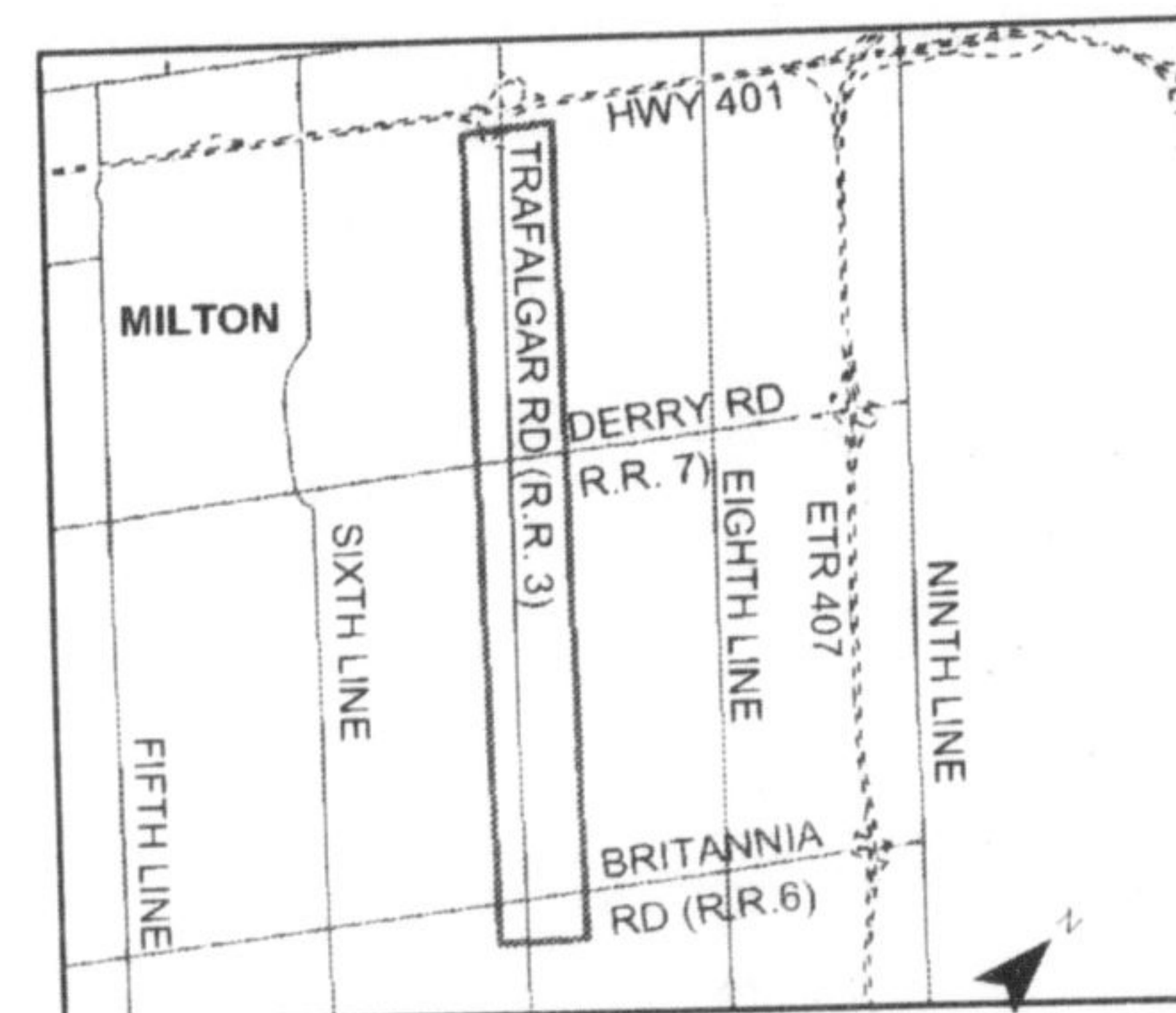

The study was conducted in compliance with Schedule C of the Municipal Engineers Association *Municipal Class Environmental Assessment (June 2000)*. In accordance with the *Municipal Class EA*, an Environmental Study Report (ESR) was prepared to document the planning and decision-making processes followed. As documented therein, the Preliminary Preferred Design calls for the widening of the approximately 5.1 km segment of Trafalgar Road (RR3) between Britannia Road (RR6) and the south ramp of Highway 401 from two to four lanes (five lanes in some sections) and construction of an overpass at the existing Canadian Pacific Rail crossing.

By this Notice, the ESR is being placed on the public record for a 30-day review period in accordance with the requirements of the *Municipal Class EA*. Subject to comments that were received in response to this Notice, the Region intends to proceed with detailed design and construction of the section of Trafalgar Road (RR3) between Britannia Road (RR25) and the south ramp of Highway 401.

The Environmental Study Report is available for review at the following locations:

**Clerk's Department
Regional Municipality of Halton**
1151 Bronte Road
Oakville, Ontario
L6M 3L1
Phone: 905-825-6000
Mon-Fri: 8:30 am to 4:30 pm

**Clerk's Department
Town of Milton (Main Floor)**
43 Brown Street
Milton, ON L9T 5H2
L6J 5A6
Phone: 905-878-7211
Mon-Fri: 8:30 am to 4:30 pm

Milton Public Library
45 Bruce Street,
Milton, ON L9T 2L5
Phone: 905-875-2665
Mon: Closed
Tues-Thurs: 10:00 am to 9:00 pm
Fri-Sat: 10:00 am to 5:00 pm

Further information may be obtained from **Edward Soldo, P.Eng., Manager of Transportation Services, Halton Region, 905-825-6000, ext. 7475**. Please provide written comments to the Region's Manager by November 25, 2002 (within 30 calendar days from the date of this Notice). If concerns regarding this Project cannot be resolved through discussions with Regional staff, a person or party may request that the Minister of Environment make an order for the project to comply with Part II of the *Environmental Assessment Act* (referred to as a Part II Order). Requests for a Part II Order must be received by the Minister in writing, at the address provided below by November 25, 2002. A copy of the request must also be sent to the Region's Manager. If no request is received by November 25, 2002, the Region intends to proceed with detailed design and construction.

Minister of Environment
135 St. Clair Avenue West, 12th Floor,
Toronto, Ontario M4V 1P5

This Notice first issued on October 24, 2002

Halton Region - Focusing on Young Children

October 19th to 27th has been designated the **Week of the Child** - a week to focus on the needs, rights and interests of young children, and to heighten awareness about the value of quality early childhood education. Presented in collaboration with the Association of Early Childhood Educators in Ontario, The Halton Resource Connection and Halton Region, events geared to young children and their families have been taking place in childcare centres, schools, libraries and parks throughout the Region all week. Children of all ages are invited to attend the final event "Children's Art in the Centre" at the Ontario Early Years Centre in Georgetown, 96 Guelph Street from 10:00 am to 12:00 pm on Saturday, October 26th.



Joyce Solone
Halton Regional Chairman
and Chair, Emergency
Housing Advisory Group



1151 Bronte Road, Oakville, ON L6M 3L1
905-825-6000 Toll free: 1-866-4HALTON (1-866-442-5866)
TTY 905-827-9833
or visit us at: www.region.halton.on.ca