

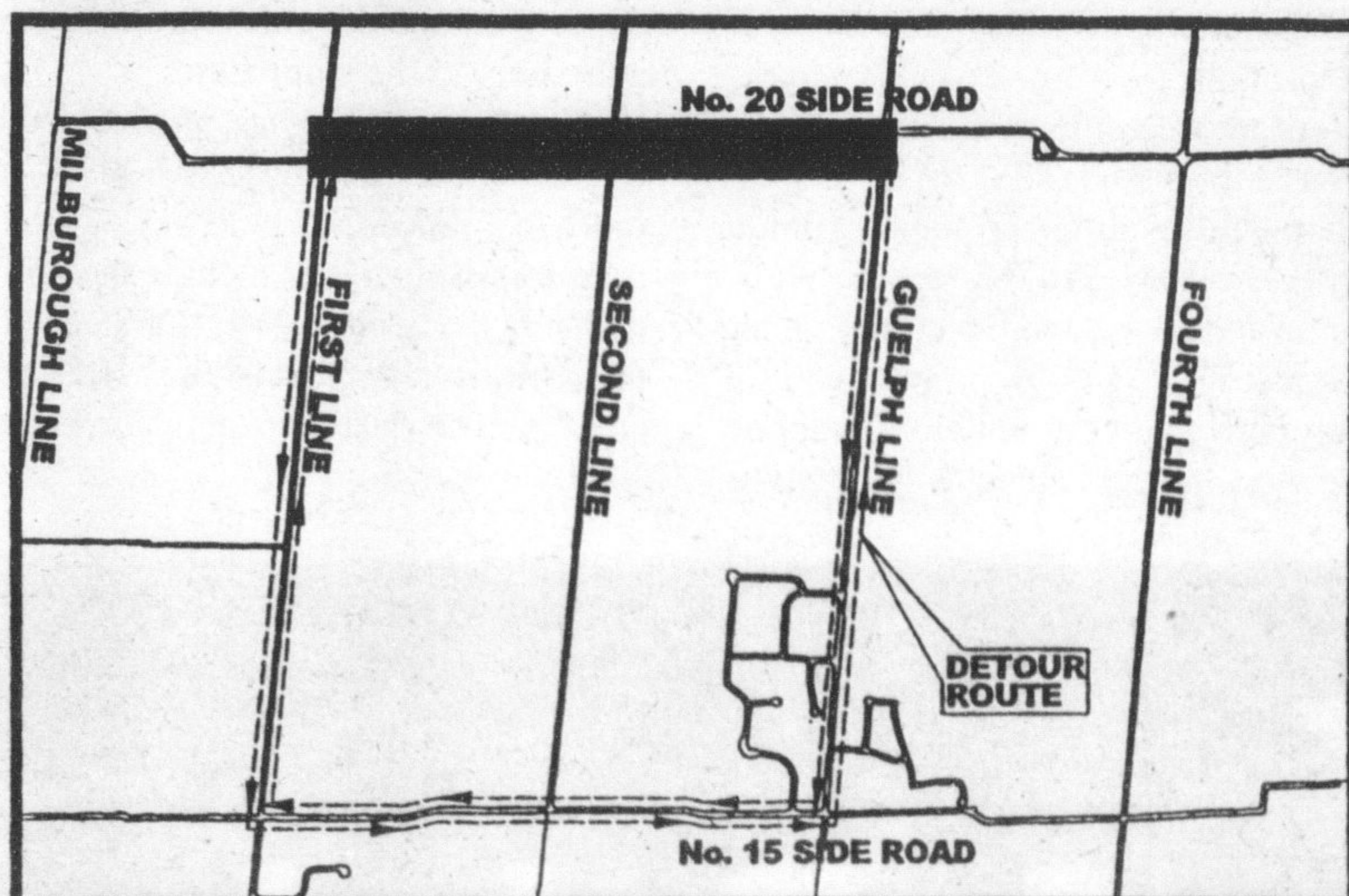

NOTICE OF ROAD CLOSURE ON NO. 20 SIDEROAD BETWEEN FIRST LINE AND GUELPH LINE



2001 ASPHALT RESURFACING PROGRAM, TOWN OF MILTON

CONTRACT NUMBER:	R-2034-01
CLOSURE START DATE:	JULY 25, 2001
CLOSURE COMPLETION DATE:	JULY 27, 2001
CONSTRUCTION SUPERVISOR:	BRENT HAMMOND
TELEPHONE:	905-825-6000 EXT. 7609
TOLL FREE:	1-866-4HALTON (1-866-442-5866)
ON THE WEB:	www.region.halton.on.ca

Dateline

Dateline is a free listing of coming events only. The column is available to local community groups to assist in promoting their future events. Only charitable or non-profit community groups may use this service. We can only guarantee one issue of publicity closest to the date of the occurrence although more insertions are possible if demand is low.

Notices for Dateline should be handed in at the office of The Champion, 191 Main St. E., mailed to P.O. Box 248, Milton, Ont., L9T 4N9, faxed to (905) 878-4943, or e-mailed to miltoned@haltonsearch.com. The final deadline is noon Friday for Tuesday's edition and noon Wednesday for Friday's edition. Dateline items will not be accepted by telephone.

Tuesday July 24

Improve your leadership and communication skills with the Milton Toastmasters. Everyone is

welcome at the Royal Canadian Legion, 21 Charles St. (upper level), at 7:30 p.m. For more information, call Ross London at (905) 875-3720.

The Parent Support Group meets at Pinelands Presbyterian Church, 5270 New St., in Burlington at 7:30 p.m. The self-support group helps parents of children who are in trouble at home, at school, with the law or who are abusive or taking drugs. For more information, call (416) 251-0233 (days) or (905) 842-1729 (evenings).

Wednesday July 25

The Milton Human Resource Centre hosts a free workshop for job seekers. Maximize your interview potential from 9 a.m. to noon. For more information, call Kerry at 1-888-689-9798.

Thursday July 26

The Milton Seniors' Activity Centre Diners Club meet at 6 p.m. Join members for comradeship,

great food and hearty socializing. For more information or to arrange for car pooling, call (905) 875-1681.

VON Alzheimer Services welcomes new caregivers to the Milton-area support group. The group meets in the Community Room (upstairs at Loblaws) on Nipissing Road from 2 to 3:30 p.m. If you're a caregiver for a relative with Alzheimer's disease or a related disorder and are interested in meeting other caregivers, call (905) 847-9559.

R.A.I.L. (Residents Against Intermodal Lines) hosts a general information meeting at the Milton Seniors' Activity Centre, 500 Childs Dr., at 7:30 p.m. Citizens are invited to share concerns with water pollution, noise, light and traffic surrounding the proposed CN intermodal facility. For more information, call Gwen Gent at (905) 876-2837.

Police auction this Saturday

Going, going, gone! Halton Regional Police will host an indoor auction at regional headquarters, 1151 Bronte Rd., in Oakville Saturday.

Viewing and registration will

take place from 8:30 to 9:30 a.m. Then the auction will begin at 9:30 a.m. sharp.

There will be something for everyone, according to auction organizers.

More than 100 bicycles, gold clubs, GT snowracers, jewellery, fishing tackle, two bowling balls, clothing and a Hoover wet/dry vacuum will be up for grabs.

Refreshments will be served.

A DEERE FOR ALL SEASONS

90 DAYS NO PAYMENTS, NO INTEREST ON ALL JOHN DEERE RIDING LAWN EQUIPMENT*

LX277 Lawn Tractor
• 17-hp engine
• 48-inch convertible mowing deck
• Automatic transmission

ONLY \$5,999



LT155 Lawn Tractor
• 15-hp engine
• 42-inch mowing deck
• Automatic transmission

ONLY \$3,699



For the past 163 years, John Deere has held the highest standards of honesty, quality, and commitment to the customer. Stop in to Evergreen to see for yourself our time tested reliability. You'll find that our standards haven't changed much over the years.

LT133 Lawn Tractor
• 13-hp overhead-valve engine
• 5-speed shift on-the-go transmission
• 38-inch mower deck
• More than 9 attachments available

ONLY \$2,799

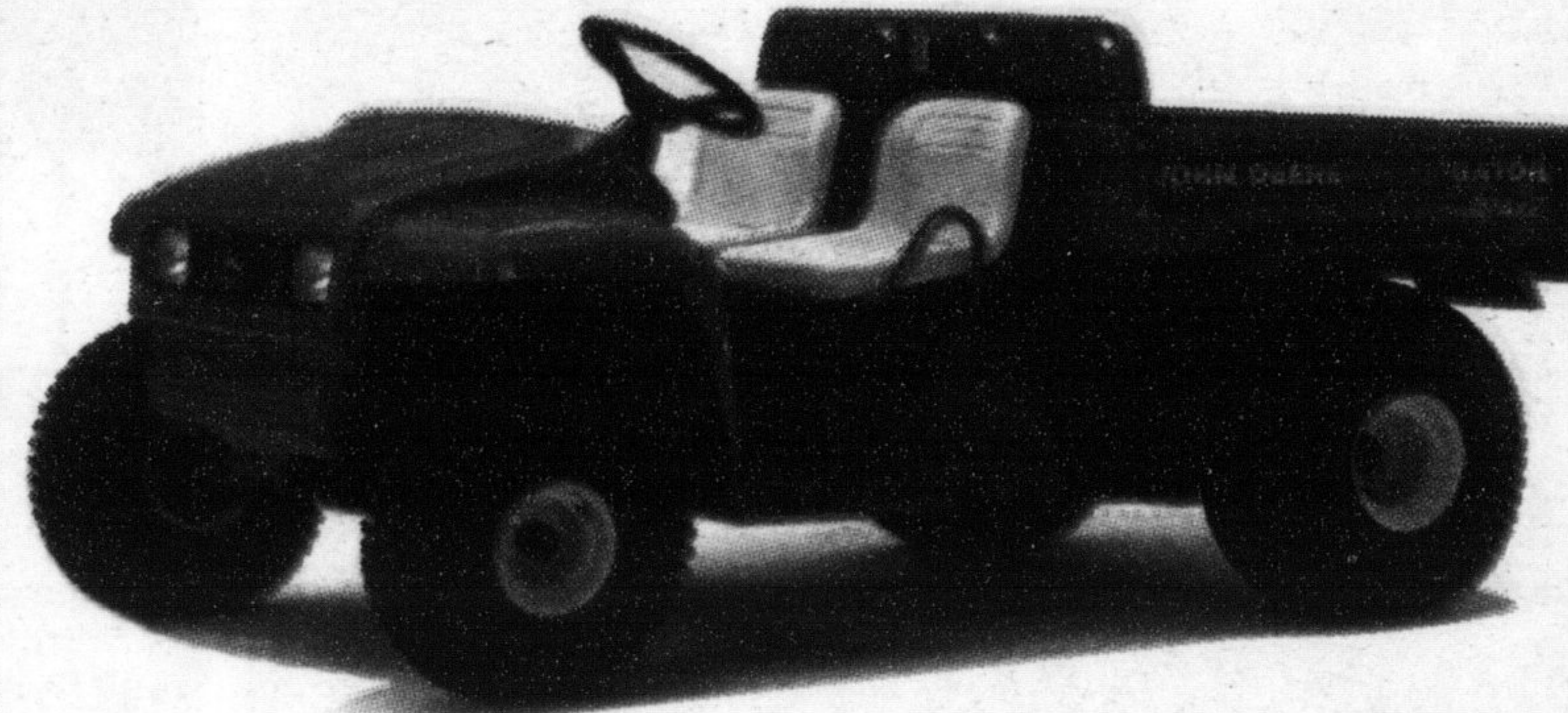

GATOR® 4x2 Utility Vehicle
• 286cc
• Independent front suspension
• 900-lb. towing capacity

ONLY \$8,741



www.JohnDeere.com

NOTHING RUNS LIKE A DEERE®

Milton
HALTON GROUNDS CARE EQUIPMENT
1589 Steeles Avenue
905-878-8121

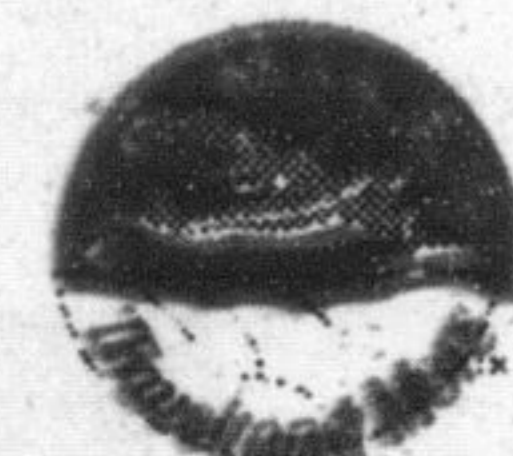

*Offer ends July 27, 2001. Subject to AgLine® approval and John Deere dealer participation. For non-commercial use only. After interest free period: 1) minimum monthly payment required and 2) for eligible purchases of goods and services, finance charges will begin to accrue on amount financed at 19.75% per annum (on the first day following the interest free period). A \$0.50 per month minimum finance charge may be applied to unpaid balances. Minimum purchase required. See your John Deere dealer for details. ©TMT Trademarks of AIR MILES International Trading B.V. Used under license by Loyalty Management Group Canada Inc. and AgLine®.

D7597-04-15061