

DEVELOPMENT CHARGES ACT, R.S.O. 1990 R.R.O. 1990, REG. 267

NOTICE OF THE PASSING OF THE DEVELOPMENT CHARGE BY-LAW BY THE CORPORATION OF THE REGIONAL MUNICIPALITY OF HALTON

TAKE NOTICE that the Council of the Regional Municipality of Halton passed By-law No. 14-99 on the 10th of February, 1999 under Section 4 and 7 of the Development Charges Act.
AND TAKE NOTICE that any person or agency may forward written comments to the Minister of Municipal Affairs and Housing.

An explanation of the development charges amended and imposed under the lands to which the By-law applies and key maps showing the locations of the lands to which the By-law applies are set out below. The complete By-law is available for inspection at the Clerk's office during regular office hours, 8:30 a.m. to 4:30 p.m., Monday to Friday.

Dated at the Town of Oakville, in the Regional Municipality of Halton on the 19th day of February, 1999.

Joan A. Eaglesham
Regional Clerk

By-Law No. 14-99

A BY-LAW TO AMEND BY-LAW 90-94, AS AMENDED, BEING A BY-LAW TO ESTABLISH NEW DEVELOPMENT CHARGES FOR THE REGIONAL MUNICIPALITY OF HALTON

By-law No. 14-99 amends Development Charges By-law 90-94 (as amended) which establishes Development Charges for residential and non-residential uses in the Regional Municipality of Halton as identified in Maps A and B with applicable development charge rates shown in Schedules A and B.

The purpose of this amendment is to delete the provisions that provide for the term of the By-law pursuant to Subsection 49(1) of the Land Use Planning and Protection Act, 1996. All other terms, conditions and rates of By-law 90-94 (as amended) are unchanged. This By-law comes into force on the date it is passed by Regional Council.

SCHEDULE A

REGION OF HALTON RESIDENTIAL DEVELOPMENT CHARGES EFFECTIVE OCTOBER 7, 1998

	Single and Semi Detached	Low Density Multiples (excluding apartments)	Apartments 2 Bedrooms Or More	Apartments Less Than 2 Bedrooms	Special Care Dwellings
Region-Wide Charges (Urban and Rural)					
General Services					
-General Government	\$ 225.07	\$ 190.20	\$ 139.46	\$ 95.10	\$ 69.75
-Police	187.90	158.79	116.42	79.39	58.23
-Hospitals	230.00	194.36	142.51	97.18	71.28
Roads	1,208.52	1,021.23	748.93	510.62	374.47
Waste Management	261.07	220.64	161.77	110.31	80.89
Sub Total	\$ 2,112.56	\$ 1,785.22	\$ 1,309.09	\$ 892.60	\$ 654.62
Specific Urban Charges					
Wastewater	1,026.19	867.20	635.95	433.61	317.97
Water	1,843.22	1,557.69	1,142.25	778.79	571.17
Sub Total	\$ 2,869.41	\$ 2,424.89	\$ 1,778.20	\$ 1,212.40	\$ 889.14
Total Urban Charge (excluding Surcharge)	\$ 4,981.97	\$ 4,210.11	\$ 3,087.29	\$ 2,105.00	\$ 1,543.76
Rural Charges					
Hydro Studies	256.21	216.51	158.81	108.20	79.40
Region-Wide Services	2,112.56	1,785.22	1,309.09	892.60	654.62
Total Rural Charges	\$ 2,368.77	\$ 2,001.73	\$ 1,467.90	\$ 1,000.80	\$ 734.02
Surcharges					
Oakville (Urban Phase 2)	821.65	694.34	509.20	347.09	254.62
Total Levy	\$ 5,803.62	\$ 4,904.45	\$ 3,596.49	\$ 2,452.09	\$ 1,798.38
Georgetown (Infill)	955.72	807.57	592.31	403.78	296.09
Total Levy	\$ 5,937.69	\$ 5,017.68	\$ 3,679.60	\$ 2,508.78	\$ 1,839.85
Georgetown (Non-Infill)	1,085.23	917.05	672.60	458.57	336.24
Total Levy	\$ 6,067.20	\$ 5,127.16	\$ 3,759.89	\$ 2,563.57	\$ 1,880.00

SCHEDULE B

REGION OF HALTON NON-RESIDENTIAL DEVELOPMENT CHARGES EFFECTIVE OCTOBER 7, 1998

PER SQUARE FOOT OF GROSS FLOOR AREA

Region-Wide Charges (Urban and Rural)	
Roads	\$ 0.822
Specific Urban Charges	
Water	\$ 1.031
Wastewater	0.430
Sub-Total	\$ 1.461
Total Urban Charges	\$ 2.283
Total Rural Charges	\$ 0.822

MAP A SCHEDULE OF URBAN AREAS
WITHIN HALTON REGION

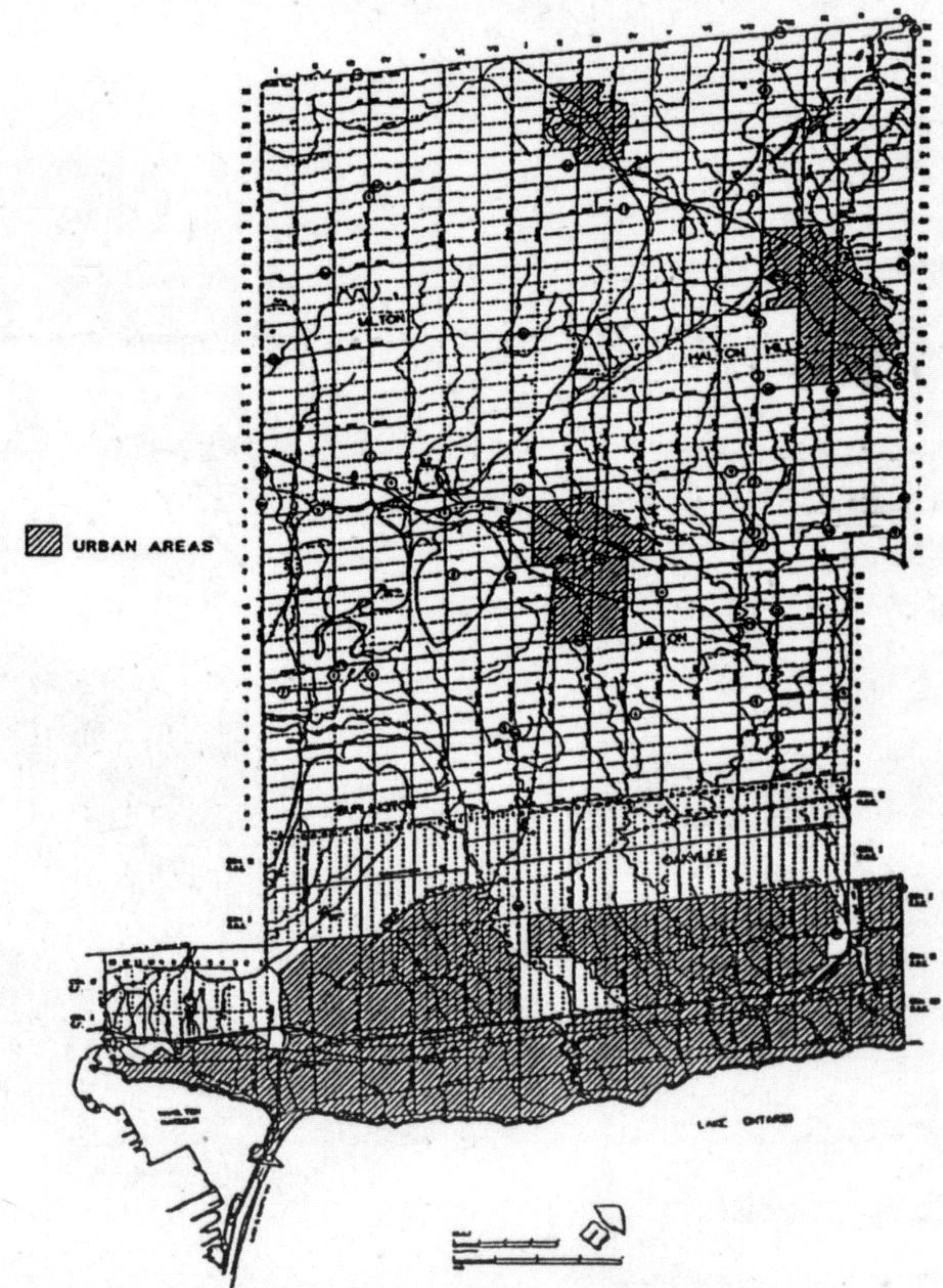

MAP B

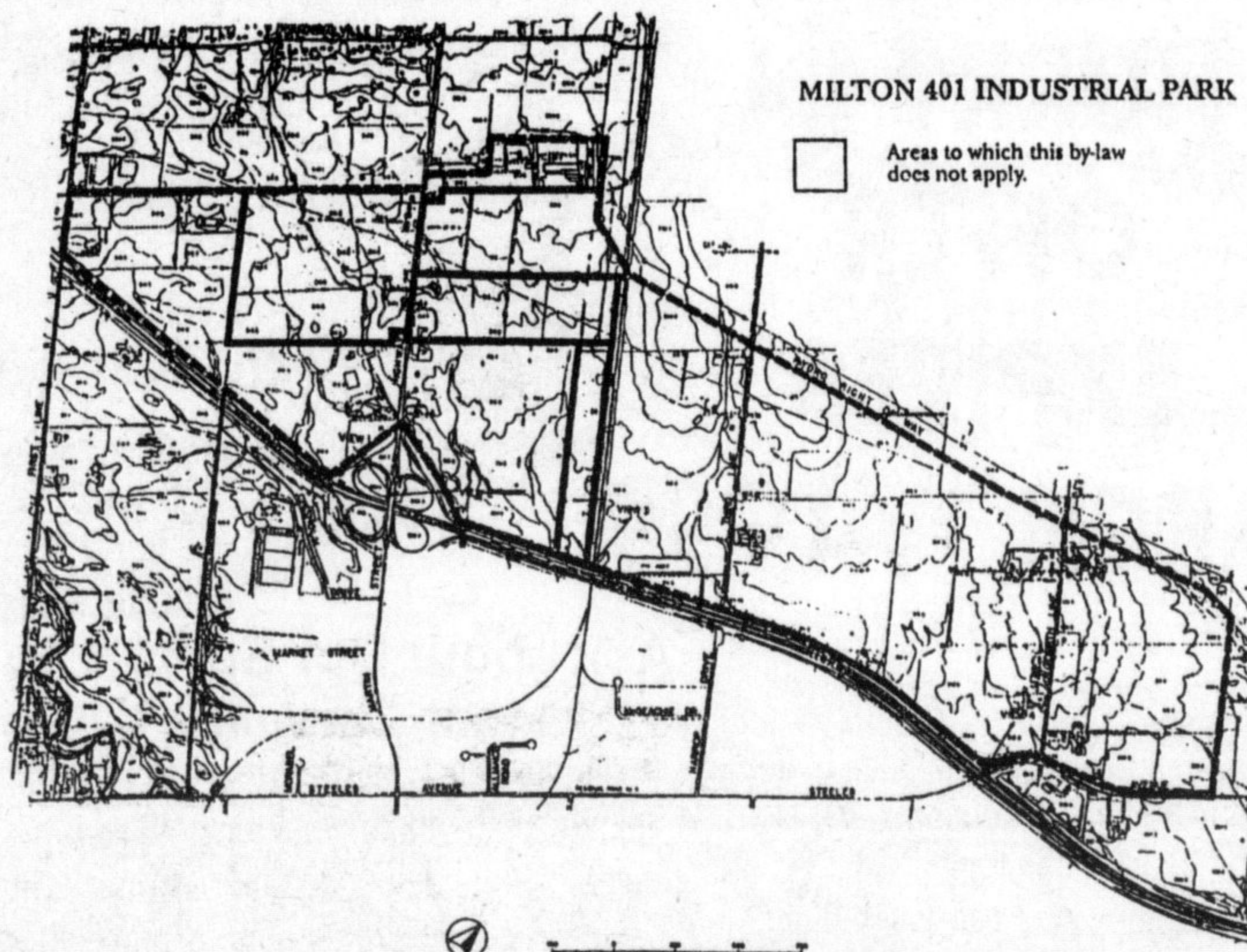

For further information please contact: Mark Scinooca, Corporate Services Department, Budgets & Fiscal Policy Services Division, 905-825-6000, extension 7043.

Regional Municipality of Halton, 1151 Bronte Road, Oakville, Ontario, L6M 3L1



www.region.halton.on.ca