

DESIGN FOR LIVING



©Copyright Select Home Designs. All rights reserved

Plan No. 2095-1338

RANCHER CAPITALIZES ON REAR VIEW

- Economical to build rancher provides a contemporary interior well suited for those who want to maximize their privacy.
- Main living areas are oriented towards the rear of the design focusing on the backyard.
- Open floor plan minimizes hallways and provides a layout without wasted space.
- Full height windows flank the fireplace creating a feature wall and allowing furniture placement without compromising the view.
- Country kitchen features a vaulted ceiling and sunny breakfast bay.
- Master bedroom boasts a walk-in closet and full bath with whirlpool spa.

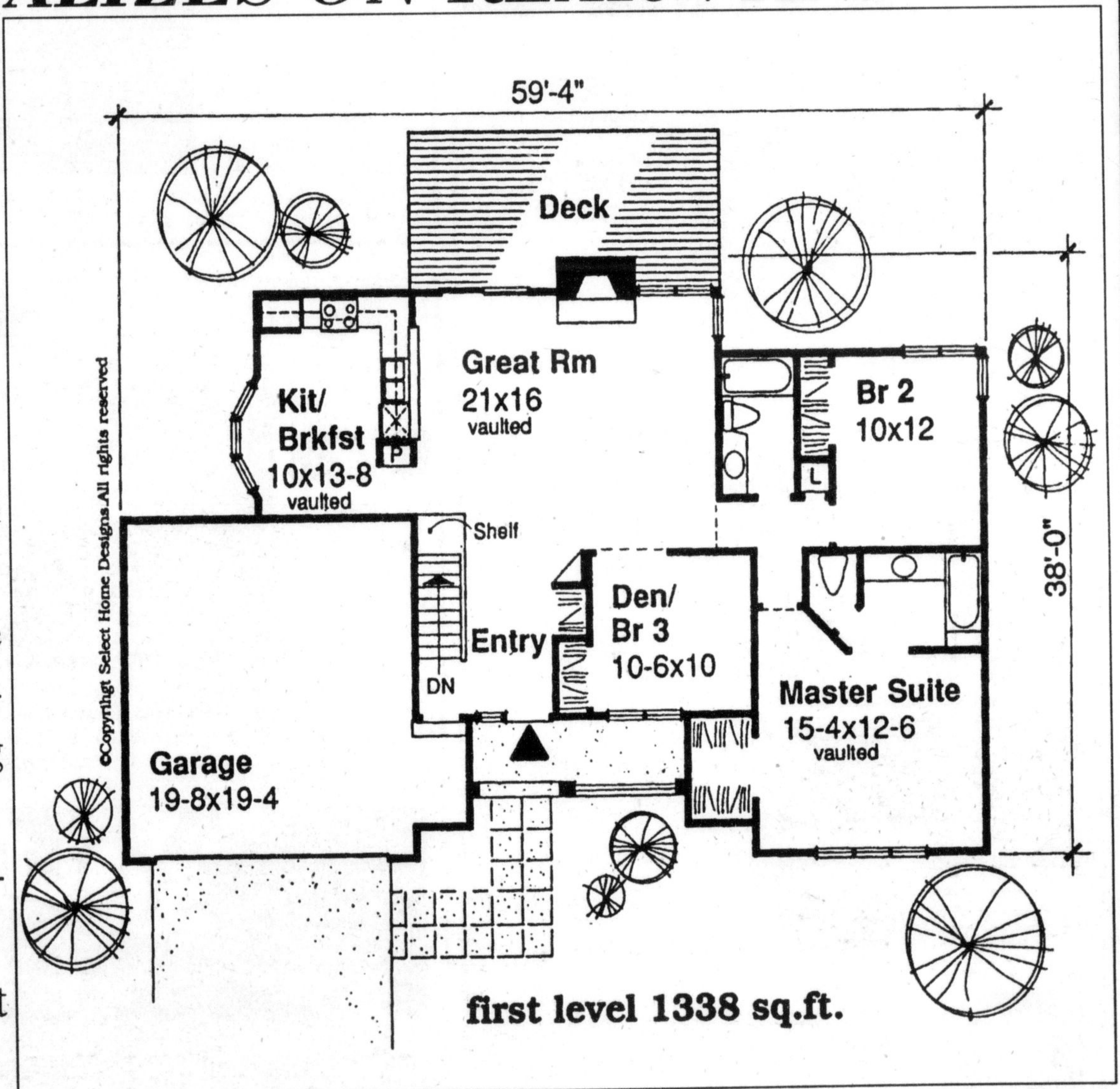

To receive a 300 page plan book for only \$9.95 (including shipping and GST) featuring this design and more than 400 other beautifully illustrated home and cottage designs, e-mail to: selecthomedesigns@msn.com or use our website at www.selectaplan.com on the internet (specify newspaper name) or call 1-800-663-6739 or fax (604) 251-3212. We accept Visa/Mastercard/AMEX. For payment via cheque or money order, make payable to Design for Living, c/o this newspaper, send to #301, 611 Alexander Street, Vancouver, B.C., V6A 1E1.