



Simply Halton

Your Halton
Connecting
September 05

GreenCart Demonstration Program

Key Dates

September 6
Cart Delivery Starts

September 12, 5:00 p.m. - 8:30 p.m.
Oakville Open House
(Iroquois Ridge Rec. Centre, 1051 Glenashton Dr.)

September 14, 5:00 p.m. - 8:30 p.m.
Milton Open House
(Halton Region Museum, Kelso Conservation Area)

September 20, 5:00 p.m. - 8:30 p.m.
Halton Hills Open House
(Salvation Army, 271 Mountainview Rd. S.)

September 21, 5:00 p.m. - 8:30 p.m.
Burlington Ward 6 Open House
(Tansley Woods Centre, 1996 Itabashi Way)

September 22, 5:00 p.m. - 8:30 p.m.
Burlington Ward 1 Open House
(Royal Botanical Gdns., 680 Plains Rd. W.)

October 3, 2005
GreenCart Collection Begins

Demonstration Area

Georgetown Wednesday Collection

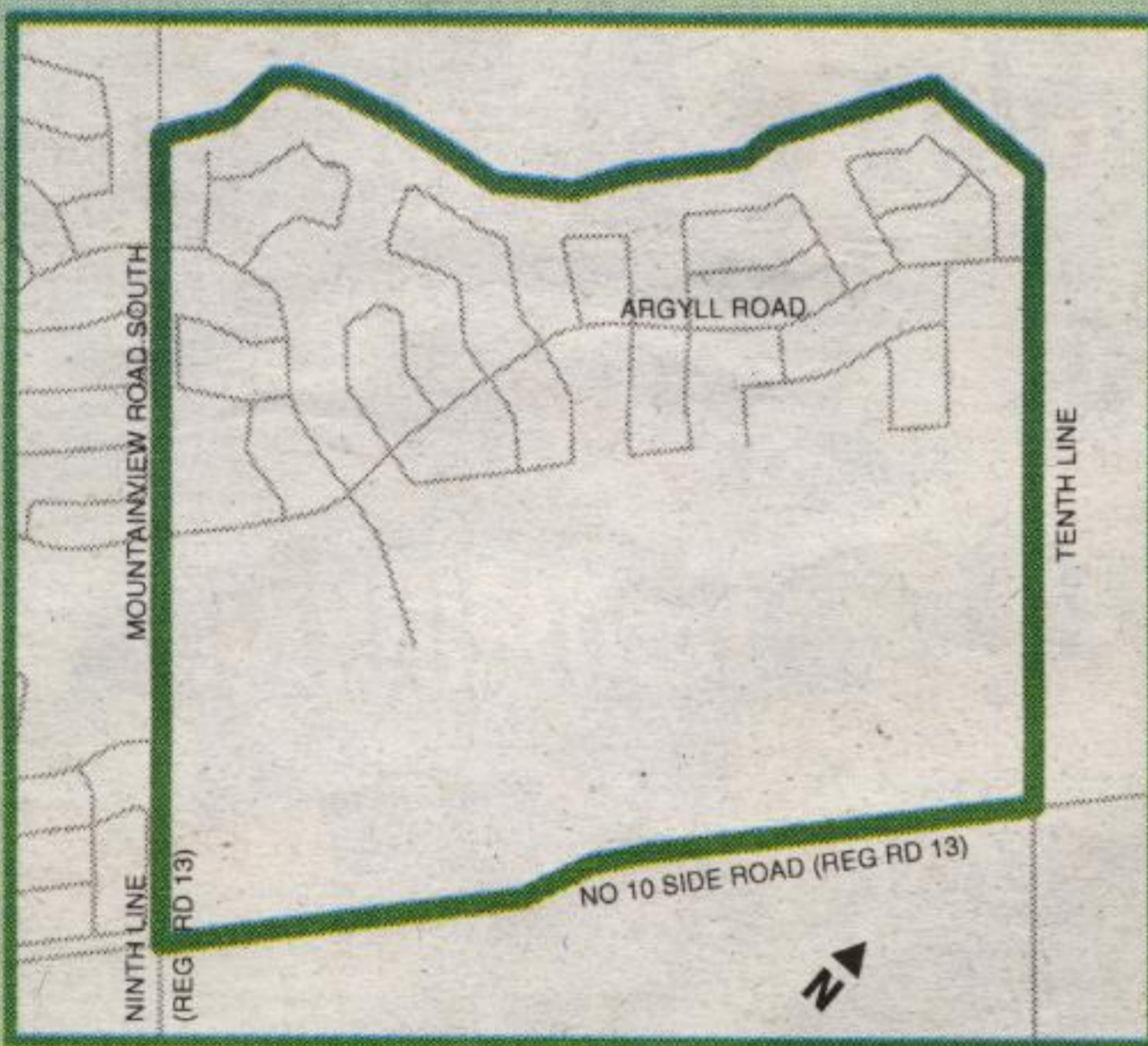

Halton Meetings & Events

Monday, September 5
Offices closed for Labour Day

Wednesday, September 7
9:30 a.m. Planning & Public Works Committee
1:30 p.m. Administration & Finance Committee

Thursday, September 8
9:30 a.m. Health & Social Services Committee

Wednesday, September 14
9:30 a.m. Regional Council

Tuesday, September 27
9:30 a.m. Health & Social Services Committee

Wednesday, September 28
9:30 a.m. Planning & Public Works Committee
1:30 p.m. Administration & Finance Committee

GreenCart program helps protect our resources and environment



Joyce Savoline
REGIONAL CHAIRMAN

On October 3, approximately 5,000 Halton residents in five neighbourhoods across the Region will start participating in Halton's GreenCart demonstration program and begin making a difference in their communities. The GreenCart program is a key initiative in Halton's Solid Waste Management Strategy that will help extend the life of our landfill.

The Halton Waste Management Site (HWMS) opened in 1992 following an \$8-million, 10-year Environmental Assessment process and a construction cost of approximately \$52 million. On top of these figures are untold hours of discussions, a Joint Board Hearing that culminated in 194 days of evidence and almost 50,000 pages of transcript. Given the enormity of the investment that went into the development of Halton's landfill, you can appreciate the efforts to manage and maximize its capacity!

Since the HWMS opened, Halton has diligently implemented several programs to stretch the facility's life expectancy beyond the initially projected 20

years. It is with thanks to your ongoing commitment towards waste management through participation in the recycling and the yard waste programs, that we have been successful in extending the lifespan of our landfill. With your continued support of new waste management strategies to divert garbage, such as the GreenCart program, it will be possible for us to double the landfill's original lifespan.

The amount of residential waste being diverted away from Halton's landfill continues to increase. In 1999, 38.2% of Halton's residential waste was diverted from our landfill. In 2004, your continued diligence and environmental stewardship led to Halton achieving one of the highest waste diversion rates in the GTA, with 41.6% of residential waste being kept out of Halton's landfill. We will be working to increase this figure, as we anticipate Provincial direction that all municipalities are to increase their diversion rate to 60% and Halton's new GreenCart program will be integral to helping us meet this target.

The GreenCart demonstration program was developed following extensive research, best practice analysis and discussions amongst Regional Council. The program will be continually monitored and evaluated with the expectation that following Council approval, the GreenCart program will be offered to all residents—another 'made in Halton solution' to manage Halton's waste.

Halton Region can't extend the life of our landfill on our own. We need the ongoing support of our residents and we'd like to thank you in advance for your participation as we embark on this new frontier of waste management in Halton Region.

Halton's GreenCart: The Blue Box for your kitchen scraps



A. Brent Marshall
CHIEF ADMINISTRATIVE OFFICER

Our new GreenCart demonstration program is like a Blue Box for your kitchen scraps and is key to helping extend the life of our landfill, while continuing our efforts towards environmental protection.

Currently, almost 45% of the content of an average household garbage bag is made up of material that could be going in the GreenCart. This new program will allow for material such as kitchen scraps (including meat and bones), paper towels and coffee grounds to be collected curbside in the GreenCart, instead of in a regular garbage bag. With your participation, we'll take garbage out of the landfill and instead, turn it into valuable compost.

Five areas across Halton will be participating in the GreenCart demonstration program – two in Burlington, one in rural Milton, one in Halton Hills (Georgetown) and one in Oakville.

Starting the week of September 6, each household in the demonstration area will receive a small Kitchen Catcher to place on either the kitchen counter or under the sink and a larger GreenCart for curbside collection.

Residents are asked to scrape their plates and place other organic material suitable for composting in the Kitchen Catcher and empty these contents into their larger GreenCart as required.

GreenCart material will be picked up each week, on your regular garbage day. The material will be co-collected with the garbage in a special truck equipped with two separated compartments. The organic material will then be sent to the composting facility, All Treat Farms in Arthur, Ontario.

To help ensure the highest quality compost possible, plastics of any kind (including diapers and plastic bags) will not be accepted in the GreenCart program. If you would like more information, please attend one of the Open Houses, visit our website or call Access Halton.



We welcome your feedback. Contact Access Halton at accesshalton@region.halton.on.ca
905-825-6000 • Toll free: 1-866-4HALTON • TTY: 905-827-9833 • www.region.halton.on.ca
Regional Municipality of Halton • 1151 Bronte Rd., Oakville, Ontario L6M 3L1