

DREAM-COME-TRUE HOMES

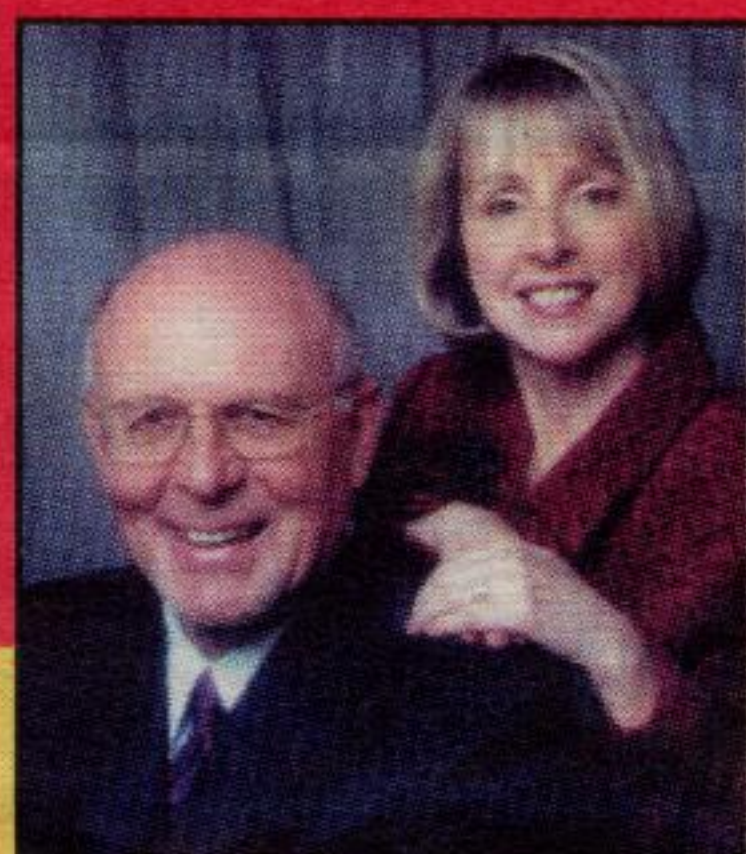

Johnson Associates

HALTON LTD., REALTOR

(905) 877-5165

LYNN and JOHN DREWRY *Sales Reps.

32 Greystone Cr.

\$252,500



21 McKinnon Ave.

\$214,900



**MARKET'S HOT!
CALL TODAY!**

\$177,900



51 Longfield Rd., Acton

\$259,900



291 Maple Ave.



NORINNE KILGOUR Sales Representative



BLUE SPRINGS REALTY
(Halton) CORP.

360 Guelph Street,
Georgetown

905-877-5211 or 1-800-834-5516

RE/MAX
HALL
of
FAME
Member



FABULOUS FAMILY HOME IN ESTATE NEIGHBOURHOOD

This home is on a ravine lot with view over conservation and hills of Erin. Some of the features are 3 fireplaces, 4 bedrooms, 2 storey solarium on back of home leading to pool area from master bedroom and dining room. The back yard which is professionally landscaped with large stones and perennial gardens and shrubs has multi-level decking, pool, hot tub and waterfalls. Just the spot for entertaining. This home has it all! Call Norinne* "for the rest of the story". Listed at \$699,500.

FOR RENT - HILLSBURGH - 4 bedroom home. \$1300/month + utilities. Available June 1st.

THINKING OF SELLING YOUR CASTLE?

ALL MY SERVICES ARE
GUARANTEED IN WRITING
Call Today For A
**COMPARATIVE MARKET
ANALYSIS ON YOUR CASTLE**



TERESA CROOKE
Sales Representative

RE/MAX Blue Springs Realty
(Halton) Corp.

905-877-5211

e-mail: tcrooke@trebnet.com



Virginia Brazeau* R.N.

#1 IN MILTON FOR ROYAL LEPAGE... AGAIN!

TOP 1% IN CANADA... AGAIN



*JOSEPH BRAZEAU, BA

*RUTH KERR, BA, MA

VIRTUAL TOURS: www.Milton-RealEstate.com
EMAIL: VBrazeau@RoyalLePage.ca

ROYAL LEPAGE

905-878-8101

388 MAIN ST. E., MILTON

Royal LePage Real Estate Services Ltd., Broker

FLOWING STREAM THROUGH PROPERTY!
In village setting just mins to 401! Upgraded & well-maintained! Gleaming hrdwd flrs, rplcd windows & carpets, freshly painted. Stream w/foot-bridge & mature trees. Oversized att garage, shed, dog run. \$292,000. Country living yet close to all conveniences!

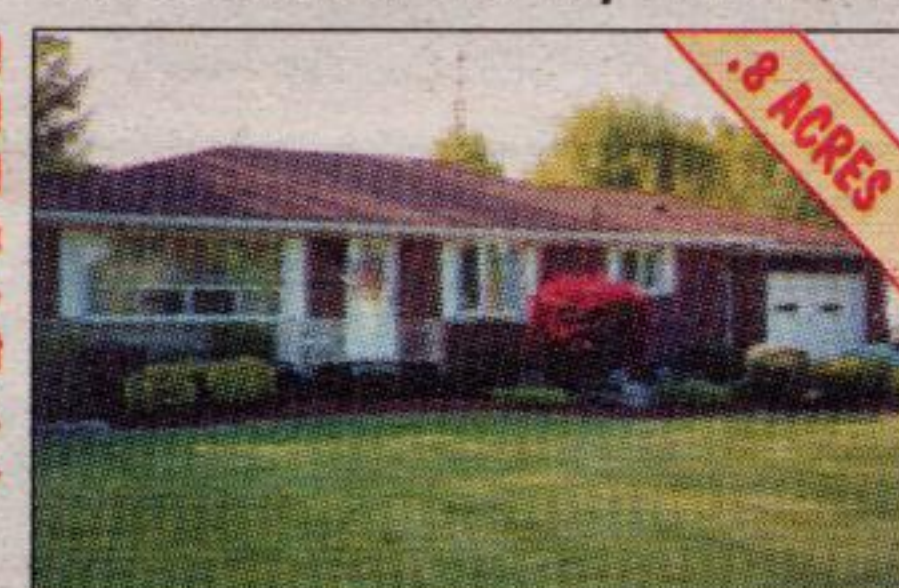

MINUTES TO 401/CAMPBELLVILLE!
Mature trees provide privacy from road/neighbors. Stone 5-bdrm Fr country exec on 2 acres. 2-storey great rm (firepl & Fr drs to patio) opens to kit w/ brkfst rm & expansive din rm. Marble firepl in oak study. Main fir master w/ huge ens & walkout. \$598,000. Virtual Tour! Excellent Value!



4-BEDROOM COUNTRY BUNGALOW
Lovely executive of exceptional quality! Oak flrs, solar-tinted windows, skylits, UV H2O system. Ceramic/oak kit w/ brkfst area & walkout to cov'd deck open to fam rm w/ firepl! Beautifully fin'd lower level w/ bdrm, bath, wdstv. \$429,900. You deserve the luxuries this home offers! Virtual Tour!



YOUR OWN 10-ACRE PARK!
Incredibly well-maintained! 4,000 sq ft (aprx) 4-bdrm w/ wrought-iron entry gates. 4 firepl, 9 skylits, gleaming hrdwd flrs. Master: stone firepl, walkin closet, private balcony, study. Spacious & sunny oak eat-in kit w/ skylits, isld, brkfst bar. \$599,000. 10 mins to 401! Virtual Tour!

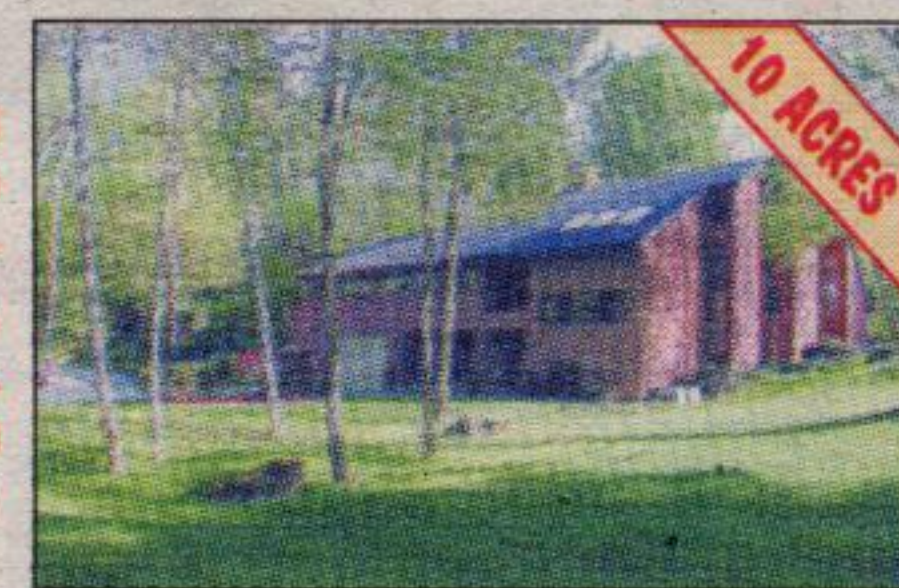

BRICK BUNGALOW & 16 MILE CREEK!
Bi-level 3+1 country home on beautiful lot w/ rocky, mature trees & flowing stream! Family rm w/ gas firepl, sunrm & ground level walkout. Patio drs to wrap-around deck/balcony from LR/DR & kit. Inlaw suite at ground level w/sep entrance. UV H2O system. \$309,000. A rare find just N. of Carlisle, 10 mins to 401/Campbellville.



47 ACRES WAITING FOR YOUR DREAM HOME!
Build on a hilltop for panoramic views, in the woods for privacy, overlooking a peaceful pond & flowing stream or in a tree-lined meadow. It's all here just North of Ballinacraigh w/quick access to 401/Trafalgar. \$299,000. Everything you could ask for in a country property!

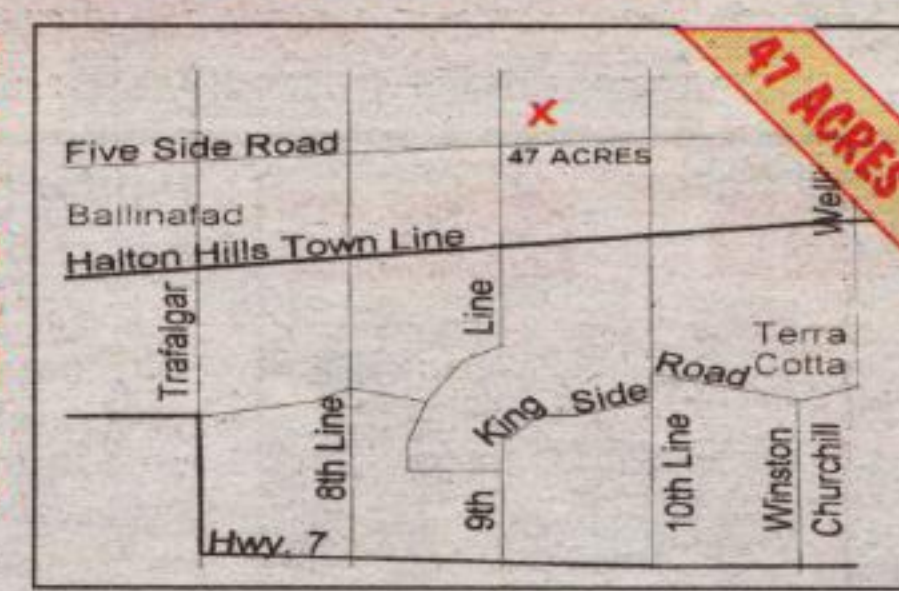

5 ACRES IN PHASE II EXPANSION
of urban Milton East. Reno'd century home w/ some mature trees, pond (not spring-fed). Hrdwd/ceramic flrs. Nanny suite on 3rd flr. 20'x50' wrkshp/garage. \$999,000. Surrounding 96 acres also available. Exceptional investment property!



1 KM N OF 401/GUELPH LINE
Well-built 4-bdrm exec set back from rd. Full in-law suite at ground level w/ sep entrance, patio. Hardwd flrs, hand-crafted woodwork thru out. Ceramic kit w/ gmhs brkfst area open to fam rm w/ wdstv & balcony overlooking landscaped grounds. 40'x60' bank barn w/ heated wrkshp. \$729,000. Incomparable quality & workmanship. Virtual Tour!



20 MINS TO 401/GUELPH LN.
Woods, pastures, ponds, fields! Handsome stone exec at end of long winding lane. Open-concept kit/fam-rm w/brkfst rm, ceramics, 'Barzoffi' cpbds, brick firepl, centre isld, w/o to sun rm & wrap-around deck overlooking pond, 1/2 pool & landscaped grounds. 4 firepl. In-law suite @ gnd level. 10-stall barn. \$1,100,000. A country estate with everything to offer! Virtual Tour!



* SALES REP