

Check out my listings on the web! realtor.com/toronto/kathyellis

Kathy Ellis

Sales Representative

(905) 877-5165

(905) 874-3040

Sales Representative

Johnson Associates
HALTON LTD., REALTOR



FEATURE HOME

Take A Look At This Fabulous Family Home!



Unique & beautiful Victorian home with incredible light and space, providing a delightful atmosphere for the growing family or connoisseurs of century homes. This delightful home is completely updated and has been cared for with complete respect for the era of this home. The kitchen and bathrooms are updated, the solarium is newer and just gorgeous, the four spacious bedrooms are bright with large windows and plentiful closets. Entertain in the large living room, main floor family room and the formal dining room or simply relax in the screened-in verandah and overlook the very large lot and beautiful landscaping with stone retaining walls, Victorian gardens and wonderful privacy. **This is a one of a kind beautifully maintained and decorated home - seldom on the market! Easy commute to the city - walk to "GO". \$384,900.**

History Included At No Extra Charge



BRENDA PAYTON

*Sales Representative

12 YR. MEMBER

877-5165

Call for a Free Complete and Accurate Market Analysis!

Johnson Associates
HALTON LTD., REALTOR

"PERFORMANCE COUNTS"



PRIVACY IN THE ESCARPMENT

3200 sq. ft. residence with double attached garage plus separate oversized workshop/garage. Greenhouse style kitchen with oak cabinetry, 18 ft. ceilings in main floor family room with floor to ceiling stone fireplace, master bedroom on the main level with walkout to cedar deck and hot tub, 3 other large bedrooms all with ensuite baths. A perfect hideaway for the successful executive.



COUNTRY RANCH BUNGALOW

Come look at this 1700 sq. ft. ranch bungalow on approx. 2 acre mature lot. Spacious living/dining rooms with stone fireplace and walkout to fabulous sunroom. Eat-in country style kitchen, three spacious bedrooms plus main floor family room. This is a one owner home and has been immaculately maintained. Easy access to Georgetown or Erin. Priced to sell - \$289,900.

GORGEOUS NEW HOMES

On 3/4 and 1 acre lots, by Rydon Homes. Four bedroom, with three bath plans, featuring hardwood, ceramics and quality broadloom. Tasteful, custom finishes by a master builder. Pictured model, \$359,999. Get details by calling Bill Ellis**.



Call **BILL ELLIS****
Assoc. Broker

Johnson Associates
HALTON LTD., REALTOR

877-5165



Town & Country Specialist



Blue Springs Realty (Halton) Corp.

Loc.: (905) 877-5211 Tor.: (905) 874-3051
1-800-834-5516 Fax: (905) 877-5154

Maureen Plucinsky B.Sc.
Sales Representative

<http://maureen.ca>



NEW

Perfect for socializing

~ 3200 sq ft. Upgraded! 4 bdrm, 4 WRs. Hallmark prof finished bsmt with FP, wet bar, wine cellar & den. Mbdm with FP & sitting area. Greenhouse kit with ceramic floor & walk-out to patio & hot tub. Hardwood flrs. French doors. Covng. Family rm with gas FP & wet bar. Prof landscaped front & rear. Sprinkler & security systems. 200 amp.



Walk to "to be built" leisure centre
Georgetown South

Westminster, 2365 sq ft only 2 yrs old with excellent floor plan. 4 bdrms, 3 washrooms, main floor Family Room with gas fireplace. Many, many upgrades. Ceramics through foyer, hall, 2pc washroom & kitchen. Professionally landscaped for maximum effect & minimum upkeep. Fenced yard. Interlocking brick. Shows to perfection. \$289,500



Dream Garages for 6 cars

Southcott Dr, ~3 min to 401

Milton: Hwy 401 & Trafalgar, South of 5th SR. Open concept with central skylight dome. 9' to 30' ceilings. Huge eat-in kit. Walk-out bright bsmt with high ceilings. 3+2 bdrms. 2 family rms & huge recreation room. 2+2+2 car garage with natural gas. Prof landscaped. Concrete & steel construction. Perfect for home business and/or car collector.

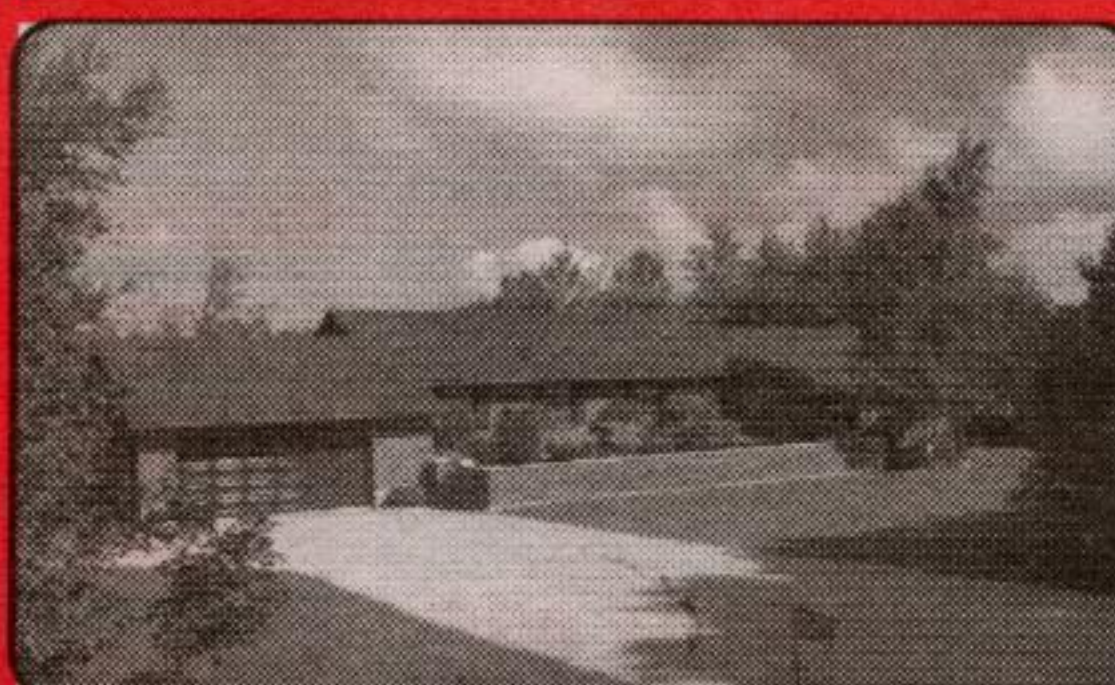

+2700 sq ft SHOP w heat & CAC

North of Rockwood: Fabulous 5.25 ac estate with 2116 x 2 sq ft of living space. Fabulous kitchen with 3/4" maple floor. Family rm with FP & w/o. 3 oak stall horse barn (40' x 24'). 2700 sq ft shop, heated & airconditioned with 2 offices & 2pc washroom. All less than 16 yrs old & built to the highest standards. Trees, stream & 2 ponds with fish! \$459,900



45 Acre HORSE FARM

South of Hwy 9 & West of Orangeville: 3+2 bdrms, 3 washroom accent stone bungalow. Finished basement. Excellent 6+ stall barn (30'x40') with water & hydro, drive shed (34'x40') & run-in shed. All buildings less than 15 years old. Fenced paddocks. 5ac bush. 2 ponds. 15 ac in hay. ~45 mins to Mohawk. \$339,500. Excellent value.



Character Home

65'x 132' manicured lot w water falls, 20'x 20' dog run & child's play house. In-law suite on main level or upstairs. 2 drvwys. Close to GO. \$197,900

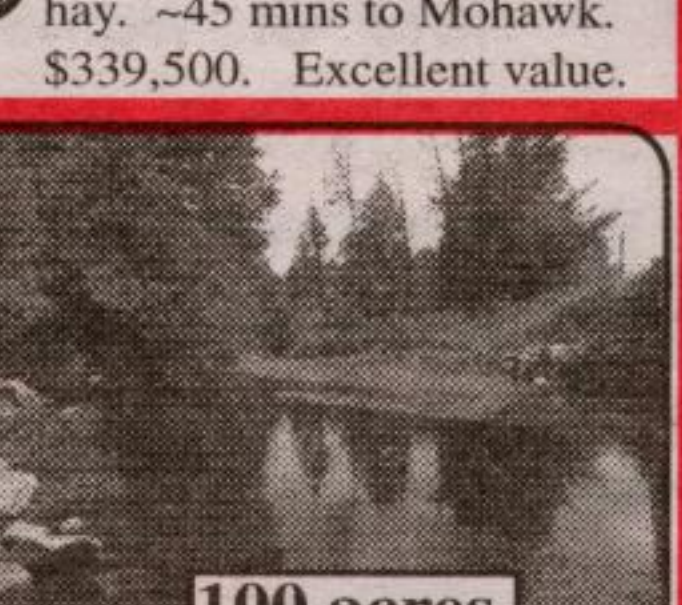

100 acres

Milton: 100 ac. SE corner of 30th SR & 2nd Line. 15 min N of 401. 4200 ft frontage. Creek. 1/2 bush. No railway, hydro towers or traffic. Paved road.



NEW

207445 Hwy 9, Mono: In-law with sep entrance. 4 fireplaces! Pond & stream. 20 acs in hay. Natural gas on Hwy 9. ~100 ac < 5 min to Orangeville & Hospit



NEW

Halton Hills: ~1 acre with 35' x 70' gar + shop w heat & hydro. W of Acton in Crewson's Corner. Backs onto conservation & has a creek. \$259,000.

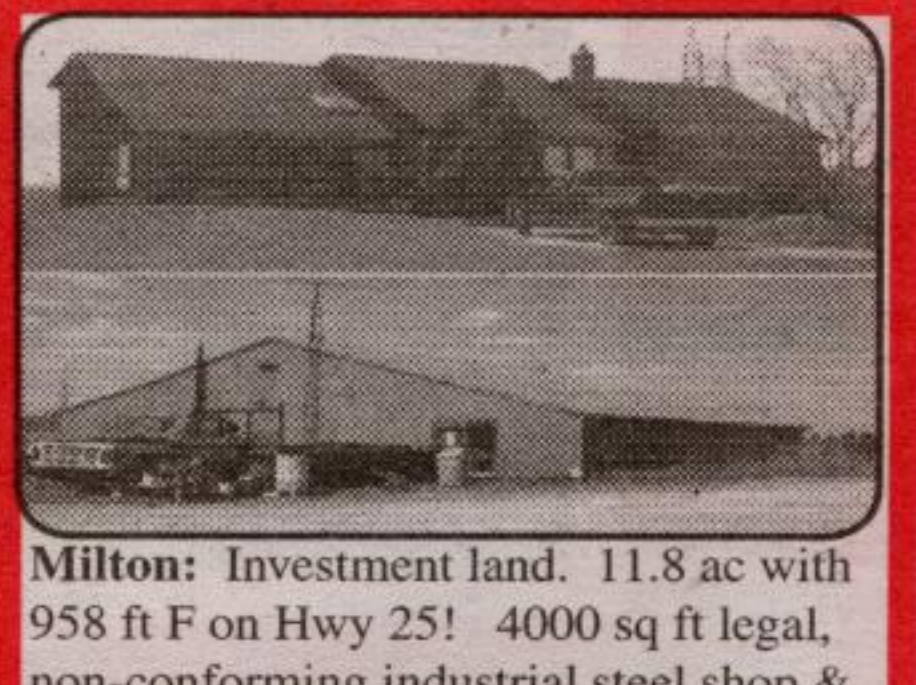

Milton: Investment land. 11.8 ac with 958 ft F on Hwy 25! 4000 sq ft legal, non-conforming industrial steel shop & Viceroy N of Burnhamthorpe. \$1.29M.

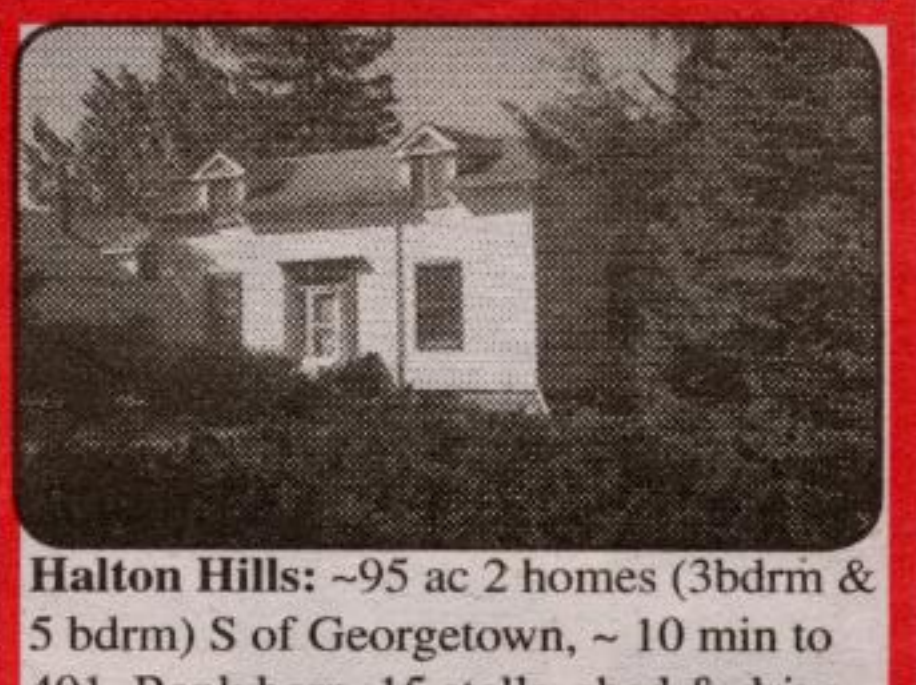

Halton Hills: ~95 ac 2 homes (3bdm & 5 bdrm) S of Georgetown, ~ 10 min to 401. Bank barn, 15 stalls, shed & drive shed. Excel well. Pond. 10730-6th L



NEW

Brampton: 4yrs old. 3 bdrms, 3 WR & fin bsmt. DR with picture window o/l trees. Kit walk-out to the patio. MBR with 4pc. Near Hwy 10 & 407. \$186,900



Georgous 8 ac building lot. Suitable for an estate home or hobby farm. Located < 15 min to Hwy #401 at Guelph Line. 512' frontage. \$249,900



Milton: 2 acre building lot Located in vicinity of the Blue Springs Creek. Plenty of good water. ~12min to 401 at Guelph Line. Quiet road. \$109,900



HIGHLY RECOMMENDED

- 40 ft. lot - fenced rear yard • 2 car garage - double driveway • 3 spacious bedrooms - office/study area • eat-in kitchen - walkout to yard • main floor family room - gas fireplace • Gleaming hardwood - ceramics - upgraded broadloom • Asking \$264,900.

Call Carol* for your personal tour. You won't be disappointed.

A proud supporter of



CAROL WOOD* *Sales Rep.

877-5211
carolwood@remax.net



BLUE SPRINGS REALTY (Halton) Corp.

