



Kathy Ellis

LIFETIME MEMBER



(905) 877-5165



* Sales Representative



Johnson Associates

HALTON LTD., REALTOR

Toronto: (905) 874-3040 Erin: (519) 833-9714

PERFORMANCE COUNTS

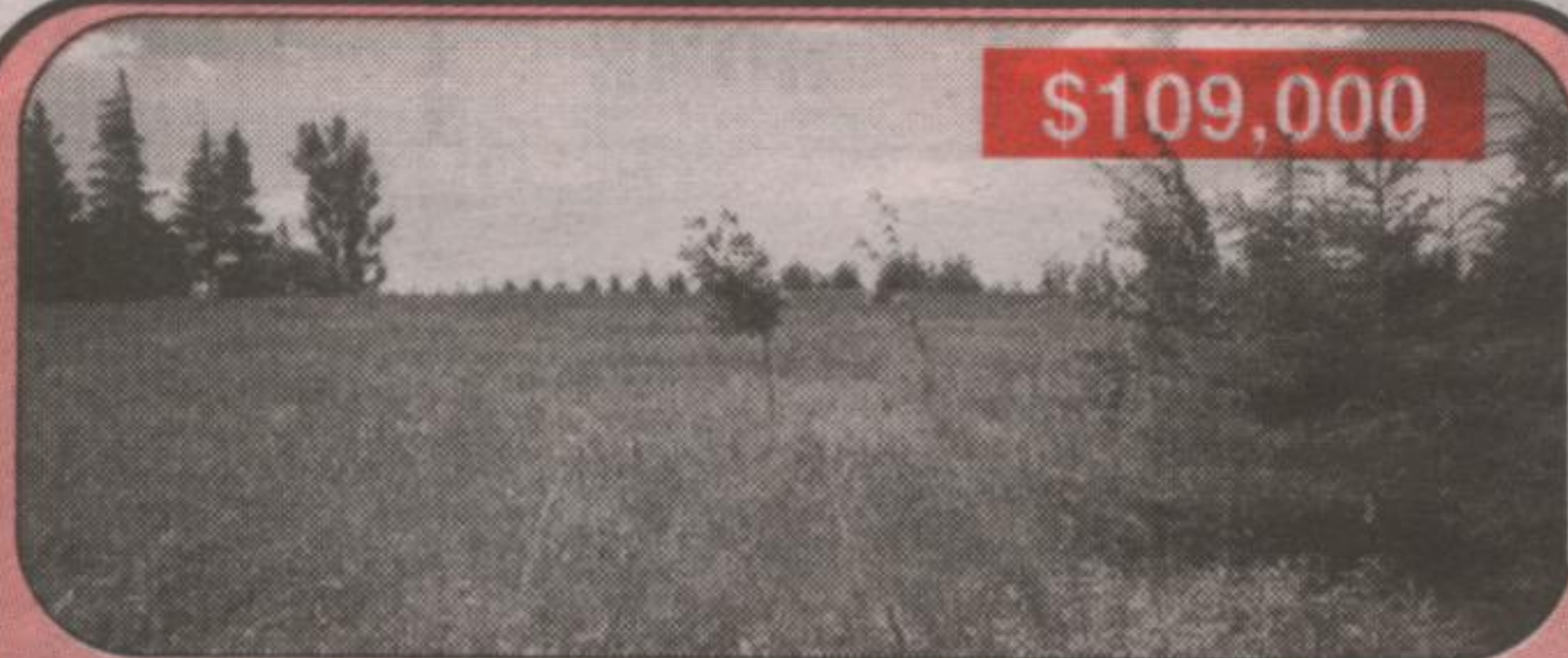

\$109,000

PRETTY 2 ACRE LOT

Treed and elevated offering very nice views of the hills of Erin. Lot levies have been paid. Just reduced!!!

Your key to real estate service!

FEATURE HOME

SPECTACULAR TRIBUTE HOME



It will take your breath away!! This home has been professionally decorated and with the stunning floor plan and huge ravine lot offers the best Georgetown South can offer. 3800 square feet of gorgeous living space plus a walkout basement!! Spacious and dramatic rooms, minimum of 9 ft. ceilings, incredible family room with 18 foot ceilings, huge gas fireplace and views of the 220 foot deep beautifully landscaped rear yard. The wildlife will entertain you! The four bedrooms all have ensuites, two have cathedral ceilings, and the master bedroom has extra large gas fireplace, walkin closet and lovely 5 piece washroom. Call today for your showing you may not see another Georgetown home on a lot like this again!! \$499,000.



THIS HOME IS IDEAL...

FOR A GROWING FAMILY OR EMPTY NESTERS
2190 sq. ft. of bright and open living space. Lovely large principal rooms, great spacious kitchen with center island. Family room beautifully located with gas fireplace and oak mantle. This home is situated on a huge fenced pie shaped lot. This is definitely a deal and Vendors are motivated. \$278,900.

OPEN HOUSE

Sunday, Feb. 4th 1-3 p.m.



72 HARLEY AVE.
Argyll east of Mountainview
EXCELLENT 3 BEDROOM RAISED BUNGALOW...

Situated in Georgetown South on large fenced yard. This home is ideal for singles, empty nesters and small families. Teenagers will love the finished basement with two bedrooms and full washroom. Basement is extremely bright. Main floor has open floor plan with Bleached Oak kitchen with breakfast area. Master bedroom is spacious with walkin closet. There is also a great newer deck. Priced to sell \$224,900.

HURRY! WE SOLD 5 LOTS IN 5 DAYS

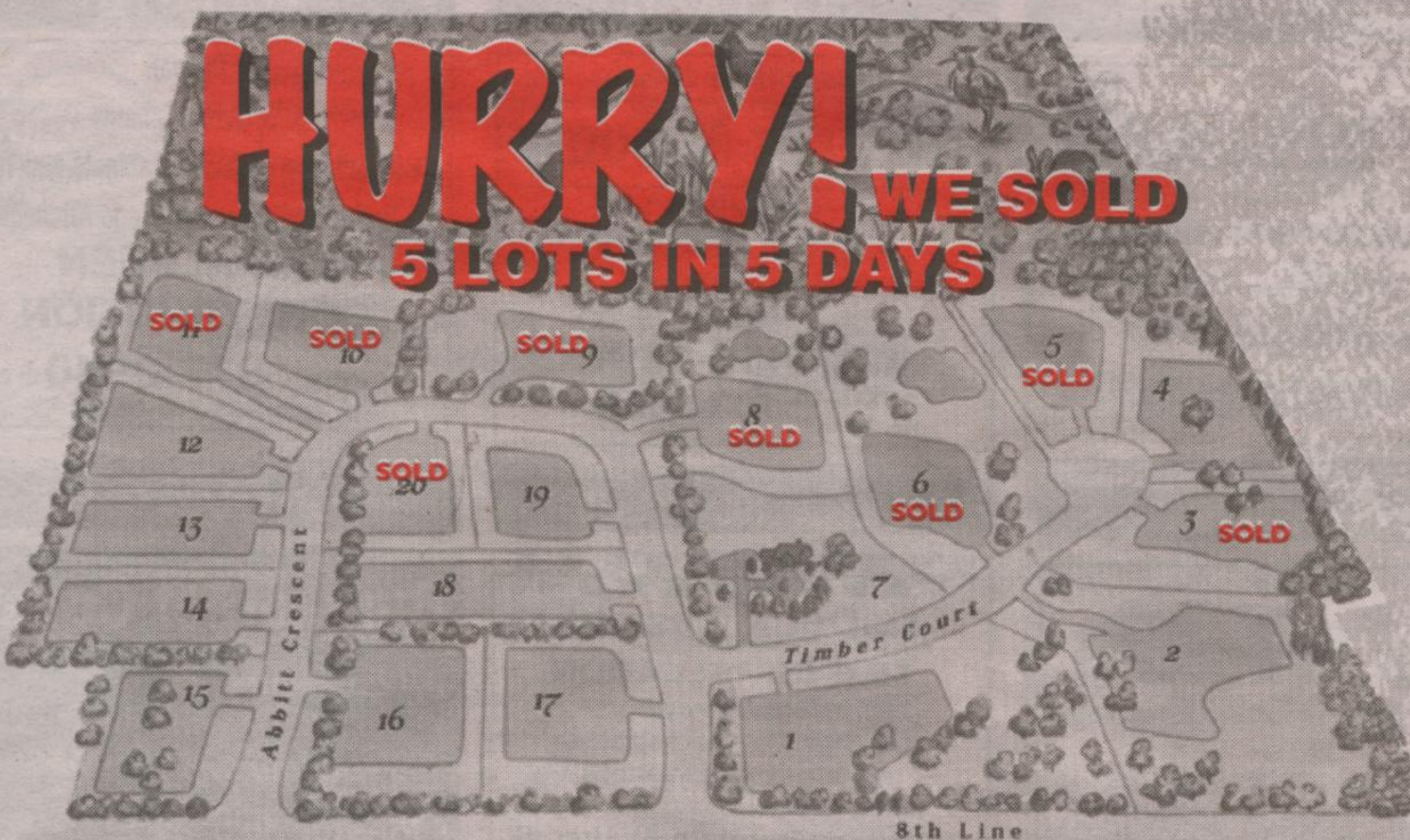

Beech Brooke Country Estates

Presented by: **Kathy Ellis**

Beautiful Country Estate in Halton Hills. 19 18 17 16 15 14 13 12 11 Lots for Sale

SPECTACULAR ESTATE LOTS IN HALTON HILLS
You will not see another development like this one again!

- These lots are priced from \$159,000., they range in size from 1.5 acres to 4 acres
- Property owners receive a 1/20th share in the Conservation Park on the property
- The Wells have been drilled and there is plentiful-potable water • Buy your lot today so that you can build tomorrow

Call me - let me give you a guided tour - I know what each lot has to offer or ask for our color brochure. Come and visit the site.

Trafalgar Road North to 27th Sideroad, East to 8th Line & North to Estates