



Y SHUTDOWN: Parents of children like these, seen playing with the dinosaur masks they made at the Acton Y Junior Day Care will have to find new care of the kids because the Y of Greater Toronto is cancelling pre-school programming in Acton as of June 15. —Submitted photo

Y cancels program...

Continued from Page 1

...centre in Milton or Georgetown for a private licensed daycare.

"There are not 22 spaces in Acton at private home licenced daycare's to pick up the slack, so I want the Y of Greater Toronto to give the Acton pre-school program a stay of execution until we get something else running," Pacheco said, adding the Y day care has been a huge vital part of the community, which is about to grow by more than 400 homes.

Acton Y director Margaret Hynds said Y officials, who will rent just one, not five rooms from the school for its programs beginning in September, have not been able to find another suit-

able location in Acton for the program.

While enrollment is at its lowest since the school board instituted Junior Kindergarten in September, Hynds said the Y's greatest competitor is unlicensed private home daycare providers.

Hynds says she hopes the three full-time and three part-time staff will be offered jobs by

the Y in another centre.

The Acton Y will offer its usual before-and-after summer camp program and a full-day summer club for six-to-nine year-olds in July and August.

At press time, The New Tanner was unable to reach a YMCA of Greater Toronto official to comment on the programing cut in Acton.

More motor suds

If you missed that car wash or your car is dirty again — pull into the parking lot beside Trinity United Church this Saturday (May 25) for another car wash — this one to help raise money to keep Off The Wall, Acton's youth centre, open until the end of June.

Organized by the "Keeping Our Youth Doors Open Committee," the \$5 car wash runs from 11 a.m. to 4 p.m.

Illegal grow operation

Halton Regional Police shut down a Georgetown marijuana grow operation at a house on Trafalgar Road, next to an elementary school, on Friday, May 17. The assistance of Halton Hills Animal control was required as officers removed two Pit Bull guard dogs.

A hydroponics growing operation was located inside the house and officers seized 293 marijuana plants with a potential street value estimated at \$293,000 and growing equipment. A loaded .22 calibre rifle was also seized.

Charged are two Georgetown men, 25 and 20 years of age.

Police are encouraging the public to report suspicions of illegal grow operations, which are found in all areas of Halton.

Family makes your house a home.

Protect them both with the life insurance plan that's right for you.

You've built a home for the safety and security of your family. Now protect them both with the life insurance plan that's right for you. A Clarica advisor can make sense out of almost anything... especially your mortgage insurance.



Jackie (McMullen) Vielma
Branch office: (905) 276-7140, local: (519) 853-8911
Cell: (905) 691-8392, fax: (905) 276-5531
4 Robert Speck Parkway, Suite 1200
Mississauga, ON LaZ 1S1
jacqueline.vielma@clarica.com



Investment and insurance solutions - Since 1870

Registered trademark of Clarica Life Insurance Company. Representing Clarica Life Insurance Company and Clarica Investco Inc.

ASBUILT CLIMATECARE

- Heating
- Air Conditioning
- Fire Places
- In Floor Heating
- Sheet Metal
- Design/Permit Packages

877-8023

APL ACTON PRECAST CONCRETE LTD.
Quality Concrete Products since 1963

- SEPTIC TANKS & WATER CISTERNS
- PVC SEWER PIPE
- WELL TILES & CULVERTS
- TRANSFORMER BASES
- STEPS & PORCHES
- YARD & PATIO PRODUCTS

519 853-1529

BEATON ROOFING

FREE ESTIMATES • Residential with Written Guarantee

- Commercial
- Industrial • AGR
- Air Conditioner
- Curb Installations
- Tar & Gravel
- Shingles
- Steel Roofing

serving: Wellington County & Halton Hills
(519) 856-9784

"Home of the Week" ~ Your Building Experts

BASEMENT-ENTRY PLAN

Three bedrooms and an expansive open living area make this design the ideal family home. The stairs to the second level lead directly into the expansive family area.

Two-storey stone pillars and an exposed open truss over the front deck add character to the exterior. The covered entrance is highlighted by the dramatic sweep of semi-circular steps to the front door, leading to a good-sized foyer, which includes a bench and a coat cupboard. On the right, an irregular-shaped den is fitted with a desk, which will be useful for homework, or any paper work, or could be the place for the family's computer. Behind the den is the laundry room and beyond that, an unfinished basement area which includes roughed-in plumbing for a bathroom.



The great room is at the front of the house and includes a gas fireplace that may also be enjoyed from all other areas of the space.

A door off the great room opens to the front deck, which also has access from the master suite. The dining room includes an optional buffet and is immediately adjacent to the large kitchen.

The house is 43 feet, 8 inches wide and 43 feet, 4 inches deep with 1,299 square feet of finished living space.

Plans for design H-2-3-703 are available for \$366 (set of 5), \$432 (set of 8) and \$474 for a super set of 10. B.C. residents add 7.5% Prov. Sales Tax. Also add \$30.00 for Priority courier charges. Please add 7% G.S.T. or 15% H.S.T. (where applicable) to both the plan price and postage charges.

Our NEW 34th Edition of the Home Plan Catalogue containing over 300 plans is available for \$11.50 (includes taxes, postage and handling). Make all cheques and money orders payable to "Home Plan of the Week" and mail to: HOME PLAN OF THE WEEK c/o...The New Tanner, 336 Columbia Street, New Westminster, B.C. V3L 1A6 CALL 1 800-527-5267 OR SEE OUR WEB PAGE ORDER FORM ON: <http://www.jenish.com> AND E-MAIL YOUR ORDER TO: homeplans@jenish.com

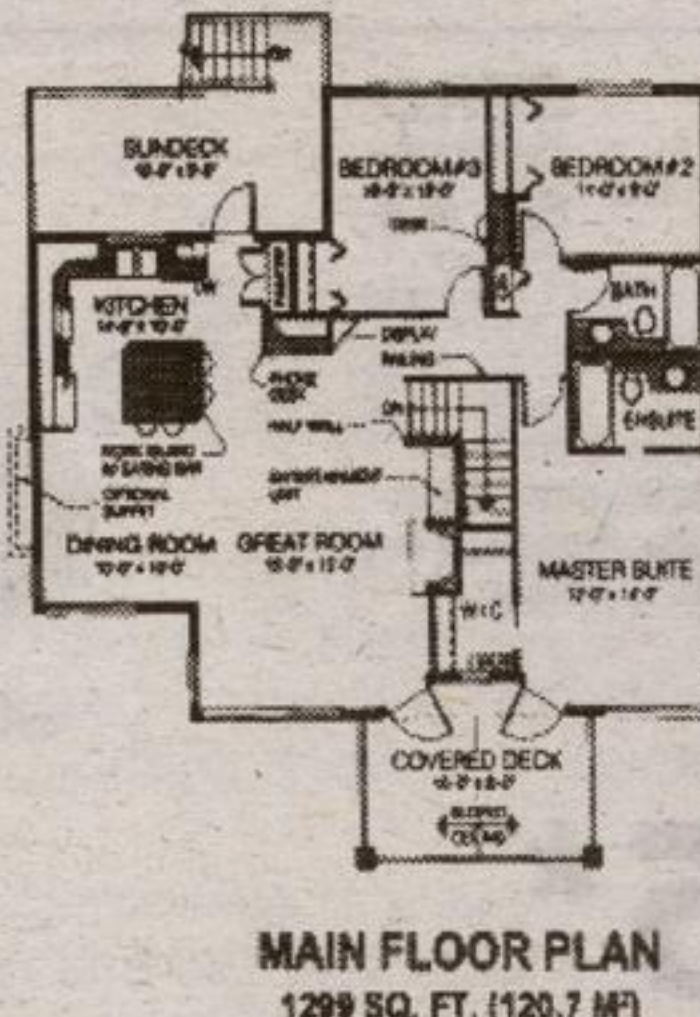
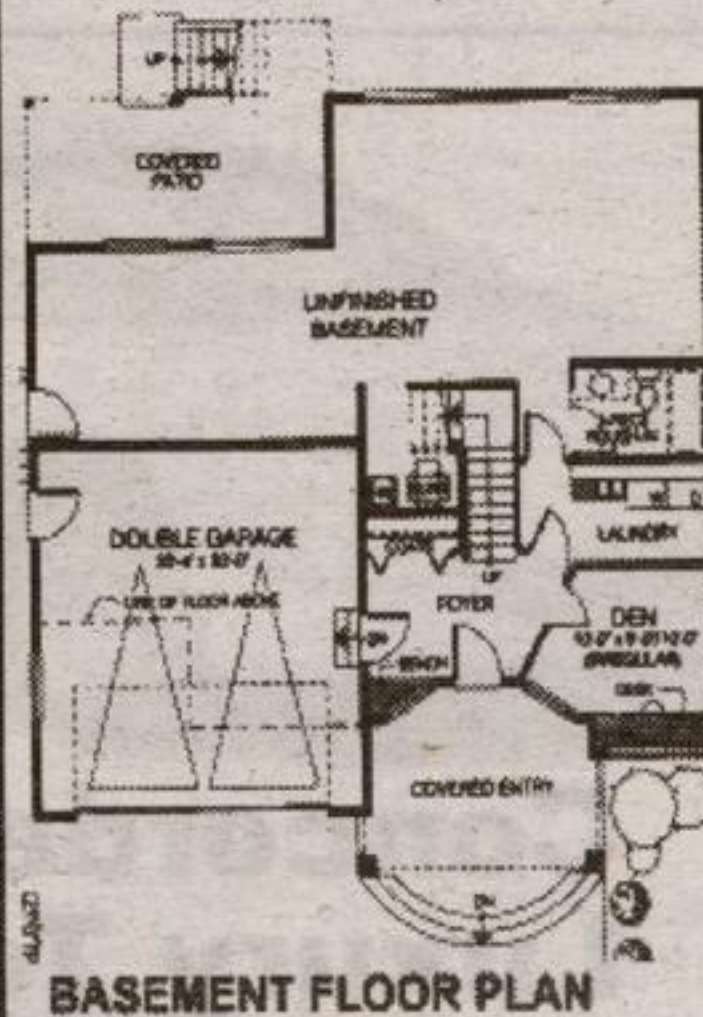

WIDTH - 43'-8" (13.3M)
DEPTH - 43'-4" (13.2M)
PLAN NO. H-2-3-703
TOTAL 1299 SQ. FT. (120.7 MF)

Elmira Farm Service

Annual OSPRINGE Open House

Saturday, May 25th ~ 9 am-4 pm

- Residential
- Commercial

FREE Draws

Demonstrations

BBQ

Ride & Drive Area

Junction of Hwy 24 & Hwy 25, Ospringe
(519) 833-9332 1-800-685-3835



R & R Company

Garage Doors
Electric Openers
Windows, Entrance Doors,
Storm Doors, Patio Doors

SALES, SERVICE & INSTALLATION

519-853-2114

Leathertown LUMBER

264 Main St. N., Acton
"We have everything you need to do the job right."

- Treated Lumber
- Plywood
- Trim
- Mill Work
- Plumbing
- Electrical
- Hardware
- Windows
- Doors
- Drywall, etc.

HOURS: Mon-Fri 7-6 Sat 8-4 **SIGO** paints **853-1970**

WEST YORK PAVING LTD.

Specialists in driveways, rural laneways, barnyards and parking lots
We Pave the Way to Quality

Established 1967

Special Senior Discounts

Call Sebastian

Toll Free: 1-800-317-9558

Paving Professionals