

Meeting of October 3, 2001

Dental Award

Regional Council congratulated Ellen Duncan-Ross, a dental educator with Halton's Health Department, on her receipt of the 'National Practitioner Award' from the Canadian Dental Assistants' Association. Ms. Duncan-Ross received the award for her work in producing teach-

ing resources, including an Alzheimer manual for dental health professionals. Nominated by the Ontario Dental Nurses and Assistants Association. Ms. Duncan-Ross is widely recognized by her peers for her dedication and expertise in the area of oral health services for the frail, elderly, and adults with special needs in Halton.



Halton Region Council HIGHLIGHTS

Municipal Award

Council recognized staff of the Halton Planning & Public

Works Department for their efforts which resulted in the achievement of a Peter J. Marshall Municipal Innovation Award Certificate of Merit. The award was given for Halton's Wastewater Treatment Facility Optimization Project, the first of its kind in Canada. The project involved the retrofitting of key elements of the Burlington Skyway Wastewater Treatment Plant resulting in the deferral of the need for immediate capital upgrades and an increase in the environmental quality of effluent discharged from the plant.

Salvation Army which will provide a trailer on the site for Halton residents to donate reusable items. Based on historical data. Staff estimate that a minimum of 200 tonnes per year of waste can be diverted from Halton's landfill site through this pilot project. The Salvation Army advised that it will use the Halton model as a benchmark for forming other municipal partnerships across Canada.

Corridor Project

Regional Council directed Regional staff, in coordination with area municipal staff, to prepare communication from the Regional Chairman and the four mayors to the Premier of Ontario and the Minister of Transportation requesting the direct involve-

ment of Halton and area Municipal staff in preparation of Terms of Reference for the Environmental Assessment Study for the proposed Niagara Mid-Peninsula Corridor Highway. The terms of reference will develop a scope for the highway project and provide details on what must be included in the environmental assessment.

Provincial Policy Statement Five Year Review

Regional Council received a report on staff's initial comments on the Ministry of Municipal Affairs and Housing's Provincial Policy Statement (PPS) Five Year Review. Under the Planning Act, the Ministry is undertaking a review of the PPS to ensure the land use planning policies effectively protect provincial interests and are consistent with the Ontario government's "Smart Growth" initiative. Council was advised that staff have identified concerns related to defining the Provincial role in planning, balancing economic, environmental and social policies, and defining priorities among Provincial land use interests.

Partnership with Salvation Army

Regional Council approved a one-year pilot project with the Salvation Army which will result in the diversion of materials from the Halton Waste Management Site and redirect household items for reuse within the community. Under the arrangement, Halton will provide the site location and services at the Halton Waste Management Site and will waive tipping fees for the residue materials from the Salvation Army Recycling Centre in Oakville. Cost of operating the depot will be borne by the

BRANCH No. 197 **LEGION NEWS**
By Joyce Buchanan Secretary

Hi again;

Well, Hallowe'en is fast approaching, and so is the Newfie Night, Oct. 27, with the Bay Boys. Don't forget. Plan on coming down and join the fun.

The tickets for the Veterans' Dinner are now available for Nov. 10. The tickets are free for veterans, so please come in and sign for your ticket so we have a firm number to cook for; also plan on attending the Service at the Branch at 12:30pm before Dinner is served at 1:15pm.

Those who canvas for the Poppies: Blitz Night is Nov. 2. Get in touch with Frank Spielvogel (853-1024) if you can help with the canvas.

OK, now Christmas is coming and like Santa we are making our lists and checking them twice. We would like you to check the boards at the Branch with the children's names and ages on and make sure they are correct and also make sure that your dues are paid-up. This will make the job for Rhona and Jim Thornhill much easier, and eventually, Santa.

Did I miss Indian Summer? I'm hoping the weather soon clears, I want to get my leaves gathered; the wind doesn't seem to be moving them over to my neighbours.

Don't forget our members who are ill. Come on down and join the people for Bridge and Euchre during the week.

See you at the Branch.

THE NEW TANNER
Hometown news people read

BOYES PLUMBING
Water Softener Rentals Water Pump Service
855-4232

FIT TO BE TRIED
Personal Fitness Training
Learn to Exercise In the convenience of your own home with a certified trainer
Makes a Unique Christmas Gift
M. IUTZI ROCKWOOD (519) 831 3221

FALL CLEARANCE SALE
All Carpet Sales Installed We supply the pad free.
Carpet remnants up to 30 feet. Special price plus free pad!
Laminate Flooring from \$1.29 sq. ft. Free underlay with installation.
BEST PRICE ON HARDWOOD Select & Better **\$4.69 sq. ft.**
Carpet & Hardwood Outlet
128 Guelph St, Georgetown • 702-1217
OPEN 7 DAYS A WEEK: Mon-Fri 9am-8pm • Sat 9am-5pm • Sun 12 noon-4pm

ACTON PRECAST CONCRETE LTD.
Quality Concrete Products since 1963
SEPTIC TANKS & WATER CISTERNS
PVC SEWER PIPE
WELL TILES & CULVERTS
TRANSFORMER BASES
STEPS & PORCHES
YARD & PATIO PRODUCTS
519 853-1529

BEATON ROOFING
FREE ESTIMATES with Written Guarantee
Residential Commercial Industrial • AGR
Air Conditioner Curb Installations
Tar & Gravel Shingles Steel Roofing
serving: Wellington County & Halton Hills
(519) 856-9784

ASBUILT CLIMATECARE
Heating Air Conditioning Fire Places In Floor Heating Sheet Metal Design/Permit Packages
877-8023

"Home of the Week" ~ Your Building Experts



Four-Bedroom Family Home

Designed to take advantage of a sloping lot with a rear view, this four-bedroom home contains all the space and features to appeal to a family.

The den immediately off the foyer is in the right place to serve as a home office, if desired, or could be the computer/study room to be used by parents and children. A two-way fireplace, built-in bookshelves and a 9 1/2-foot ceiling lift this room right out of the ordinary.

The long living room and dining room are both enhanced by nine-foot ceilings and the see-through fireplace that is shared with the den.

A buffet niche has been added to the dining room and french doors open on to an oversized sun deck that is sure to be well-used during the warmer months. This is where dinner guests could be entertained before dinner, and is also likely to be the favourite spot for family barbecues.

The expansive family room has a gas fireplace and the breakfast nook, with a sloping ceiling, is set into a bay with access to the sun deck.

The kitchen is designed with the utmost efficiency and includes a spacious work island and a walk-in pantry.

A powder room, laundry and coat cupboard are located off the central hallway.

Upstairs, the master suite at the rear of the house enjoys a view of the back garden and has a charming nook with a clerestory window. The five-piece en suite bathroom also has

extra window interest with a box window above the soaker tub. A walk-in closet completes the master suite.

Three secondary bedrooms are all a good size and share a three-piece bathroom. Bedroom No. 3 has a sloping ceiling and a circle-top window.

The double-door garage has a side door and entrance into the house through the laundry room. Extra storage space is provided at the rear of the garage.

The house is 38 feet, 8 inches wide and 52 feet, 4 inches deep with 2,181 square feet of living space and an unfinished basement.

Plans for design H7-4-816 are available for \$494 (set of 5), \$579 (set of 8), and \$633 for a super set of 10. B.C. residents add seven per cent Prov. Sales Tax. Also add \$15.00 for Priority courier charges within B.C. or \$25.00 outside of B.C. Please add 7% G.S.T. or 15% H.S.T. (where applicable) to both the plan price and postage charges.

Our NEW 33rd Edition of the Home Plan Catalogue containing over 300 plans is available for \$11.50 (includes taxes, postage, and handling). Make all cheques and money orders payable to "Home Plan of the Week" and mail to: Home of the week, c/o The New Tanner, 336 Columbia Street, New Westminster, B.C. V3L 1A6 or see our web page order form on: <http://www.jenish.com> and e-mail your order to: homeplans@jenish.com

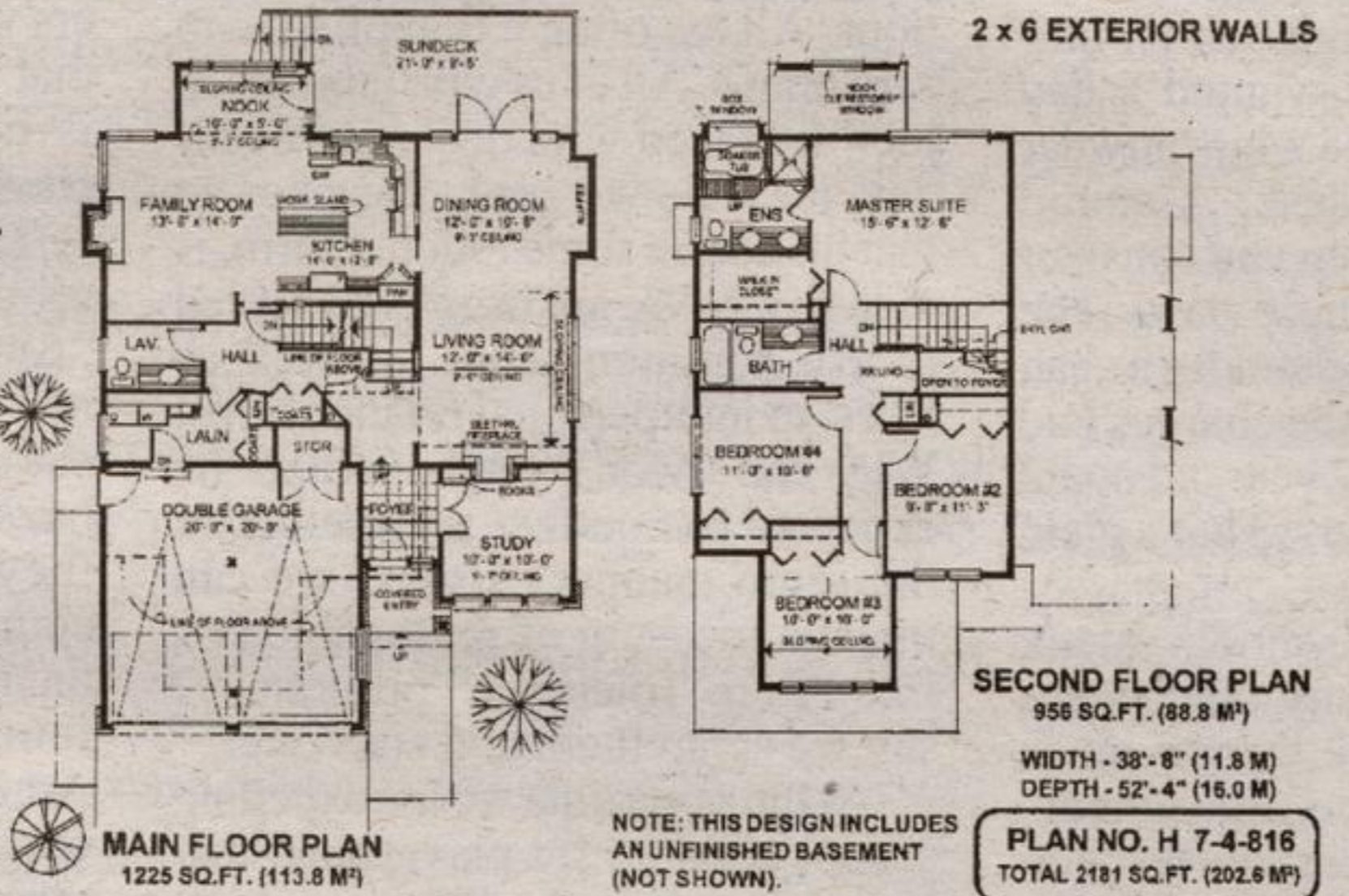

Lakeview FLOORING & KITCHENS
Home Design Centre
Paints • Wallpaper Carpet • Vinyl • Ceramic Tile
Hardwood Flooring Windows Blinds
Full Kitchen & Bath Renovations
VISIT OUR SHOWROOM
130 Mill St. E., Acton
853-4577
853-1190
Financing available O.A.C.

Leathertown LUMBER
264 Main St. N., Acton
"We have everything you need to do the job right."
Treated Lumber Plywood Trim Mill Work
Plumbing Electrical Hardware Windows Doors Drywall, etc.
HOURS: Mon-Fri 7-6 Sat 8-4
853-1970

ADVANCED 2000 WATER EXPERTS LTD.
Customized Machines For Problem Well Applications
Water Softeners Purifiers ~ Reverse Osmosis Distillers • Iron Filters Organic Filters • Ultraviolet
Purchase ~ Lease-To-Own
Healthy water is our future "Trust The Experts"
Call Janis or Roland Holley
853-4947

G & S EXCAVATING LTD.
Snow Plowing & Removal Licensed Septic Systems Sand & Gravel Topsoil Ponds Basements Dug
R.R.#2 Acton **853-2515**

Phillips Plumbing
Guaranteed Lowest Rates Complete Bathroom Renovations Emergency Drain Service Highest Quality Workmanship
Free Estimates
905-632-1074 or 905-630-7060 cell.

R & R Company
Garage Doors Electric Openers Windows, Entrance Doors, Storm Doors, Patio Doors
SALES, SERVICE & INSTALLATION
519-853-2114