



Adam Ahearn



Rebecca Austin



Darya Barbir



Maya Barbir

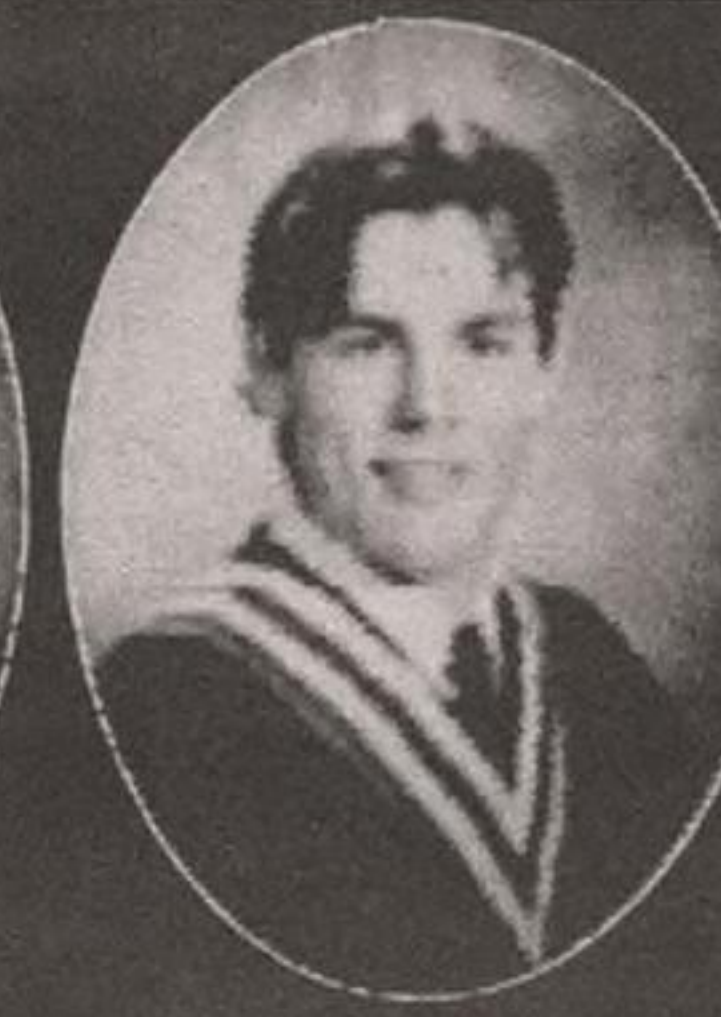

Sandy Chapman



Christina Cooper



Marianne Craig

# One quarter Acton grads earn Honours

By FRANCES NIBLOCK  
The New Tanner

Almost one-quarter of this year's graduating class at Acton High School is graduating with honours—marks above 80 per cent.

Fifteen of the 92 grads have been named Ontario

Scholars by the province, signifying they achieved marks of at least 80 per cent in six OAC courses, and seven students are Ontario Secondary School Diploma honour graduates.

"It's great to see so many students graduating with honours. Twenty-two stu-

dents graduating with honours is a good number in a small graduating group," said Acton vice-principal Caroline Conn-Smith on Friday, adding most of the honours students have at least one characteristic in common.

"I would have to say, that for the majority, they would

be kids that are very well-rounded children, involved in many areas of the school. Academics are not their only strength," Conn-Smith said, adding "they, and all of the graduates, are our future."

The honours graduates are among those who will receive awards at the Acton

High School Commencement tomorrow (Friday).

Ontario Scholars: Adam Ahearn, Rebecca Austin, Darya Barbir, Maya Barbir, Sandy Chapman, Christina Cooper, Marianne Craig, Nicola Garwood, James Mashinter, Graham McClure, Stephanie McKay, Tracy McLaughlin, Vanessa Poltrock, Jennifer Schultz, Jennifer Vanderstarren.

McLaughlin, Vanessa Poltrock, Jennifer Schultz and Jennifer Vanderstarren.

OSSD Graduates—with honours: JP du Toit, Michael Fowler, Tara Goulding, Paige Killick, David Metcalfe, Justin Patenaude and Rachel Wooldridge.



Nicola Garwood



James Mashinter



Graham McClure



Stephanie McKay



Tracy McLaughlin



Vanessa Poltrock



Jennifer Schultz



Jennifer Vanderstarren

**ASBUILT CLIMATECARE**

- Heating
- Air Conditioning
- Fire Places
- In Floor Heating
- Sheet Metal
- Design/Permit Packages

**877-8023**

**APL ACTON PRECAST CONCRETE LTD.**  
Quality Concrete Products Since 1963

- SEPTIC TANKS & WATER CISTERNS
- PVC SEWER PIPE
- WELL TILES & CULVERTS
- TRANSFORMER BASES
- STEPS & PORCHES
- YARD & PATIO PRODUCTS

519 853-1529

**BEATON ROOFING**

- Residential
- Commercial
- Industrial • AGR
- Air Conditioner Curb Installations
- Tar & Gravel
- Shingles
- Steel Roofing

FREE ESTIMATES with Written Guarantee

serving: Wellington County & Halton Hills  
**(519) 856-9784**

Raze the roof on your house building or home improvement business!!

Advertise in this spot.  
**Call Marie at 853-0051**

**G & S EXCAVATING LTD.**

Snow Plowing & Removal  
Licensed Septic Systems  
Sand & Gravel  
Topsoil  
Ponds  
Basements/Foundations

**FREE ESTIMATES**  
R.R.#2 Acton **853-2515**

**SCOTT'S OAK & PINE FURNITURE**

- ◆ Oak & Pine Tables & Chairs
- ◆ Bedroom Suites
- ◆ Entertainment Centres
- ◆ Bookcases and Desks
- ◆ Quality Coil & Foam Mattresses
- ◆ Gifts & Accessories

Specializing in Solid Wood  
- Locally Hand Crafted Furniture  
197 Main St. S, Rockwood  
**856-2537**  
\*LOCATED ON HWY#7 BETWEEN GUELPH & ACTON\*

## "Home of the Week"

## YOUR BUILDING EXPERTS

### Open plan living



An open living plan, with an expansive great room and more than 1,200 sq ft of floor space, gives this straight-entry home plenty of modern-day appeal. The plan includes an unfinished basement for future expansion, and is sure to be particularly appealing to first-time buyers.

Inside the entrance a planter ledge and a display stand add an interesting feature to the foyer.

The main living area, within the great room includes a freestanding work island, offering additional meal-preparation space and also a raised bar for casual snacks and quick coffees.

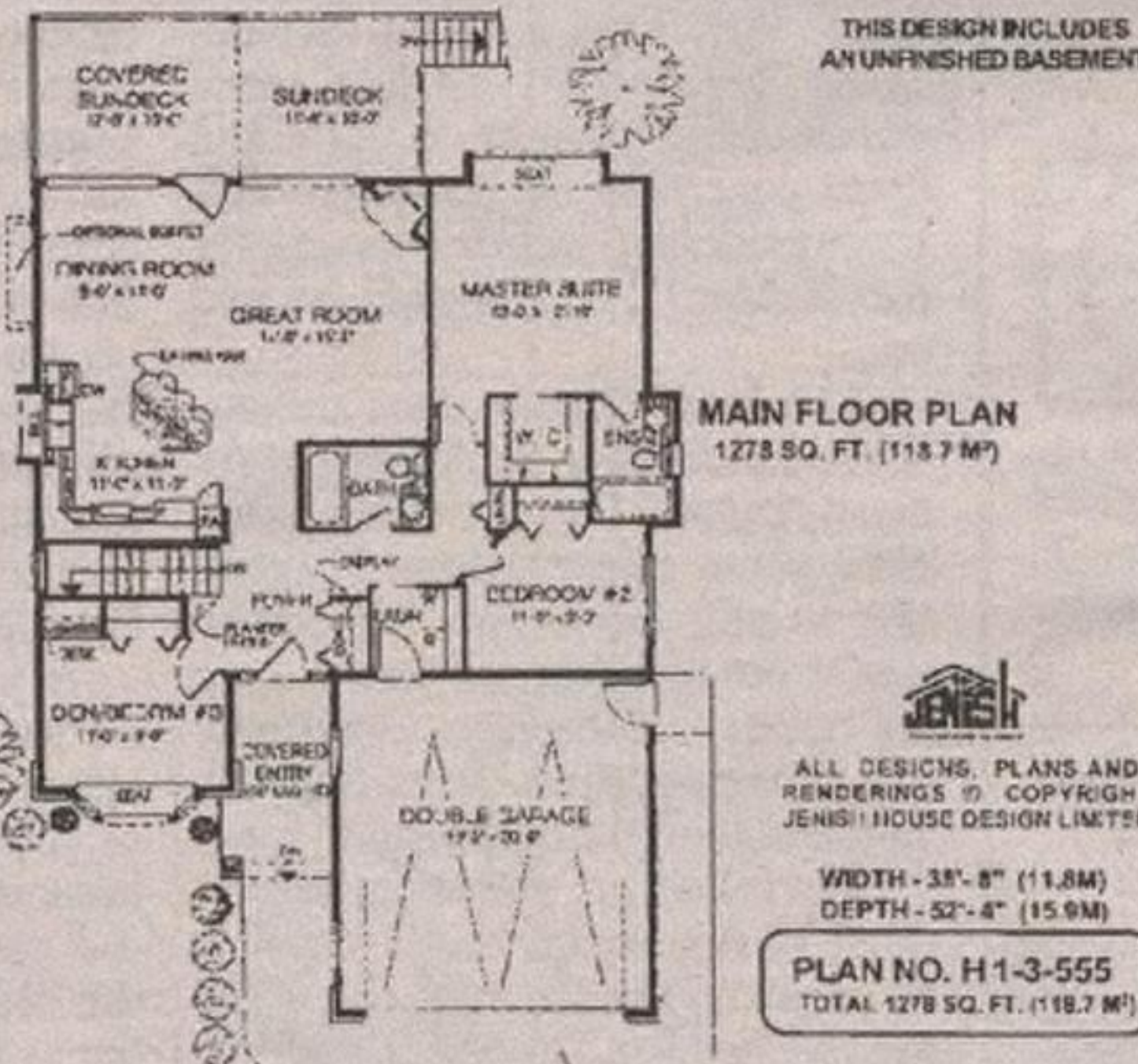

THIS DESIGN INCLUDES AN UNFINISHED BASEMENT

ALL DESIGNS, PLANS AND RENDERINGS © COPYRIGHT JENISH HOUSE DESIGN LIMITED

WIDTH - 38'-8" (11.8M)  
DEPTH - 52'-8" (15.9M)  
PLAN NO. H1-3-555  
TOTAL 1278 SQ. FT. (118.7 M<sup>2</sup>)

The dining area has an option for an inverted buffet stand. A door provides access to the covered portion of the sun deck.

The spacious living/family area has a corner fireplace giving the room a cosy feel during the colder months.

The master bedroom has a window seat that adds character to the room and provides a cosy space to enjoy a relaxing read. A walk-in closet and three-piece en suite bathroom complete the suite.

Bedroom No. 3 has an attractive bay window and is designed with a built-in desk for an easy conversion to home-office or den.

There is plenty of storage space throughout the house and a double garage has a side door as well as entrance to the home through the laundry room.

A 10-foot-high covered entrance, horizontal siding and brick accents grace the exterior of the house, which is 38 feet, 8 inches wide and 52 feet, 4 inches deep with 1,278 square feet of living space.

Plans for design H1-3-555 are available for \$341 (set of 5), \$407 (set of 8), and \$49 for a super set of 10. Please add \$25.00 for Priority courier charge. Also add 7% GST to both the plan price and postage charges.

Our NEW 32nd Edition of the Home Plan Catalogue containing over 300 plans is available for \$11.50 (including taxes, postage and handling). Make all cheques and money orders payable to "Home Plan of the Week" and mail to: HOME PLAN OF THE WEEK, c/o The New Tanner, 336 Columbia Street, New Westminster, BC V3L 1A6. or see our web page order form on: <http://www.jenish.com> and e-mail your order to: [homeplans@jenish.com](mailto:homeplans@jenish.com)

**Lakeview FLOORING & KITCHENS**  
Home Design Centre

Paints • Wallpaper  
Carpet • Vinyl • Ceramic Tile  
• Hardwood Flooring  
• Windows Blinds & Shutters  
• Full Kitchen & Bath Renovations

VISIT OUR SHOWROOM

130 Mill St. E., Acton  
**853-4577**  
**853-1190**  
Financing available O.A.C.

**Leathertown LUMBER**

264 Main St. N., Acton  
"We have everything you need to do the job right."

- Treated Lumber
- Plywood
- Trim
- Mill Work
- Plumbing
- Electrical
- Hardware
- Windows
- Doors
- Drywall, etc.

HOURS: Mon-Fri 7-6 Sat 8-4

**SIKO Paints**  
**853-1970**

**G. W. WOODWORKING**

20 years of experience  
Commercial • Residential

- Design & Manufacture
- Installation
- Kitchens, Vanities, Bars, Wall Units
- Specializing in Custom Kitchens
- 3D Computer Design Layout

Free Estimate  
COME VISIT OUR SHOWROOM  
348 Guelph St. Unit 15  
Georgetown  
**877-9796**

**PETER ZIONS CONSTRUCTION LTD.**

"Complete Home Packages Available"

A Family Building Tradition Since 1964  
**519-853-2464**

**R & R Company**

Garage Doors  
Electric Openers  
Windows, Entrance Doors,  
Storm Doors, Patio Doors

**SALES, SERVICE & INSTALLATION**

**519-853-2114**

**Concept Cabinets**

Custom Kitchens & Vanity Cabinets  
Architectural Cabinets  
Store Fixtures  
Custom Millwork

JASON BREAU & GLENN PROCTOR  
Tel: (905) 878-9177  
Mobile: (416) 930-5128  
Toll Free: 1-877-774-7757  
Fax: (905) 878-7756  
785 Main St. E., Unit #3  
Milton