

Classifieds 853 0051



Storage & Industrial Space

INDUSTRIAL SPACE AVAILABLE

SPACES FROM

1,500 sq ft to 50,000 sq ft

- located within Halton Hills
- suitable for warehousing or light manufacturing

For further information, please call (519) 853-9595



Services

MR. MOVER

Free no obligation quotes
Free boxes • Free wardrobes
Your local mover
Discounts for Mid Month Moves and Seniors
MAKE YOUR MOVE AND CALL MR. MOVER
• Weekly Long Distance service to the U.S. and Canada coast to coast
• Affordable HOME OFFICE or APARTMENT Moves
• Commercial and Warehouse Moving
• Packing Services, Maid/Cleaning Services
• Storage Facilities
1-877-503-6683 (MOVE)
www.mover.to
E-mail: booking@mover.to



For Sale

DANBY FACTORY SECOND OUTLET STORE
McCULLOUGH-SHUH APPLIANCES
397 Woodlawn Rd. W.
Guelph, Ontario
824-4925

TOPSOIL, manure, sand, gravel. Delivered. 853-2449 days. (TFN)

ATTENTION INTERNET USERS - unlimited access, only \$15.95. Great local service & support from SURF THE NET 873-2602. (42)

"WILD FLOWER HONEY": 8832, 32 Side Road (West of 25), 1 mile North of Acton. 853-2622. (V4/13)



Jacy C. 2000

Plans to rezone a rural property on the south east corner of Highway 7 and 22 Side Road - Henderson's Corner - to permit commercial uses in an existing building four times larger than allowed in the Official Plan, drew objections from an area resident at a public planning meeting last week.

Floyd Nelson, who operates a body shop across from

TOWN DIGEST

the property, praised the owner for recent improvements to the building, and asked what commercial uses would be allowed. He also raised concerns about snow plowing, outside storage, increased traffic and com-

plained someone is living illegally on the property.

Town planner Gabriel Charles said residential uses won't be permitted and the site plan process will look at the issues Nelson raised, adding Halton will determine if

traffic concerns warrant a study on 22 Side Road. Highway 7 is under the jurisdiction of the province.

Commercial uses in rural cluster are to serve the needs of area people and in the past two decades, there's been a fruit market, car dealer and trailer sales on the property.

Councillors will debate the proposal once staff has prepared a report.

ASBUILT CLIMATECARE

- Heating
- Air Conditioning
- Fire Places
- In Floor Heating
- Sheet Metal
- Design/Permit Packages

877-8023

ACTON PRECAST CONCRETE LTD.
Quality Concrete Products Since 1963

- SEPTIC TANKS & WATER CISTERNS
- PVC SEWER PIPE
- WELL TILES & CULVERTS
- TRANSFORMER BASES
- STEPS & PORCHES
- YARD & PATIO PRODUCTS

519 853-1529

BEATON ROOFING

- Residential
- Commercial
- Industrial • AGR
- Air Conditioner
- Curb Installations
- Tar & Gravel
- Shingles
- Steel Roofing

FREE ESTIMATES with Written Guarantee

serving: Wellington County & Halton Hills
(519) 856-9784

SCOTT'S OAK & PINE FURNITURE

- ◆ Oak & Pine Tables & Chairs
- ◆ Bedroom Suites
- ◆ Entertainment Centres
- ◆ Bookcases and Desks
- ◆ Quality Coil & Foam Mattresses
- ◆ Gifts & Accessories

Specializing in Solid Wood
- Locally Hand Crafted Furniture
197 Main St. S, Rockwood
856-2537
LOCATED ON HWY#7 BETWEEN GUELPH & ACTON

"Home of the Week" ~ Your Building Experts

Three Bedroom Family Home

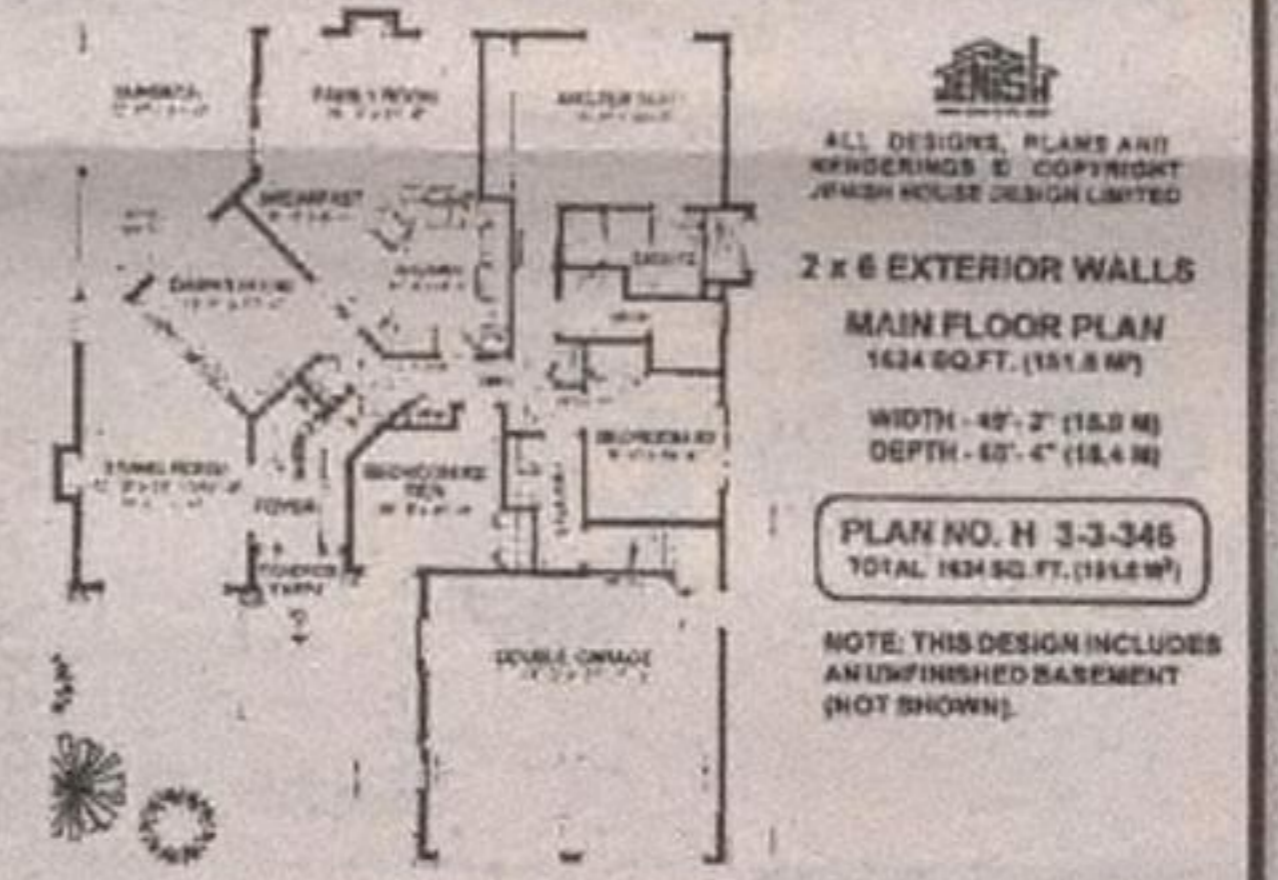

Space is used to its utmost efficiency in this good-looking, three bedroom family home.

The compact foyer, while large enough for practical use, enables additional space to be used to advantage in the rest of the house.

The dining room is intriguingly designed on an angle, bordered by the kitchen and family area on one side and is separated from the living room by a half-wall on the other side.

The living room, immediately off the foyer has a central gas fireplace and a dramatic, 12' 6" high ceiling that enhances the feeling of spaciousness. This formal living room also benefits from the interesting angle of the adjoining dining room, separated by a half-wall.

The dining room itself, as well as the main-floor living areas, are raised seven risers from the foyer-level. Sliding glass doors give the dining room access to a covered deck.

The next-door family room, with sliding doors to the open area of the same sun deck, has its own gas fireplace for a cosy atmosphere during the winter months.

A half-wall is all that separates the kitchen from the family room, which makes sure the whole family zone, with the breakfast room, is open for congenial day-to-day living. A pantry and an abundance of counter space make sure the kitchen offers plenty of room for meal preparation.

The master suite is at the rear of the house and includes a full wall closet with generous space for clothes. The four-piece en suite bathroom has a

raised soaker tub set into a bay and separate shower.

The two secondary bedrooms share the main, three-piece bathroom. Bedroom No. 3, located off the foyer, could be used as a den or home office, if desired.

A laundry room is given convenient access from the double garage, which also has a side door.

Skylights in the central hallway will give this area an abundance of light.

Broom and linen cupboards make sure there is plenty of storage space.

The exterior is distinguished by a cathedral entrance, brick pillar and brick corner detailing. Brick accents, combined with stucco and a concrete slate tile roof, offer an elegant finish. The house is 49 feet, 2 inches wide and 60 feet, 4 inches deep with 1,634 square feet and an unfinished basement.

Plans for design H3-3-346 are available for \$404 (set of 5), \$475 (set of 8), and \$524 for a super set of 10. Please add \$25.00 for Priority courier charge. Also add 7% GST to both the plan price and postage charges.

Our NEW 32nd Edition of the Home Plan Catalogue containing over 300 plans is available for \$11.50 (including taxes, postage and handling). Make all cheques and money orders payable to "Home Plan of the Week" and mail to: HOME PLAN OF THE WEEK, c/o The New Tanner, 336 Columbia Street, New Westminster, BC V3L 1A6. or see our web page order form on: <http://www.jenish.com> and e-mail your order to: homeplans@jenish.com

POLICE BEAT

Man attacked on BalACLava Street

Rockwood violence

A 34-year-old Rockwood man received minor injuries when he was attacked on a trail near BalACLava Street as he walked home from work around 9:30 p.m. on Oct. 3.

The man told Wellington OPP five teenagers approached him, followed him onto the trail, then knocked him to the ground, and kicked and punched him.

The attackers are described as around 17 years of age. One was six feet tall, with dirty blonde hair, a large nose and wore a black cap, baggy, black jeans, and a black Nike sweatshirt. Another youth wore a maroon ball cap with Rockwood written on it, and a green sweatshirt.

Girl struck

Police suspect a nine-year-old girl struck by a rock as she walked along Guelph Street near the Rockwood post office around 5:30 p.m. on Oct. 4 may have met one of the youths involved in a Rockwood assault the previous night.

A teenaged male approached the girl, told her to

look at something in a nearby bush, then when she complied, he threw a small rock striking her on the head. The child was not seriously injured.

The male is described as 16 to 17 years of age, with dirty blonde hair and wearing a black shirt and black ball cap.

The description matches that of one of the youths involved in a BalACLava Street assault the night before and also with a suspect in an attempted break-in at Rockwood Centennial School on Sept. 27.

Woman hurt

A 32-year-old Hillsburgh woman received only minor injuries to her hand when she got it caught in a machine at Greening Donald Ltd. in Erin on Oct. 5. The woman was trying to repair a guide wheel when the accident occurred.

Bus damaged

The rear windows of a Denny's school bus were shot out with a bb gun while the bus was parked in a Stanely Park driveway last week.

Lakewood FLOORING & KITCHENS
Home Design Centre

- Paints • Wallpaper
- Carpet • Vinyl • Ceramic Tile
- Hardwood Flooring
- Windows Blinds & Shutters
- Full Kitchen & Bath Renovations

VISIT OUR SHOWROOM

130 Mill St. E., Acton
853-4577
853-1190
Financing available O.A.C.

Leathertown LUMBER

264 Main St. N., Acton
"We have everything you need to do the job right."

- Treated Lumber
- Plywood
- Trim
- Mill Work
- Plumbing
- Electrical
- Hardware
- Windows
- Doors
- Drywall, etc.

HOURS: Mon-Fri 7-6 Sat 8-4
853-1970

G. W. WOODWORKING
20 years of experience
Commercial • Residential

- Design & Manufacture
- Installation
- Kitchens, Vanities, Bars, Wall Units
- Specializing in Custom Kitchens
- 3D Computer Design Layout

Free Estimate
COME VISIT OUR SHOWROOM
348 Guelph St. Unit 15
Georgetown
877-9796

PETER ZIONS CONSTRUCTION LTD.
"Complete Home Packages Available"
A Family Building Tradition Since 1964
519-853-2464