

## Says Kingham Rd. parking still a concern for residents

To the Editor, Town Council, Kingham Road residents, Having spent hours speaking with various Town departments about the pathetic parking situation, a workable solution or proposal has been attained for Kingham Road.

Removal and recessing the curb nine feet back for the top of Greenore Crescent to the

town pumping station, increasing street lighting and opening it up to the 12 hour parking would meet the need and criteria necessary as per Bob Butrym. (As submitted to The New Tanner last week.)

Parking on the corner as is, on this under-width eight-metre road is hazardous. Two buses negotiating the curve at the same time could spell

disaster.

As I suggested a couple of years ago, the whole road should be widened due to safety concerns and loss of road due to snow accumulation. Last winter, tape measure in hand, 14 feet of usable road was all that existed. The Town responded by issuing a letter to every household to switch their vehicles to the other side of Kingham for a night to gain back road width, as the snow was plowed and taken away.

As our children age and new residents arrive the typical two car family has been replaced with three and four. Green space for parking and extra spots are non-existent.

Being taxpayers of an over populated half a kilometre area, we seek your assistance.

Thank you,  
Stephen Grasby.



## Board chair urges Acton to get behind saving land

Dear Editor,

I would like to provide a bit of background around the possible disposition of approximately three acres of property at McKenzie-Smith Bennett Public School, and assure the people of Acton that I will work as hard as I possible can to protect the access to that property.

Ontario School Boards are tied to a funding model which leaves much to be desired in many areas; one of those being accommodation. The province dictates that we run every school in Halton at 100 per cent capacity, and that we carry no surplus pupil spaces before we receive grants to

build schools. We have huge growth areas in Halton where schools clearly are needed, and we have no way at the present time to generate revenue in order to build schools. Part of the problem is that this, and past school boards refused to close underutilized schools.

The Ontario government requires all boards in the province to file a capital strategic plan which sets out a plan to accommodate students for the next 20 years. CN Watson and Associates Ltd., an independent consulting firm has prepared for the Halton District School Board such a plan. It recognizes that the population of Halton will nearly double in the next 20 years and that we will need 33 new elementary schools and eight new secondary schools to deal with that growth. The plan calls for the closure of schools with surplus capacity, the introduction of Junior Kindergarten centres, and the disposition of surplus board property, among other things. Rest assured that I did not bring the sell of the McKenzie-Smith Bennett property to the Board; it was simply part of that report.

The linking of the two schools in 1995 has caused these schools to now be considered as one school. The funding formula also sets out the size of sites for schools;

thus McKenzie-Smith Bennett is now considered to have a larger site than it needs to accommodate a play area for the children who attend that school.

It is required by law that our Board provide adequate accommodation for all students in Halton. While it is not the responsibility of the Board to provide community recreational facilities any more than it is the town's responsibility to build schools, I think we have a shared responsibility here to the children of Acton. There is every indication that the town and the Board will work together to try and address your concerns.

I am pleased that the people of Acton are making their voices heard. I would suggest that you:

lobby the town as well as the Halton District School Board

petitions are everywhere in Acton - sign one.

delegate the Board and town council. (Board meetings are the first and third Wednesday of each month. Written requests for delegations should be submitted to the Director's Office. Call Gail Gortmaker at 878-8451 for more information.)

write letters to me, asking that they be distributed to all trustees. I will be happy to do that.

please assure your children that their playground is not going to disappear. If the worst happens and the three acres are removed from the 15.4 acres, there will still be room to play. Let's not worry the children.

In the meantime, I have been collecting information - I have met with the Board staff, the mayor and town staff, and I will continue to work toward a solution. At this time, the disposition of this property is not a "done deal". Board approval is required for every school to close, and every property for sale. The timelines for this process are at present not determined.

However, I look forward to having the two bus loads of people from Acton arrive at a Board meeting to present your petition. Good for you!

Yours truly,  
Ethel Gardiner,  
Chair of the Board

**We'll Make You Smile!!**

House Calls Available

**DENTURE SPECIALIST**  
E. JUREVICIUS D.D.

Construction & Fittings of New Dentures

- Same Day Repairs & Relines
- Free Consultations • Seniors Discount
- Specializing in Problem Lower Dentures

**ACTON DENTURE CLINIC**

16 Mill St. E., Acton 853-0079

**API ACTON PRECAST CONCRETE LTD.**

Quality Concrete Products Since 1963

- SEPTIC TANKS & WATER CISTERNS
- PVC SEWER PIPE
- WELL TILES & CULVERTS
- TRANSFORMER BASES
- STEPS & PORCHES
- YARD & PATIO PRODUCTS

519 853-1529

**Leathertown LUMBER**

264 Main St. N., Acton  
"We have everything you need to do the job right."

- Treated Lumber
- Plywood
- Trim
- Mill Work
- Plumbing
- Electrical
- Hardware
- Windows
- Doors
- Drywall, etc.

HOURS: Mon-Fri 7-6 Sat 8-5

**SICO** Paints  
853-1970

**G & S EXCAVATING LTD.**

Snow Plowing & Removal  
Licensed Septic Systems  
Sand & Gravel  
Topsoil  
Ponds  
Basements/Foundations

**FREE ESTIMATES**

R.R.#2 Acton 853-2515

**G. W. WOODWORKING**

20 years of experience  
Commercial • Residential

- Design & Manufacture
- Installation
- Kitchens, Vanities, Bars, Wall Units
- Specializing in Custom Kitchens
- 3D Computer Design Layout

Free Estimate  
COME VISIT OUR SHOWROOM  
348 Guelph St. Unit 15  
Georgetown 877-9796

"The Home of the Week"

## YOUR BUILDING EXPERTS

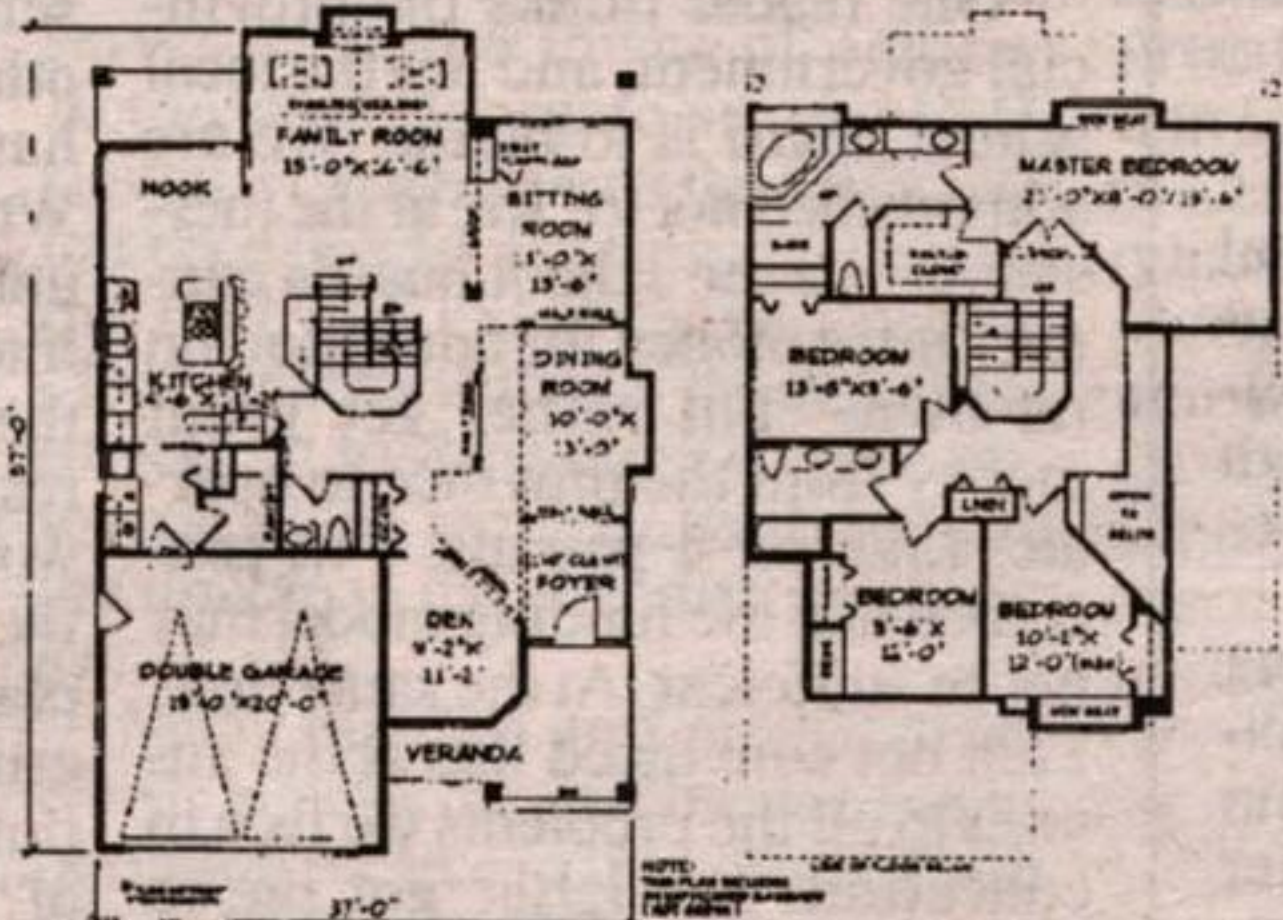
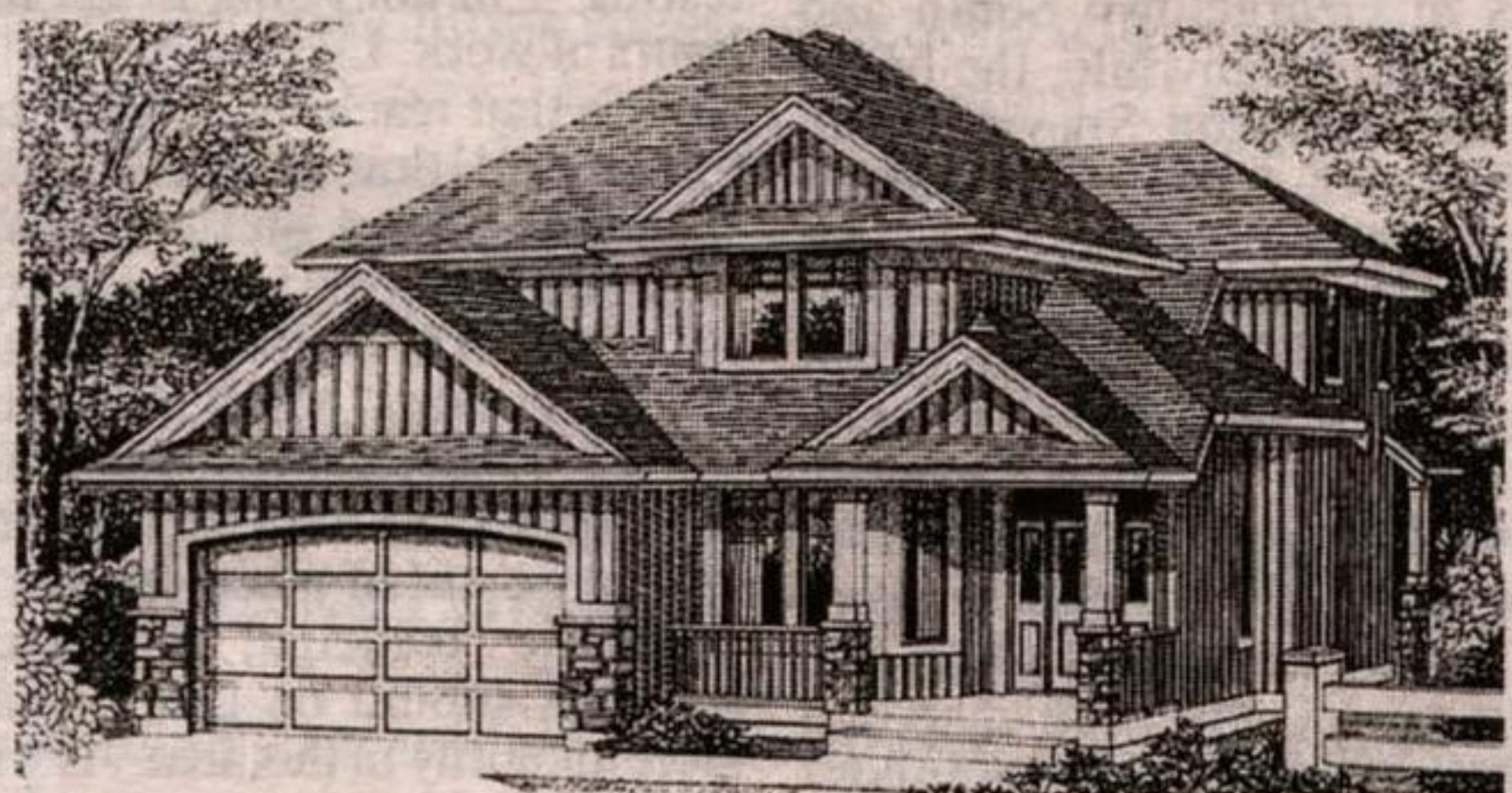

### Stylish family home features open plan layout

Half walls and arched entryways replace full height walls and doors, offering a spacious open plan atmosphere while still suggesting a subtle division between different living areas.

An 11'-0" ceiling height in the foyer and dining room creates a grand style entrance. Stand in the foyer and you can see, over half walls, into the dining room and sitting room and partially into the family room. As well, an arched entrance allows you to see into the den. A vaulted ceiling in the family room adds a stylish touch. A three way fire-place can be enjoyed from the family room and the sitting room. The cook in the family will enjoy a gourmet style kitchen complete with a work island, and a walk-in pantry off the utility room.

Upstairs, you can look over the railing into the foyer and dining room as a result of the high ceiling in these

areas. French doors lead into a deluxe master bedroom which features a large walk-in closet, and a five piece ensuite with an oversized shower and double sinks.

An unfinished basement awaits your own creative touch.

Plans for U-1128 may be obtained for \$485.00 for a package of five complete sets of working prints and \$40.00 for each additional set of the same plan. Allow \$20.00 extra to cover the cost of courier. (Add 7% GST to plan total plus postage and handling.)

This is one of our new designs. Many innovative plans are now available in our NEW catalogue: Two Storeys 2000 to 2500 sq ft, which is available for \$8.51 including postage and handling and GST.

Please make all cheques, money orders, and Visa or Mastercard authorizations payable to The New Tanner Plan of the Week, 13659 - 108th Ave., Surrey, B.C. V3T 2K4.

**PETER ZIONS CONSTRUCTION LTD.**

"Complete Home Packages Available"

A Family Building Tradition Since 1964

519 853-2464

**BEATON ROOFING**

FREE ESTIMATES with Written Guarantee

- Residential
- Commercial
- Industrial
- Air Conditioner Curb Installations
- Tar & Gravel
- Shingles

serving: Wellington County & Halton Hills  
(519) 856-9784

**R & R Company**

Garage Doors - Electric Openers  
Windows, Entrance Doors, Storm Doors, Patio Doors

**SALES, SERVICE & INSTALLATION**

Contact Gary  
519-853-2114

**lakeview FLOORING & KITCHENS**

Home Design Centre

- Paints • Wallpaper
- Carpet • Vinyl • Ceramic Tile
- Hardwood Flooring
- Windows Blinds & Shutters
- Full Kitchen & Bath Renovations

VISIT OUR SHOWROOM

130 Mill St. E., Acton  
853-4577  
853-1190

Financing available O.A.C.

**Medical Pharmacy**

(in the Medical Building)  
93 Mill St. E. Acton  
853-5780

- No \$2 copay (for eligible ODB)
- Free Medication Advice
- Free Local Delivery
- 10% Seniors Discount EVERY DAY

**GUELPH & ACTON UPHOLSTERY**

Earl Jensen  
Serving Acton & Rockwood Area

Recovering Furniture - Antique & Modern.

Please call for a FREE estimate in your home or visit our FABRIC SHOWROOM at  
303 Victoria Rd. N. GUELPH (Corner of Speedvale)

Or call 824-0533 (local call)  
Free pickup and delivery