

W.J. Vermeulen

Chartered Accountant



Revenue Canada
Authorized Agent
for Electronic Filing

**MOST TAX RETURNS \$25
GET YOUR REFUND IN JUST TWO WEEKS!**

18 Burns Drive, Guelph • 824-0897



BIT O' THE BLARNEY? Knox Presbyterian Church held its annual St. Patrick's dinner on Friday. Knox member Isabel McDonald, left, and Ruth Linham, a member of Limehouse Church, share an Irish story. (Doug Harrison photo)

HOMEPLAN OF THE WEEK!

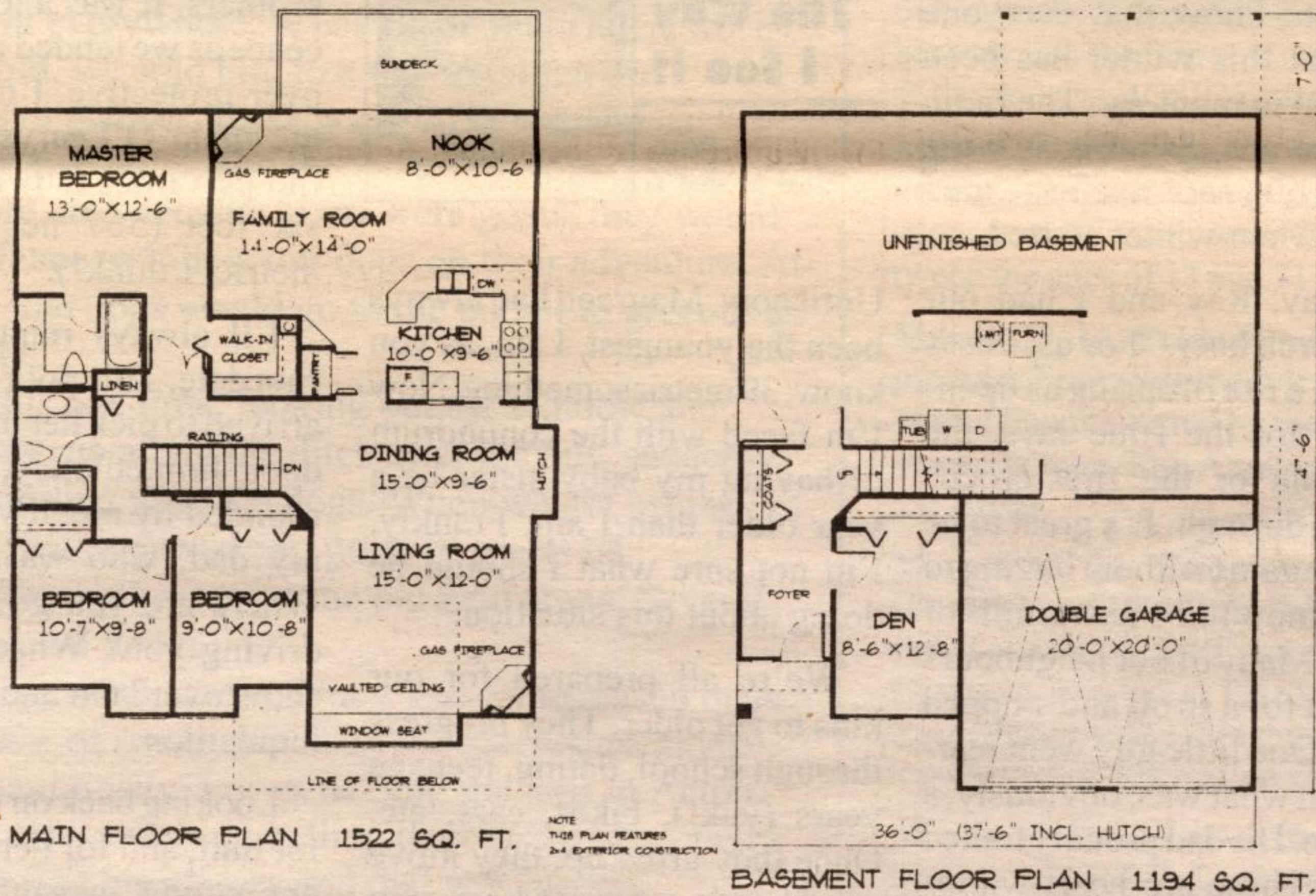

Efficient family home design

This compact basement home design offers a very comfortable and versatile living environment.

The unfinished basement provides plenty of room for a future in-law suite, and already has a private side entrance. The den could be converted into a shared utility room. If an in-law suite isn't in your long range plans, perhaps the unfinished area could be developed into a recreation room and an extra bedroom or two. The den, right inside the front entrance and away from the main traffic areas, would make an ideal home office.

An open plan for the living-dining room creates a spacious area for entertaining and features a vaulted ceiling and a boxed out window seat. The kitchen provides an efficient working layout with plenty of cupboard and counter space, a pantry, and an open counter which acts as a handy pass-through to the nook and the family room.

Both secondary bedrooms feature a boxed out area with a window providing extra space for a dresser or a desk. The master, like those in larger homes, has a walk-in closet and a three-piece ensuite.

Plans for GL-629 may be obtained for \$375 for a package of five complete sets of working prints and \$34 for each additional set of the same plan. Allow \$15 extra to cover the cost of postage and handling (Add seven per cent GST to plan total plus postage and handling)

This is one of our new designs. Many innovative plans are now available in our new 30th edition plan catalogue for \$13.85 including postage and handling and seven per cent GST.

Please make all cheques, money orders and Visa or Mastercard authorizations payable to: The Acton Tanner Home of the Week, P.O. Box 150, Acton Ont., L7J 2M3.

Angelo's CARPENTRY

Custom Trim Work
Sundecks • Bars • Wall Units
Rec Rooms • Kitchens
General Carpentry

**Supply and Installation
of French Doors**

Highway 7, East **856-1333**
(Between Guelph & Rockwood)

UNICORN DRAPERIES

Blinds,
Shades &
Custom
Draperies

Open 9 am-6 pm Daily

823-1116

R.R. 5 Guelph (At Marden)

PETER ZIONS CONSTRUCTION Ltd.

853-2464 • ACTON
"A Family Building Tradition
for 28 Years"

- ◆ Home Improvements
- ◆ Licensed R-2000 Home Builder

Twiss Fuels

- Shell Fuels & Lubricants
- 24-Hour Burner Service
- Hot Water Heater Rentals
- Energy-Efficient Testing
- Installation



878-6380

Unit 15, 32 Steeles Ave.
Milton

B & K WINDOWS & Aluminum Products

- EXPERTS IN THE SALE & INSTALLATION OF:**
- ALUMINUM & VINYL WINDOWS
 - PATIO DOORS & SHUTTERS
 - STORM WINDOWS & DOORS
 - PORCH ENCLOSURES
 - SOLARIUMS
 - THERMAL REPLACEMENT
 - DOUBLE OR TRIPLE GLAZED
 - FASCIA, SOFFIT, EAVESTROUGH, SIDING

FOR A FREE ESTIMATE, CALL TODAY: **877-3769**

Police band to entertain

LEGION NEWS

There were two tables of bridge and 18 tables of euchre last week. The winners for Bridge were Lil Cook, Kathleen Tulk and Len Lovell. Glad Inglis, Fred Johnson, Liz Klimsiak, Pearl Baker, Marguerite Atkinson and Stella Brunelle were successful.

The winners for Saturday's Ham Roll draw were too numerous to mention but the Meat Draw winners were: P. Bouchard, Cathy, Sylvia Neville, Bonnie Townsley, Barb Andrews, Ed Molody, Wayne Wilson, Al Robinson, Ken Tarzwell, Wayne Scott, J.T. Hayes, Joyce Snow, Jackie Ford, Wally Ferguson and the large winner was that gal from Georgetown who could not get close enough to the fireplace, Doris Clarke.

Coming Events: Bridge, Euchre and the Meat Draw — Same place, same day next week. Saturday night is the 63rd Anniversary of the Branch Charter and there will be a bar, dinner and entertainment in the auditorium, starting at 6 pm at \$15 per person for members only and at 9 pm the public is welcome to join and dance to the music of The Peel Regional Police Band for \$5 per couple.

General: At the General Meeting we learned we have almost 600 members. Most of these members live in and around Acton and take advantage of all the programs and services we offer.

If you are really interested in the Acton Branch and its activities, make a point to get in touch with entertainment chair Keith Andrews, Gary Munday (in charge of maintenance) or Art Moss, the chair who is in charge of crew chiefs.

NH MH North Halton Material Handling

- Sales & service
- Residential garage doors & openers
- Commercial overhead doors
- Dock levellers & Lift trucks
- 24 hour service
- Seniors' discounts

FREE ESTIMATES

853-2550

ALL WORK GUARANTEED

ABR

ROOFING & ALUMINUM

Specializing in Re-Roofing
Siding • Eavestroughing
New Roofs • Repairs
Soffit • Fascia

ANDREW B. RAMSDEN
Free Estimates **853-1452**

HALTON HILLS

ELECTRICAL CONTRACTING

- RESIDENTIAL • COMMERCIAL
- INDUSTRIAL • RURAL

POLE LINE WORK
24-HOUR SERVICE
NEWWORK • REWIRING
ELECTRIC HEATING
INSTALLATION & MAINTENANCE

Call **853-2572**
73 NELSON CRT.
PROP. — LYLE PRUETER

CHATELAINE LIGHTING

SERVING GUELPH & AREA SINCE 1969

REPAIRS TO LIGHTING FIXTURES
COMPLETE LINE OF NUTONE
EXHAUST FANS & DOOR CHIMES

OPEN 6 DAYS A WEEK

GUELPH, 519 **824-0401**
52-56 VICTORIA RD. S. (AT ELIZABETH)

DENNY'S INSURANCE

50 YEARS EXPERIENCE

Serving All Your Insurance Needs

Home • Auto • Business • Travel
Life • Mortgage Ins. • Group • RRSP

853-0150
15 Mill Street West
Your Insurance Broker Understands