

'Thanks for your support Acton'

Continued from Front Page

"I can only express my sincere, heartfelt thanks for all the support, best wishes and assistance that have been forthcoming from the community customers of Acton in particular, but also from throughout Ontario," praised Dawkins, who added that advertising is being done in Guelph, Hamilton and Kitchener. He's hoping to get some extended market publicity on the merits of Friday's festivities.

Although business has been slow, Wetherby's owner Jo Lister has noticed more customers on Saturday and Sunday.

"Up to now, it has been more

local people, but I'm sure there will be a lot of people driving up this weekend to visit the Hide House and look at the fall colours," Lister predicted.

"This weekend will be reminiscent of the old days with lots of cars and people," Dawkins predicted. "It's like running a four-engine aircraft. It was running on one engine for the opening in September and two weeks later it was on two. This weekend will be like going from two to four engines."

Police will add staff Oct. 31

Continued from Front Page

designate as Halloween the police will add extra staff," Stewart told council, adding that the police expressed a preference for Sunday and have already scheduled extra staff.

She also found that the last time Halloween was on Sunday council made no decision to change the date.

By phoning other municipalities she also discovered that five out of seven communities surrounding Halton Hills, including Guelph and Brampton, have designated Sunday as Halloween.

Hamilton has decided to hold the event on Saturday, but may revert back because they have been inundated with phone calls and questions concerning the change. Stewart said they have had to set up a special Halloween "Hotline."

Milton is awaiting the decision of Halton Hills before they make their plans. Stewart said that the clerk's office has already fielded a lot of questions about the Town's decision.

"We've been receiving a lot of calls about this — it's certainly been the hot issue," Stewart said.

One councillor joked at last week's council meeting that "if we are planning to change Christmas, we should decide now to avoid the rush."

Smoking bylaw to be passed in January

Continued from Front Page

non-smokers will have to accept the smell and effects of tobacco smoke if they choose to go to a bar or tavern.

"We've got to give the business community some latitude to make a profit," Mayor Russ Miller said in support of the exemption.

The bylaw must be examined by the Town's lawyers and passed at council before it becomes law. Fines and enforcement procedures are not yet clearly defined.

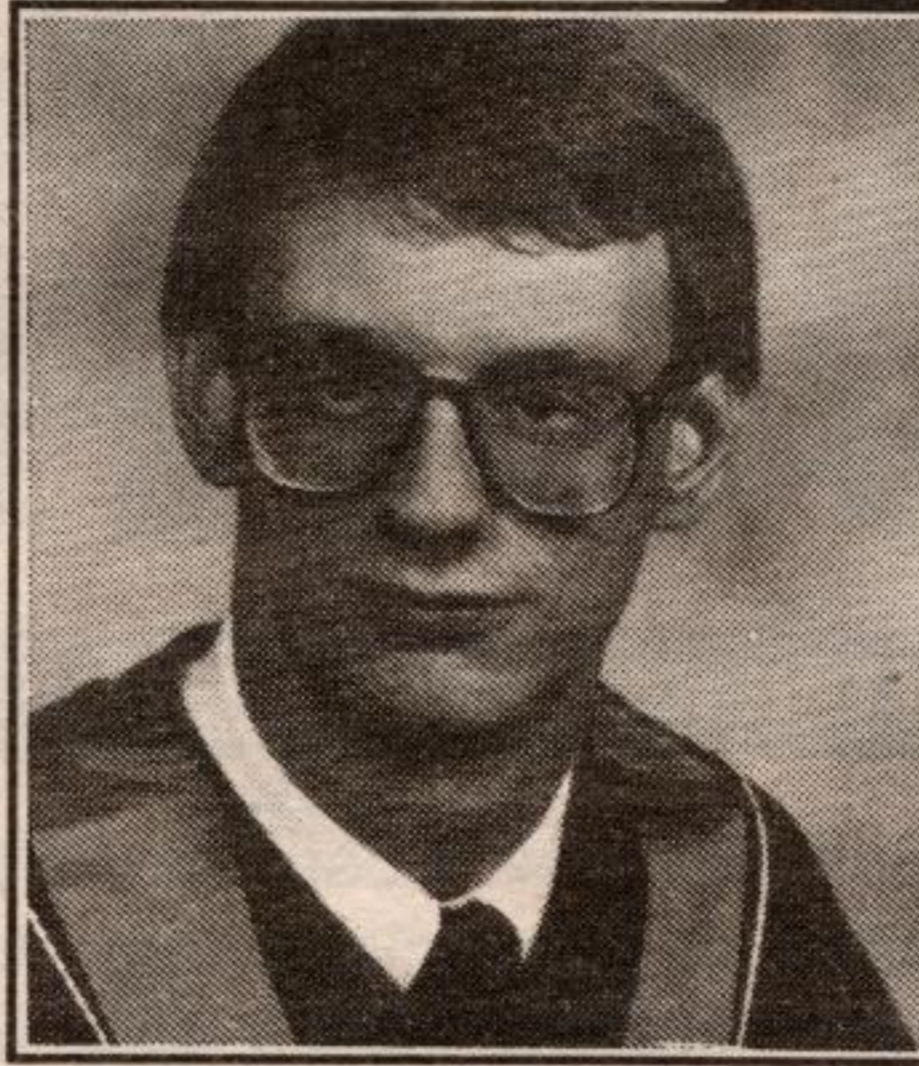

W.J. Vermeulen Chartered Accountant

- Owner-Managed Businesses
- Personal Financial Planning
- Not-For-Profit Organizations

FREE INITIAL CONSULTATION — CALL TODAY!

18 Burns Drive, Guelph • 824-0897

ALL WORK GUARANTEED

ABR

ROOFING & ALUMINUM

Specializing in Re-Roofing
Siding • Eavestroughing
New Roofs • Repairs
Soffit • Fascia

ANDREW B. RAMSDEN
Free Estimates **853-1452**

GRAHAM WELL DRILLING LTD.

Canadian Water Well Association Ontario Water Well Association

FARM, RES. COMM., INDUST.

Drilling & Pump Systems
Competitive Prices
Free Estimates

R.R. 5 **824-3690**
ROCKWOOD

AK CARPENTRY & PAINTING

Quality 1st

RENOVATIONS & ADDITIONS
BUILDING RESTORATION
DECKS, FENCING, TRIM

ROCKWOOD
856-2230
105 MacLennan

DENNY'S INSURANCE

50 YEARS EXPERIENCE

Serving All Your Insurance Needs

Home • Auto • Business • Travel
Life • Mortgage Ins. • Group • RRSP

853-0150
15 Mill Street West
Your Insurance Broker Understands

HOMEPLAN OF THE WEEK!

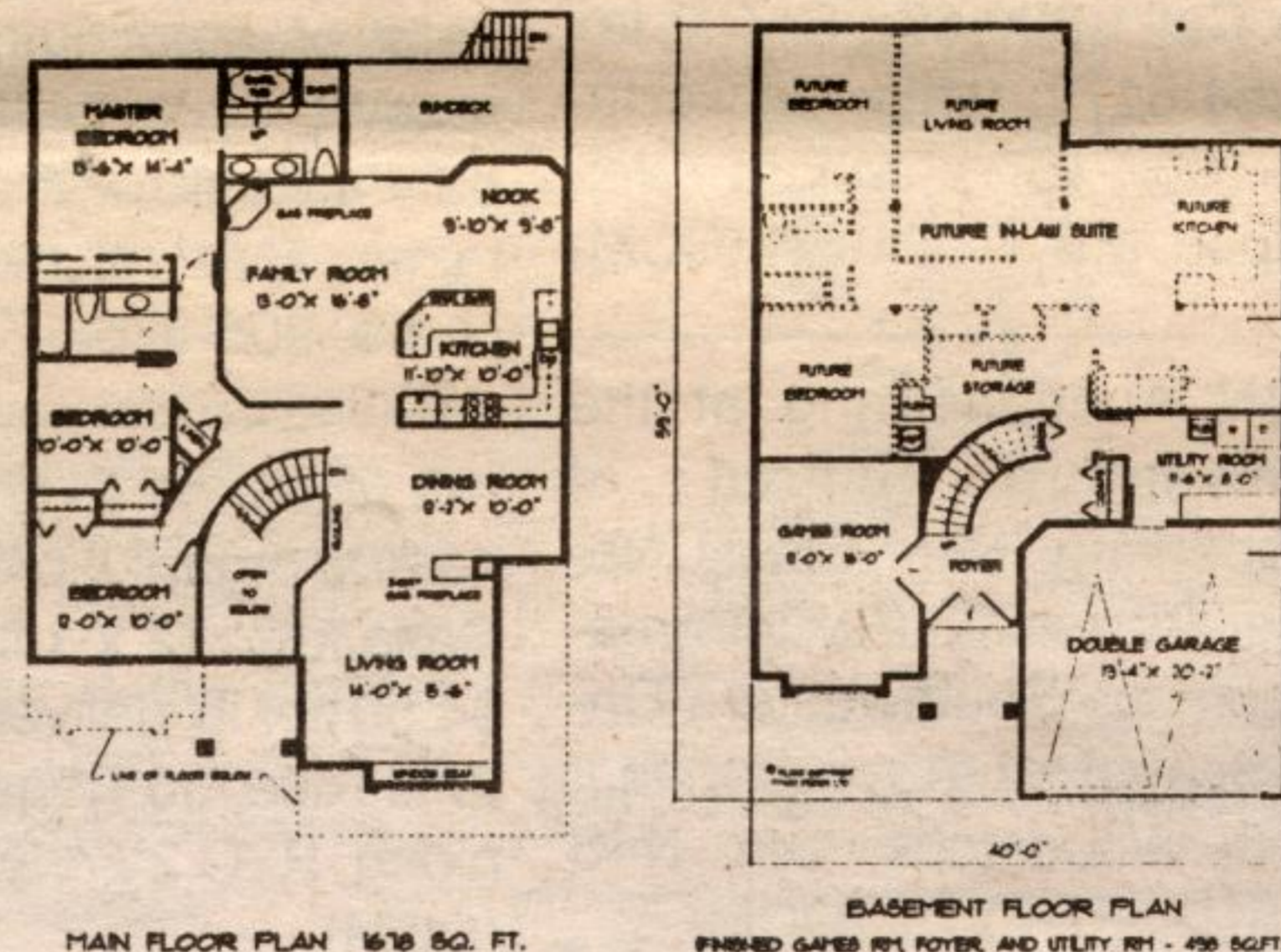
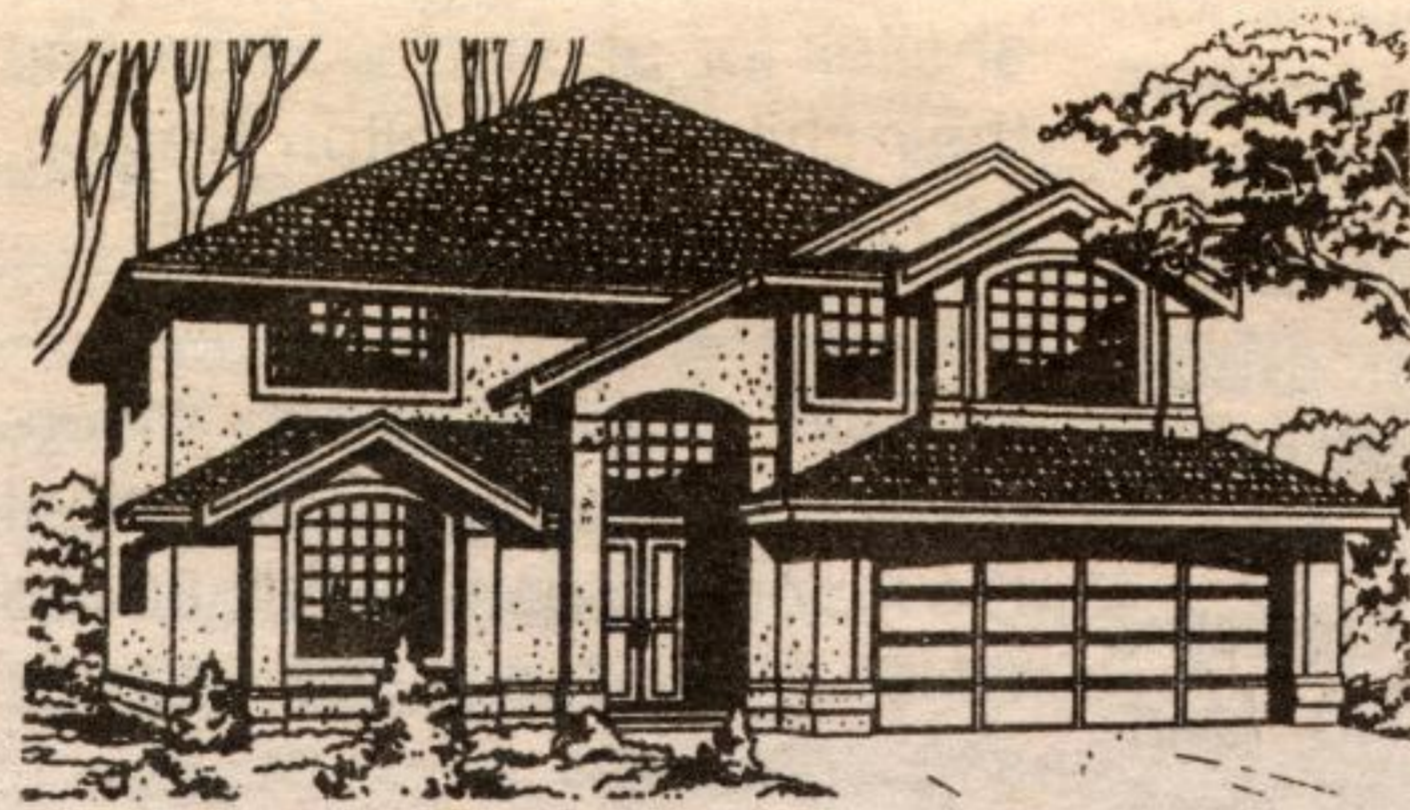

Ideal home for extended family

This basement entry home plan provides a rough-in for a deluxe future in-law suite.

A multi-level roof design with gables and large palladian style windows on the upper and lower floor create the appearance of a two storey rather than a basement entry home. A high arched entrance adds an elegant touch.

Enter through double doors into a large foyer open to the second storey. To the left, French doors lead into a good sized games room which boasts an attractive feature window. To the right, a utility room can be entered from the garage or from the foyer. A future in-law suite has been roughed-in, showing a spacious and comfortable living environment, with two bedrooms, a large kitchen and living room, and a space for a washer and dryer. Windows along the rear and the side of the home will provide plenty of natural light for the suite.

A curved staircase leads to the main living and bedroom area. A stylish living room features a window seat set into a palladian window. The living and

dining room share a three-way fireplace. The kitchen boasts an efficient working layout with a handy breakfast bar and a bayed out nook. The family room, open to the nook, has a cosy gas fireplace, and provides access to the sun deck via sliding glass doors.

The master bedroom boasts a five piece ensuite with double sinks and a raised swirl tub.

Plans for GL-621 may be obtained for \$365 for a package of five complete sets of working prints and \$29 for each additional set of the same plan. Allow \$15 extra to cover the cost of postage and handling (B.C. residents add applicable sales tax to plan total). All Canadian residents add 7% GST to plan total plus postage and handling.

This is one of our new designs. Many innovative plans are now available in our NEW Basement Entry plan catalogue for \$9.58 including postage and handling and 7% GST.

Make cheques, money orders, and Visa or MasterCard authorizations payable to: Acton Tanner Home of the Week, P.O. Box 150, Acton, Ont. L7J 1G8.

HALTON HILLS
ELECTRICAL CONTRACTING

- RESIDENTIAL • COMMERCIAL
- INDUSTRIAL • RURAL

POLE LINE WORK
24-HOUR SERVICE
NEWWORK • REWIRING
ELECTRIC HEATING
INSTALLATION & MAINTENANCE

Call **853-2572**
73 NELSON CRT.
PROP. — LYLE PRUETER

PETER ZIONS
CONSTRUCTION Ltd.

853-2464 • ACTON

"A Family Building Tradition for 28 Years"

- ◆ Home Improvements
- ◆ Licensed R-2000 Home Builder

Twiss Fuels

- Shell Fuels & Lubricants
- 24-Hour Burner Service
- Hot Water Heater Rentals
- Energy-Efficient Testing • Installation

878-6380
Unit 15, 32 Steeles Ave., Milton

B & K WINDOWS & Aluminum Products

EXPERTS IN THE SALE & INSTALLATION OF:

- ALUMINUM & VINYL WINDOWS
- PATIO DOORS & SHUTTERS
- STORM WINDOWS & DOORS
- PORCH ENCLOSURES
- SOLARIUMS
- THERMAL REPLACEMENT
- DOUBLE OR TRIPLE GLAZED
- FASCIA, SOFFIT, EAVESTROUGH, SIDING

FOR A FREE ESTIMATE, CALL TODAY: **877-3769**

ESCHUBERT
EXCAVATING LTD.
EXCAVATING & LANDSCAPING

- TOPSOIL
- ROCKERY STONE GARDENS & RETAINING WALLS
- WATERFALLS
- SEPTIC SYSTEMS
- SNOW REMOVAL
- BOBCAT MINI-BACKHOE SERVICE

Eric Schubert
853-4344 R.R. 1, Acton

MASONRY

NOTICE YOUR CHIMNEY LATELY?
CHIMNEY & MASONRY REPAIRS

- Chimney Rebuilt & Pointed
- General Masonry Work
- Concrete Work
- FREE Estimates

416-873-2266
Jim Stroud
RECESSION RATES "No Job Too Small"

CHATELAINE LIGHTING

SERVING GUELPH & AREA SINCE 1969

REPAIRS TO LIGHTING FIXTURES
COMPLETE LINE OF NUTONE
EXHAUST FANS & DOOR CHIMES

OPEN 6 DAYS A WEEK

GUELPH, 519 **824-0401**
52-56 VICTORIA RD. S. (AT ELIZABETH)

Leathertown LUMBER

LUMBER, PANNELLING & PLYWOOD
PLUMBING, ELECTRICAL
HARDWARE, HAND-TOOLS
PAINTS, STAINS, WINDOWS, TILES
DOORS, TRIM & SIDING

"Everything you need to do the job right."

Leathertown Lumber Inc.
Main St. North • 853-1970