

# Great Pumpkin Challenge a sign of the season

By Eileen Ross

Well, it's that time of year again. Roast turkey, pumpkin pie, and the annual Great Pumpkin Challenge Weigh-off. Hosted by Bert and Laurie Andrews of Andrews Scenic Acres in Milton, it's the fourth consecutive year of Thanksgiving fun for the family.

The festivities will be held Thanksgiving Monday, Oct. 11 with the great pumpkin challenge beginning at 2:30 p.m. Students may enter two categories with entries grown over this past summer.

The two classes are the Atlantic Giant Pumpkin and the best Jack O' Lantern contest. The winner of each will receive a \$200 cash prize, and a \$200 donation in their name to the charity of their choice.

Other activities to enjoy on the special day include a

haunted forest, Wicked Wendy's Wigwam, pony and hay rides, and a playground, giant sandbox and animal coral for the kids. There will also be an opportunity to pick out your own pumpkin for Hallowe'en.

In addition to the annual Great Pumpkin Challenge Weigh-off, Andrews Scenic Acres hosts hundreds of school students in the fall who are treated to activities involving Thanksgiving and Hallowe'en themes.

Andrews Scenic Acres is open from May until Oct.31 year-round.

To get to Andrew's Scenic Acres, take Hwy. 401 to Hwy. 25 at Milton, drive five km north on Hwy 25. Drive east on 10 Side Road for three km. The property can be found between 3rd and 4th line.

**ARTHUR F. JOHNSON & ASSOCIATES LTD., REALTOR**

**877-5165**

Tor. 874-3040 Res. (519) 833-9578

**LARRY BARNSTAPLE**

\*Sales Representative

Providing Real Estate Services

Since 1972

Let me bring Toronto, Mississauga, & Brampton to your home via Rogers Cable TV

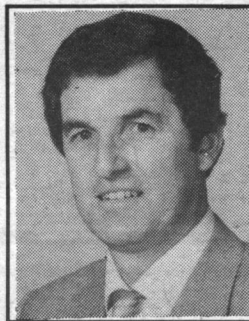

**NEW**  
**WHAT A BACKYARD**  
\$104,900 asking, 3 bedroom townhome. Unspoiled basement, patio doors to fenced yard. Walk to shops, 10 mins. to 401 Hwy. Call Larry\* 877-5165. 93-2-534



**NEW**  
**QUALITY, LUXURY, SPACE**  
Only \$499,000 asking. 3 bedroom Cape Cod on 123 acres of rolling panorama, gourmet kitchen, with entertainer's family room, huge master bedroom with the ultimate ensuite, adjoining study, beautifully finished lower level with walkout to deck, patio and inground pool. Call Larry Barnstaple\* 874-3040. 93-2-528



**NOW \$264,000**  
25 panoramic acres secluded from the road, 2 new baths, sunroom, large elevated patio, walkout basement - Very bright home. Stocked pond, workshops. 93-2-367



**ALMOST NEW - AND IMPROVED**  
\$225,000 asking. Large family kitchen with oak cabinets, main floor family room with vaulted ceiling, sunken library with built-in bookcase, 3 baths, walkout basement, exceptional lot backing on to conservation area. 10+++-. To view call Larry Barnstaple\* 877-5165. 93-2-504



**GLEN WILLIAMS**  
\$219,000 asking, 3 bedroom brick on near acre treed lot. 2 car garage, walkout to yard from basement level. Inground pool. Call Larry\* 877-5165. 93-2-484



**SIX ACRES OF PARK**  
\$268,000 asking, spotless and beautifully upgraded 3 bedroom, skylights, oak kitchen, main floor laundry, large insulated garage, 26' x 48' workshop, your own ski trails thru the forest. This one is loaded with extras. Call Larry\* 877-5165. 93-2-511



**STORYBOOK YARD**  
3 bedroom bungalow in one of Erin's better neighbourhoods. Gleaming hardwood floors, very private well treed back yard, Sunny kitchen and finished rec room. Asking \$179,900. 93-2-330

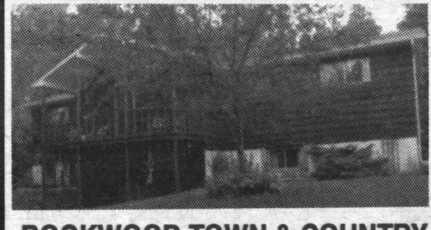

**ROCKWOOD TOWN & COUNTRY**  
\$189,500 asking, almost 1/3 acre treed lot; very private. 4 bedroom home, beautiful decor, family room with woodstove, hot tub, walkout to two decks. Larry\* 877-5165. 93-2-483



**OLYMPIC ACHIEVEMENT**  
The setting, location, creativeness, design and construction combine to make a winning team. An executive retreat high on a hill among the Maples. A spacious home of elegance with separate guest suite. Call Larry\* for all the details. 93-2-395

**RE/MAX**  
Blue Springs Realty (Halton) Corp.  
853-2086  
Tor. 874-3053

**JOHN W. BARTLETT**  
\*Sales Associate

**HEATHER (WHITING) SCOTLAND**  
\*\*Associate Broker

**TRUCKERS/CONTRACTORS \$279,900**

Ideal 32 x 54 ft. steel insulated workshop located 5 minutes south of the 401 on 5 acres. Spacious 2000 sq. ft. raised bungalow overlooking a beautiful valley. Call Heather\*\* or John\*.  
RMAC93-89

**1872 BRICK VICTORIAN \$179,900**

The nostalgia of yesteryear is combined with the convenience of today in this charming 3 bedroom, 2 bath home. Features include an oak and leaded glass kitchen, main floor family room, separate dining room, ensuite and walk-in closet in the master bedroom, and oversized double garage. Call HEATHER\*\* or JOHN\* at 853-2086.  
RMAC93-83

**5 BEDROOM HOME \$399,000 \$479,900**

Modern & spacious all brick, 5 bedroom family home with main floor family room, country kitchen and main floor laundry. Located on 67 scenic acres, including several out buildings. Now priced for action - \$429,900. Call Heather\*\* or John\*.  
RMAC93-57

**AFFORDABLE COUNTRY LIVING \$159,900**

This spacious 3 bedroom home with a wood stove in the livingroom features a main floor laundry, updated roof, well and septic system and an excellent frame barn set on a half acre lot just minutes east of Acton. Call HEATHER\*\* or JOHN\* at 853-2086. RMAC93-77

**VACANT LAND**

5 or 10 acres (Erin)	\$99,900
12 acres, rolling (East Garafraxa)	\$89,900
22 acres, qualifies for severance (Erin)	\$99,000
97 acres, recreational on highway (Halton)	\$389,900
.75 acres, Credit River Pines (Erin)	\$108,000 <del>\$149,900</del>

Please call Heather\*\* or John\* at (519) 853-2086

**ICI DEVELOPMENT LAND**  
BUILDING LOTS/FULLY APPROVED SUBDIVISIONS. Priced sensibly, all draft approved, some serviced. Locations: Erin, Belwood, Lindsay, Orangeville, Fergus.

**GAS BARS.** Highway #24 Caledon - for sale or lease. Affordable.  
Highway #10 Caledon - over 4,000,000 litres, two bay garage, two apartments, variety store, good income, plus 1 ac. vacant land.

**INDUSTRIAL.** 18,000 sq. ft. industrial building located near downtown. Some retail/commercial possibilities. Will divide and refurbish to suit tenants.

**COMMERCIAL/INDUSTRIAL.** Newer steel building with highway exposure (approx. 2,000 sq. ft.) presently M-1 industrial but commercial zoning is pending. \$239,900.

**FOR LEASE.** Approx. 500 sq. ft. office/commercial, may be divided, on a good highway location. \$400 per mo. net.  
Please call Heather\*\* or John\* 853-2086

**NOW ONLY \$239,000**

**AFFORDABLE BRICK VICTORIAN**  
Privately tucked away on 4.5 acres yet minutes to town. Renovated oak kitchen with high ceilings and pine wainscoting. Recently constructed ensuite off large master bedroom. Charm & convenience. Call Larry\* 874-3040. 93-2-325

**NEW PADDOCKS**  
47 acre panorama, 3 bedrooms, high on a hill, walkout on two levels, hot tub, rec room, huge insulated shop, fenced paddocks. Call Larry Barnstaple\* 874-3040. 93-2-251

**FOR RENT**  
Room to move! \$1380/mo. Beautiful 5 bedroom century home, entertainers living and dining rooms, fireplace, family room, 1 1/2 baths, French doors, double garage. Call Larry\* for details, 877-5165.

**SPECTACULAR VIEWS**  
Custom built home with approx. 5,000 sq. ft. on the main floors, 10 ft. ceilings, cherry plank floors, walkouts to balcony deck, 4 spacious bedrooms, library, large studio, 57 acres of trees, hills & streams. 93-2-394

**25 ACRES**  
Trees, pond, fast flowing stream. Beautiful 4 bedroom post and beam with 3 room apartment, 2 large outbuildings. Call Larry Barnstaple\* 877-5165. 93-2-440

**REDUCED**

**\$10,000 DOWN - IT'S LIKE NEW**  
\$199,900. Exceptional 4 bedroom on pool sized lot - with the pool. Gleaming hardwood and broadloom. Beautiful rec room with log burning fireplace - must be viewed. 93-2-130

**NEW PADDOCKS**  
47 acre panorama, 3 bedrooms, high on a hill, walkout on two levels, hot tub, rec room, huge insulated shop, fenced paddocks. Call Larry Barnstaple\* 874-3040. 93-2-251

**SPECTACULAR VIEWS**  
Custom built home with approx. 5,000 sq. ft. on the main floors, 10 ft. ceilings, cherry plank floors, walkouts to balcony deck, 4 spacious bedrooms, library, large studio, 57 acres of trees, hills & streams. 93-2-394

**REDUCED**

**\$10,000 DOWN - IT'S LIKE NEW**  
\$199,900. Exceptional 4 bedroom on pool sized lot - with the pool. Gleaming hardwood and broadloom. Beautiful rec room with log burning fireplace - must be viewed. 93-2-130

**HORSE FARM AND STONE HOUSE**  
On 89 acres, large bank barn, indoor riding arena, 38 stalls, stream, pond, 5 acres of bush. 92-2-485

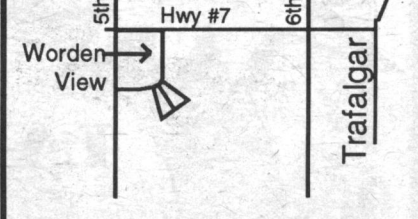

**ESTATE LOTS 114,900**  
2 acre lots on paved road, ravine, trees, close to Georgetown "Go". Call Larry\* 874-3040.

**\$499,000**

**NEW**  
**21.5 acres**  
4th LINE 5th LINE  
10th SIDEROAD, ERIN

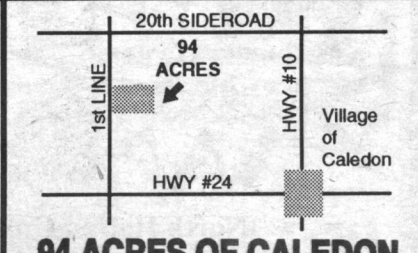

**23 PRIVATE ACRES**  
Spring fed pond. Open meadow. Executive Cape Cod home with spacious family room addition with cathedral ceiling & stone fireplace situated to take advantage of the views. 5 stall insulated barn with paddocks. 93-2-115

**FISH HERE!**  
\$129,000 asking for this 21.5 acre building lot, trees, stream, pond, trout, new 28 x 48 ft. workshop. Call Larry\*.

**94 ACRES OF CALEDON**  
\$649,000 asking. Close to Caledon Village, close to Hwys #24 and #10. Great home site while waiting for future opportunities. Call Larry\* 877-5165