

# First-time buyers a major force

First-time home buyers have been the major force in the Toronto real estate market says a new study by Royal LePage.

The Royal LePage National Survey of Canadian Real Estate Consumers, released today, shows that 50 per cent of all residential real estate purchases in the Greater Toronto Area during the first three months of 1991 were made by first-time buyers.

The Survey examined 66,000 real estate transactions over the past 18 months and compared them with annual statistics dating back to 1987.

Data for Toronto shows that the percentage of first-time buyers in

the real estate market rose from 31 per cent in 1987 to 44 per cent in 1990. Through the first quarter of this year, this figure has risen to 50 per cent, which is the second highest such figure in Canada. Only Montreal, where 60 per cent of purchasers are first-time buyers, is high.

Royal LePage says this first-time buyer phenomenon is a feature of most major cities across Canada, although not to the same extent as in Toronto and Montreal.

Bernie Vogt, Senior Vice President for Royal LePage in Toronto, says he is not surprised. "The affordability of housing in the

Toronto area has improved significantly in the past year or so. Mortgage interest rates have dropped almost 4 per cent since the beginning of 1990. House prices are down anywhere from 10 per cent to 20 per cent depending on location. And, until recently, there was an abundant supply of affordably-priced housing on the market."

Vogt points out that the median price of homes sold in Toronto dropped throughout 1990 and now stands at just over \$210,000. Moreover, condominiums, which represent close to one in four resale homes in the Metro area, are even more affordable. The

median price of condominium apartments is currently under \$142,000.

"Thirdly, the Toronto 'commuter-shed' runs for Hamilton, north to Barrie and east to Oshawa, so there are always affordable homes in the Toronto region."

The average home in Toronto, which remains Canada's most expensive city for real estate, costs \$260,675 compared to national average of \$160,643.

The second major finding of the Survey was a trend away from investment in residential real estate properties.

## CROSS CANADA MARKETPLACE

IT'S FAST - IT'S EASY! ONE CALL, ONE BILL DOES IT ALL. THINK BIG - CALL THE HERALD AT 877-2201 FOR DETAILS.

### RECREATIONAL VEHICLES

BONAIR CAMPING TRAILERS, Hardtop, Fold-down, Fifth-wheel, Travel, Park-models, parts-accessories, New-Used, Fiberglass & Lear Fiberglass & Aluminum Truck Caps, Consignments welcome, Royal Trailer & R.V. Centre in Teviotdale, Ont. (519)343-2122.

### BUSINESS OPPORTUNITIES

FACT #1 - Over 450 people averaged \$225K with our firm last year. Fact #2 - More people earned \$10K/mo. part time. For more info, (416)777-1493.

### LIVESTOCK

4TH Canadian National Breeders School for ALL BEEF PRODUCERS, July 31 - Aug. 4, 1991, Kemptonville, Ontario. Registration \$395 includes all meals and lodging. Contact Vern Spence (613)692-3373.

### NOTICES

DO YOU HAVE PSORIASIS? Call 1-807-937-ITCH, 1-800-561-ITCH Zsoria-Med cures your symptoms. 90 Day Money-Back Guarantee!!

Your ad could appear in community newspapers in Ontario, or right across Canada, or any individual province. Space is limited, so Call The Herald at 877-2201 Today!

## HOME IMPROVEMENT TIPS

Today's Beaver home improvement tip is about how to plant trees and shrubs.

Outdoor trees and shrubs are hearty plants, but they will die if you don't give them enough room. Step one is to dig a hole wide enough for the longest root to be laid into it without crowding. Before you start to dig, use a plastic or plastic sheet to pile dirt on. This will save on clean up time and prevent dirt from smothering the grass where it is piled. Make the hole half again as large as the diameter of the roots of the plant.

If the shrub is in a container, the hole should be dug at least 2 inches deeper than the root in the container. Loosen the soil below the root and add a small amount of plant food. Remove the plant from the container and lower it into the hole. Refill the hole loosely with soil, forming a barrier with the additional soil around the edge of the shrub at ground level to make a small basin to hold water.

**PLUMBING SUPPLIES**

- Acrylic Bath & Shower Units
- Whirlpools
- Spas • Pedestals
- Vanities & Medicine Cabinets

— Since 1958 —  
**877-2293**  
**798-7786**

**HOWSELL**  
 PLUMBING SUPPLIES LIMITED  
**PLUMBING SHOWROOM**  
 11 Armstrong Ave., Georgetown

**HERMAN'S**  
 ALUMINUM & ROOFING PRODUCTS LTD.

**SIDING • SOFFITS FASCIA**

Aluminum and Vinyl

- 5 Inch Seamless Eavestrough
- Replacement Windows and Doors

**457-2134**  
 OR  
**873-1951**

**Aqua-Mar**  
 POOLS

**AND SPAS**

"NOT JUST ANOTHER HOLE" IN THE GROUND

- Custom Designed Pools & Spas
- Pool Renovations
- Coping, Painting, etc.
- Pool & Spa Maintenance

**Phone 793-7665**  
 or **677-8163**

**APC** ACTON PRECAST CONCRETE LIMITED

- SEPTIC & HOLDING TANKS
- PVC SEWER PIPE
- W. L. TILES & CULVERTS
- TRANSFORMER BASES
- STEPS & PORCHES
- YARD & PATIO PRODUCTS

**853-1529**

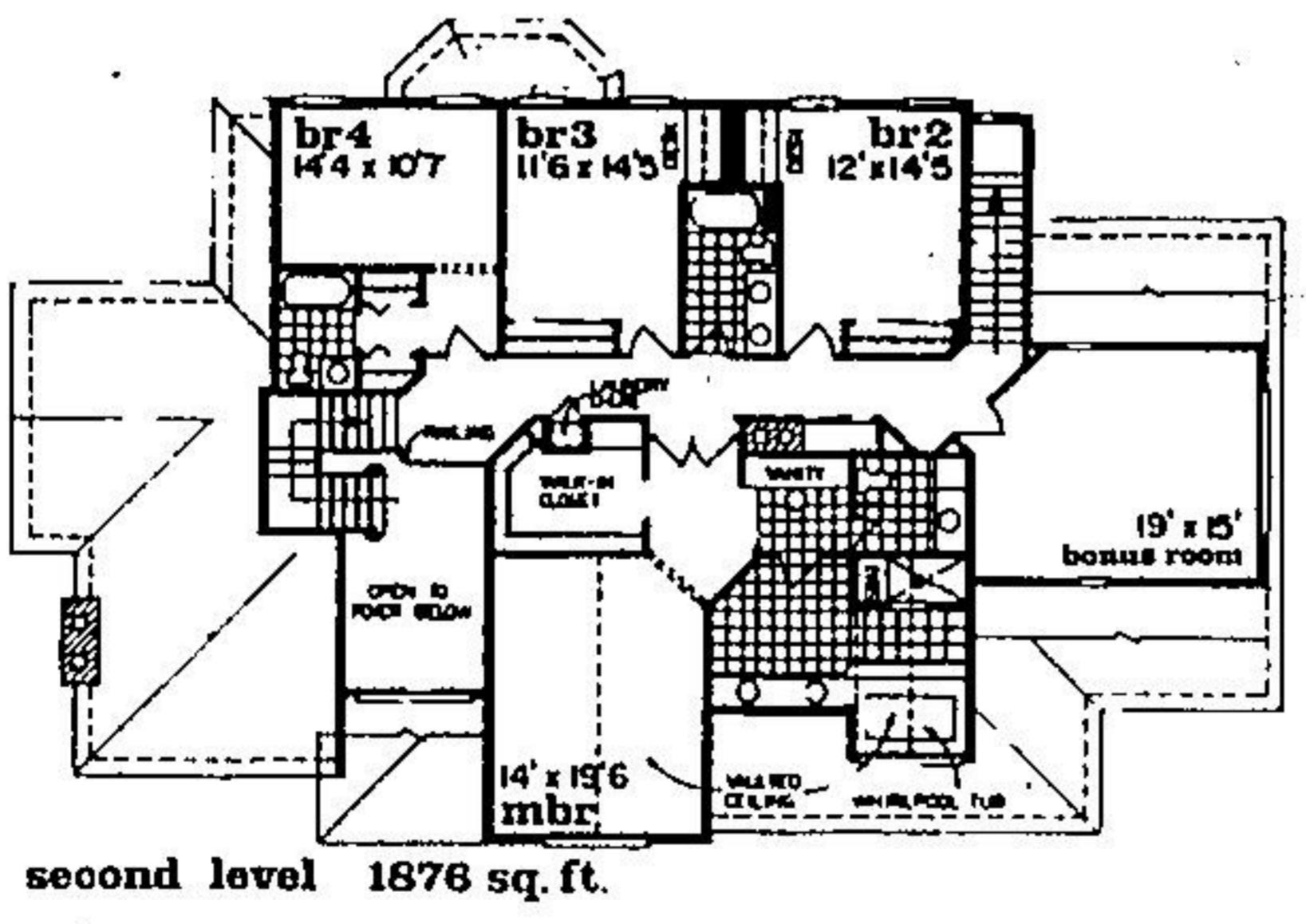
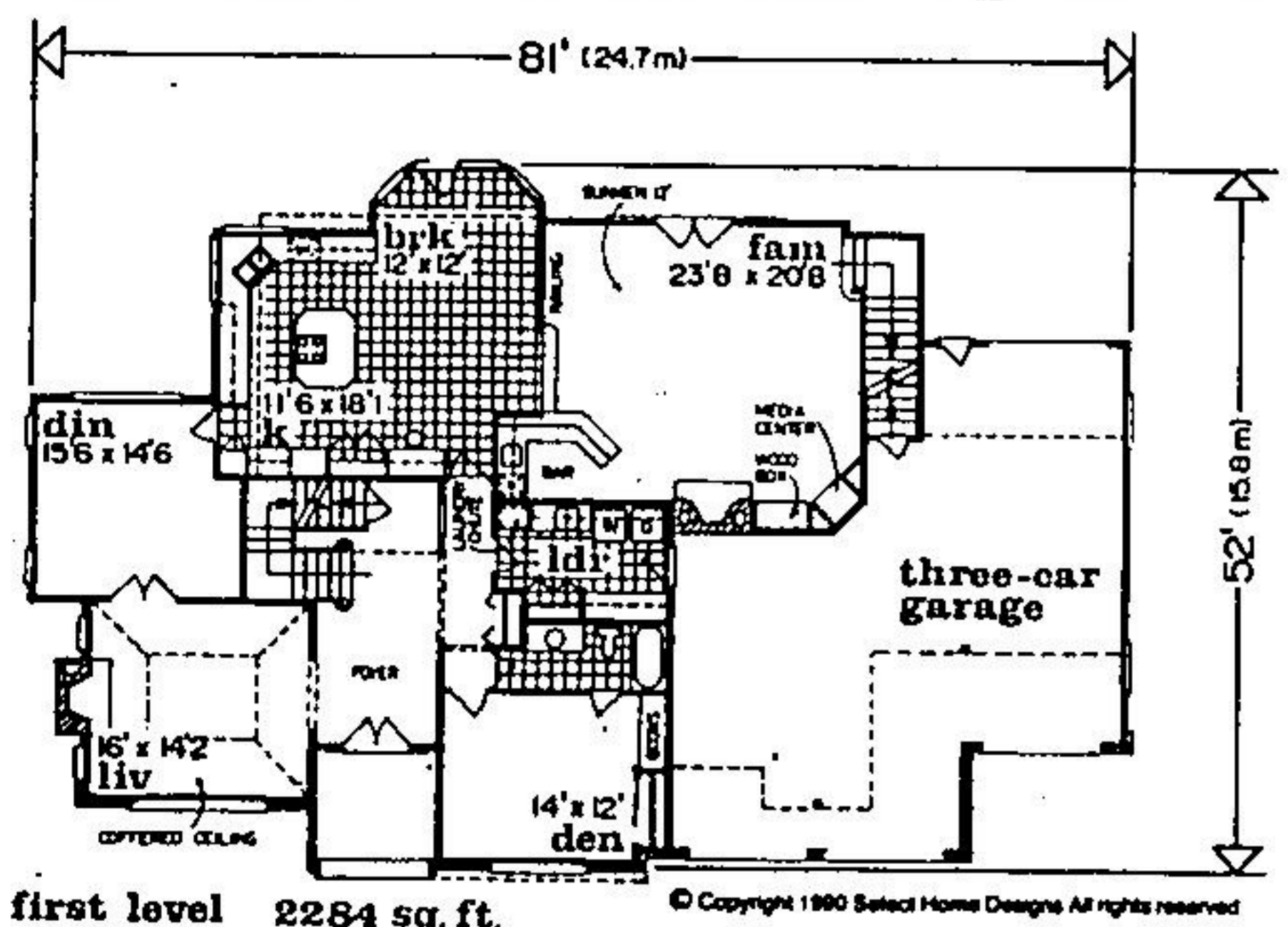

"The Custom Touch That Makes The Difference"

**TRIMIR** FINISH CARPENTER

- Interior & Exterior Renovations
- Custom Trim & Millwork

CALL DALE AT:  
**(BUS) 875-7219 (RES) 873-7211**

**CORE'S WELL DRILLING**  
 4th & 5th Working Generation

COMPLETE WATER SYSTEMS INSTALLED

**878-4515 MILTON**

**K & B ROOFING AND REPAIRS**

- Interior • Exterior
- Repairs • Re-Roofs • Siding
- Shingling • Soffit & Fascia

FREE ESTIMATES **875-1263**

**AMLY CUSTOM HOMES**

- All Phases of General Contracting
- Complete Homes or Basement & Frame Package
- Labour & All Material Supplied

**873-6104 PLEASE LEAVE MESSAGE**

**ECOLINE**  
 by Catherine Farley

Caring for Our Land

**THE COST OF GARBAGE**  
 It costs taxpayers over \$100 per tonne to collect and dispose of household garbage.

Food waste	30%
Yard waste	5%
Newspapers	10%
Other paper	30%
Glass, plastic, and metal	20%
Other	5%

**WHAT'S IN THE AVERAGE HOUSEHOLD GARBAGE?**

- Compost food and yard waste, or put it through the blender and use as nutrient rich food for house plants.
- Reuse or recycle metal cans, and plastic and glass bottles.
- Don't buy products that are overpackaged.
- Put a "NO JUNK MAIL" sign on your mail box, or return unwanted mail to sender.

**AIRWAYS VACUUM SERVICE**

CHIMNEYS CLEANED PROFESSIONALLY

- Air Duct Specialists
- Serving Town & Country

FREE ESTIMATES **873-1884**

**WATER PUMP**  
 Sales & Service

COULDS WATER SYSTEMS Serving Hillsburgh, Enn & Nation Hills

**BOYES PLUMBING**  
 for all your plumbing needs  
**855-4232**

**CONTACTI** Mortgage Brokers Inc.

Mounting Monthly Debts?  
 Planning Improvements To Your Home?  
 Call Us For All Your Mortgage Needs!

CONTACT PAULA OR SUSAN (519) 741-5151

**LANGILLE WELL DRILLING**

5" & 6" Diameter • Cable Drilling  
 Pump Sales & Service

**877-8329** or **453-0256**

**DREAMSCAPE** LAWN SPRINKLERS LANDSCAPING

**873-1917**

**ROBERT FREESTONE CONSTRUCTION LTD.**

Residential & Commercial Projects  
 To Your Specifications or Ours

**877-2698**

Representing: **artcraft kitchens** **Beckermann**

**A Touch of Class**  
 KITCHEN SHOWROOM INC.

Hwy. 25, 1 mile south of  
**ACTON 853-4577**

**NEKA** **CORIAN**