

**PLUMBING SUPPLIES**

- Acrylic Bath & Shower Units
- Whirlpools
- Spas • Pedestals
- Vanities & Medicine Cabinets

877-2293  
798-7786

**ROUSELL**  
PLUMBING SUPPLIES LIMITED

**PLUMBING SHOWROOM**  
11 Armstrong Ave., Georgetown

**HERMAN'S**  
ALUMINUM & ROOFING PRODUCTS LTD.

**SIDING - SOFFITS - FASCIA**

ALUMINUM & VINYL

- 5 INCH BEAMLESS EAVESTROUGHING
- SHUTTERS - WINDOWS - DOORS
- ASPHALT SHINGLE ROOFING

20 YEAR WRITTEN GUARANTEE

457-2134  
OR  
873-1951

**ELECTROLUX**

Join the new generation in home cleaning with a new **Electrolux Central Vacuum System.**

It can be easily installed into new and existing homes

For more information call: **451-7429**

119 McLaughlin Rd. BRAMPTON, ONT.

**PRESTIGE FABRICATION**

MODULAR STAIR SYSTEMS DESIGNED FOR THE DO-IT-YOURSELF ENTHUSIAST  
EXPERT INSTALLATION AVAILABLE

31 LOWRY DR. BRAMPTON **840-7233**

**DREAMSCAPE** LAWN SPRINKLERS LANDSCAPING

**873-1917**

**LENNOX** AIR CONDITIONING HEATING

Enquire About The New Whisper Heat Natural Gas Efficient Furnace

**TERRY ROWLEY MECHANICAL INC.**

408 Commercial St., Milton **878-1979**

**WATER PUMP** Sales & Service

GOULDS WATER SYSTEMS Serving Hillsburgh, Elm & Halton Hills

**BOYES PLUMBING** for all your plumbing needs

**855-4232**

**CONTACT Mortgage Brokers Inc.**

Mounting Monthly Debts?  
Planning Improvements To Your Home?  
Call Us For Your Mortgage Needs!

CONTACT PAULA OR SUSAN (519) 725-3033

**CORE'S WELL DRILLING**

4th & 5th Working Generation

COMPLETE WATER SYSTEMS INSTALLED

**878-4515 MILTON**

**GEMINI** GLASS & MIRROR

- AESTHETIC CREATIONS • CUSTOM DESIGN
- Mirror Walls & Ceilings
- Mirror Closet Doors (Sliding & Bifold)

FREE IN-HOME CONSULTATION & ESTIMATES

9 Carruthers Rd. **873-1230**

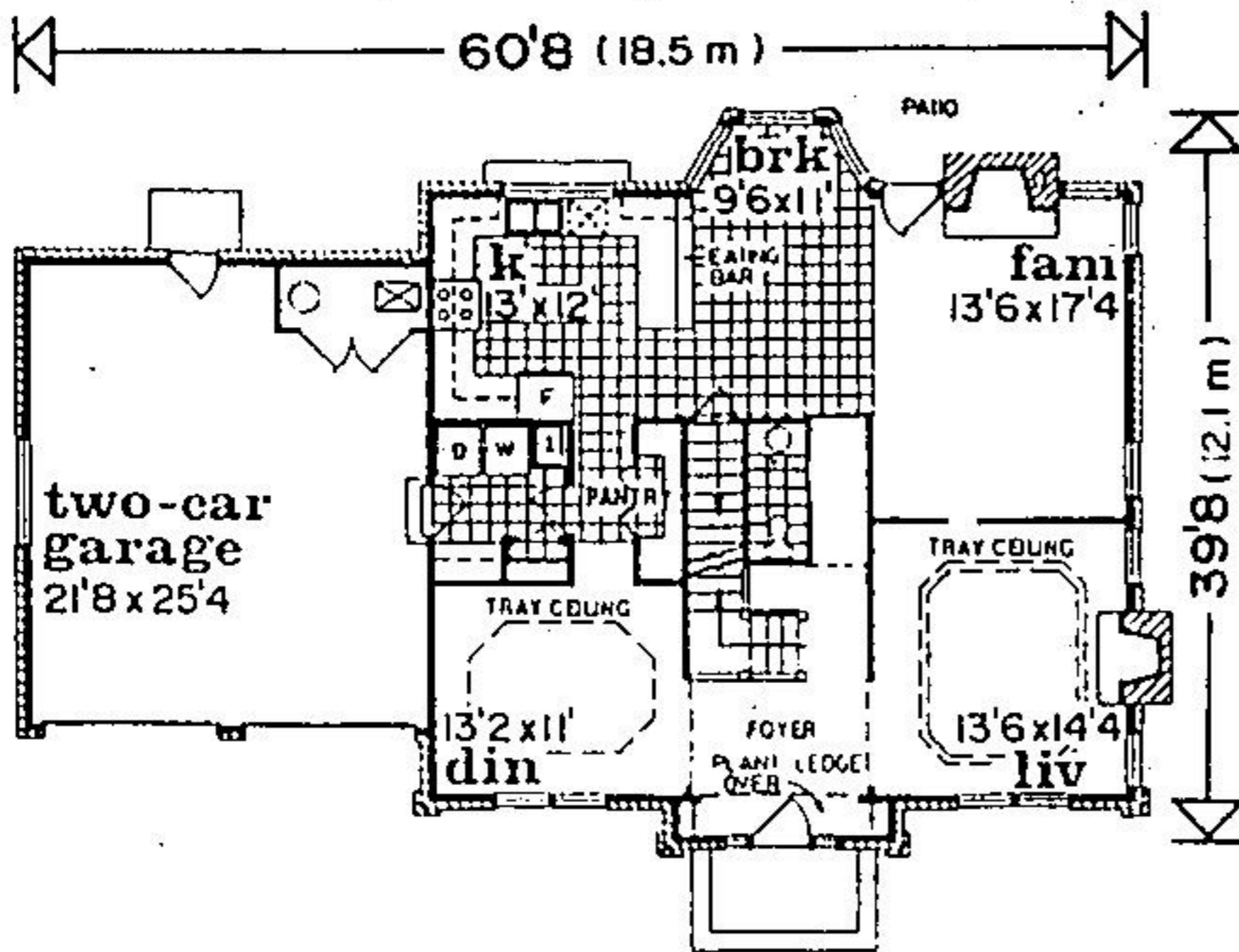

first level 1332 square feet



Master bedroom

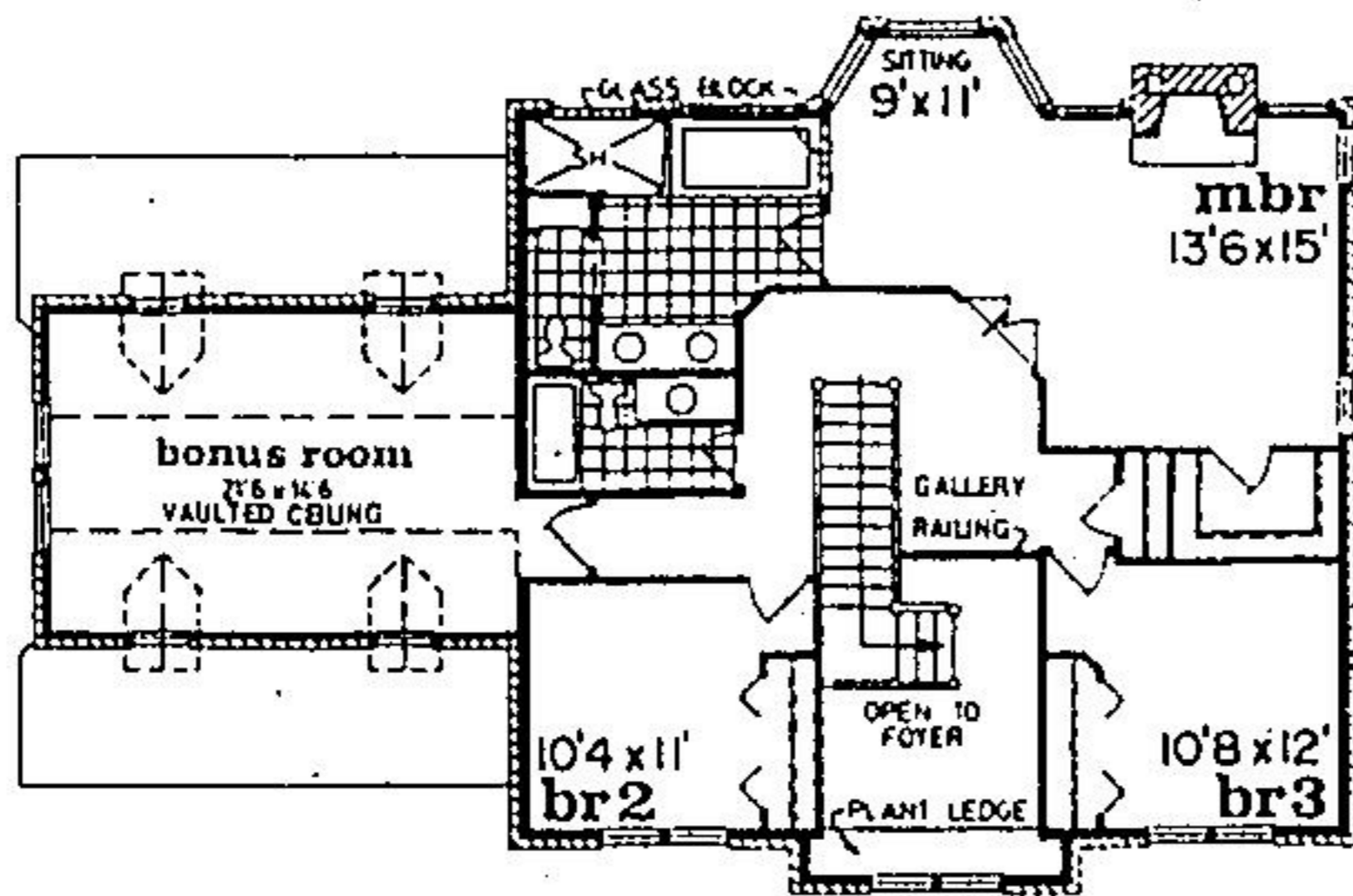

second level 1206 square feet

**AMLY CUSTOM HOMES**

- All Phases of General Contracting
- Complete Homes or Basement & Frame Package
- Labour & All Material Supplied

**873-6104 PLEASE LEAVE MESSAGE**

**CURTIS EVANS**

PAINTING & WALLPAPERING

WALLPAPERING SPECIALISTS  
Residential - Commercial - Industrial

PHONE **873-0707**

**HERWYNEN SAWMILL**

**Bruce** hardwood floors

- RED WESTERN CEDAR

**856-1180**

R.R. 1, ROCKWOOD - See Yellow Page No. 33

**Carter's Bobcat Services**

- TRENCHING • EXCAVATING • POST HOLES
- GRADING • DRIVEWAYS

**840-7756**

**TUGA FORMING LTD.** COMMERCIAL/RESIDENTIAL

**TF**

- Concrete Foundation
- Custom Homes Our Specialty

Archie Duiker **941-9965**

**VICTOR'S GLASS ENCLOSURES**

- Solariums • Sunrooms
- Pool Enclosures • Entrances

OVER 25 YRS. EXPERIENCE **873-1258**

**ARBOLITO**

LANDSCAPING - SINCE 1988

- Driveways • Patios • Decks
- Pruning • Interlocking Stone And Much More!

**877-9591** MOBILE No. 565-6211

Representing: **artcraft kitchens** **Beckermann**

**A Touch of Class**

KITCHEN SHOWROOM INC.

Hwy. 25, 1 mile south of **ACTON 853-4577**

**SKBA** **CORIAN**

**LANGILLE WELL DRILLING**

5" & 6" Diameter - Cable Drilling  
Pump Sales & Service

**877-8329 or 453-0256**

DID YOU MISS OUR INVITATION TO HAVE YOUR AD INCLUDED IN THIS WEEKLY FEATURE? IF SO, AND YOU WOULD LIKE TO PLACE AN ADVERTISEMENT CALL

**KIM HARYOTT**  
at **877-2201**

**ROBERT FREESTONE CONSTRUCTION LTD.**

Residential & Commercial Projects To Your Specifications or Ours

**877-2698**

# Planning gardens

This article is provided by local Realtors and the Ontario Real Estate Association (OREA) for the benefit of consumers in the real estate market.

Once you've raked, cleaned up and prepared your garden and flower beds, it's time to decide what to put in them.

Planting time varies across Ontario. Gardeners in the southern part of the province can usually plant earlier than those in central and northern regions.

Start with self-grown or purchased vegetable plants that can withstand a bit of frost, such as broccoli. Also sow seeds of vegetables that germinate in cool soils such as peas and many root crops.

Many seeds, such as peas, beans, carrots, lettuce, spinach, corn and potato, are best sown directly into the ground. Others, like broccoli, cauliflower, tomatoes and peppers, are best planted as seedlings.

In small gardens, select vegetables that yield a lot of limited space, such as lettuce, onions and snap beans. You can make the most of your garden space by planting lettuce seeds between slow-growing vegetables such as broccoli and cabbage.

You can also increase productivity by planting fruits and vegetables among flowers. Herbs such as chives and parsley and fruits such as strawberries make neat borders for flower beds. Carrots and asparagus mix in well with perennials.

To ward off insects that may attack your garden vegetables, plant marigolds among your beans, spinach, tomatoes, celery and other crops. The roots of marigolds produce a chemical that can kill some garden insects.

## FLOWER BEDS

Flower beds are most effective when located along the edge of a lawn, alongside a house or driveway, or as islands in a lawn. Borders should feature tall plants in the background, medium-sized plants in the middle and dwarf plants at the front.

Island beds are most attractive with tall plants in the middle, medium-sized plants on both sides and dwarf plants at the edges. Containers such as large flower pots and wooden barrels also make good flowerbeds. These should all have drainage holes at the bottom, which are covered with stones to prevent soil from washing out.

Even if you don't have a green thumb, your flower beds will flourish by including some hardy annuals. Most popular are impatiens, geraniums, marigolds, petunias, pansies and begonias.

Remember to consider how well the plants you select tolerate shade or sun. If your garden gets six or more hours of sun a day, selected sun-loving plants. Otherwise, stick to shade dwellers.

Impatiens are by far the most popular shade-loving annuals. Marigolds and petunias are great for dry, sunnier spots. Known as 'survivor' plants, these do well almost anywhere and require practically no care.

Most annuals are available in tall and dwarf forms and a variety of sizes in between.

You can combine annuals and perennials together to produce beautiful blooms each season, year after year. But because perennials only put on a flower display for part of a season, these gardens require a little more planning and care.